

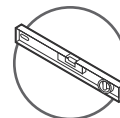

Roca

PRISMA CONFORT

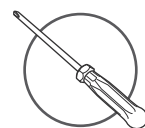
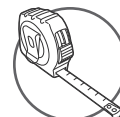
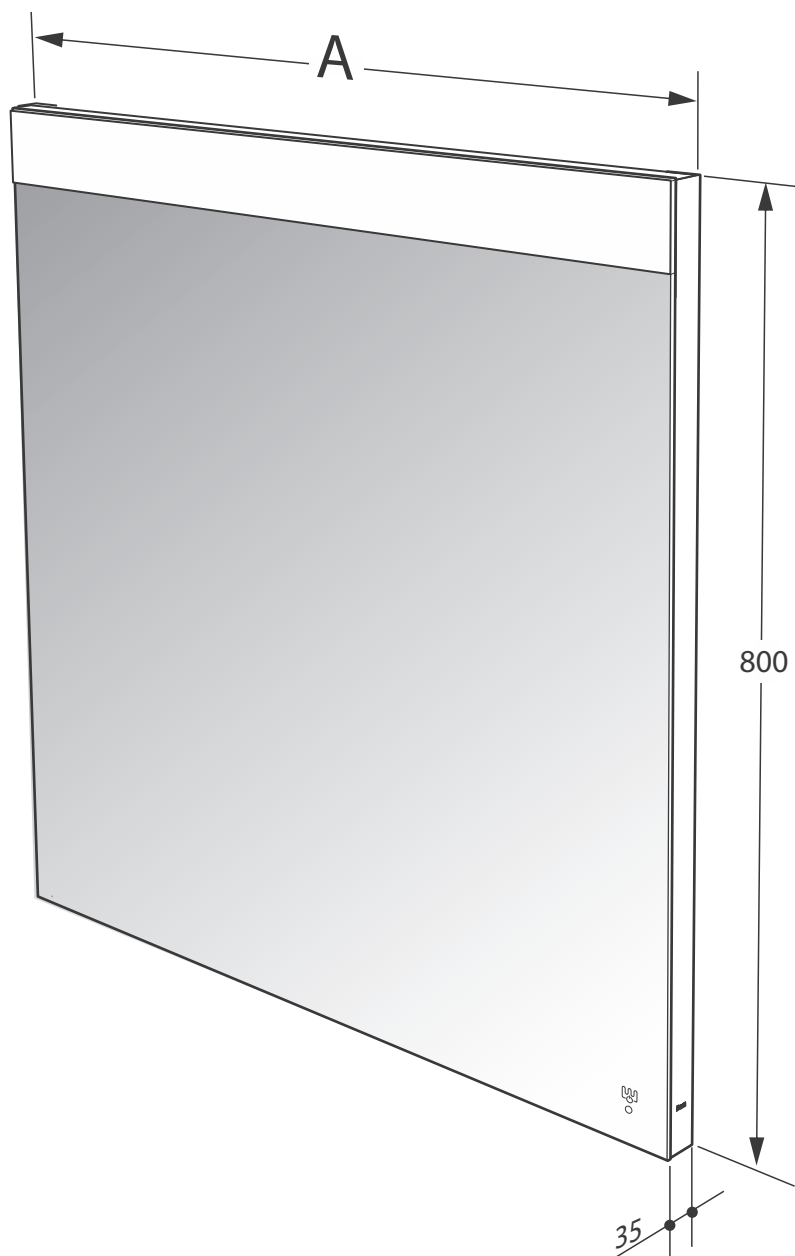

	A mm
A812263...	600
A812264...	800
A812265...	900
A812266...	1000
A812267...	1100
A812268...	1200
A812277...	1300

220-240V ~ 50/60Hz
LED Max 1x12W
IP44

230V

ON/OFF

L min. 2 x 1mm ²

Antivaho	W A
A812263...	Max 1x36 W
A812264...	Max 1x36 W
A812265...	Max 1x36 W
A812266...	Max 1x36 W
A812267...	Max 1x36 W
A812268...	Max 2x36 W
A812277...	Max 2x36 W

1

110 mm min.

≥ 110 mm

2

A	L
600	480
800	680
900	780
1000	880
1100	980
1200	1080
1300	1180

L (mm)

1900

1867

Ø6

3

H05VV-F
0,5-1,5 mm ²
(x2)

A > 1200 mm

4

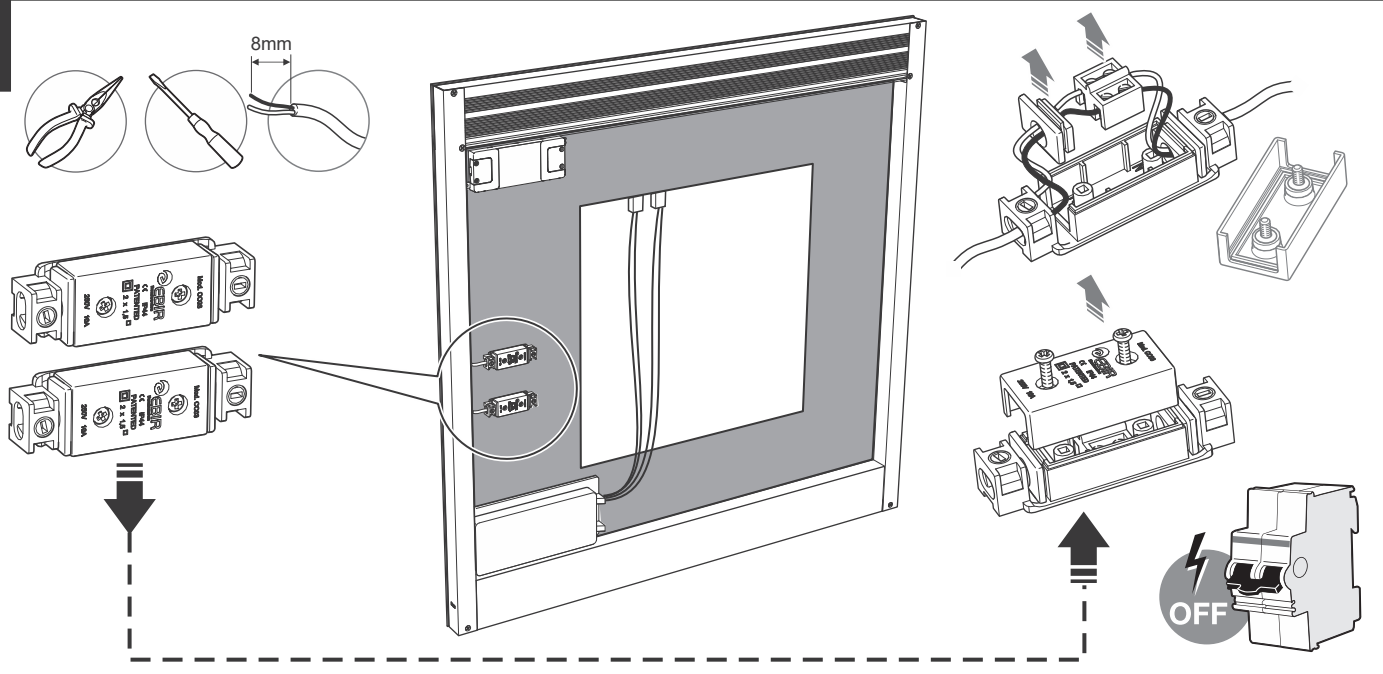

5

Conexión básica

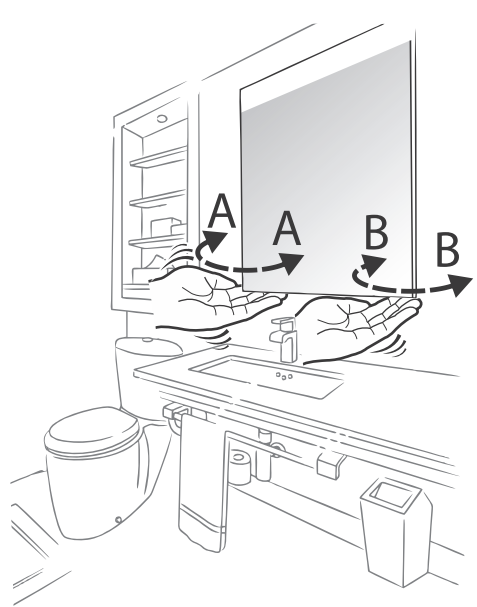
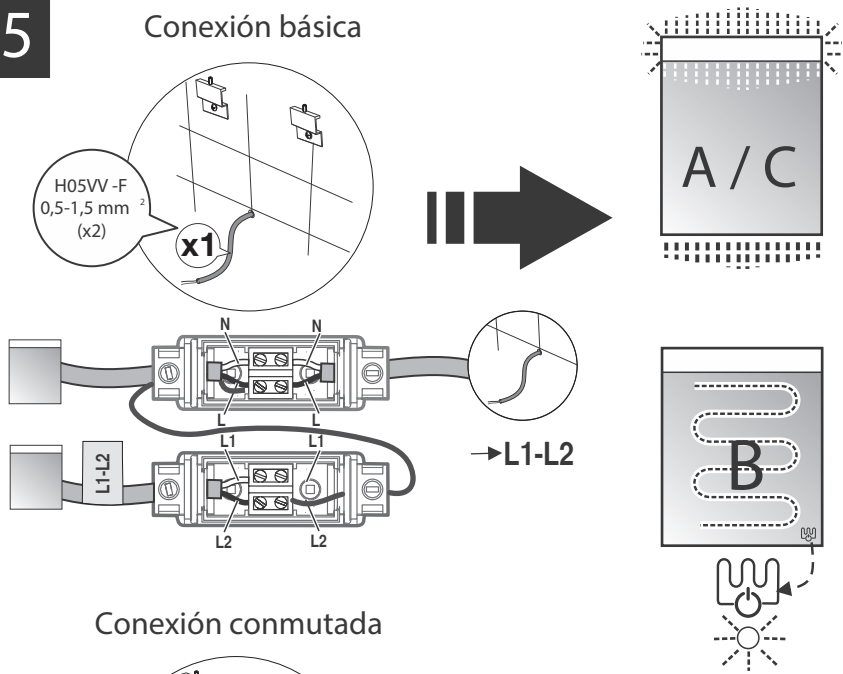

Conexión conmutada

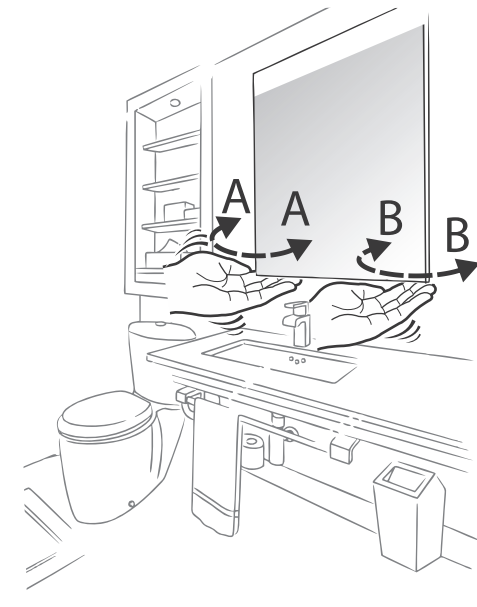
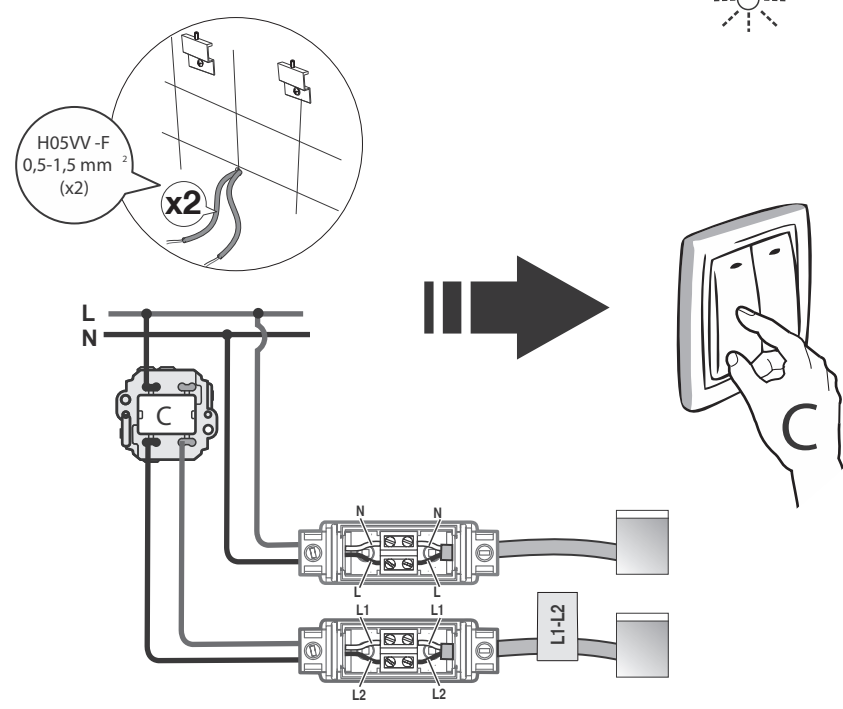

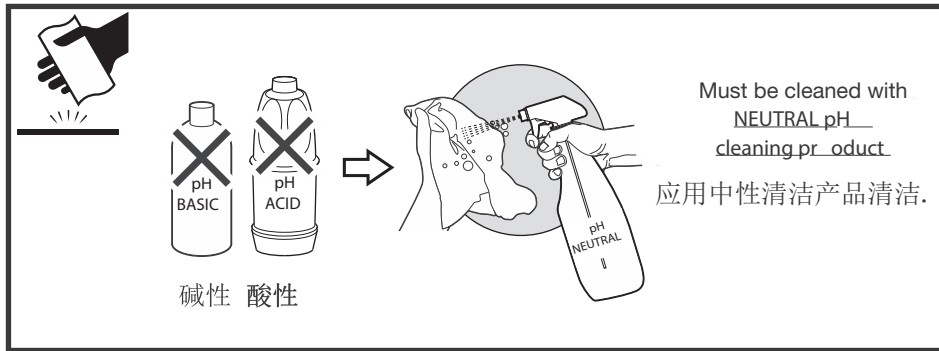
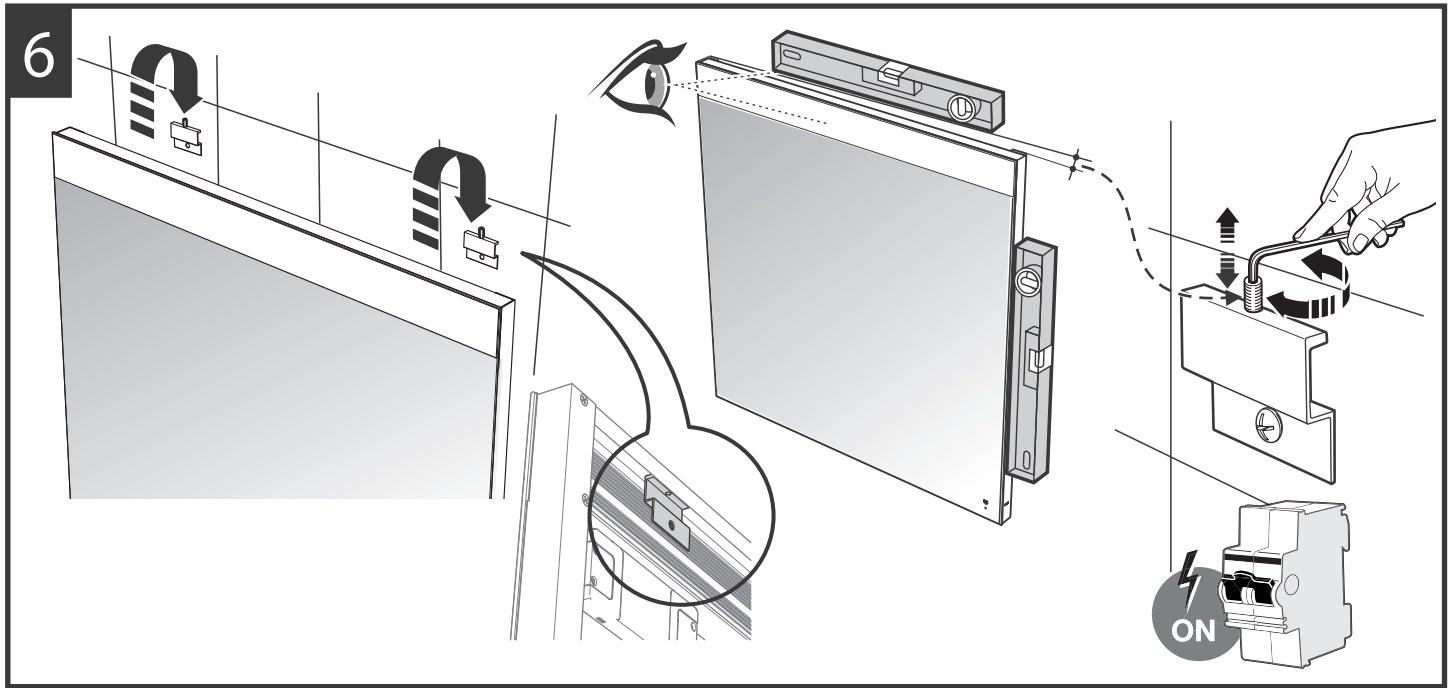

La fuente de luz de este espejo con luz es no reemplazable; cuando la fuente de luz alcance el final de su vida, se debe sustituir el espejo con luz completo

The light source of this light mirror is non-replaceable; When the light source reaches the end of its life, it must replace the complete light mirror.

灯具的光源是不可替换的，当灯具的光源达到寿命期限时，应替换整个灯具。

DIN A3



Roca Sanitario, S.A.
Avda. Diagonal, 513
08029 Barcelona
SPAIN
www.roca.com

933 LÍNEA DE ATENCIÓN
661 AL CONSUMIDOR
266 ESPAÑA

SERVICIO TÉCNICO
ESPAÑA

productsupport.rs@roca.net
soporteproducto.rs@roca.net

Q40600238G-f