

## WARRANTY STATEMENT

Where Methven tapware or valving (tapware) is purchased for use or on-sale in the context of any business, Methven undertakes to either repair or replace (at its option) that tapware if it is discovered that such tapware contains a material defect, which arose in the course of manufacture.

This undertaking shall not apply if:

1. The defect is brought to Methven's attention later than 2 years after the date of purchase, where the defect relates to washers, "O" rings, lip and other seals and powder coating, or 5 years where the defect relates to any other tapware componentry. All single lever ceramic disc cartridges specified for mains pressure only use, has a lifetime warranty.
2. There is a failure by any person to follow Methven's installation instructions or the tapware is used other than in accordance with Methven's specifications.
3. Evidence cannot be produced which confirms that the relevant tapware was purchased from a Methven authorised distributor.
4. Repair work is performed on the relevant tapware by a person other than Methven, its authorised service agents or any plumber who has not received authorisation **prior** to proceeding with the work.

Conditions:

Proof of purchase details (such as invoice or receipt) will be required to claim under this warranty.

Lifetime warranties are applicable, where mains pressure use only has been specified, on ceramic disc cartridges and will result in replacement of defective parts.

The above undertaking from Methven shall also apply to any purchaser of Methven tapware who is a "Consumer" under the Consumer Guarantees Act 1993, in addition to any other right or remedy which such person may have under that Act.

Methven shall in no way be liable to the purchaser or user of any tapware, for any loss, damage (direct, indirect or consequential), cost or expense suffered or incurred by that person, otherwise than as provided in the above provisions, or as provided under the Consumer Guarantees Act 1993.

METHVEN LIMITED \* 447 Rosebank Rd \* Avondale \* Auckland \* New Zealand  
phone : 03 466 4180      fax : 0800 805 222      website: [www.methven.biz](http://www.methven.biz)



METHVEN

## FUTURA SLIDE SHOWER

### Installation Instructions

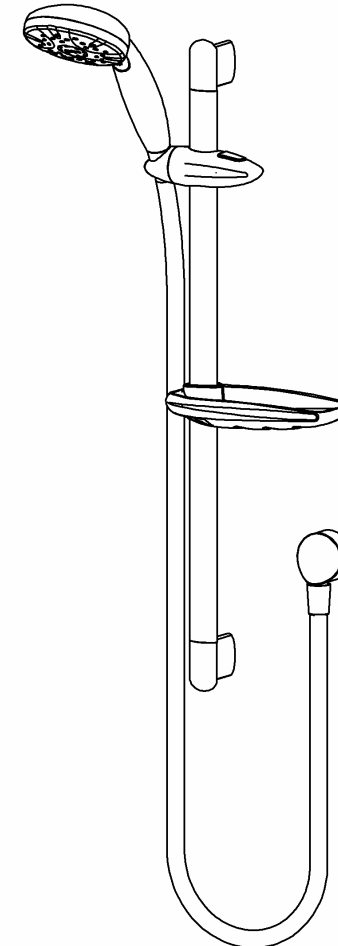

# INSTALLATION

1

Locate the bottom bracket in the desired position and attach with one screw

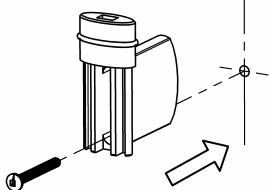

2

Attach the slider and the soap dish to the rail in the desired orientation

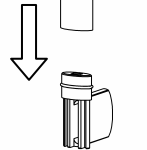
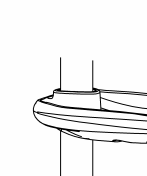
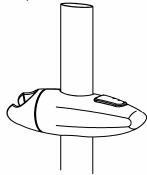
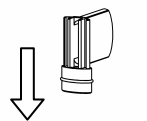

Fit the rail to the bottom bracket

Fit the top bracket to the rail

3

Ensure that the rail is vertical

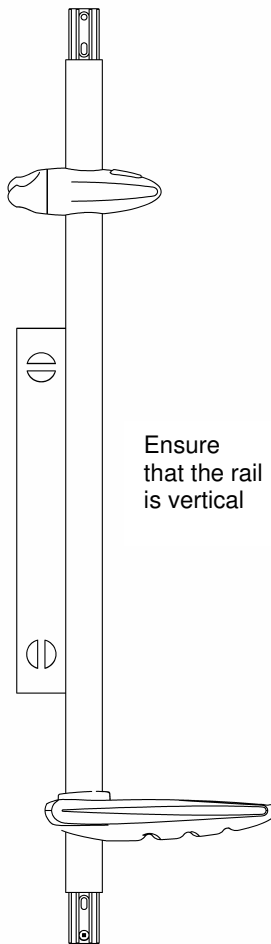

4

Insert the remaining screws

Fit the end caps

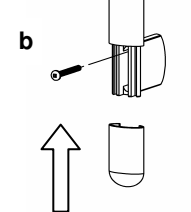
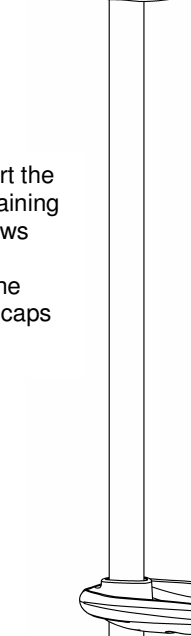
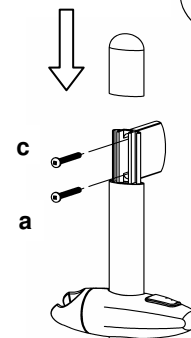

5

6

