

**Important – Please read all of the instructions before installation**

This Mixer is designed for Equal and Unequal Pressure systems.

This mixer is not recommended for use in uncontrolled heating systems such as wetbacks or solar heater units unless a NEFA TLV valve is fitted. BIA G12 requires all hot water supplies to any sanitary outlet to be tempered to 55°C.

**ALL PIPEWORK MUST BE THOROUGHLY FLUSHED PRIOR TO INSTALLATION OF THE MIXER. AN INLINE FILTER MUST BE FITTED TO PREVENT FOREIGN PARTICLES DAMAGING THE CERAMIC CARTRIDGE.**

**Technical specifications**

**Operating Pressure:** Min: 35kPa, Max 1000kPa.

Recommended 150 – 500kPa. Install a NEFA PLV if supply pressure exceeds 1000kPa.

**Hot Supply Temperature:** Recommended 55 – 65°C at the mixer. Max 80°C

**Inlet Connections:** All ½” BSP

**Installation Instructions**

A 35mm diameter hole is required in the bench top. The bench top cannot exceed 40mm thick.

Screw the mounting studs into the bottom of the mixer.

Connect the flexible hoses to the mixer body. Fit the base ring and the O ring to the base of the sink mixer.

Place the hoses through the bench top.

Fit the mounting gasket and mounting plate and tighten the mounting nuts.

2 rubber washers are provided for the flexible hose connections to the nipples. Machined nipple ends are required to ensure a seal to the flexible hose nuts and the rubber washers.

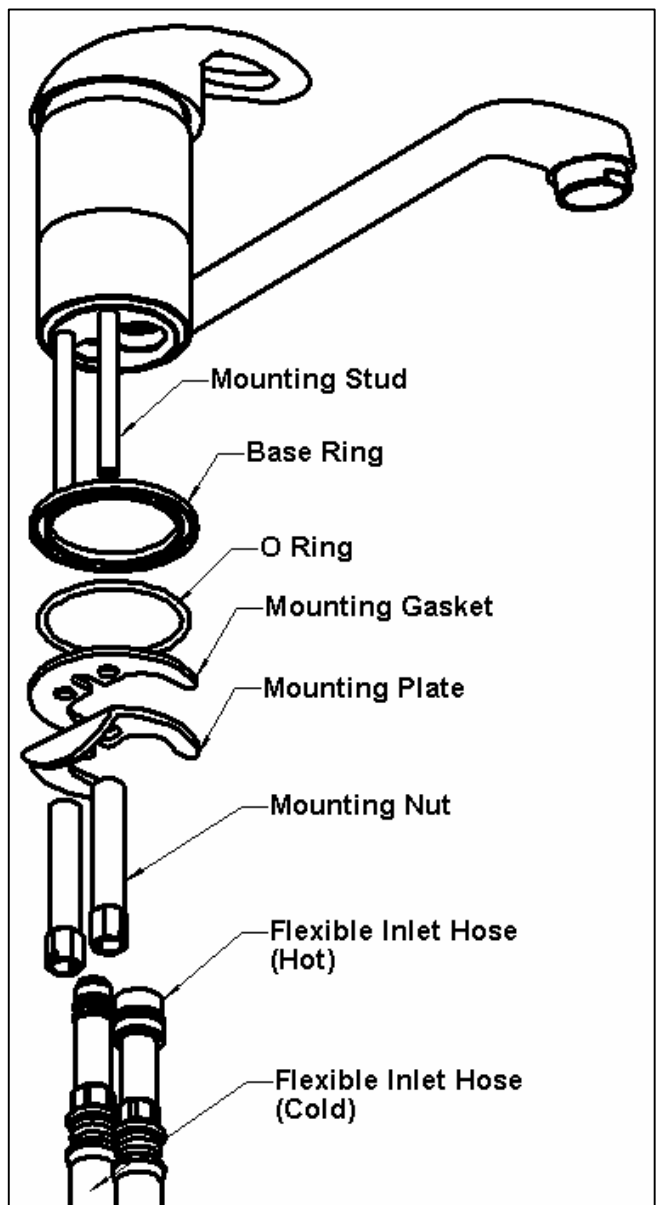

## Flexible Hose Requirement

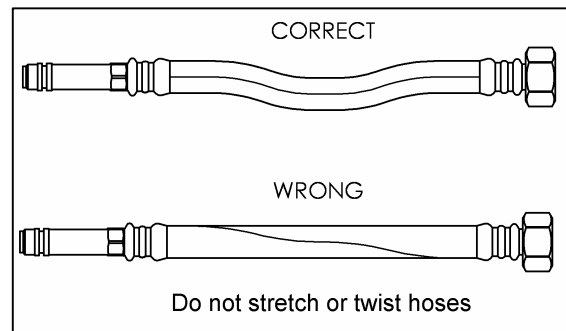
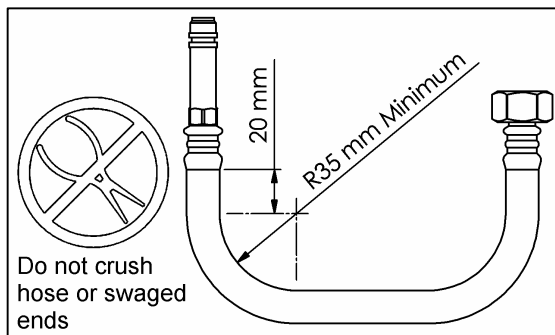

Where Methven tapware or valving (tapware) is purchased for use or on-sale in the context of any business, Methven undertakes to either repair or replace (at its option) that tapware if it is discovered that such tapware contains a material defect, which arose in the course of manufacture.

This undertaking shall not apply if:

1. The defect is brought to Methven's attention later than 2 years after the date of purchase, where the defect relates to washers, "O" rings, lip and other seals and powder coating, or 5 years where the defect relates to any other tapware componentry. All single lever ceramic disc cartridges specified for mains pressure only use, has a lifetime warranty.
2. There is a failure by any person to follow Methven's installation instructions or the tapware is used other than in accordance with Methven's specifications.
3. Evidence cannot be produced which confirms that the relevant tapware was purchased from a Methven authorised distributor.
4. Repair work is performed on the relevant tapware by a person other than Methven, its authorised service agents or any plumber who has not received authorisation **prior** to proceeding with the work.

Conditions:

Proof of purchase details (such as invoice or receipt) will be required to claim under this warranty.

Lifetime warranties are applicable, where mains pressure use only has been specified, on ceramic disc cartridges and will result in replacement of defective parts.

The above undertaking from Methven shall also apply to any purchaser of Methven tapware who is a "Consumer" under the Consumer Guarantees Act 1993, in addition to any other right or remedy which such person may have under that Act.

Methven shall in no way be liable to the purchaser or user of any tapware, for any loss, damage (direct, indirect or consequential), cost or expense suffered or incurred by that person, otherwise than as provided in the above provisions, or as provided under the Consumer Guarantees Act 1993.

METHVEN LIMITED \* 447 Rosebank Rd \* Avondale \* Auckland \* New Zealand  
phone : 03 466 4180      fax : 0800 805 222      website: [www.methven.biz](http://www.methven.biz)