

Network Connectivity

LexCom Home

Your safe link to the www.world



Yes, we are specialized in many areas!

As an experienced installer, you probably know about Schneider Electric. The company was founded in 1836 and today we are a global specialist in energy management, providing everything from installation materials and wiring devices to complete systems for automation and energy efficiency.



Even though all installers don't know about it, we supply network solutions with superior usability for offices and industries. Since 1998 we also provide seamless end-to-end network connectivity for homes, aiming to deliver complete peace of mind. As an installer, you are our most important partner in delivering this to the end consumers. So if you have any questions, don't hesitate to contact us for service and support. For example, what about getting a certification in the LexCom Home networks? Tell us and we will sign you up.

Safety is our competitive edge

Safety is the core idea for our three home networks LexCom Home Essential, LexCom Home Performance and LexCom Home Premium. They have been developed from our professional networks, with full compatibility between the old and new techniques. For instance, we predicted back in 1998 that the commonly used cat 5 cables wouldn't meet future needs, and used a cable similar to cat 6a instead. Today, this is the high performance standard. All our solutions are shielded and wired, providing a steady connection which doesn't disturb anyone or anything.



Contents

To sell and install LexCom Home	4
The three solutions	6
Choice guide	8
LexCom Home Essential	10
LexCom Home Performance	16
LexCom Home Premium	24

Why recommend LexCom Home?

Even though some people can be a bit hesitant towards networks and IT equipment, it's quite easy to sell any of the LexCom Home solutions. The reason is the safety aspects.

LexCom Home is developed from professional networks, based on proven future proof techniques, shielded and provided by a well-known supplier. Most LexCom Home installations are performed by LexCom Home certified installers. The networks also meet the customers' need to keep pace with the fast IT development, since it allows a very high bit rate and most parts can be upgraded. When installed, the network solution is easy accessible via the universal RJ45 outlet. That makes it a safe solution for your customers to let into their homes, and thereby it's automatically safe for you to sell it.

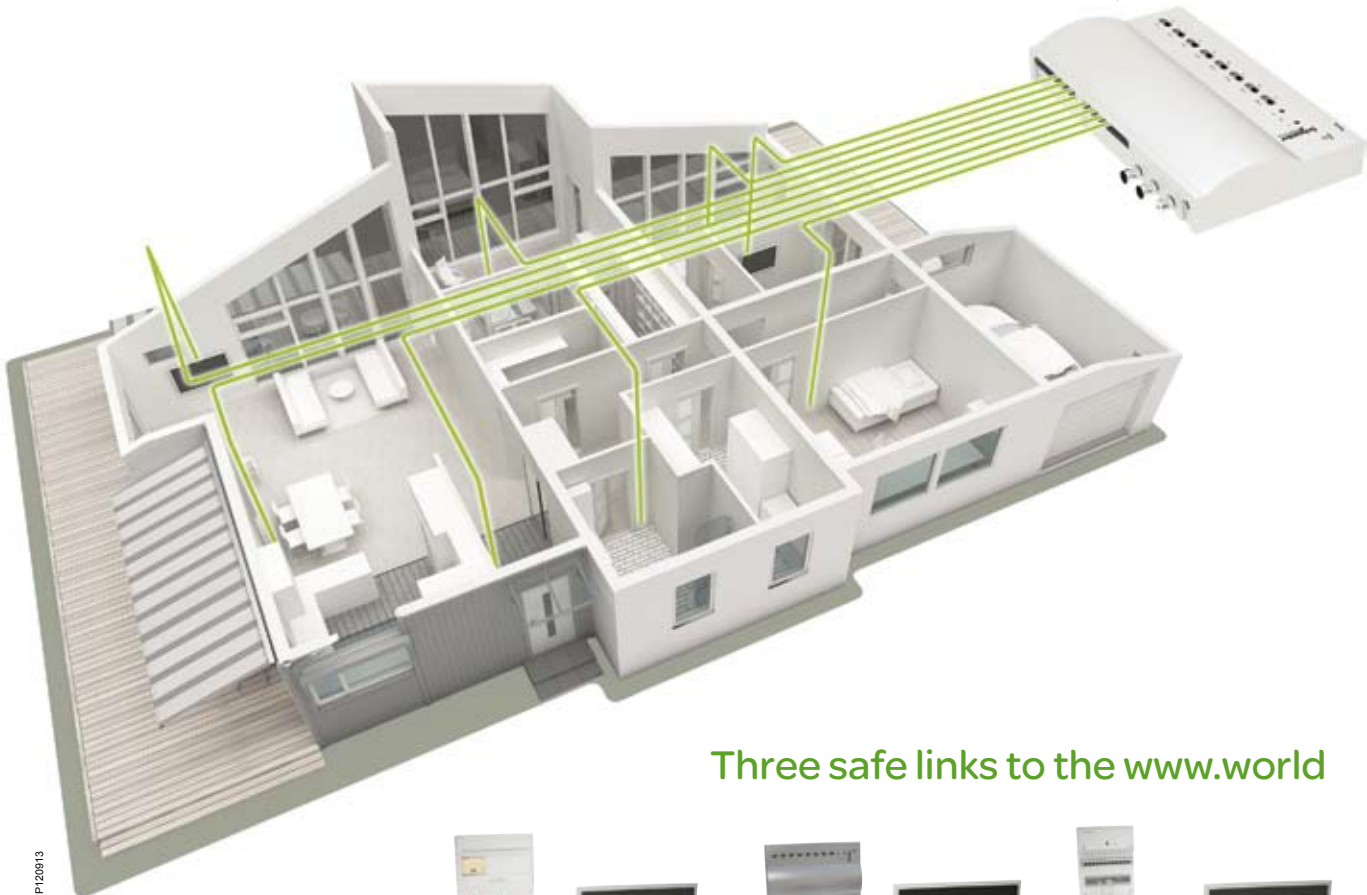

Three safe links to the www.world

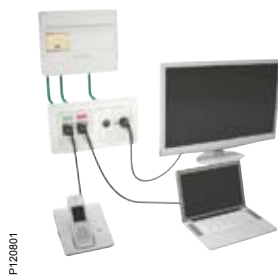

Essential

LexCom Home Essential is a simple construction demanding some coax cabling.

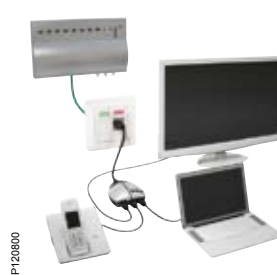

Performance

LexCom Home Performance is the most flexible system with multimedia Triple play.

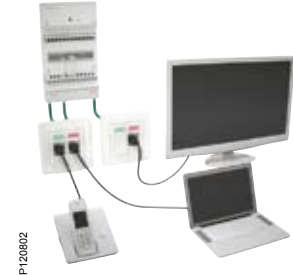

Premium

LexCom Home Premium is the tailor-made gigabit net for advanced high tech users.



Add LexCom Home to your installation skills

Your customers already got power at home. Now they need network connectivity. So go ahead and install IT outlets! The LexCom Home networks are as easy and safe for you to install, as they are for your customers to invest in. They will get a reliable data broadband, and also the opportunity to use high definition TV, audio-video and telephones, all from one and the same outlet. With your help they will also get an aesthetically safe choice – matching outlet designs and no tangled cords!



If you need hands-on guidance and information on network installations – let us know! At our Training and Competence Centres we provide introductions to all installers, fitters and consultants. As a result you will become certified in LexCom Home installations.

What's in it for you as an installer then?

Adding network installations to your skills will of course increase customers' interests in your services and result in more assignments for you. Our three network solutions are self-instructive and close to tool-less to install. For two of the solutions, LexCom Home Performance and LexCom Home Premium, only one cable type is needed. If you need instruction and training we can provide it. And if you still feel a bit insecure – our support and help desk is at stand by to help you. As a certified LexCom Home installer your installations also come with a special function and spare parts warranty. That makes the LexCom Home networks safe investments for your customers.

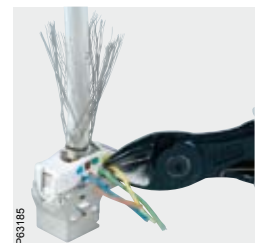
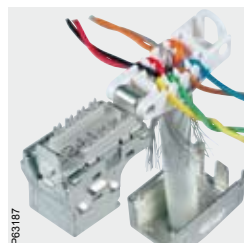

Three solutions for all needs

Investing in technology often makes people insecure – they need it but don't really know how it works in detail. That's why many irrelevant factors can influence your customers' choice of network solution. Here you find charts with the actual facts and figures. Use the information when explaining the capacity of our three solutions. That way you will help your customers to avoid irrational decisions.

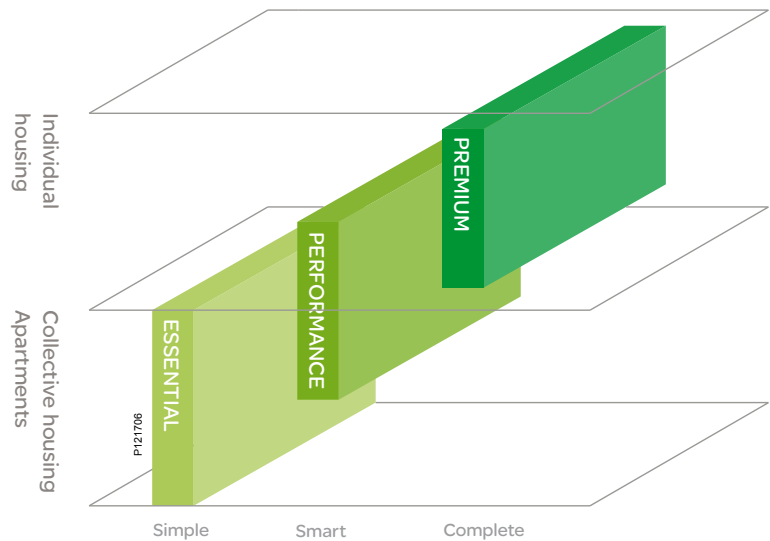

Who and where?

Is your customer an experienced high tech user, or is the network meant to provide basic connectivity? If it's just a matter of getting online, or if there's a big number of users in the same building, LexCom Home Essential is the smartest choice. If your customer is very interested in modern high tech or building his or her own home, the long lasting LexCom Home Premium would be a better recommendation. That way your customer can expand, upgrade and rebuild the network in the future, without limits.



Application	LexCom Home Essential	LexCom Home Performance	LexCom Home Premium
Telephone			
1 line	● ● ●	● ● ●	● ● ●
2 lines	● ●	● ● ●	● ● ●
Data			
100 Mbps	● ●	● ● ●	● ● ●
1 Gbps	● (over 50 m)	–	● ● ●
Television			
IP TV	● ●	● ● ●	● ● ●
Terrestrial	Coaxial	● ● ●	● ● ●
Cable	Coaxial	● (except Return path; coaxial)	● ● ●
Satellite	Coaxial	Coaxial	Coaxial or Modulator

– Not compliant ● Compliant with limitations ● ● Compliant ● ● ● Optimal

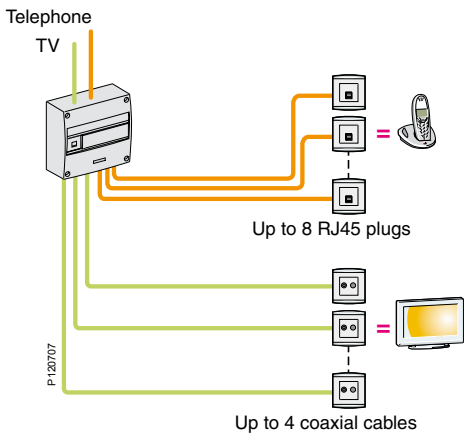

LexCom Home Essential

TV on coaxial plugs. Phone and data on RJ45 plugs. A rather simple and fast installation, providing the basics to let several users get online.

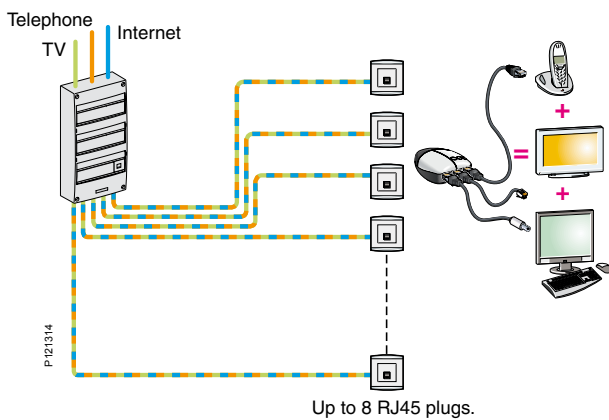

LexCom Home Performance

TV, phone and data on RJ45 plugs. The splitter makes all media available at the same time (Triple play).

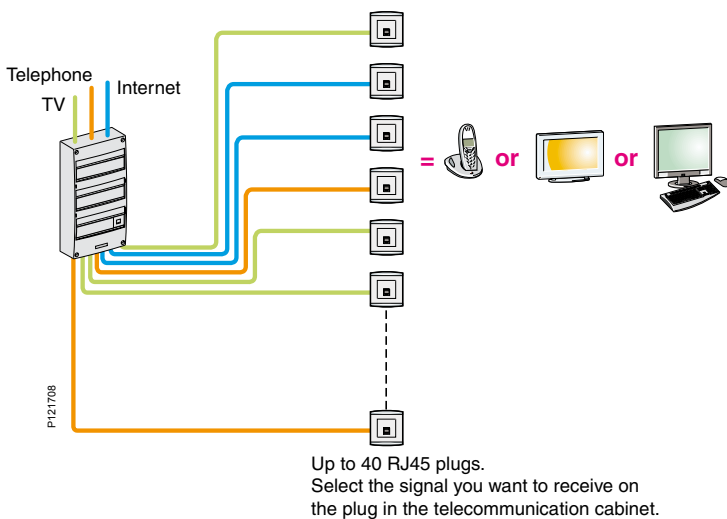

LexCom Home Premium

Select the media you want at the plug. More convenient for bigger houses, and for specific configurations (use with a satellite decoder, need of gigabit).

Choice guide

The terminology of computers and networks might be quite a novelty to many professional installers. So below is a chart explaining some of the terms and techniques. If it doesn't answer your questions, please contact Schneider Electric, and we will help you sort things out in order to provide customers with that exact network solution they need.

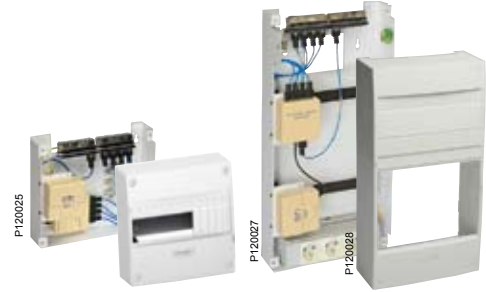

Application	Description	LexCom Home Essential
Delivery form		Pack
Number of outlets		Up to 8 RJ45, up to 4 coaxial.
Services		Telephone, data, television.
Cable infrastructure		Twisted pairs for telephone and data Cat 5 coaxial for video.
Connectivity		RJ45 and coaxial sockets.
Simultaneous service		1 RJ45 = 1 service.
Operator modem location		Essential: anywhere in a room. Essential XL: in the telecommunication cabinet.
Data	100 Mbps 1 Gbps Power on Ethernet (PoE)	7 outlets per module (Option). Compatible Compatible
Telephone	Lines Analogue line Internet Service Provider line (through Internet Gateway) ISDN	2 lines. Up to 8 outlets. Up to 8 outlets. Yes
Television and Radio	Analogue radio (FM) Digital radio (DAB) Analogue terrestrial TV Analogue cable TV Digital cable TV – DVB-C (SD, HD) Digital terrestrial TV – DVB-T (SD, HD) Return path for VOD in cable TV IP TV Analogue or digital satellite TV (DVB-S) Connection cord type (between device and wall sockets)	8 outlets. 8 outlets. Up to 4 outlets. Up to 4 outlets. Up to 4 outlets. Up to 4 outlets. Up to 4 outlets. 7 outlets per module (Option). Up to 4 outlets. Standard: coaxial.
Audio Video (AV) distribution	Analogue AV modulators Infrared remote control	– –



	LexCom Home Performance	LexCom Home Premium
	Pack or to mount	To mount.
	Recommended 8. Extension to 16 possible.	16 to 24 RJ45 (up to 40+).
	Telephone, data, television.	Telephone, data, television
	Twisted pairs for telephone, data, video.	Twisted pairs for telephone, data, video.
	RJ45 sockets.	RJ45 sockets.
	1 RJ45 = 3 services.	1 RJ45 = 1 service.
	Anywhere in a room or telecommunication cabinet.	Anywhere in a room or telecommunication cabinet.
	7 outlets per module.	4 outlets per module.
	–	4 outlets per module.
	Compatible Mode A (pairs 1, 2, 3 and 6).	Compatible
	2 lines.	2 or 4 lines.
	Up to 8 outlets.	8 outlets per module.
	Up to 8 outlets.	8 outlets per module.
	–	8 outlets per module.
	Compatible	Yes
	8 outlets.	Yes
	8 outlets.	Up to 6 outlets per module.
	Yes, except return path (see return path below).	Up to 6 outlets per module (exception: see return path).
	Yes, except return path (see return path below).	Up to 6 outlets per module (exception: see return path).
	8 outlets.	Up to 6 outlets per module.
	Additional coax cable is required.	Up to 2 outlets per module.
	7 outlets per module.	Up to 4 outlets per module.
	Additional coax cable is required (or modulator).	Additional coax cable is required (or modulator).
	Specific: RJ45 – coaxial.	Specific: RJ45 – coaxial.
	Compatible (need A111 module).	Designed for it. Cascading possible.
	Compatible with A111 module.	Yes

LexCom Home

Essential

Comparison chart

	Telephone	Data (Megabit)	TV (aerial)	CATV	SAT TV	Sockets
Essential	●	100 ○	○	○	○	● x 8 ○ x 4
Performance	●	100 ●	○	○	○	● x 8*
Premium	●	1000 ●	●	●	○	● x 40

● 4 pairs cable, RJ45 socket. ○ Coaxial cable, coax socket, *x 3 signals.

A robust and simple solution



P120801

If your customer's primary need simply is to get access to Internet, then LexCom Home Essential is a robust and reliable solution.

This is how it works

After installing a central telecommunication cabinet, where the preferred Internet operators modem has its designated place, up to 8 RJ45 outlets can be mounted to provide access to Internet, telephone and IP TV.

Easy to adjust media

What feature that's available in each RJ45 outlet can easily be changed by adjusting the patch cords in the central cabinet.

Bye-bye unaesthetical cords

Now your user can use any multimedia feature through the broadband, without having the fuzz of extra devices, modems and cables shattered around all over the home. LexCom Home Essential is a centralized, compact, organized and aesthetical solution for network connectivity.

Further instructions

Does it sound hard? It isn't! All information is conveniently concentrated inside the telecommunication cabinet.

There are many ways to install network connectivity. Some of them are as easy for the user to invest in as for the installer to install. This is one of those solutions. LexCom Home Essential is the perfect start, as a first simple solution.



P121683



P121683





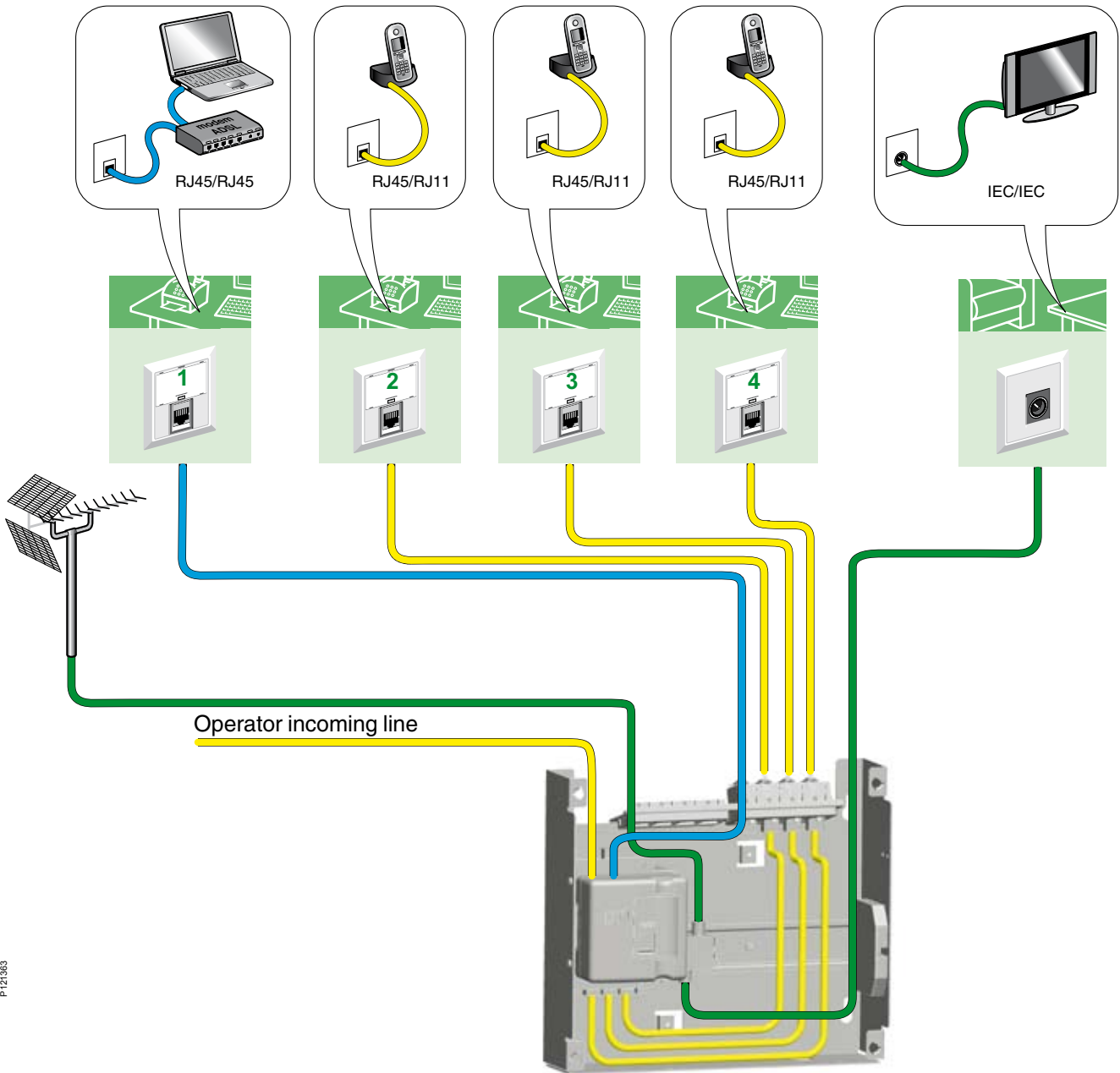

P121684

Applications and installation examples

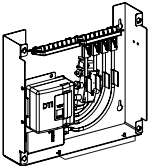
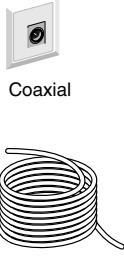

P121863

LexCom Home Essential components

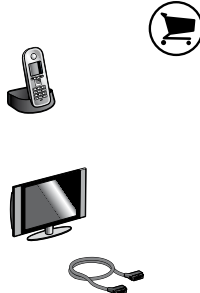
 <p>VDIR390010</p>	 <p>Coaxial</p> <p>VDIC115118</p>	 <p>RJ45</p>	 <p>RJ45/RJ45</p> <p>0.15 m: VDIR547201 1 m: VDIR547402 2 m: VDIR547404 3 m: VDIR547405 5 m: VDIR547406</p>	 <p>RJ45/RJ11</p> <p>2 m: VDIR642102 5 m: VDIR642103</p>	
---	--	---	--	---	---

P120025, P120026, P120027, P120028

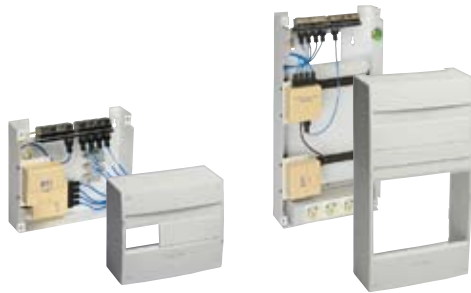

Packs

- 1 Patch panel with 4 connectors RJ45 Cat 5e FTP
- 1 ADSL Filter
- 1 Coaxial splitter - 4 outputs
- 4 Patch cords for phone application
- 1 Patch cord for ADSL signal
- Ground

Essential Pack

Allow to distribute phone & data over twisted pairs cable and video over Coaxial cables.

- 1 OPALE Cabinet, 1 row with steel back

Essential Pack XL

Allow to distribute phone & data over twisted pairs cable and video over Coaxial cables with the room for the operator box.

- 1 OPALE Cabinet, 3 rows with steel back to provide the room for the telecom operator box

Type	EAN code	Reference
Essential Pack	3606480060168	VDIR390010
Essential Pack XL	3606480060175	VDIR390020

P119787



Data

Ethernet switch

Allow to network all the IT equipments linked to the wall sockets and share the Internet access.

- Interface: 8 ports RJ45
- Speed: 10/100 Mbps Base-T
- Fit into VDIR390010, VDIR390020 and VDIR511000

Type	Dimensions	EAN code	Reference
Ethernet switch 8P 100 Mbps 8 cords	139x66x22 mm	3606480060199	VDIR323008

P119910, P119911



Telephone

ADSL Master filter

Allow to separate the Phone signal from the ADSL signal in front end of the installation.

Type	EAN code	Reference
1 input line, 1 output ADSL, 1 output Telephone	3606480185908	VDIR526001
1 input line, 2 outputs Telephone	3606480185915	VDIR526002
1 input line, 1 output ADSL, 4 outputs Telephone	3606480060212	VDIR326005

P120050



DTI with integrated Phone Splitter

Allow to connect incoming telecom operator signal, test it and split it.

Type	EAN code	Reference
DTI with integrated Phone Splitter, 4 outputs Telephone	3606480456121	VDIR326010
DTI with integrated Phone Splitter, ADSL filter, 4 outputs Telephone, 1 output ADSL	3606480456138	VDIR326020

P119789, P119783



TV-SAT distribution

TV-SAT Splitter

Dispatch the antenna signal to 2 or 3 outputs.

Type	EAN code	Reference
2 Ways TV-SAT Splitter	3606480185854	VDIR327002
4 Ways TV-SAT Splitter	3606480185861	VDIR327004

P130652, P119786



Spare parts

Connectors

Type	EAN code	Reference
Unshielded 4 keystones RJ45, Cat 5e	3606480185878	VDIR351651
Shielded 4 keystones RJ45, Cat 6	3606480186066	VDIR553661

P120045



Patch panel

- 4 Connectors RJ45, Cat 6 shielded
- Spare parts for VDIR390010, VDIR390020

Type	EAN code	Reference
Patch Panel 4 ports	3606480060243	VDIR512001

P130651



Patch cord

Type	Length	EAN code	Reference
Telephone patch cord RJ45, Cat 5e unshielded 1P	0.3 m	3606480342349	VDIR346101

P119785



Power Supply

Allow to supply the equipments within the telecommunication cabinet in electricity.

- 3 Plugs 230V - 16A
- 2 m cable - Class 2
- Solid conductor: 1.5 mm²

Type	EAN code	Reference
3 Main outlets box - power cord	3606480060229	VDIR315001

P118659



Cable

4 pair cable with general unshielded Halogen free external sheath.

- 100 Ohms, 155 MHz

Type	Length	EAN code	Reference
Cat 5e U/UTP	305 m	3606480169496	VDIC115118
Cat 5e U/UTP	500 m	3606480169502	VDIC115218

Performance

Comparison chart

	Telephone	Data (Megabit)	TV (aerial)	CATV	SAT TV	Sockets
Essential	●	100 ○	○	○	○	● x 8 ○ x 4
Performance	●	100 ●	○	○	○	● x 8*
Premium	●	1000 ●	●	●	○	● x 40

● 4 pairs cable, RJ45 socket. ○ Coaxial cable, coax socket, *x 3 signals.

The flexible multimedia choice



If your customer is accustomed to IT, interested in using modern high tech solutions and lives in an own house, this is the network to recommend. LexCom Home Performance provides full multimedia access from every outlet, thanks to the Triple play splitter. This is how it works.



Thanks to a central all-in-one unit, LexCom Home Performance allows a permanent distribution of TV, phone and data. RJ45 interfaces and balanced cables support the whole installation. Creating connectivity is very easy with LexCom Home Performance. Just connect the CATV or TV antenna, phone lines and the data switch, and the system is all set to communicate with the world.

An easy installation

You need a core unit, the cabling and connectors, and some accessories. Use the combi bracket to mount the neat metal house (the core unit) on the DIN rail, which automatically integrates it with the Pragma enclosures. The core unit can easily be fastened on a 10" VDI shelf. Connect the IDCs (insulation displacement connectors) in no time with the universal connector tool. Phone lines are selected with buttons. What's the status of amplification and signals? The system is easily checked and adjusted with the convenient test kit.

Creating Plug & Triple Play

Each LexCom Home Performance kit includes 8 links, and each link has full Triple play, so the solution provides functions equivalent to 24 outlets! Cross connectivity is never needed since all outlets support several services. It's the Triple Play Splitter which turns every outlet into a Multimedia hub. If more capacity is needed, the LexCom Home Performance is very inexpensive and easy to expand!

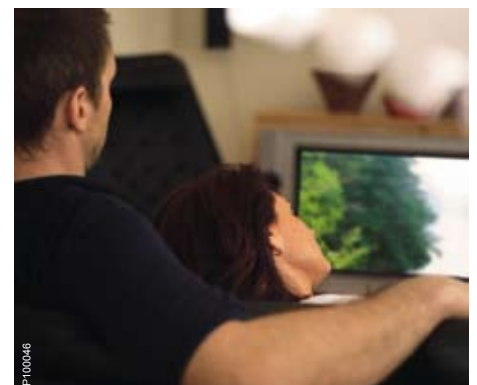
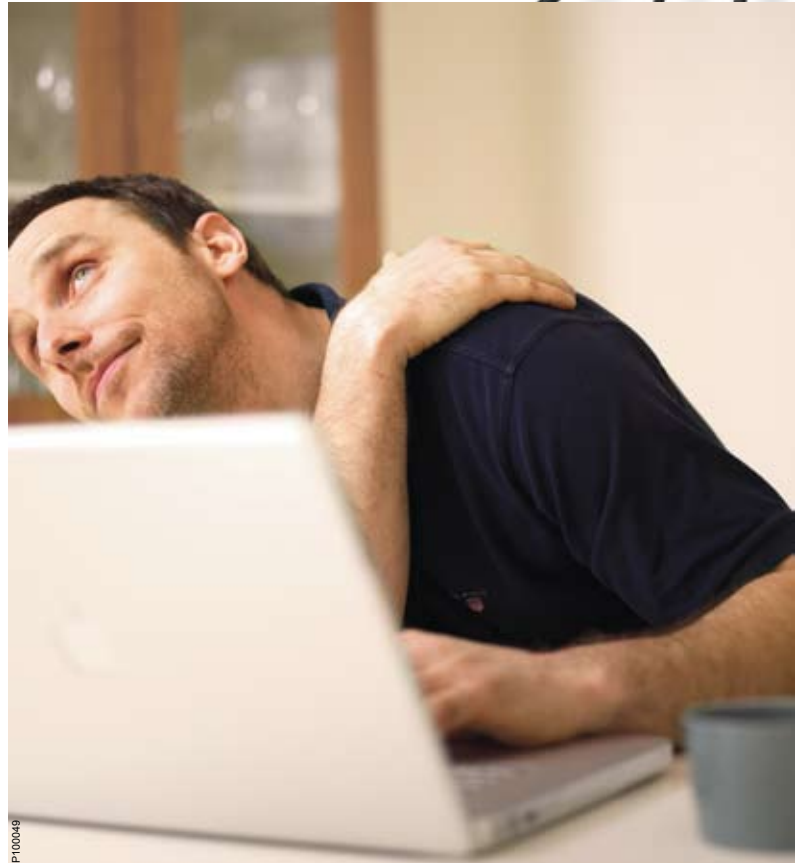

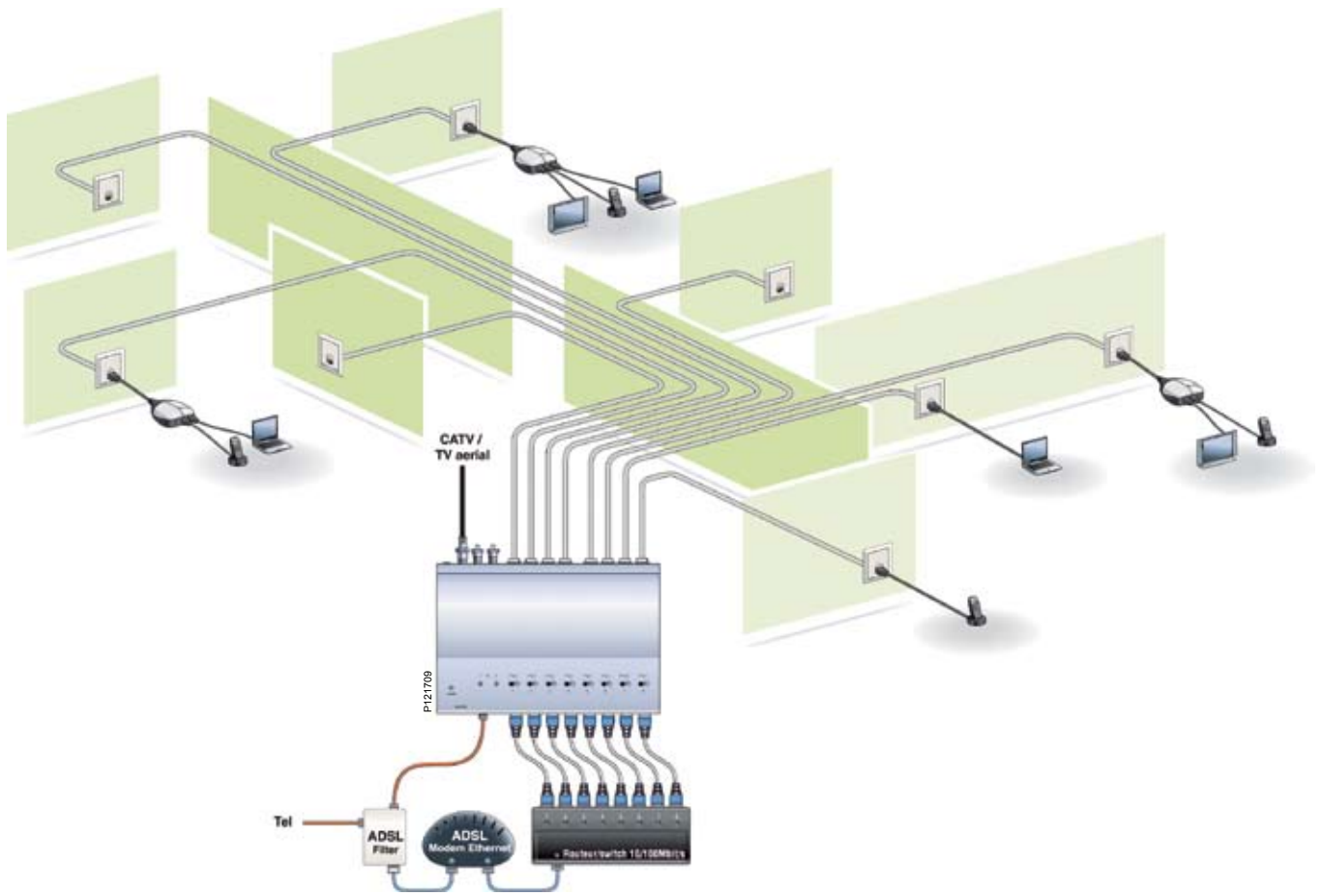

LexCom Home Performance components

Splitting outlets into three

The Triple Play Splitter turns any outlet into a Multimedia hub. So instead of having to choose if you want to use the outlet for phone, broadband or TV – you can plug in all three into the same outlet.

The box package includes power supply (12V) and connection cords for the phone line inputs.



Triple Play Splitter



R/TV connection cord

Phone connection cord

Data connection cord

Stacking cord



Applications and installation examples

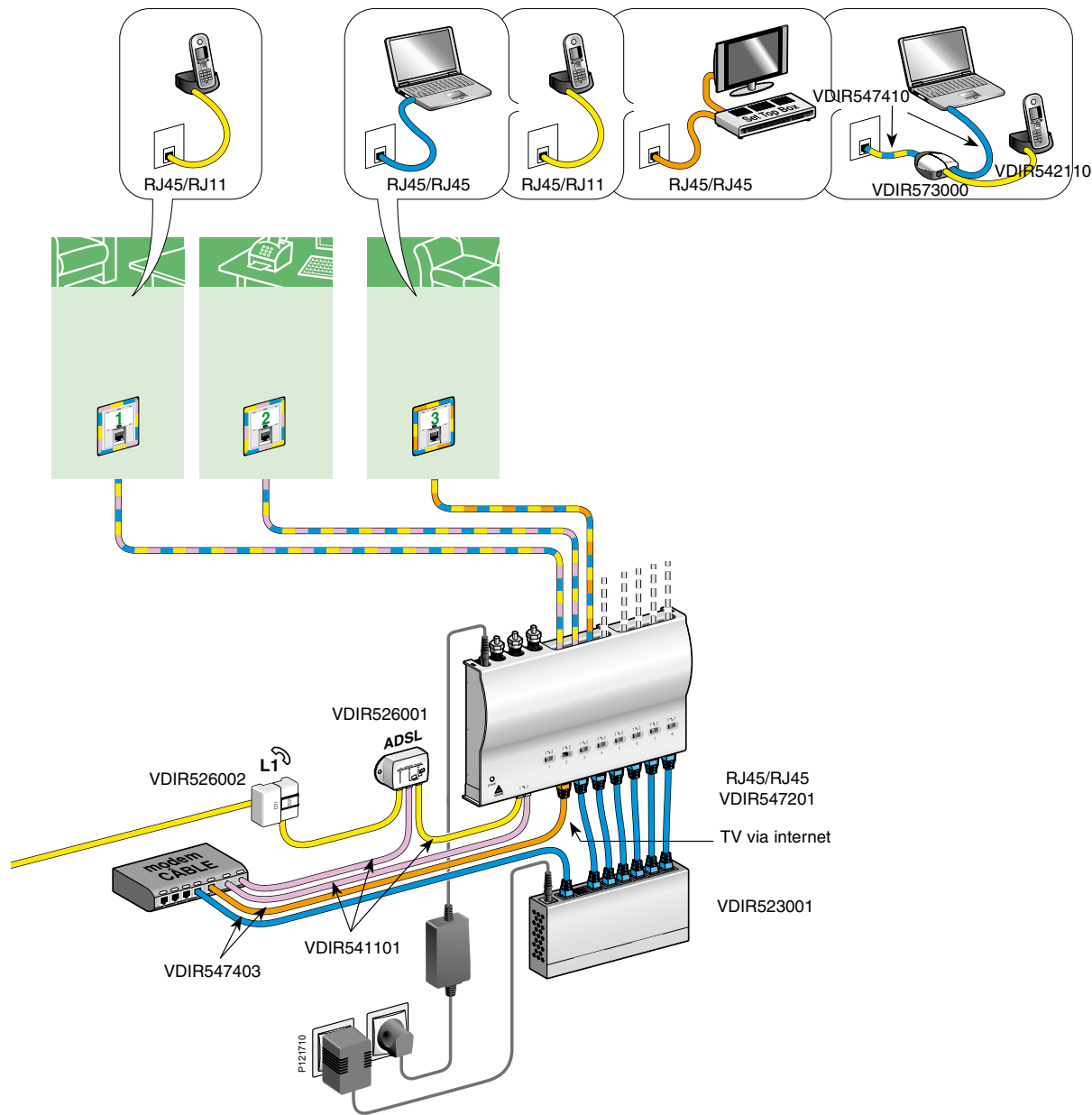

LexCom Home Performance components

<p>VDIR528000</p>	<p>VDIR523001</p> <p>RJ45/RJ45 VDIR547201 (x8)</p>	<p>VDIR534830</p> <p>RJ45</p> <p>VDIR526002</p>	<p>VDIR526001</p> <p>RJ45/RJ45</p> <p>0.15 m: VDIR547201 1 m: VDIR547402 2 m: VDIR547404 3 m: VDIR547405 5 m: VDIR547406</p>	<p>VDIR573000 VDIR593000</p> <p>RJ11/RJ45</p> <p>2 m: VDIR642102 5 m: VDIR642103</p>	<p>RJ11/RJ11</p> <p>0.3 m: VDIR541101 2 m: VDIR542110</p> <p>IEC/RJ45</p> <p>3 m: VDIR643003</p>	
-------------------	--	---	--	--	--	--

Applications and installation examples

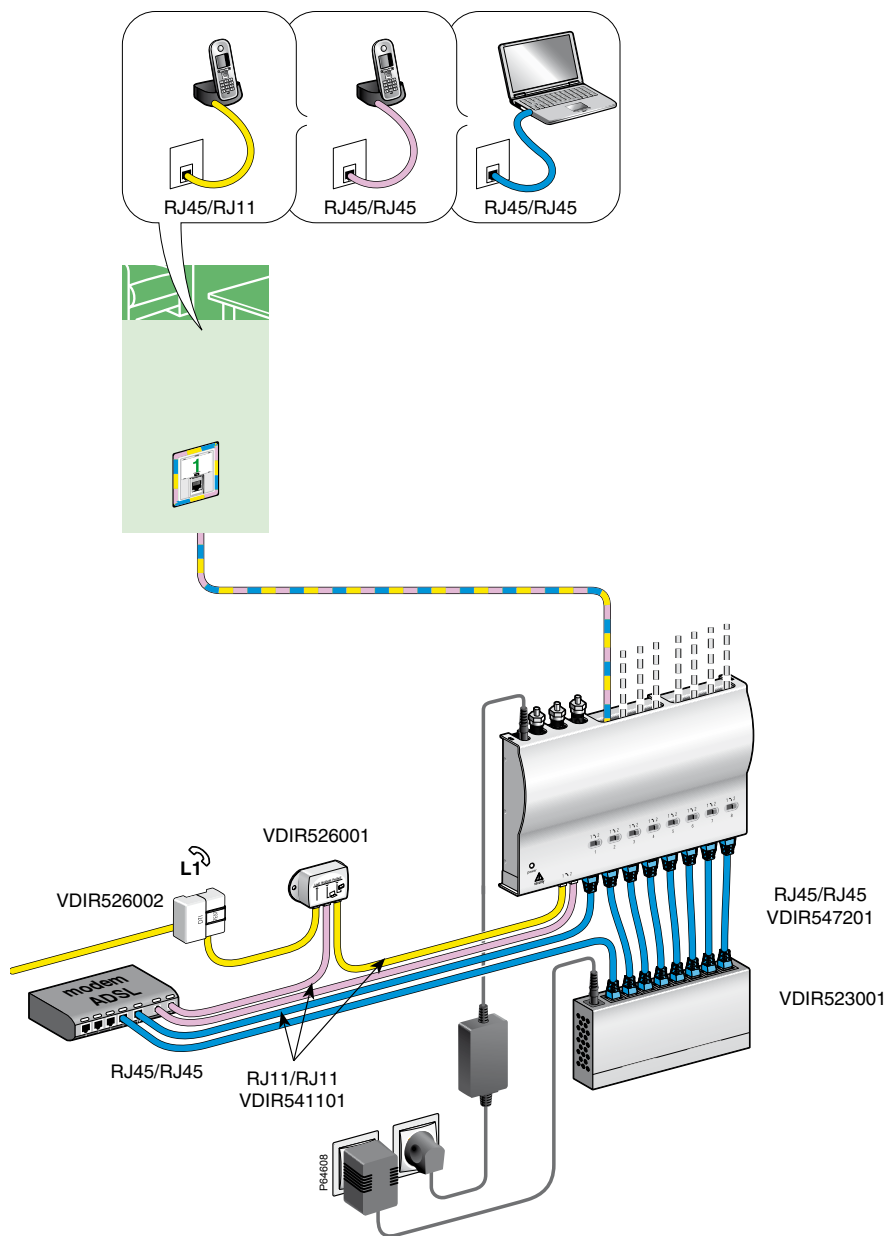

<p>VDIR528000</p>	<p>VDIR523001</p> <p>RJ45/RJ45 VDIR547201 (x8)</p>	<p>VDIR534830</p> <p>RJ45 VDIR526002</p>	<p>VDIR526001</p> <p>RJ45/RJ45 0.15 m: VDIR547201 1 m: VDIR547402 2 m: VDIR547404 3 m: VDIR547405 5 m: VDIR547406</p>	<p>VDIR573000 VDIR593000</p> <p>RJ11/RJ45 2 m: VDIR642102 5 m: VDIR642103</p>	<p>RJ11/RJ11 0.3 m: VDIR541101 2 m: VDIR542110</p>	
-------------------	--	--	---	---	--	--

P82071



Triple play distribution

Performance core unit

Heart of the system: Dispatch the antenna, phone and Internet information to the rooms.

- Connectivity: 2 RJ11 ports (for 2 phone lines)
- 1 RJ45 security (to plug a central alarm)
- 8 ports RJ45 (to plug the external switch VDIR523001)
- 8 IDC brochures (to connect a cable linked to the communication sockets)
- TV Amplification: -5 / +15 dB
- Accessories supplied: 1 power supply 12V
- 2 patch cords
- wall fixing / rail fixing

Type	Dimension	EAN code	Reference
Performance Core Unit - Europe	145x225x39 mm	3606480185922	VDIR528000
Performance Core Unit - UK	145x225x39 mm	3606480185939	VDIR528010

P120028, P120030



Packs

Performance Pack

All in One solution to distribute the antenna, phone and internet connection across a flat.

- 1 OPALE cabinet 3 rows
- 1 Power supply for the switch and the performance unit
- 1 ADSL filter
- 1 coaxial splitter 4 outputs
- 3 connection cords for communication sockets: 1 for telephone, 1 for IT, 1 for TV
- 1 Performance Core Unit - Europe

Type	EAN code	Reference
Performance Pack	3606480060182	VDIR590001

P120024, P120028



Performance Operator Cabinet Pack

Allow to put an operator box close to the communication cabinet.

- Box pack
- 3 power sockets
- 1 OPALE cabinet, 3 rows with steel back to provide the room for the telecom operator box
- To be used in addition of VDIR590001 or VDIR390010

Type	EAN code	Reference
Performance Operator Cabinet Pack	3606480060670	VDIR511000

P8578



Cables

Make the link between the enclosure modules and the wall outlets.

- Internal structure: 4 twisted pair cable - S/FTP
Cat 6 - pairs 7/8 have been tested up to 900 MHz to let TV signal pass
- Impedance: 100 Ω
- TIA color coding
- Norms: Comply to EN50083
- External: White RAL9010

Type	Length	EAN code	Reference
Performance cable S-FTP, white	120 m	3606480150975	VDIR534810
Performance cable S-FTP, white	300 m	3606480185953	VDIR534830

P81305, P119786



Connectors

Category 6 connectors

Type	EAN code	Reference
Shielded Connector, Cat 6, 10 pieces	3606485000173	VDI552012
Shielded 4 Keystones RJ45, Cat 6	3606480186066	VDIR553661

P119604



Data

Ethernet switch

Put in network all the IT equipments linked to the wall sockets and share the Internet access.

- Interface: 8 ports RJ45
- Speed: 10/100 Mbps

Type	Dimension	EAN code	Reference
Ethernet switch 8 ports	139x66x22 mm	3606480185892	VDIR523001

P119790



Data patch cord

Connect the switch to the Performance Core Unit (need 8). 2 pairs patch cord.

- Connectivity: RJ45 / RJ45
- Sheath material: Grey LSZH
- Specification: Shielded - 100 Ω

Type	Length	EAN code	Reference
Ethernet cord FTP 2P Cat 5	0.15 m	3606480185991	VDIR547201

P118427



Connection cords

Connect your IT equipments to the wall outlet - SPECIFIC EQUIPMENT FOR PERFORMANCE OFFER.

- Connectivity: RJ45 - RJ45
- Internal: Shielded - Cat 5
1/2 - 3/6 pairs connected
- External: Grey - LSZH
- Impedance: 100 Ω

Type	Length	EAN code	Reference
Connection cord data STP RJ45 2P	0.5 m	3606480186004	VDIR547402
Connection cord data STP RJ45 2P	1 m	3606480186011	VDIR547403
Connection cord data STP RJ45 2P	2 m	3606480186028	VDIR547404
Connection cord data STP RJ45 2P	3 m	3606480186035	VDIR547405
Connection cord data STP RJ45 2P	5 m	3606480186042	VDIR547406

P119792



Telephone

Expansion cord

Put in serie 2 Performance Core Units.

- Connectivity: RJ45 / RJ11
- Sheath material: Black PVC

Type	Length	EAN code	Reference
Stacking cord, black	1 m	3606480185984	VDIR542111

P119791



Patch cord

Allow to connect the ADSL Master filter to the Performance Core Unit.

Type	Length	EAN code	Reference
Tele cord RJ11-RJ11, black	0.3 m	3606480185960	VDIR541101

P83704



Connection cord

Connect your phone/fax to the wall outlet.

- Connectivity: RJ45 - RJ11
- Colour: Black

Type	Length	EAN code	Reference
Tele cord RJ11-RJ45 pair 4-5, black	2 m	3606480185977	VDIR542110

P86672



TV and Radio

Coaxial cord

Connect your AV device (TV, DVB-T decoder, cable receiver) to the wall outlet.

- Connectivity: Coaxial 9.52 mm - RJ45
- Colour: Black

Type	Length	EAN code	Reference
TV-R Coaxial cord 75-100 Ohms Balun	2 m	3606480186769	VDIR643000

P93733



Accessories

Triple play splitter Pack

Allow to get back the 3 media signals: Internet, TV and phone on a single wall outlet.

With 4 cords

- 1 splitter (VDIR573000)
- 1 connection cord for splitter - communication socket, RJ45/RJ45 - 2 m (VDIR547410)
- 1 connection cord for splitter - IT, RJ45/RJ45 - 2 m (VDIR547404)
- 1 connection cord for splitter - Phone, RJ45/RJ11 - 2 m (VDIR542110)
- 1 connection cord for splitter - TV, RJ45/Coax - 3 m (VDIR643000)

With 1 cord

- 1 splitter
- 1 connection cord for splitter - communication socket, RJ45/RJ45 - 2 m (VDIR547410)

Type	Dimension	EAN code	Reference
Triple play splitter with 4 cords	29x53.5x58.8 mm	3606480186134	VDIR593000
Triple play splitter with 1 cord	29x53.5x58.8 mm	3606480186141	VDIR593001
Triple play splitter without cord	29x53.5x58.8 mm	3606480186073	VDIR573000

P93703



Connection cord

Allow to get back the 3 media signals: Internet, TV and phone on a single wall outlet.

- Connectivity: RJ45 - RJ45
- Colour: Black

Type	Length	EAN code	Reference
Triple play cord SFTP RJ45-RJ45 2P, black	2 m	3606480186059	VDIR547410

P93715



Tools

Test kit

Simulate input signals in order to make the installation commissioning (continuity, short-circuit, connection inversion).

- 1 injector
- 1 automatic testor
- All cables and plugs needed

Type	EAN code	Reference
Test kit	3606480186097	VDIR580010

P93717



Remote test kit unit

Spare part in case of losing the initial remote unit.

- 1 remote injector

Type	Length	EAN code	Reference
Test kit remote unit- patch cord FTP	1 m	3606480186103	VDIR580011

P86655



Tool kit

Provide all the mandatory tools to install the system.

- 1 cable stripper
- 1 connecting tool
- 1 flat screw driver for gain adjustment
- 1 Phillips screw driver for fixing
- 1 key for F connector
- 1 cutting clamp

Type	EAN code	Reference
Tool kit for Performance Core Unit	3606480186110	VDIR580020

P119788



Spare parts

Power supply Performance

Provide the power supply to the Performance Core Unit.

Type	EAN code	Reference
Power supply for Performance Core Unit	3606480185885	VDIR515001

LexCom Home

Premium

Comparison chart

	Telephone	Data (Megabit)	TV (aerial)	CATV	SAT TV	Sockets
Essential	●	100	○	○	○	● x 8 ○ x 4
Performance	●	100	●	○	○	● x 8*
Premium	●	1000	●	●	○	● x 40

● 4 pairs cable, RJ45 socket. ○ Coaxial cable, coax socket, *x 3 signals.

A step further for the advanced user

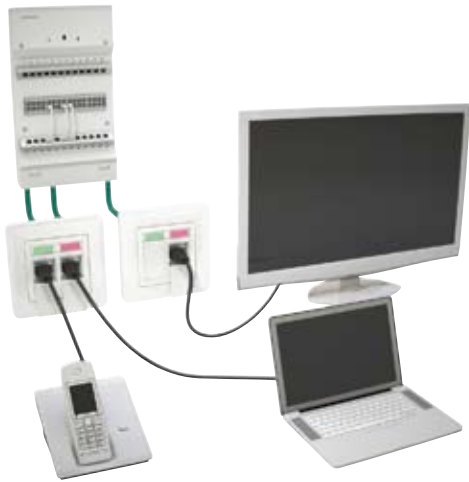

P120802

If your customer wants access to satellite TV without coax cabling, LexCom Home Premium is the choice, providing IR link technology and a maximum broad band capacity. It's a bit more exclusive than our other two networks, but the tailor-made qualities definitely makes LexCom Home Premium worth its price!

Managing the fast IT evolution and a very high gigabit rate are not the only advantages with LexCom Home Premium. This network will also untangle homes from long or excessive extension cords. If you install a couple of outlets in each room, it's just to plug in any RJ45-device in the nearest one. Every outlet can be used both for phones, television and data.

Easy to expand

The system is easy to install and expand, thanks to a well thought-out construction with many compact modules. To enhance your customers comfort, add an AV modulator and an IR link. Then the DVD or satellite receiver can be remote controlled and TV watched from any room!

This is what's needed

Decide where outlets should be placed and install them. Shielded eight wire cables lead from the outlets to the universal patch modules, with patch cables connecting the signals. All the needed modules for antenna amplifying, computer network, phones and so on, are then placed inside the distribution centre cabinet, which can be flush or surface mounted. The centre accommodates six active components and 24 patch outlets. It can't get much simpler.

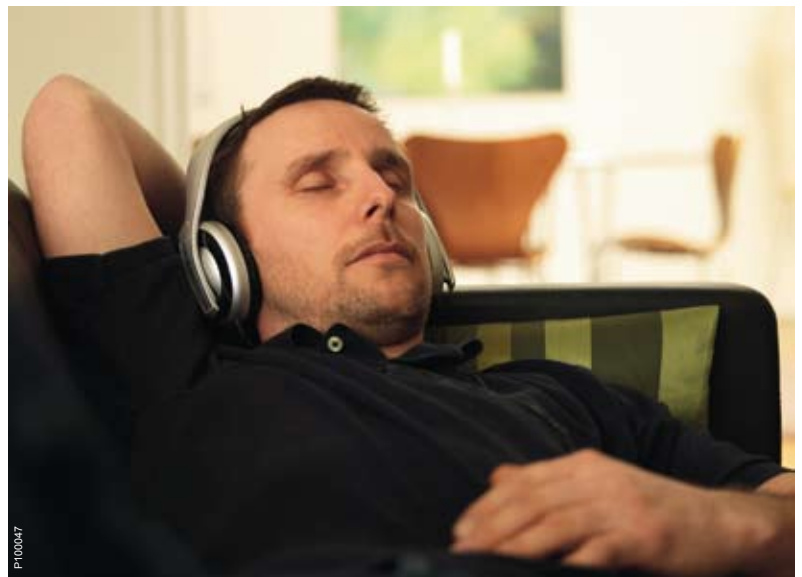

P103047



P103038



P103050

LexCom Home Premium components

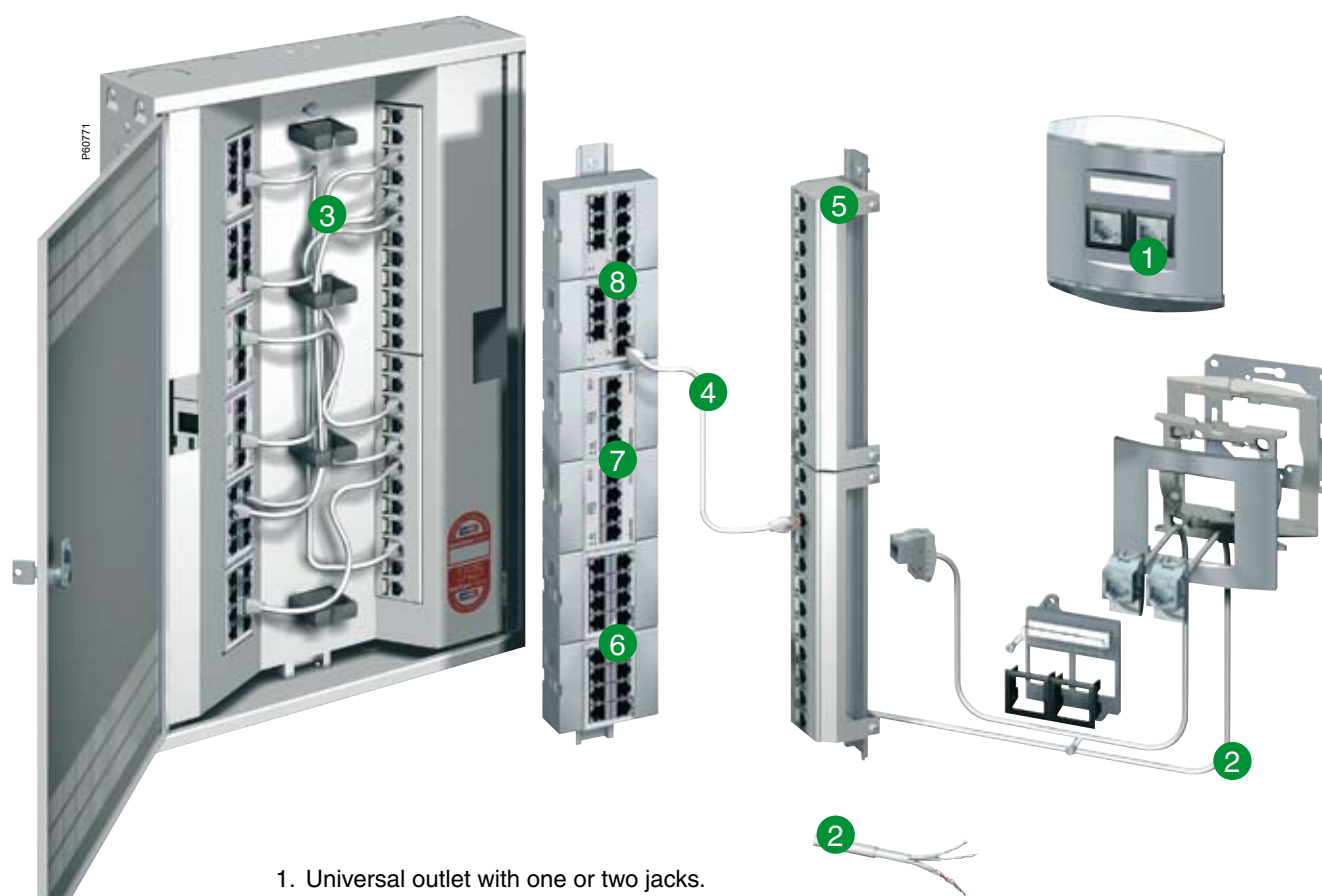

1. Universal outlet with one or two jacks.
2. Shielded installation cable, eight wires.
3. A distribution centre where incoming cables from aerial, cable TV, phone and the broadband network are connected to the home network.
4. Patch cables for simple connection of the signals to the wall outlets.
5. Universal patch modules.
6. Distribution module for eight connection points for phone/ISDN/fax/modem.
7. Switch module for computer network with four connection points.
8. Antenna amplifier for six TV connections.

Applications and installation examples

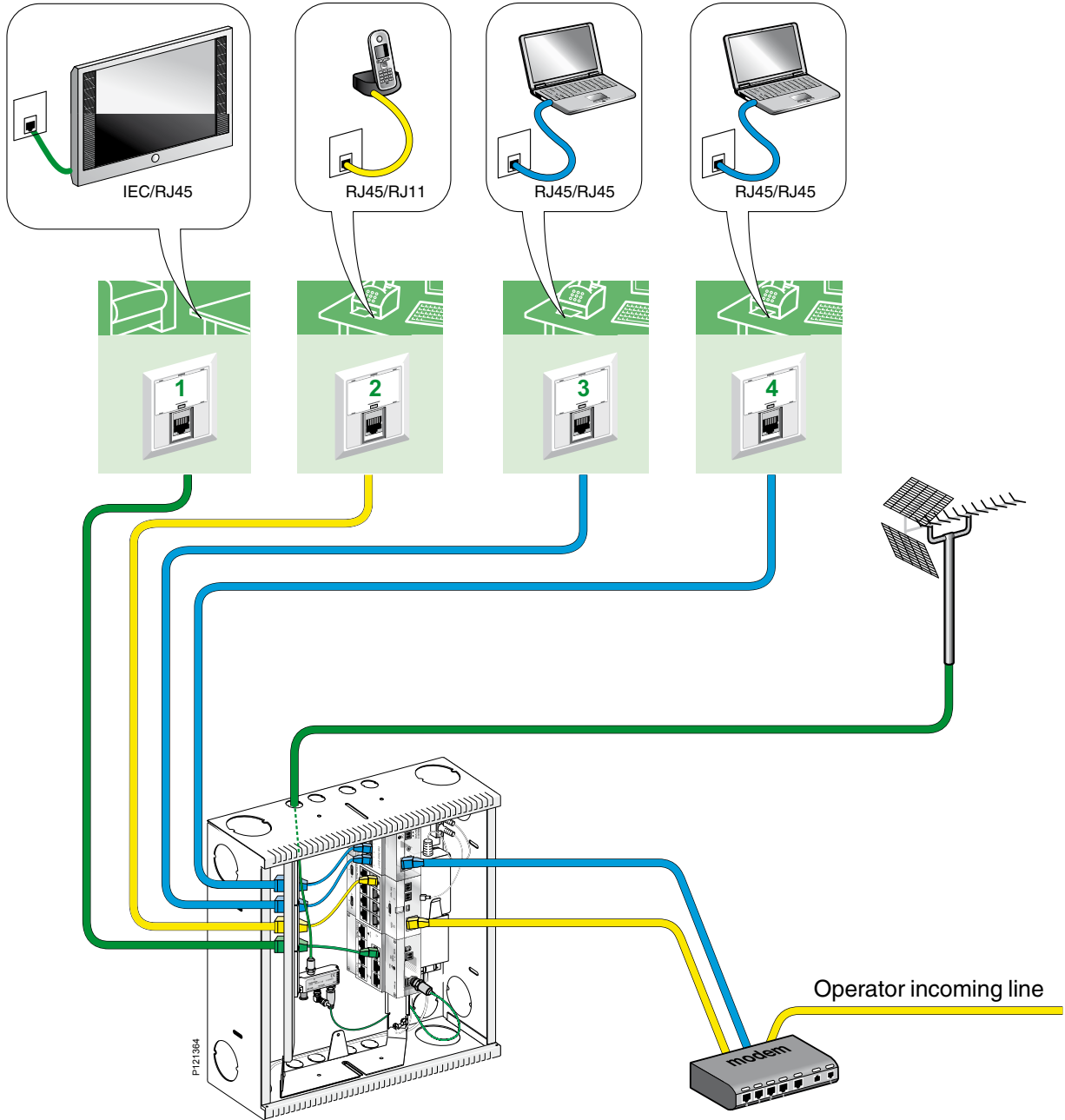





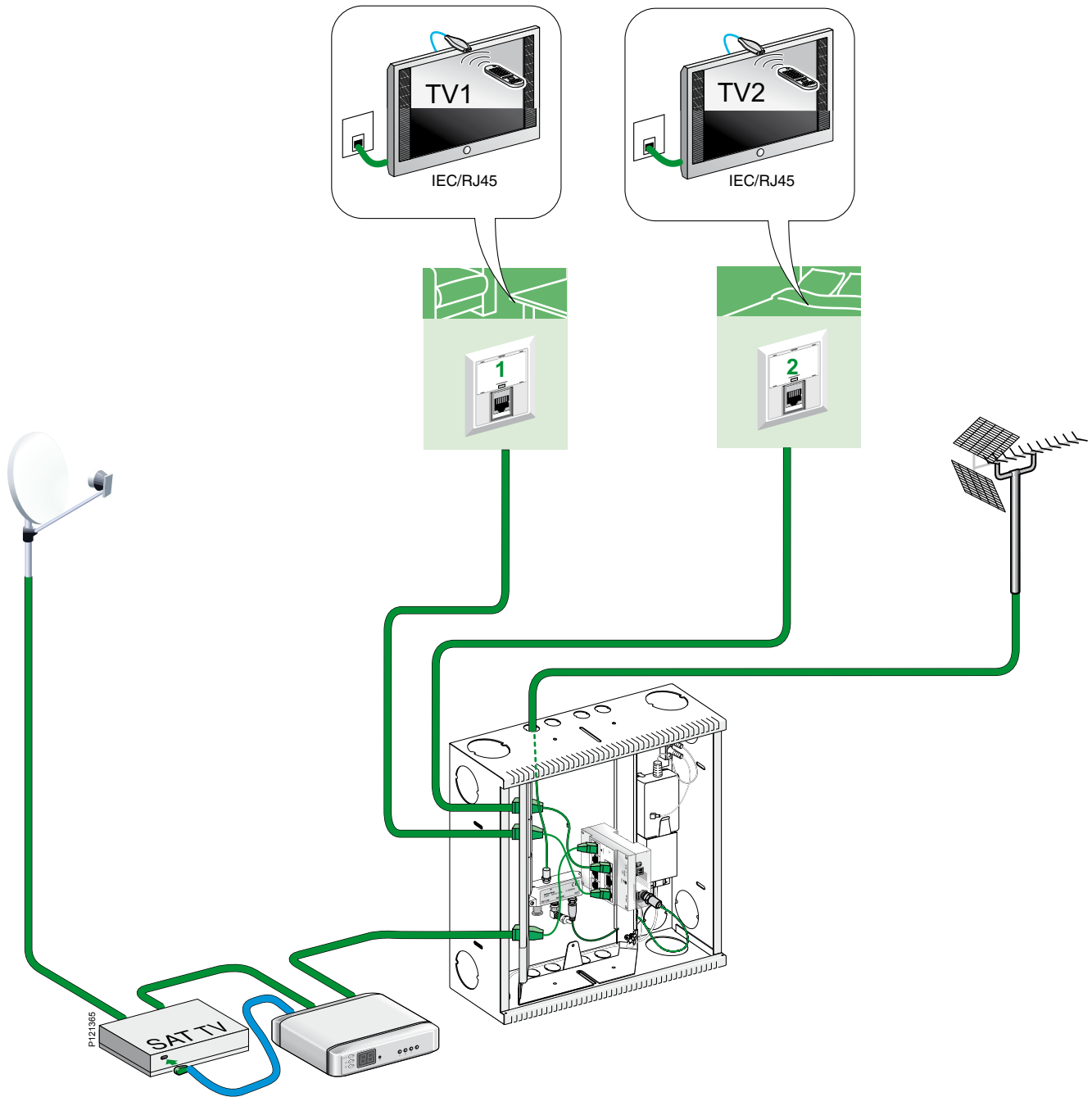

LexCom Home Premium components

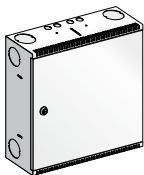
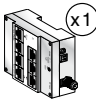
VDIR611002	VDIR62301G	VDIR627165	VDIR626100	VDIR634130	RJ45/RJ45 2 m: VDIR647103			
VDIR615004	RJ45/RJ45 0.26 m, 0.29 m, 0.32 m: VDIR647401	IEC/RJ45 3 m: VDIR643003	RJ11/RJ45 2 m: VDIR642102					

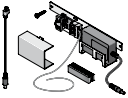
Applications and installation examples

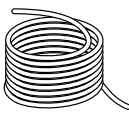

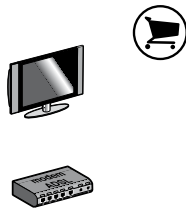
 <p>VDIR611002</p>  <p>VDIR627165 (x1)</p>  <p>VDIR673V10 (x1)</p>  <p>VDIR615004</p>	 <p>RJ45/RJ45 0.26 m, 0.29 m, 0.32 m: VDIR647401 (x1)</p>	 <p>VDIR634130</p>  <p>VDIR672104 (x2)</p>  <p>VDIR643002 (x2)</p>	
---	--	---	---

PR2573_P63221



Enclosures and accessories Apollo

Enclosure Apollo

Place to put data, phone and TV distribution modules to dispatch the signals all around the house.

- Distribution box in folded sheet steel, textured epoxy polyester powder paint, colour white RAL 9010
- Body + reversible hinged sheet steel door (180° opening)
- Vertically mounted DIN rail for active components
- Removable vertically mounted connector panel containing 26 connector positions (Direct Panel Mount)
- Cover plate with patch cord management
- Capacity up to 26 horizontal cable drops and 6 active components
- The enclosure is fully prepared for Class 1 power installation, having all units and components safely linked to ground
- Build-in CATV test point with 20 dB TAP and additional 11 dB TAP point for apartment backbone break-out
- Fitted with 0.5 m coax jumper cord for internal wiring
- Flush trim plate providing stepless depth adjustment, colour white RAL 9010
- Key holes in the rear of the enclosure for surface mounting

Type	Dimension	EAN code	Reference
Distr APOLLO 22 inch DIN-DPM, white	556x356x100 mm	3606480186165	VDIR611001
Distr APOLLO 14 inch DIN-DPM, white	356x356x100 mm	3606480186172	VDIR611002
Distr APOLLO 22 inch DIN-Slim, white		3606480186226	VDIR611007
Distr APOLLO 14 inch DIN-Slim, white		3606480186233	VDIR611008
Distr APOLLO 22 inch W/O patch panel		3606480217449	VDIR611009
Distr APOLLO 14 inch W/O patch panel		3606480217456	VDIR611010

PR4612



Power supply Apollo

Provide the power supply up to 3 modules in an Apollo enclosure.

- Power supply unit dedicated for APOLLO cabinets - 4 modules can be power supplied
- Output: 12V DC - Consumption : 20W maxi
- Maximum load: 18W
- Input: 100 - 250C DC / 50-60 Hz
- Screw less terminals for easy installation: 0.5 to 2.5 mm², solid conductor
- Class 1 isolation
- Accessories supplies: Fixing bracket, segregation cover, 5-way magazine and 3 pieces 12V jumper cords

Type	EAN code	Reference
Power supply for APOLLO - 4 outputs	3606480186462	VDIR615004

PR5061_P65062



Patch panel HD 24 ports

Receive the RJ45 connector within the telecommunication cabinet (Apollo only).

- High Density (HD) panels for the APOLLO 14" or 22" enclosures
- 2 rows of WB RJ45 connectors
- Material: Steel / Colour: White
- Provided accessories: Mounting frames (clips) to support installation of the LexCom Home WB connectors

Type	EAN code	Reference
P214 Patch Panel HD 24 Ports White	3606480186271	VDIR612004
P222 Patch Panel HD 40 Ports White	3606480186288	VDIR612005

Patch panel DIN rail

Receive the RJ45 connector within the telecommunication cabinet (DIN Rail - IBM connector only).

Type	EAN code	Reference
DIN Rail Patch Panel 12P 12RJ45 IBM	3606480187483	VDIR612011
DIN Rail Patch Panel 4P 4RJ45 IBM	3606480187476	VDIR612010
Patch panel 4 Ports Slim White DIN	3606480187490	VDIR612008
Patch panel 12 Ports Slim White DIN	3606480187506	VDIR612009

Patch panel Apollo

Receive the RJ45 connector within the telecommunication cabinet (Apollo - Slim connector only).

Type	EAN code	Reference
Patch Panel Slim 12 Ports 14"	3606480186295	VDIR612006
Patch Panel Slim 24 Ports 22"	3606480186301	VDIR612007

P118420



Trim Frames

Trim frames for flush mounting of vertical 22" and 14" steel enclosures and spare keys for the Apollo Enclosures.

- The frame will cover the edge from the cutout for the enclosure in the wall
- Stepless (floating) adjustment and latched with screws from top / bottom (inside) of the cabinet

Type	EAN code	Reference
Trim Frame 22 inch Flush Mount White	3606480186400	VDIR613010
Trim Frame 14 inch Flush Mount White	3606480186417	VDIR613011

P64606, P64608



Enclosure and accessories Formula

Enclosure Formula

Place to put data, phone and TV distribution modules to dispatch the signals all around the house.

- Surface or flush mounted Telecommunication centre for 2 patch panels P112 and 1 DIN rail in the centre position.
- Metal patch panels and DIN rails to provide strength and earthing continuity.
- Patch panels contains 12 ports each (24 ports max for the cabinet). DIN rail has space for 3 active modules.
- The patch panels are angled towards the centre DIN rail to provide good installation conditions and reduce stress to the patch cables.
- Colour: White or grey

Type	EAN code	Reference
Distrib FORMULA Surf-wb White	3606480186189	VDIR611003
Distrib FORMULA Surf-wb Grey	3606480186196	VDIR611004
Distrib FORMULA Flush-WB White	3606480186202	VDIR611005

P120012



Power Supply Formula

Provide the power supply up to 3 modules in a Formula enclosure.

- Power Supply Unit dedicated for FORMULA cabinets - 3 modules can be power supplied
- Output: 12V DC - Consumption: 20W maxi.
- Maximum Load : 18W
- Input: 100 - 250C DC / 50-60 Hz
- Screw less terminals for easy installation: 0.5 to 2.5 mm², solid conductor
- Class 1 isolation
- Accessories supplies : Fixing bracket, segregation cover, 5-way magazine and 3 pieces 12V jumper cords

Type	EAN code	Reference
Power Supply for FORMULA - 3 Outputs	3606480186455	VDIR615003

P63848



Patch panel 12 ports

Receive the RJ45 connector within the telecommunication cabinet (DIN Rail)

- Designed for FORMULA enclosures only
- Width: 13 DIN units (13 x 18mm) on the DIN rail
- Height: 25 mm
- 12 x RJ45 ports WB Connector
- 45° angle to ensure optimal protection and access for the patch cords
- Silver / Material: Steel

Type	EAN code	Reference
P112 Patch Panel 12 Ports Silver	3606480186257	VDIR612002

P118423, P118422, P118421



Formula mounting accessories

Type	EAN code	Reference
Link Bracket Flush Horizontal	3606480186318	VDIR613001
Link Bracket Flush Vertical White	3606480186332	VDIR613003
Wall Brackets Flush Wall 6-30mm	3606480186349	VDIR613004

P63847



Standard DIN Rail Enclosures

Patch panel 12 ports

Receive the RJ45 connector within the telecommunication cabinet (Formula). Designed for standard DIN enclosures, provided that the uplift unit are included.

- Width: 13 DIN units (13 x 18mm) on the DIN rail
- Height: 25 mm
- 12 x RJ45 ports WB Connector
- 45° angle to ensure optimal protection and access for the patch cords
- Colour: White / Material : Steel

Type	EAN code	Reference
P113 Patch Panel 12 Ports White	3606480186264	VDIR612003

P63846



Patch panel 5 ports

Receive the RJ45 connector within the telecommunication cabinet (DIN Rail). Designed for standard DIN enclosures, provided that the uplift unit are included.

- Width: 6 DIN units (6 x 18 mm) on the DIN rail
- Height: 25 mm
- 5 x RJ45 ports WB Connector
- 45° angle to ensure optimal protection and access for the patch cords
- Colour: White RAL9003 / Material: Steel

Type	EAN code	Reference
P106 Patch Panel 5 Ports White	3606480186240	VDIR612001

P64614

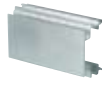

UP-Lift Unit

Up lift unit to enable LexCom Home modules to be installed in any standard DIN enclosure.

- When an active LexCom Home module is mounted on an up-lift unit, it complies to the standard DIN dimension (height).
- Support 1 module
- Earthing link

Type	Dimension	EAN code	Reference
Up-Lift Unit 1 DIN for Std cabinets	69x25x43 mm	3606480186424	VDIR613012

P64613



Common accessories

Blind Cover

Blind cover to use when the maximum capacity of the telecommunication cabinet has not been reached.

- Identical width to an enclosure module width
- Color: White or grey

Type	EAN code	Reference
Blind Cover 1 Module Grey	3606480186356	VDIR613005
Blind Cover 1 Module White	3606480186363	VDIR613006

PR3189



Infrastructure

Cables and Connectors

Cables

Make the link between the enclosure modules and the wall outlets.

- S/STP Structure: Each pair is individually shielded in a metal foil and all pairs together covered by a tinned copper wire braid
- Bandwidth: 0 - 900 MHz (CATV compatible)
- Unique Color Coding matching with the wire map of the connector
- NEXT: 86 dB @ 100 MHz
78 dB @ 300 MHz
71 dB @ 800 MHz
- Impedance: 100 Ω
- Bending Radius: min 3x diameter
- Diameter: 7.5 mm
- LSZH material

Type	Length	EAN code	Reference
Cable S-STP 4 Pairs LSFROH White	300 m - reel	3606480186615	VDIR634130
Cable S-STP 4 Pairs LSFROH White	500 m - reel	3606480186622	VDIR634150

P118416



Cables in Preflex tube

Make the link between the enclosure modules and the wall outlets.

- S/STP Structure - Each pair is individually shielded in a metal foil and all pairs together covered by a tinned copper wire braid
- 1 or 2 Cables in Preflex Tube
- Bandwidth: 0 - 900 MHz (CATV compatible)
- NEXT: 86 dB @ 100 MHz
78 dB @ 300 MHz
71 dB @ 800 MHz
- Impedance: 100 Ω
- Bending Radius: min 3x diameter
- Diameter: 7.5 mm
- TIA color coding
- LSZH material

Type	Length	EAN code	Reference
1 Cable in Tube S-STP 4P LSFROH 16 mm	100 m - reel	3606480186608	VDIR63411F

P60406, P111195



WB Connector

Tool less Wide Band STP connector.

Provide in the home installation a Cat 6 link. Very good transmission quality for CATV signals up to 900 MHz. International colour coding.

- Bandwidth: 0-900 MHz (CATV)
0-250 MHz (Cat 6)

Type	EAN code	Reference
Shielded WB Connector RJ45, Wideband DPM	3606480186974	VDIR651601
Shielded WB Connector RJ45, Wideband DPM, 500 pieces	3606480186981	VDIR651602
Shielded Connector, Cat 6, 10 pieces	3606485000173	VDI552012

Multimedia Packs

Data

Data Switch

Allow to network all the IT equipments linked to the wall sockets and share the Internet access.

- Connectivity: 1 RJ45 input
4 RJ45 output
- Speed: 1 Gbps Base-T
- Power Supply: 12V DC - 3.5 W
- Signaling LED: Data Link, Data Speed, Power

Type	Dimension	EAN code	Reference
Data Switch S1000-T 4&1Ports 100M-1G bps	72x37x86 mm	3606480186479	VDIR62301G

Data Switch

Allow to network all the IT equipments linked to the wall sockets and share the Internet access.

- Connectivity: 1 RJ45 input
4 RJ45 output
- Speed: 10/100 Mbps Base-T
- Power Supply: 12V DC - 2.4 W
- Signaling LED: Data Link, Data Speed, Power

Type	Dimension	EAN code	Reference
Data Switch S101-T 4&1Ports 10-100 Mbps	72x37x86 mm	3606480060687	VDIR623101

Data Connection Cord

Connect your IT equipments to the wall outlet.

- UTP structure for Cat5E application: slim & very flexible
- Connectivity - RJ45/RJ45
- Can also be used in the cabinet for phone/data application: Color coding clips to ensure correct patching

Type	Length	EAN code	Reference
Patch Cord Data-Tele UTP RJ45	1 m	3606480186868	VDIR647102
Patch Cord Data-Tele UTP RJ45	2 m	3606480186875	VDIR647103
Patch Cord Data-Tele UTP RJ45	3 m	3606480186882	VDIR647104
Patch Cord Data-Tele UTP RJ45	5 m	3606480186899	VDIR647105

Telephone

Telephone Line Splitter - 2 Lines

Dispatch the 1 or 2 analog phone lines or one S0 bus with 1 analog line over up to 8 outlets.

- Connectivity: Input : 1 RJ45 STP for ISDN/ADSL, 2 screws terminals for 2 analog lines
Output : 8 RJ45 STP
- Configuration with 3 switches (8 configurations)

Type	Dimension	EAN code	Reference
Tele Module T100 - 8 Ports	72x37x86 mm	3606480186486	VDIR626100

Telephone Connection Cord

Connect your phone to the wall outlet - To be used with T100 Module.

- Unshielded cable
- Connectivity: RJ11/RJ45

Type	Length	EAN code	Reference
Tele Cord RJ11-RJ45 Line 1 Silver	2 m	3606480186684	VDIR642102
Tele Cord RJ11-RJ45 Line 1 Silver	5 m	3606480186691	VDIR642103

ADSL Adapter

Allow plug on a wall outlet the ADSL Modem.

- Must be used with the T100 Telephone module
- Enables to distribute to an ADSL modem the ADSL signal from the T100
- Enables to distribute the analogue telephone line outputs from an ISDN modem to all communications sockets
- Provided accessories: 3 cords (2 RJ11/RJ11 + 1 RJ45/RJ45)
- A standard tele/data patch cord must be used to connect the adapter box to the ISDN line from the wall outlet

Type	EAN code	Reference
Tele Adapter B100 for ISDN-FAX	3606480187070	VDIR673001

Telephone Line Splitter

Dispatch up to 4 phones lines over 8 outlets (Need to use specific connection cords).

- Telephone module for 1 to 4 analogue phone lines
- Input: 4 connectors for operators lines
- Output: 8 RJ45 ports.
- All 4 lines are distributed using dedicated pairs. At the wall outlet, dedicated connection cords for line 1, 2, 3 and 4 are necessary

Type	Dimension	EAN code	Reference
Tele Module T104 - 8Ports	72x37x86 mm	3606480186509	VDIR626104

P111225



P111214



P81145



P80756



P81875



P80762



P79818



P81876, P81877, P81878



Telephone Connection Cords for T104

Connect your phone to the wall outlet. To be used with T104 module only.

- Unshielded cables.
- Connectivity: RJ11/RJ45

Type	Length	EAN code	Reference
Tele Cord RJ11-RJ45 Line 2 Purple	2 m	3606480186707	VDIR642104
Tele Cord RJ11-RJ45 Line 2 White	2 m	3606480186721	VDIR642106
Tele Cord RJ11-RJ45 Line 2 White	5 m	3606480186738	VDIR642107
Tele Cord RJ11-RJ45 Line 2 Red	2 m	3606480186745	VDIR642108
Tele Cord RJ11-RJ45 Line 2 Red	5 m	3606480186752	VDIR642109

P83145



Telephone Line Splitter - ISDN

Distribute the S0 signal up to 8 outlets (short passive bus).

- Telephone module for ISDN
- Input: 1 RJ45
- Output: 8 RJ45 ports

Type	Dimension	EAN code	Reference
Tele Module T110 - ISDN - 8 Ports DIN	72x37x86 mm	3606480186530	VDIR626110

P81880



Telephone Connection Cord for T110

Connect your 2 ISDN lines to the wall outlet - To be used with T110 ISDN Module.

- Unshielded cable
- Connectivity: RJ11/RJ45

Type	Length	EAN code	Reference
Tele Cord RJ11-RJ45 Lines 1&2 Black	2 m	3606480186660	VDIR642100
Tele Cord RJ11-RJ45 Lines 1&2 Black	5 m	3606480186677	VDIR642101

P77768



Telephone Module - British Telecom

Dispatch 2 individual phones lines (British Telecom Specific).

- Telephone module to distribute 2 individual telephone lines: British Telecom Specific

Type	Dimension	EAN code	Reference
Tele Module T101- BT Second. - 8 Ports	72x37x86 mm	3606480186493	VDIR626101

P109874, P109878, P109875



TV and Radio

TV and Radio Modules

Dispatch the TV antenna signals over 6 outlets and re-distribute the AV signals from AV modulators.

- Input power: 12V DC - 6W max
- Output Level: 6 x 108 dBμV
- CSO: 88 dBμV (42 channels)
- Gain: 27 ± 2 dB
- Attenuation: 0-20 dB (adjustable)
- Return Gain: 5 dB
- AV entry level: 60-80 dBμV

A111-00

- Connectivity: 7 RJ45 STP output (2 return paths, 1 AV link)
1 IR link output
1 RF input: F-Type connector

- Bandwidth: 42 - 860 MHz

A111-30

- Connectivity: 7 RJ45 output (2 return paths, 1 AV link)
1 RF input: F-Type connector

- Bandwidth: 47 - 860 MHz
- Return Path: 5-30 MHz

A111-65

- Connectivity: 7 RJ45 STP output (2 return path, 1 AV link)
1 IR link outputs
1 RF input : F-Type connector

- Bandwidth: 85 - 860 MHz
- Return Path: 5-65 MHz

Type	Dimension	EAN code	Reference
R-TV Module A111-00 - 6&1Ports DIN	72x37x86 mm	3606480186547	VDIR627100
R-TV Module A111-30 - 6&1Ports DIN	72x37x86 mm	3606480186554	VDIR627130
R-TV Module A111-65 - 6&1Ports DIN	72x37x86 mm	3606480186561	VDIR627165

P85600



Enclosure - Patch Cords S-STP

Connect inside the telecommunication cabinet the enclosure modules to the patch panel. Order the same number as the number of wall outlet connected.

- Exclusively dedicated to use inside the communication cabinet between active modules and patch panels
- Compliant with all application: TV, Radio, Data, Phone
- Cat6 STP
- Material: LSZH
- Sheath: Light Grey (RAL7035)

Type	Length	EAN code	Reference
Patch Cord S-STP 3 Lengths TV-Data-Tel	26, 29, 32 cm	3606480186912	VDIR647401
Patch Cord S-STP TV-Data-Tel	0.5 m	3606480186929	VDIR647402

P85675, P85674



Connection - TV and Radio Cord with IR Link

Connect a TV or an audio tuner to a wall outlet, and allow to pilot a AV sourcing remotely.

- Double shielding with IR Link
- Bandwidth: 1 - 862 MHz
- Connectivity: RJ45 - IEC Male 9,52 mm
- Impedance (Input): RJ45 - 100 Ω
- Impedance (Output): Coaxial - 75 Ω
- Sheath: White or black
- Adapter included in each blister package for Radio (female)

Type	Length	EAN code	Reference
TV-R Cord XU110 IR Link Balun White	3 m	3606480186776	VDIR643001
TV-R Cord XU110 IR Link Balun Black	3 m	3606480186783	VDIR643002

P85673



Connection - TV and Radio Connection Cord

Connect a TV or an audio tuner to a wall outlet.

- Double shielding
- Bandwidth: 1 - 862 MHz
- Connectivity: RJ45 - IEC Male 9.52 mm
- Impedance (Input): RJ45 - 100 Ω
- Impedance (Output): Coaxial - 75 Ω
- Sheath: Black
- Adapter included in each blister package for Radio (female)

Type	Length	EAN code	Reference
TV-R Cord XU100 75-100 Balun Black	3 m	3606480186790	VDIR643003

P85675, P85672



Connection - Radio Connection Cord

Connect an audio tuner to a wall outlet.

- Bandwidth: 86 - 109 MHz
- Connectivity: RJ45 - IEC Female 9,52 mm
- Impedance (Input): RJ45 - 100 Ω
- Impedance (Output): Coaxial - 75 Ω
- Sheath: White or black

Type	Length	EAN code	Reference
R Cord XR110 FM Pass Balun White	3 m	3606480186806	VDIR643004
R Cord XR110 FM Pass Balun Black	3 m	3606480186813	VDIR643005

P75597



TV and Radio Accessories

Coax Splitter

Split the antenna signal to 2 outputs.

- To be installed in the LexCom Home Apollo cabinets when 2 pcs TV/R amplifiers are installed - sharing the incoming TV signal
- The kit comprises a 2-way coax splitter unit and 2 pcs of jumper cords supporting all coaxial interconnections inside the cabinet
- The jumper cords supplied are pre-terminated with F-male connectors enabling plug-and-play installation. Supplied with all necessary fixing accessories

Type	EAN code	Reference
Coax Splitter 2 Ways 3.5 Db	3606480186431	VDIR613013

P83530



Termination Plug

Prevent from having interferences when RJ45 plugs of enclosure modules are not connected to an outlet.

- Impedance: 100 Ω per pairs (R/TV/AV)

Type	EAN code	Reference
Termination Plug RJ45 100 Ohms STP	3606480186905	VDIR647201

P118426



Attenuators

Plug-in unit for outlets to compensate for short link problems on TV signals.

- Supports only distribution of R/TV signals and the AV / IR link
- Attenuation: 5, 10 or 15 dB @ 800 MHz

Type	EAN code	Reference
Attenuator ITA05 5 dB 100 Ohms RJ45	3606480186820	VDIR647001
Attenuator ITA10 10 dB 100 Ohms RJ45	3606480186837	VDIR647002
Attenuator ITA15 15 dB 100 Ohms RJ45	3606480186844	VDIR647003

P.69970



Audio Video Distribution

Audio modulator

Allow to redistribute an audio source (PC for example) to an audio amplifier.

- Connectivity: 2 RCA L/R for connecting the stereo source
1 RJ45 for connecting to communication socket
1 jack for IR receiver to control remotely the source
- Power Supply: 12V DC - 70mA max
- Frequency band: 89 - 106 MHz
- Output: 84 selectable preset channels
- Accessories: Connection cord + Power supply
- Colour: Black

Type	Dimension	EAN code	Reference
PC Player PCP110	169x84x49 mm	3606480187087	VDIR673002

P.116954



Audio-Video modulator

Allow to redistribute any video or audio source (DVD, Cable receiver, SAT receiver, IP decoder, Multimedia PC)

- Connectivity: 4 x 3 RCA L/R + Composite for connecting up to 4 audio-video sources
1 RJ45 for connecting to communication socket
4 jack for IR receiver to control remotely the sources
- Power Supply: 12V DC - 500mA max
- Frequency band: UHF 471,25 - 879,25 MHz
- Output: up to 49 Selectable preset channels
- Accessories: Connection cord + Power supply
- Colour: Silver
- Supports all European PAL TV standards (B, L, I and D)

Type	EAN code	Reference
AV Modulator AV211-4	3606480187162	VDIR673V10

P.81879



Audio Video Modulator Connection Cord

Connect your AV Modulator to the wall outlet.

- Double shielding patch cord to connect Audio Video modulators to the communication sockets.
- Connectivity RJ45 to RJ45 interface.
- Sheath: Light Grey

Type	Length	EAN code	Reference
AV Cord S-STP RJ45-RJ45 100 Ohms	2 m	3606480186950	VDIR647412
AV Cord S-STP RJ45-RJ45 100 Ohms	3 m	3606480186967	VDIR647413

P.83169



AV Combiner

Allow to couple 3 modulators within the system.

- Connectivity: 4 RJ45 sockets
- DIN Rail
- Bandwidth: 80 MHz - 862 MHz
- Insertion Loss: Max 8 dB @ 862 MHz; Min 6.5 dB @ 470 MHz
- Infrared link supported
- Supplied accessories: 1 termination plug on one unused entry

Type	Dimension	EAN code	Reference
AV Combiner C110-3 - 3 Ways	72x37x86 mm	3606480187094	VDIR673003

P.1002701



AV Combiner

Allow to couple 2 modulators within the system.

- Connectivity: 3 RJ45 sockets
- Bandwith: 80 MHz - 862 MHz
- Insertion Loss: Max 8 dB @ 862 MHz; Min 6.5 dB @ 470 MHz
- Infrared link supported
- Supplied accessories: 1 termination plug on one unused entry

Type	EAN code	Reference
AV Combiner C110-2 - 2 Ways	3606480187100	VDIR673004

P69520, P118418



Infra-Red Remote Control Transmission - IR Link

IR Receiver and Emitter Pack

Control remotely the AV sources.

- Pack to be used with the AV modulator (AVxxx) and the Antenna Amplifier (A111-xx)
- The receiver is put close to the 2nd TV, and is connected through the R/TV IR link connection cord
- The IR eye of the emitter is stuck over the IR lens of the AV source, and is linked to the AV modulator or the Antenna module
- Compatibility: All infrared red remote control of the market (35 - 500 kHz)
- Capacity: Up to 6 receivers for the LexCom Home Systems
- Range: 8 m / 50° angle
- Power Supply: 10V DC - 0,1W
- Connectivity: Jack 2.5 mm
- Length: 2.8 m
- Colour: Silver

Type	EAN code	Reference
IR Link Receiver - Emitter, silver	3606480187025	VDIR672101
IR Link Receiver - Emitter, black	3606480187056	VDIR672104

P69860



IR Emitter

Control remotely the AV sources (Emitter Only).

- Emitter to be used with the AV modulator (AVxxx) and the Antenna Amplifier (A111-xx) for controlling additional sources
- The IR eye of the emitter is stuck over the IR lens of the AV source, and is linked to the AV modulator or the Antenna module
- Compatibility: All infrared red remote controls of the market (35 - 500 kHz)
- Power Supply: 10V DC - 0,1W
- Connectivity: Jack 2.5 mm
- Length: 2.8 m

Type	EAN code	Reference
IR Emitter	3606480187049	VDIR672103

P60735, P118417



IR Receiver

Control remotely the AV sources.

- The receiver is put close to the additional TV, and is connected through the R/TV IR link connection cord
- Compatibility: All infrared red remote control of the market (35 - 500 kHz)
- Capacity: Up to 6 receivers for the LexCom Home Systems
- Range: 8m / 50° angle
- Power Supply: 10V DC - 0,1W
- Connectivity: Jack 2.5 mm
- Length: 2.8 m
- Colour: Silver or black

Type	EAN code	Reference
IR Receiver , silver	3606480187032	VDIR672102
IR Receiver, black	3606480187063	VDIR672105

P68854, P102703



Bang & Olufsen

Audio-Video distribution Bang & Olufsen

- Use Bang & Olufsen Master Link application over your home network
- Impedance: 100 Ω
- Connectivity: 8 RJ45 STP output
1 RJ45 STP for stacking 2 modules

BO100-ML

Ensure the link between Bang & Olufsen Audio-Video equipments.

BO103-PL

Ensure the link between an audio source (2, 1) and speakers from Bang & Olufsen.

- Dolby Surround Sound

Type	Dimension	Reference
Master Link Module BO100-ML 8Ports	72x37x86 mm	3606480186578 VDIR629001
Power Link Module BO103-PL Surround LXH	72x37x86 mm	3606480186592 VDIR629003

P60250



Tools

Cable stripper

Allow to strip the cable without damaging the shielding.

- Adapt to the thickness of the sheath

Type	EAN code	Reference
Cable Stripper	3606480186127	VDIR580021

Spare parts

P118419



Door keys

Spare keys for the Apollo Enclosure

Type	EAN code	Reference
Door Key - Set of 2 keys for APOLLO	3606480186448	VDIR613014

P65004



Connector

2-pole screw terminal female plug to use at the enclosure active modules for power supply connectivity.

- To use when the LexCom Home system is installed in a generic adaptation and a different DIN power supply is used
- Connector with a mechanical keyway

Type	EAN code	Reference
Connector 2 Poles Screw Terminal	3606480186394	VDIR613009

P60775



Icon sheets

Icon Sheets for Outlets.

Type	EAN code	Reference
Icon Sheets for Outlets	3606480187018	VDIR671102

Conversion list

Former non Schneider-Electric reference numbers

Former non Schneider-Electric Ref. No.	New Schneider-Electric Ref. No.	Former Schneider-Electric Ref. No.	New Schneider-Electric Ref. No.
306140005	VDIR611001	306460007	VDIR647002
306140006	VDIR611002	306460008	VDIR647003
306140007	VDIR611003	306460009	VDIR647412
306140008	VDIR611004	306460010	VDIR647413
306140009	VDIR611005	306460012	VDIR647102
306140013	VDIR611009	306460013	VDIR647103
306140014	VDIR611010	306460014	VDIR647104
306140015	VDIR611007	306460015	VDIR647105
306140016	VDIR611008	306460016	VDIR642104
306160002	VDIR612002	306460017	VDIR642105
306160003	VDIR612001	306460018	VDIR642106
306160004	VDIR612003	306460019	VDIR642107
306160005	VDIR612004	306460020	VDIR642108
306160006	VDIR612005	306460021	VDIR642109
306160009	VDIR612006	306460022	VDIR642102
306160010	VDIR612007	306460023	VDIR642103
306170001	VDIR613001	306460027	VDIR643001
306170003	VDIR613003	306460028	VDIR643004
306170004	VDIR613004	306460029	VDIR643002
306170005	VDIR613005	306460030	VDIR643005
306170006	VDIR613006	306460031	VDIR643003
306170009	VDIR613009	306460033	VDIR542111
306170010	VDIR613010	306460035	VDIR547402
306170011	VDIR613011	306460036	VDIR547403
306170012	VDIR613012	306460037	VDIR547404
306170013	VDIR613013	306460038	VDIR547405
306170014	VDIR613014	306460039	VDIR547406
306270001	VDIR634130	306540001	VDIR651601
306270002	VDIR634150	306540002	VDIR651602
306270003	VDIR63411F	306560001	VDIR647201
306270004	VDIR534830	306680002	VDIR671102
306270005	VDIR534810	308350001	VDIR580021
306330006	VDIR626100	308350014	VDIR580020
306330008	VDIR626110		
306330011	VDIR626104		
306330012	VDIR629001		
306330015	VDIR626101		
306330017	VDIR528000		
306330021	VDIR629003		
306330022	VDIR62301G		
306330023	VDIR627100		
306330024	VDIR627165		
306330026	VDIR627130		
306330028	VDIR623101		
306350001	VDIR672101		
306350002	VDIR672102		
306350003	VDIR672103		
306350007	VDIR673001		
306350010	VDIR673002		
306350011	VDIR673003		
306350012	VDIR672104		
306350013	VDIR672105		
306350014	VDIR673004		
306350019	VDIR615003		
306350020	VDIR615004		
306350021	VDIR673V01		
306350022	VDIR673V02		
306350026	VDIR673V03		
306350027	VDIR673V04		
306350035	VDIR515001		
306440001	VDIR647401		
306440002	VDIR647402		
306460001	VDIR642100		
306460002	VDIR642101		
306460006	VDIR647001		

Conversion list

Former Schneider-Electric reference numbers

Former Schneider-Electric Ref. No.	New Schneider-Electric Ref. No.	Former Schneider-Electric Ref. No.	New Schneider-Electric Ref. No.
VDI514005	VDIR611001	VDI544002	VDIR647402
VDI514006	VDIR611002	VDI546001	VDIR642100
VDI514007	VDIR611003	VDI546002	VDIR642101
VDI514008	VDIR611004	VDI546006	VDIR647001
VDI514009	VDIR611005	VDI546007	VDIR647002
VDI514013	VDIR611009	VDI546008	VDIR647003
VDI514014	VDIR611010	VDI546009	VDIR647412
VDI514015	VDIR611007	VDI546010	VDIR647413
VDI514016	VDIR611008	VDI546012	VDIR647102
VDI516002	VDIR612002	VDI546013	VDIR647103
VDI516003	VDIR612001	VDI546014	VDIR647104
VDI516004	VDIR612003	VDI546015	VDIR647105
VDI516005	VDIR612004	VDI546016	VDIR642104
VDI516006	VDIR612005	VDI546017	VDIR642105
VDI516007	VDIR612010	VDI546018	VDIR642106
VDI516008	VDIR612011	VDI546019	VDIR642107
VDI516009	VDIR612006	VDI546020	VDIR642108
VDI516010	VDIR612007	VDI546021	VDIR642109
VDI517001	VDIR613001	VDI546022	VDIR642102
VDI517003	VDIR613003	VDI546023	VDIR642103
VDI517004	VDIR613004	VDI546027	VDIR643001
VDI517005	VDIR613005	VDI546028	VDIR643004
VDI517006	VDIR613006	VDI546029	VDIR643002
VDI517009	VDIR613009	VDI546030	VDIR643005
VDI517010	VDIR613010	VDI546031	VDIR643003
VDI517011	VDIR613011	VDI546033	VDIR542111
VDI517012	VDIR613012	VDI546035	VDIR547402
VDI517013	VDIR613013	VDI546036	VDIR547403
VDI517014	VDIR613014	VDI546037	VDIR547404
VDI518109	VDIR573000	VDI546038	VDIR547405
VDI518110	VDIR593000	VDI546039	VDIR547406
VDI518112	VDIR593001	VDI546040	VDIR547410
VDI527001	VDIR634130	VDI546041	VDIR542110
VDI527002	VDIR634150	VDI546042	VDIR643000
VDI527003	VDIR63411F	VDI546043	VDIR541101
VDI527004	VDIR534830	VDI546049	VDIR547201
VDI527005	VDIR534810	VDI550001	VDIR351651
VDI533006	VDIR626100	VDI554001	VDIR651601
VDI533008	VDIR626110	VDI555002	VDIR553661
VDI533011	VDIR626104	VDI556001	VDIR647201
VDI533012	VDIR629001	VDI560017	VDIR580011
VDI533015	VDIR626101	VDI560020	VDIR580010
VDI533017	VDIR528000	VDI561014	VDIR580020
VDI533020	VDIR528010	VDI568002	VDIR671102
VDI533021	VDIR629003	VDI634017	VDIR523001
VDI533022	VDIR62301G	VDI735001	VDIR580021
VDI535001	VDIR672101	VDIR623101	VDIR623101
VDI535002	VDIR672102		
VDI535003	VDIR672103		
VDI535007	VDIR673001		
VDI535010	VDIR673002		
VDI535011	VDIR673003		
VDI535012	VDIR672104		
VDI535013	VDIR672105		
VDI535014	VDIR673004		
VDI535019	VDIR615003		
VDI535020	VDIR615004		
VDI535021	VDIR673V01		
VDI535022	VDIR673V02		
VDI535026	VDIR673V03		
VDI535027	VDIR673V04		
VDI535035	VDIR515001		
VDI535036	VDIR526001		
VDI535037	VDIR526002		
VDI535039	VDIR673V10		
VDI544001	VDIR647401		

VDIxxxxxx VDICxxxxxx	Page
VDI552012	21 & 31
VDIC115118	14
VDIC115218	14

VDIR3xxxxxx	Page
VDIR315001	14
VDIR323008	13
VDIR326005	13
VDIR326010	13
VDIR326020	13
VDIR327002	13
VDIR327004	13
VDIR346101	14
VDIR351651	13
VDIR390010	13
VDIR390020	13

VDIR5xxxxxx	Page
VDIR511000	21
VDIR512001	13
VDIR515001	23
VDIR523001	22
VDIR526001	13
VDIR526002	13
VDIR528000	21
VDIR528010	21
VDIR534810	21
VDIR534830	21
VDIR541101	22
VDIR542110	22
VDIR542111	22
VDIR547201	22
VDIR547402	22
VDIR547403	22
VDIR547404	22
VDIR547405	22
VDIR547406	22
VDIR547410	23
VDIR553661	13 & 21
VDIR573000	23
VDIR580010	23
VDIR580011	23
VDIR580020	23
VDIR580021	36
VDIR590001	21
VDIR593000	23
VDIR593001	23

VDIR6xxxxxx	Page
VDIR611001	29
VDIR611002	29
VDIR611003	30
VDIR611004	30
VDIR611005	30
VDIR611007	29
VDIR611008	29
VDIR611009	29
VDIR611010	29
VDIR612001	30
VDIR612002	30
VDIR612003	30
VDIR612004	29
VDIR612005	29
VDIR612006	29
VDIR612007	29
VDIR612008	29
VDIR612009	29
VDIR612010	29
VDIR612011	29
VDIR613001	30
VDIR613003	30
VDIR613004	30
VDIR613005	31
VDIR613006	31
VDIR613009	37
VDIR613010	29
VDIR613011	29
VDIR613012	31
VDIR613013	34
VDIR613014	37
VDIR615003	30
VDIR615004	29
VDIR62301G	32
VDIR623101	32
VDIR626100	32
VDIR626101	33
VDIR626104	32
VDIR626110	33
VDIR627100	33
VDIR627130	33
VDIR627165	33
VDIR629001	36
VDIR629003	36
VDIR62301G	32
VDIR634130	31
VDIR634150	31
VDIR642100	33
VDIR642101	33
VDIR642102	32
VDIR642103	32
VDIR642104	33
VDIR642106	33
VDIR642107	33
VDIR642108	33
VDIR642109	33
VDIR643000	22
VDIR643001	34
VDIR643002	34
VDIR643003	34
VDIR643004	34
VDIR643005	34
VDIR647001	34
VDIR647002	34
VDIR647003	34
VDIR647102	32
VDIR647103	32

VDIR6xxxxxx	Page
VDIR647104	32
VDIR647105	32
VDIR647201	34
VDIR647401	34
VDIR647402	34
VDIR647412	35
VDIR647413	35
VDIR651601	31
VDIR651602	31
VDIR671102	37
VDIR672101	36
VDIR672102	36
VDIR672103	36
VDIR672104	36
VDIR672105	36
VDIR673001	32
VDIR673002	35
VDIR673003	35
VDIR673004	35
VDIR673V10	35



* Make the most of your energy

Schneider Electric Industries SAS

35 rue Joseph Monier
92500 Rueil-Malmaison
France
www.schneider-electric.com

As standards, specifications and designs change from time to time, please ask for confirmation of the information given in this publication.



This document has been printed
on ecological paper

Publishing: Schneider Electric Industries SAS
Design: LEON
Illustrations:
Photos:
Printing: