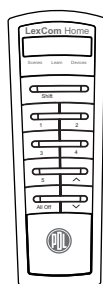
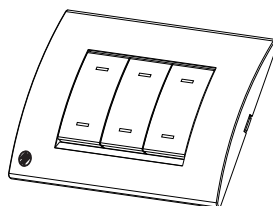

 **LexCom Home****LexCom Home Control Series****User's Guide****LHC Series**

© Copyright PDL Industries Australia Pty Ltd (PDL) 2006. All rights reserved. This material is copyright under Australian and international laws. Except as permitted under the relevant law, no part of this work may be reproduced by any process without prior written permission of and acknowledgment to PDL.

PDL is a registered trademark of Schneider Electric New Zealand Holdings Ltd.
LexCom Home is a registered trademark of Schneider Electric Aust Pty Ltd.

Encryption by QUALCOMM

The information in this manual is provided in good faith. Whilst PDL has endeavoured to ensure the relevance and accuracy of the information, it assumes no responsibility for any loss incurred as a result of its use. PDL does not warrant that the information is fit for any particular purpose, nor does it endorse its use in applications which are critical to the health or life of any human being. PDL reserves the right to update the information at any time without notice.

V1.0 May 2006

Contents

1.0	Product Range	5
2.0	Important Notes	5
3.0	Description	6
4.0	Definitions	8
5.0	Basic Operation	10
6.0	LexCom Home Control Networks	11
	6.1 Creating a Network	11
7.0	Grouping Buttons Together	13
	7.1 Using Timers	15
8.0	The Remote Control	17
	8.1 Installing the Batteries	18
	8.2 Programming the Remote	18
	8.3 Clearing Remote Assignments	20
9.0	Scenes	21
	9.1 Creating a Scene Button	22
	9.2 Learning a Scene	23
10.0	Factory Resets	24
	10.1 Button Reset	24
	10.2 Unit Reset	25
11.0	Care Instructions	26
	11.1 Removing the Facia	26
12.0	Power Failure	27
13.0	Limitations	27
14.0	Learn Mode Programming Examples	28
	14.1 Networking Units Together	28
	14.2 Grouping Three Buttons Together	28
	14.3 Grouping Buttons with a Timer	29
	14.4 Assigning a Remote Control Button	29
	14.5 Clearing a Unit's Remote Assignments	30
	14.6 Button Reset	30
	14.7 Unit Reset	30
	14.8 Creating a Scene Button	31
	14.9 Learning a Scene	31
15.0	Troubleshooting	32
16.0	Electrical Specifications	35
17.0	Mechanical Specifications	38
18.0	Warranty	39

1.0 Product Range

This manual applies to the units listed below.

Catalogue Number	Description
LHCxR8FxWH Series	LexCom Home Control Wall Switch (relay)
LHCxD2LxWH Series	LexCom Home Control Wall Switch (leading edge dimmer)
LHCxD2TxWH Series	LexCom Home Control Wall Switch (trailing edge dimmer)
LHC2R10F1	LexCom Home Control Plug Adaptor (relay)
LHC2D3L1	LexCom Home Control Plug Adaptor (leading edge dimmer)
LHC2D2T1	LexCom Home Control Plug Adaptor (trailing edge dimmer)
LHC8TXRF	LexCom Home Control Remote Control

2.0 Important Notes

- LexCom Home Control wall switches must be installed by appropriately qualified personnel.
- Wall switches must be connected to circuits that incorporate 10 A rated circuit breaker protection.
- All two channel wall switch relay units require both channels to have loads connected for proper operation.
- Some load types such as most compact fluorescent (CF) lamps (also known as energy saver lamps), are incompatible with dimmers and electronic switches. Do not use these with LexCom Home Control wall switch relay units (unless specially modified by your installer), or LexCom Home Control dimmer units.
- When using fluorescent lamps with LexCom Home Control wall switch relay units, ensure they meet the unit's minimum load rating (25 W).



No isolation is provided by wall switches. Hazardous voltage exists at the load terminals and lamp sockets in the unit's "off" state. Ensure that the circuit breaker is switched off before changing light bulbs, etc.

3.0 Description

LexCom Home Control wall switches are a two-wire retrofitable range of radio frequency (RF) devices, designed to replace standard wall switches and dimmers. LexCom Home Control wall switches and plug adapters can be operated by remote control, and have learn and scene capability.

The learn capability allows you to link multiple units into a common network. You can create associations between buttons on multiple units, so that a button press on one unit will operate a button on another (activating connected lights or other appliances). LexCom Home Control learn is used to:

- link the remote control to a wall switch or plug adaptor
- link wall switches and plug adaptors into a network.

Scene capability allows you to perform a series of actions across multiple units by pressing a single button. For example, on arrival home you could use a scene to switch on lights in the hallway and kitchen, dim lights in the lounge, and switch on a heater.

The following illustrations show possible LexCom Home Control unit installations. The room in Figure 1 uses stand-alone units which can be operated by remote control. The room in Figure 2 uses networked units where buttons on one unit can operate other units or trigger scenes.

This User's Guide describes how to program LexCom Home Control units using learn mode. Step by step instructions are provided for common learn tasks.

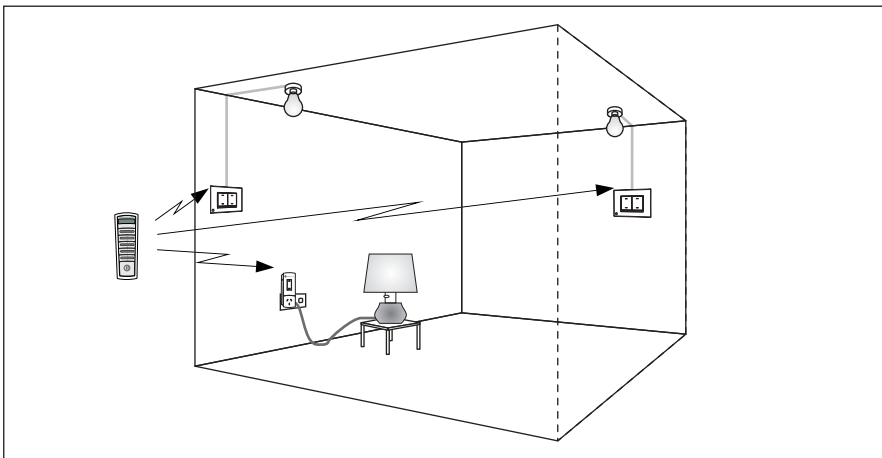

Figure 1 – Stand-alone units switched by remote control

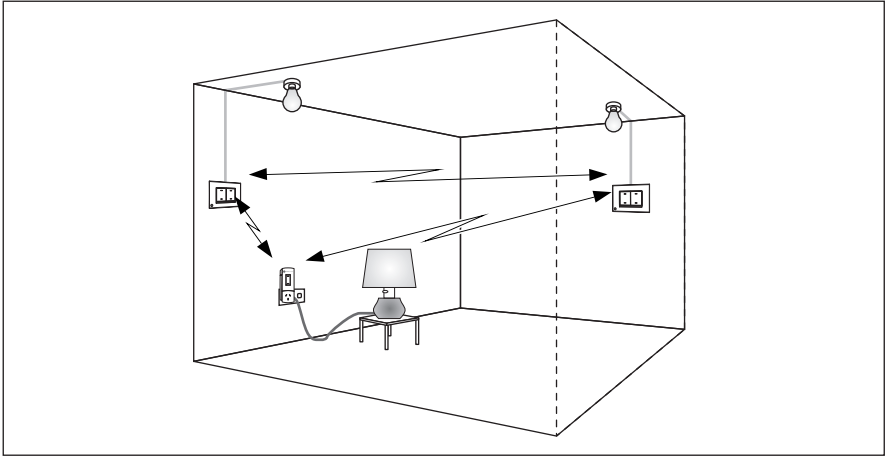

Figure 2 - Networked units (buttons on one unit can operate other units)

4.0 Definitions

The definitions in Table 1 are used in discussing LexCom Home Control units. Button types are shown in Figure 3.

load	A light or other electrical appliance connected to a LexCom Home Control Wall Switch or Plug Adaptor. Examples include lights, heaters and electric motors.
scene	A series of actions across multiple LexCom Home Control units, triggered by a single button. For example, on arrival home you could use a scene to switch on lights in the hallway and kitchen, dim lights in the lounge, and switch on a heater.
local control button	A button on a LexCom Home Control unit that is linked to an output channel of the same unit. LexCom Home Control devices have one pair of local control buttons for each of their output channels (the lowest numbered buttons).
free button	Any button on a LexCom Home Control unit that is NOT a local control button. Plug adapters have no free buttons.
group	An association between buttons, and typically one or more loads. Allows the control of one load from multiple switches.
learn mode	<p>A configuration state of LexCom Home Control. Learn mode enables you to create associations between buttons on units, and add functionality such as timers and remote control.</p> <p>Learn mode is entered by pressing and holding a local control button pair for 10 seconds (until the unit's indicator lights start flashing alternately). Once in learn mode, the local control button indicators of all units in the same network continue to flash alternately, except for buttons which are grouped to the local control button pair from which you entered learn mode.</p>
quick-press	A brief button press (pressed for a fraction of a second).
double quick-press	Two quick-presses in quick succession.

Table 1 – Definitions

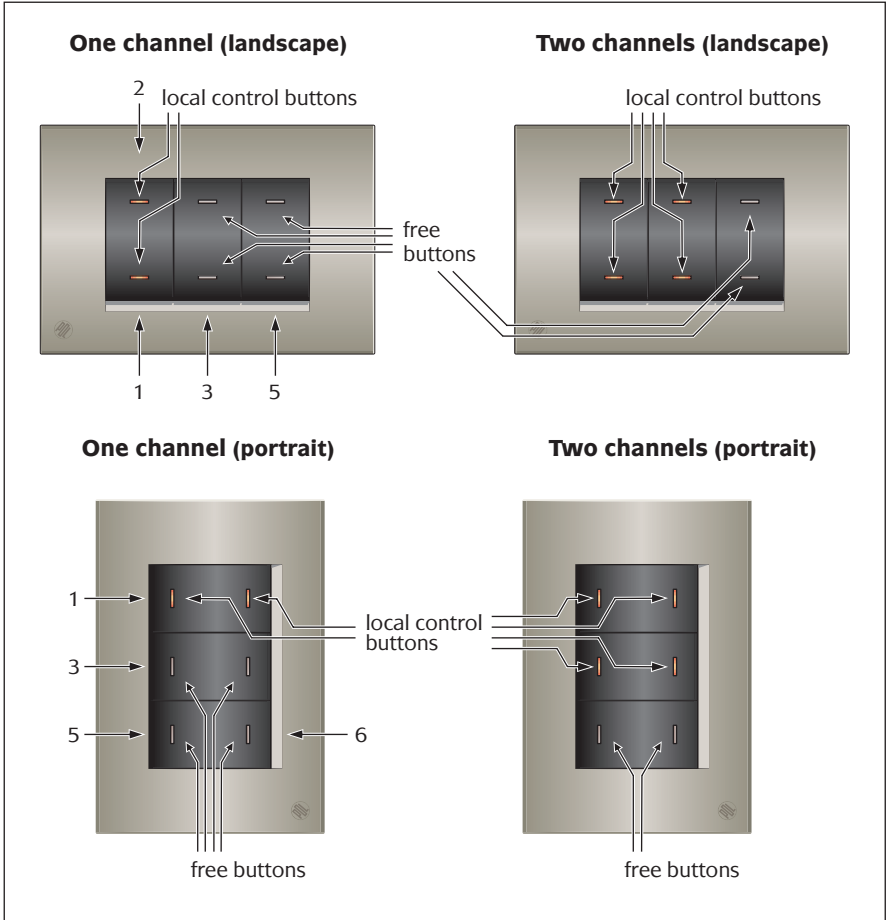

Figure 3 - LexCom Home Control button identification

5.0 Basic Operation

When a LexCom Home Control wall switch or plug adapter is first installed, it functions as a stand-alone unit. In this default mode, the unit functions as a dimmer or switch. The advantages of wireless operation are not utilised.

LexCom Home Control plug adapters have one output channel (a single AC mains socket) and two buttons. Wall switches are available in one or two output channel versions, with two, four, or six buttons (depending on the style). Each channel controls one or more lights or other appliances connected to its output.

Buttons on a LexCom Home Control wall switch or plug adapter are organised in pairs that control the output channels, (local control buttons). Remaining buttons (free buttons) are used to control outputs on other units when multiple LexCom Home Control units are configured as part of a network.

A 6 button, 2 channel LexCom Home Control wall switch is shown in Figure 3. Its buttons perform the following functions:

- Buttons 1 and 2 control the first channel. These are the two left-most buttons in a horizontally mounted unit or the two top-most buttons in a vertically mounted unit.
 - A quick-press on either button toggles the channel on or off. A long press on either button dims the unit in alternate directions.
 - If the channel is set to an intermediate dim level, button 1 commences with dim down, and button 2 commences with dim up. (When a channel has not been adjusted for 15 seconds or more, the highest numbered button always gives preference to dim up).
- Buttons 3 and 4 control the second channel in the same way as buttons 1 and 2 control the first.
- Buttons 5 and 6 are unused when the unit is used as a stand-alone unit. They may be used to control outputs on other units when part of a multi-unit network.

6.0 LexCom Home Control Networks

To experience the full capabilities of wireless operation, LexCom Home Control units must be linked together to form a network.

To communicate with each other successfully, units within the same network must be located no further than 20 metres from each other (Figure 4). This range will vary depending on the building's construction and the proximity to dense or metallic objects. Refer to the Typical Range specified on Page 35.

A network may consist of dozens of units. For best results however, it is recommended that no more than 30 units be placed within the same network. You may have multiple networks within the same building. Units in one network cannot control units in another.

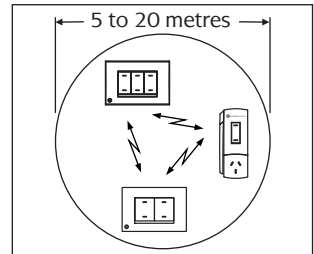

Figure 4 - Network range

6.1 Creating a Network

When a LexCom Home Control wall switch or plug adapter is first installed, it operates as a stand-alone unit. Before it can communicate with other units, it must be configured to be part of a LexCom Home Control network.

To create a network of units:

- 1) **Select a unit to be networked to.** (If all units are new, this can be any unit. If you are adding a new unit to an existing network, this must be a unit on your existing network).
- 2) **Press and hold buttons 1 and 2 for 10 seconds (until the unit's indicator lights start flashing alternately and rapidly). This activates learn mode.**

Only the local control button indicators flash. This flashing slows down after 5 seconds. At this time, if the buttons are part of a group, they will remain lit and no longer flash.

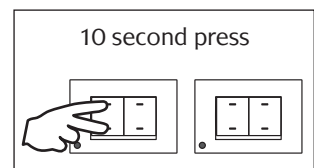
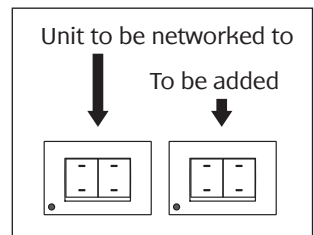

- 3) On each unit you are adding to the network, **perform step b) within 5 seconds of completing step a),**

- a) **Press and hold buttons 1 and 2 for 10 seconds** (activate learn mode as you did for the unit in step 2).
- b) **While the indicators are flashing quickly, press and buttons 1 and 2 again*, for 2 seconds.** The indicator lights start flashing simultaneously.

*If you do not perform step b) within 5 seconds of step a) (before the alternate flashing slows down), pressing buttons 1 and 2 together will exit learn mode.

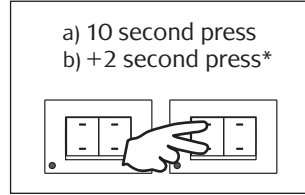

- 4) **Go back to the unit to be networked to. Hold down button 1 and, while continuing to hold, quickly double-press button 2.** This links the units you selected in step 3) into the same network as this unit.

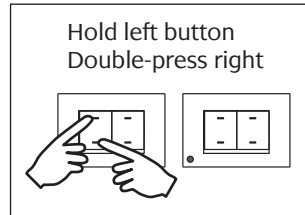

- 5) **Check the units added to the network.** They will return to learn mode (where they will flash alternately) after flashing quickly for several seconds.

If the indicators of a unit continue to flash slowly and simultaneously, the unit has not been added to the network (probably due to radio frequency (RF) interference or the unit being out of range). Try repeating step 4 on the unit to be networked to.

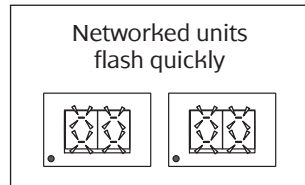

- 6) After networking the units together, they remain in learn mode ready for further learn activities (such as grouping buttons together, explained next).

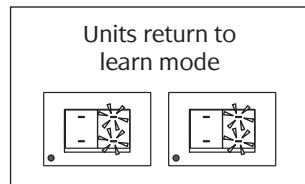

- 7) **To exit learn mode and return the units to normal switch or dimmer operation, press and hold buttons 1 and 2 for 1 second.**

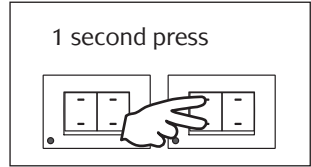

Your units are now part of a LexCom HomeControl network.

7.0 Grouping Buttons Together

When LexCom Home Control units are linked together in a network, you can associate buttons on one wall switch or plug adapter, with buttons on other units. This is called grouping buttons.

Before you group buttons together, there are some rules you should be aware of:

- **You must enter learn mode from the local control buttons you want to include in a group.**
- **You cannot group a free button to a local control button on the same wall switch (see Page 8 for definitions).**
- **After grouping one free button on a wall switch with a local control button on another unit, the free button,**
 - **toggles on/off for quick-presses**
 - **dims up/down for long presses (on dimmer units).**
- **After grouping two free buttons on a wall switch with a local control button on another unit,**
 - **both free buttons toggle on/off for quick-presses**
 - **either button dims the unit in alternate directions for long presses. If the channel is set to an intermediate dim level, the highest numbered button commences with dim up, and the other commences with dim down. (When a channel has not been adjusted for 15 seconds or more, the highest numbered button always gives preference to dim up).**
- **Up to two free buttons per wall switch can be included in any group.**

To group buttons together:

- 1) **Go to a unit that has a local control button pair you want to group with one or more other buttons. Press and hold the pair for 10 seconds, to activate learn mode.** The indicator lights on all units in the same network will flash alternately.

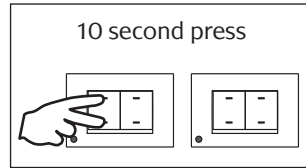

After 5 seconds, if the pair is already part of a group, all buttons belonging to the group will be selected (their indicators and loads will switch on).

- 2) **Press the buttons on the units you want to add to the group. Use quick-presses.** The indicator of each selected button will remain lit.

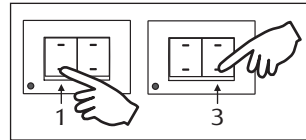

To remove a button from the group, simply press to deselect it.

Note that local control buttons work in pairs (pressing either local control button will select or deselect both).

- 3) **When you have selected all the buttons you want in a group, press and hold the top two buttons of any unit in the network for 1 second, to exit learn mode.**

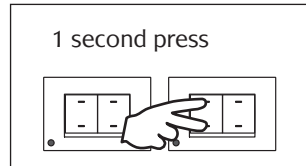

In the illustrations above, button 1 of the unit on the left is grouped with button 3 of the unit on the right. This means that pressing button 3 of the right unit will activate buttons 1 and 2 of the left unit, which operate as a pair. (A light or other appliance connected to button 1's channel output can be operated from button 3 of the other unit).

7.1 Using Timers

When using learn mode to add buttons to a group, you can set a button to work as a timer. You do this by holding the button down instead of using a quick-press (as in step 3 below). After about 1 second, the indicator light double-flashes, signifying that the button has been set as a timer. As you continue to hold the button, the indicator continues to double-flash. The timer is incremented by 5 minutes for each double-flash.

To group buttons together and make one a timer:

- 1) **Go to a unit which has the local control button pair you want to group with a timer button. Press and hold the button pair for 10 seconds, to activate learn mode.** The indicator lights on all units in the same network will flash alternately.

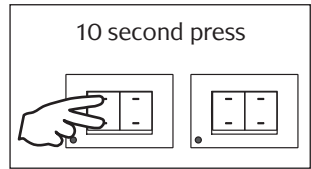

After 5 seconds, if the pair is already part of a group, all buttons belonging to the group will be selected (their indicators will remain lit).

- 2) **Press the buttons you want to add to the group. Use quick-presses.**

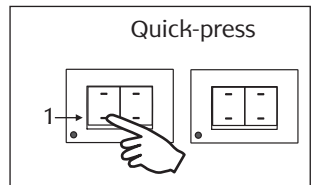

- 3) **Press and hold the button you want to use as a timer. Ensure you can see the button's indicator.** Count the double-flashes, and release the button once the count corresponds with the timer period you want (one double-flash for each 5 minutes).

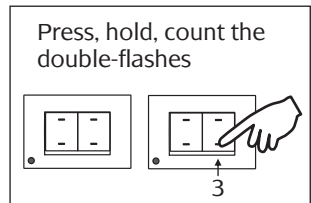

- 4) **Press and hold buttons 1 and 2 of any unit in the network for 1 second, to exit learn mode.**

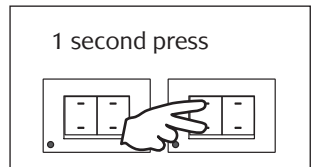

In the illustrations above, button 3 of the unit on the right is set as a timer for button 1 of the unit on the left. Step 3 is where the button is set as a timer.

If the button is held for 4 seconds, the indicator light will double-flash after 1 second, and again

after each of the following 3 seconds. The timer period will be set for 20 minutes (4 × 5 minutes).

You can select either a single button or a pair of buttons on the same wall switch or plug adapter, to function as a timer (local control buttons work in pairs):

- A single button timer will switch a light (or other appliance) on, and automatically switch it off after the timer period.
- When a pair of buttons work as a timer, the highest numbered button will switch the light on with a timer. The other button will switch it on or off with no timer.

To group buttons together with a timer button pair:

- 1) **Go to a unit which has a local control button pair you want to group with a timer button. Press and hold the button pair for 10 seconds, to activate learn mode.** The indicator lights on all units in the same network will flash alternately.

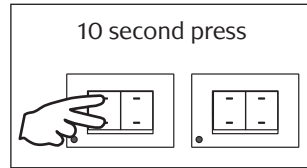

After 5 seconds, if the pair is already part of a group, all buttons belonging to the group will be selected (their indicators will remain lit).

- 2) **Quick-press the buttons you want to add to the group. Quick-press the first free button you want to use as a timer.**

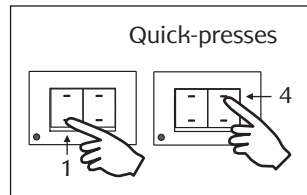

- 3) **Hold down the second free button you want to use as a timer (on the same unit). Ensure you can see the button's indicator.** Count the double-flashes, and release the button once the count corresponds with the timer period you want (one double-flash for each 5 minutes).

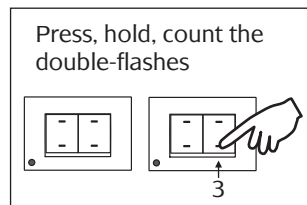

- 4) **Press and hold buttons 1 and 2 of any unit in the network for 1 second, to exit learn mode.**

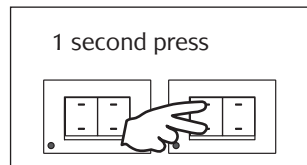

In the illustrations on the previous page, buttons 3 and 4 of the unit on the right will work as a timer pair for button 1 of the unit on the left. Button 4 will switch button 1 on with the timer (to switch off after the timer period expires). Button 3 will switch button 1 on or off with no timer.

8.0 The Remote Control

The LexCom Home Control Remote Control allows you to control buttons on LexCom Home Control wall switches and plug adapters. It is a radio frequency (RF) remote that works up to 15 to 20 metres from a device it controls. Unlike an infrared (IR) remote, you do not need to point it at the unit you want to control.

Up to 10 separate buttons on wall switches or plug adapters can be controlled by the remote control unit. These can be on various units on different networks. A single button on a wall switch or plug adapter can be controlled by up to two remote controls.

Remote buttons are organised in two banks of five. Banks are alternately selected by pressing the Shift button (Figure 5).

Up and Down buttons allow you to dim the level associated with the last button selected (on dimmer units). An All Off button provides a convenient way to switch off every light or other appliance that has been associated with the remote control.

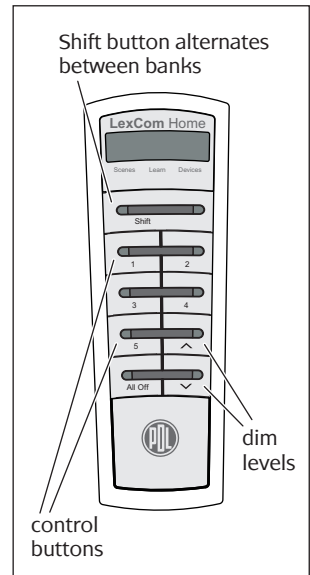

Figure 5 – Button layout

8.1 Installing the Batteries

The LexCom Home Control Remote Control uses 2 × AAA batteries. Alkaline batteries are recommended. To install the batteries:

- 1) Turn the remote upside down.
- 2) Press the tab and slide the back cover down to release (refer to Figure 6).
- 3) Insert the batteries. Ensure the ⊕ and ⊖ terminals match the symbols inside the battery compartment.
- 4) Replace the back cover (position and slide up).

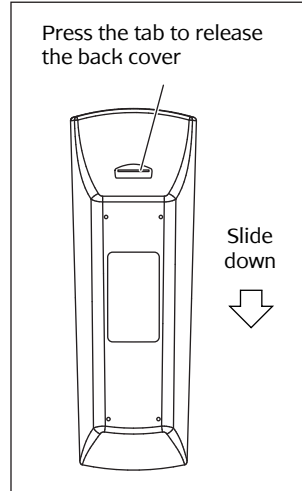

Figure 6 - Removing the back cover

8.2 Programming the Remote

Before the Remote Control can be used, LexCom Home Control units must be programmed to recognise the remote's buttons. The remote, wall switch and plug adapter units do this in learn mode.

Learn mode is activated on the remote by removing the back cover (as when installing batteries), and sliding the switch across to the Learn position. The remote's learn mode switch is shown in Figure 7.

The following procedure is used to assign a button on the remote to a button on a LexCom Home Control wall switch or plug adapter:

- 1) **Set the LexCom Home Control Remote Control to learn mode, as described on the previous page (slide the switch across to the Learn position).**

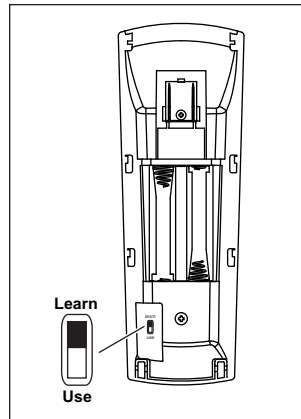
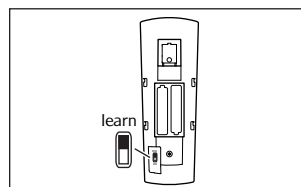
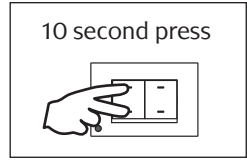

Figure 7 - Activating the remote's learn mode



- 2) **On the wall switch or plug adapter, press and hold buttons 1 and 2 for 10 seconds, to activate learn mode.** (The indicator lights on all units in the same network will flash alternately).



- 3) **On the remote, press and release the button you want to assign.** (The indicators on all wall switches and plug adapters in the same network will flash simultaneously).

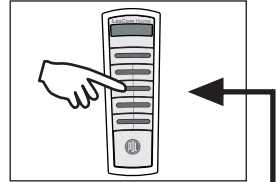

- 4) **On the wall switch or plug adapter, quick-press the button you want the remote to control.** Do this within 30 seconds of pressing the remote button in the step above (while the indicators are flashing).

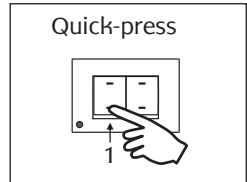

- 5) **Repeat steps 3 and 4 for any additional remote buttons you want to assign.**

- 6) **When you have finished programming remote buttons, press and hold the top two buttons of any unit in the network for 1 second, to exit learn mode.**

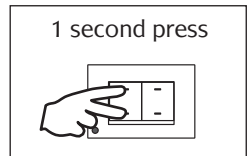

- 7) **Slide the learn mode switch on the remote back to the Use position.**

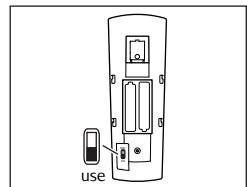

In the illustrations above, the third assignable remote button is assigned to button 1 of the wall switch. This means that a light operated from button 1 of the wall switch can also be operated from button 3 of the remote.



Assigning a button on the remote to a button on a LexCom Home Control unit does not unlearn any previous assignments to other units. To do this you need to clear the previous remote assignments (section 8.3).

8.3 Clearing Remote Assignments

You can clear an individual remote assignment learned by a specific button on a wall switch or plug adapter. You do this by re-assigning the remote button to the wall switch or plug adapter button, (assigning a button once learns it, assigning it again clears it).

You can clear all remote assignments (from all remote controls) learned by an individual wall switch or plug adapter. To do this:

- 1) **Set the LexCom Home Control Remote Control to learn mode, as described on Page 18** (slide the switch across to the Learn position).
- 2) **On the wall switch or plug adapter, press and hold buttons 1 and 2 for 10 seconds, to activate learn mode.**
- 3) **Press and release any one of the five assignable buttons on the right side of the remote control.**
- 4) **Double quick-press one of the buttons on the wall switch or plug adapter.**
- 5) **Wait until the indicator lights return to a slow alternating flash. Then press and hold buttons 1 and 2 on the wall switch or plug adapter for 1 second, to exit learn mode.**
- 6) **Slide the learn mode switch on the remote control back to the Use position.**

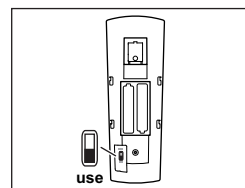
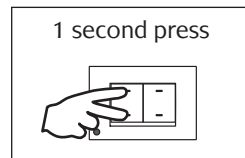
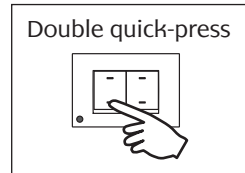
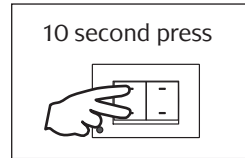
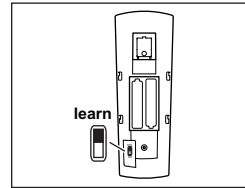

8.4 Labelling Remote Control Buttons

An assortment of labels is supplied with the remote control. These include individual button labels which illuminate when inserted behind the buttons.

To insert the Remote Control labels:

- 1) Remove the Remote Control's back cover (Figure 6).
- 2) Gently pull the front cover away from the remote.
- 3) Pull off the buttons.
- 4) For each label required, peel off the protective backing to reveal the adhesive film, and stick the label to the black mask (over one of the clear, rounded rectangles).
- 5) Reattach the remote's buttons, front cover and back cover.

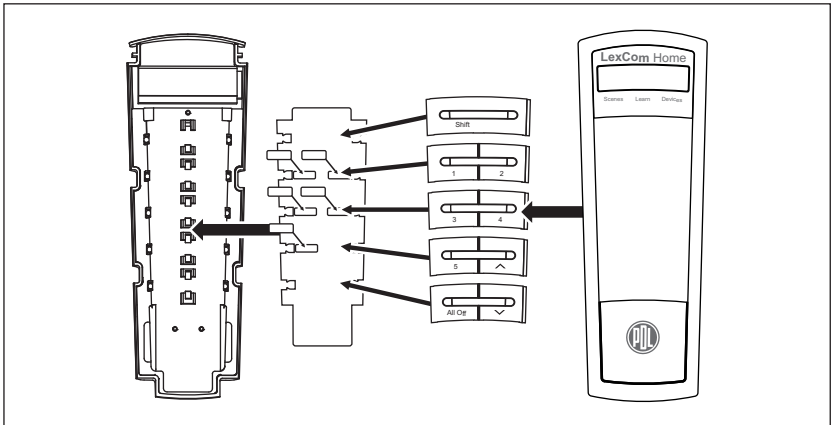

9.0 Scenes

A scene allows you to perform a series of actions across multiple LexCom Home Control units with the press of one button. For example, on arrival home you could use a scene to switch on lights in the hallway and kitchen, dim lights in the lounge, and switch on a heater.

A unit can have as many scenes as it has buttons, depending on how many groups of buttons the scenes control. The total number of button groups that scenes in a unit may control is between 46 and 49, depending on organisation. For example, a unit may contain one scene which controls 49 button groups, or three which control 16 button groups each.

There are two stages of creating a scene:

- 1) You must create a scene button. This is a button that will be used to trigger the scene. Any button can be used as a scene button (it is normally best to use a free button).
- 2) You must learn the scene. This involves setting the states or levels of lights or other appliances you want to be recalled (by pressing grouped buttons), and assigning these to the scene button.

Note that before a button can be included in a scene, it must be grouped to another button (as in Section 7.0), or at least to itself (if it is a local control button).

To group a local control button to itself:

- 1) **Enter learn mode from the local control button pair.**
- 2) **Select the local control button (its indicator will illuminate).**
- 3) **Exit learn mode.**

9.1 Creating a Scene Button

A scene button is created by double quick-pressing a button in learn mode:

- 1) Go to the unit on which you want to create a scene button. Press and hold buttons 1 and 2 for 10 seconds, to activate learn mode.
- 2) Double quick-press the button you want to set as a scene button (it will begin flashing quickly).
- 3) Press and hold buttons 1 and 2 for 1 second, to exit learn mode.

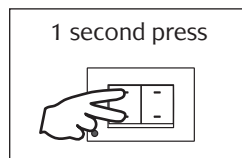
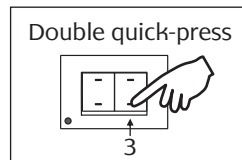
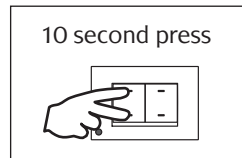

In the illustrations above, button 3 is set as a scene button. It can then be used to learn a scene (as described in the following section).

9.2 Learning a Scene

Once a scene button has been created, you can use it to capture the states or levels of lights and other appliances within the same network (by pressing grouped buttons). These states can then be recalled by pressing the scene button. (You can group an ungrouped local control button to itself, so it can be included in a scene. To do this, enter learn mode from the local control button pair, select the local control button and exit learn mode.)

To capture the states of other buttons (learn a scene):

- 1) **Press and hold the scene button for 10 seconds (until it starts flashing).**
- 2) **Use grouped buttons on any units within the same network, to set the states of the lighting levels and other electrical appliances that you want to capture as part of the scene.**

You can switch buttons on, or set them to a specific level (in the case of dimmers). To capture an off state, switch a button on and then off.

- 3) **Press and hold the scene button for 1 second (until it stops flashing), to exit scene learn mode.**

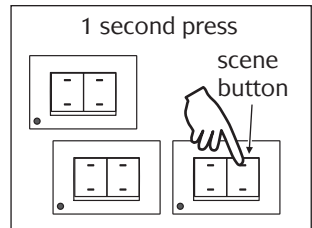
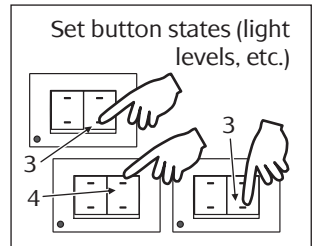
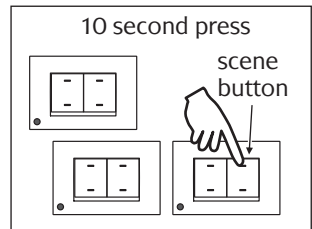

In the illustrations above, three button states are captured and stored in a scene. Each state may consist of on, off or a particular lighting level (depending on what appliance is connected, and whether the unit is a relay or dimmer). Buttons 3, 4 and 3 of the first, second and third respective units, are added to the scene button in the third unit.

10.0 Factory Resets

10.1 Button Reset

The button reset allows you to clear a button on a LexCom Home Control wall switch or plug adapter to its original factory default state. This can be used to delete a scene button.

To reset a button back to its factory default state:

- 1) **Press and hold buttons 1 and 2 for 10 seconds, to activate learn mode.** (The indicator lights will flash alternately).
- 2) **Double quick-press any button on the unit.**
- 3) **Double quick-press the same button again.**
- 4) **Press and hold the button you want to reset for 2 seconds** (until the indicator flashing slows down).
- 5) **Press and hold buttons 1 and 2 for 1 second to exit learn mode.**

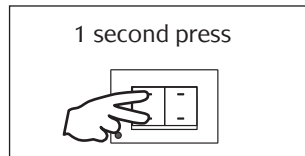
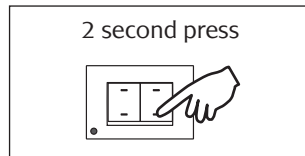
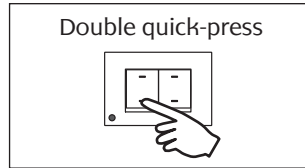
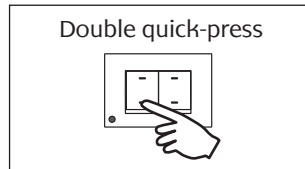
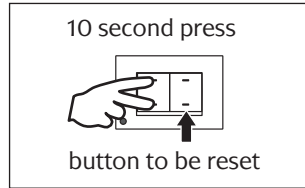

10.2 Unit Reset

The unit reset allows you to clear a LexCom Home Control wall switch or plug adapter to its original factory default settings. This is recommended under the following circumstances:

- when adding a previously programmed unit to a new network (perhaps changing from a single to multiple network installation)
- if you lose track of where you are up to when programming a unit.

To reset a unit back to its factory default settings:

- 1) **Press and hold buttons 1 and 2 for 10 seconds, to activate learn mode.** (The indicator lights will flash alternately).
- 2) **Double quick-press any button on the unit.**
- 3) **Double quick-press the same button again.**
- 4) **Press and hold buttons 1 and 2 for 1 second** (until the indicators stop flashing).
- 5) The unit being reset will perform a series of flashes for about 10 seconds, before returning to the standard learn mode slow alternating flash.
- 6) **Press and hold buttons 1 and 2 again for 1 second to exit learn mode.**

10 second press



Double quick-press

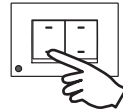

Double quick-press

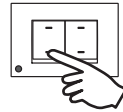

1 second press



10 sec. series of flashes

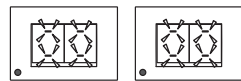

1 second press



11.0 Care Instructions

LexCom Home Control units contain electrical and electronic parts to support their functions. Be sure to note the following precautions.

- Clean regularly using a soft lint free cloth.
- Do not use chemicals or spray cleaners when cleaning.
- Do not operate with wet hands.
- Do not use hard, sharp objects to select the controls.
- Allow adequate ventilation. Do not cover the unit.
- LexCom Home Control units are designed for indoor use only.
- Do not expose to direct sunlight for extended periods.



no wet hands



no cleaner spray



no coverage



no direct sunshine



no dust

11.1 Removing the Facia

The cover plate is removable. This allows you to replace it with a different style or colour, or temporarily remove it to paint the wall.

To remove a LexCom Home cover plate

- 1) Insert the blade of a small flat head screwdriver into one of the release slots.
- 2) Lever the cover plate off the grid.

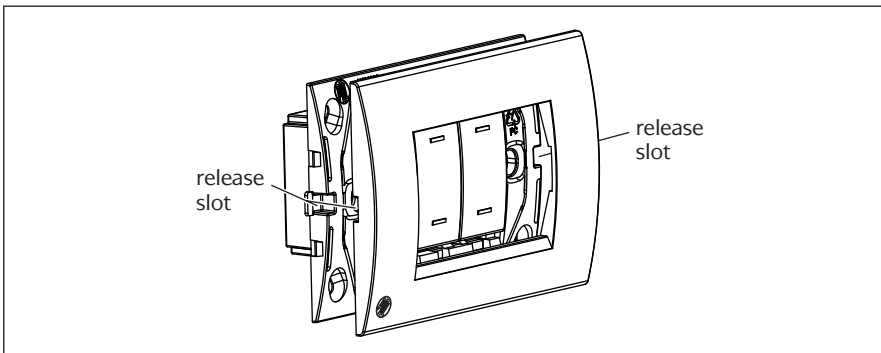

12.0 Power Failure

All LexCom Home Control units have on-board non-volatile memory, which is used to store the operating state in case of mains power loss. After a power failure, the on/off and dimmer level states of wall switches and plug adapters, are restored according to the states before the power failure. Restoration occurs approximately 10 to 20 seconds after power resumes.

13.0 Limitations

- LexCom Home Control relay units may sometimes switch the indicators off momentarily. This usually occurs when a load has been switched off, and is normal behaviour.
- LexCom Home Control wall switches include a thermal overload protection mechanism. If excessive load is connected to a unit, dimmers will dim down and relay units will not operate. If this condition is observed, the load on the unit should be reduced. Relays will not resume functionality until mains power has been switched off and on.
- It is recommended that no more than 30 units be placed in a single network.
- This equipment uses radio communication for its operation. Communication between units requires a clear radio path. Some types of installation and building materials can severely disrupt radio communication. The range quoted is typical and not guaranteed. The range will be severely reduced if this equipment is placed inside metal enclosures.

14.0 Learn Mode Programming Examples

14.1 Networking Units Together

To link a plug adapter and wall switch to another wall switch:

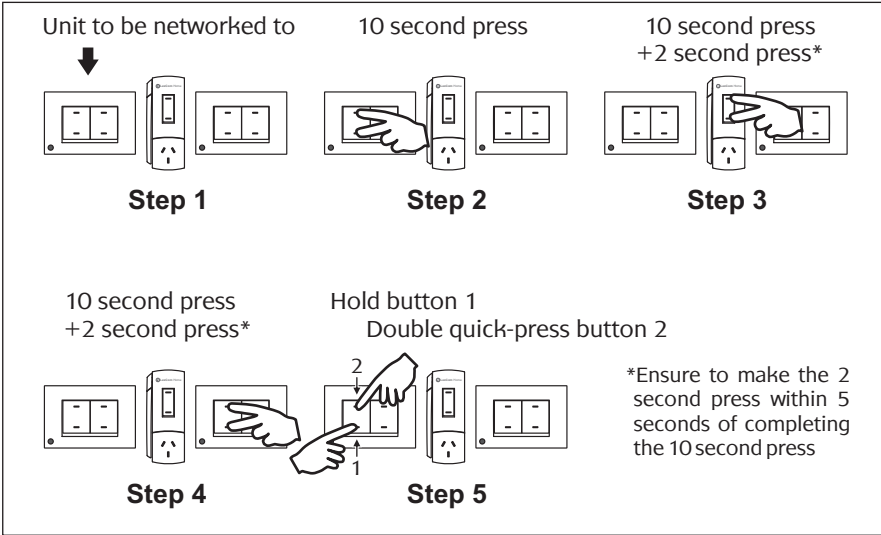

14.2 Grouping Three Buttons Together

To group buttons on three networked units:

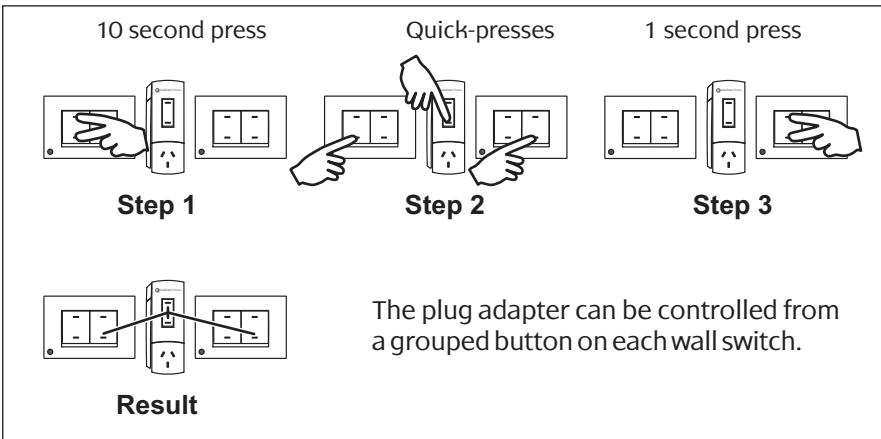

14.3 Grouping Buttons with a Timer

To group a 30 minute single button timer to a button on a networked unit:

10 second press	Quick-press	Press & hold for 6 double-flashes	1 second press
Step 1	Step 2	Step 3	Step 4
		<p>Pressing the grouped wall switch button switches the plug adapter on for 30 minutes.</p>	
Result			

14.4 Assigning a Remote Control Button

To assign a remote control button to a button on a unit:

	10 second press		Quick press		1 second press	
Step 1	Step 2	Step 3	Step 4	Step 5	Step 6	
		<p>The plug adapter can be controlled from the remote control button. Quick-presses on the remote, switch the plug adapter on and off. If the plug adapter is a dimmer, long presses on the remote dim it up and down.</p>				
Result						

14.5 Clearing a Unit's Remote Assignments

To delete all the remote control button assignments in a unit:

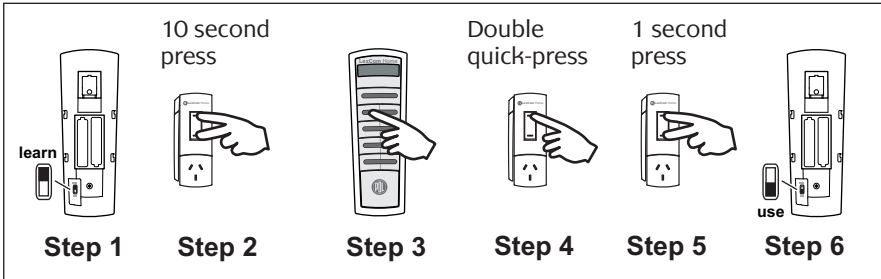

14.6 Button Reset

To clear a button to its original factory default state:

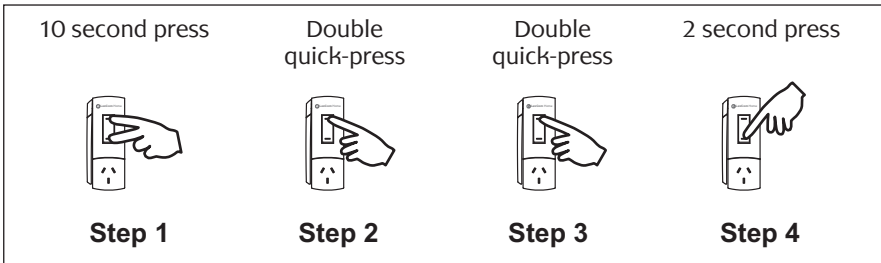

14.7 Unit Reset

To reset a unit back to its original factory default settings:

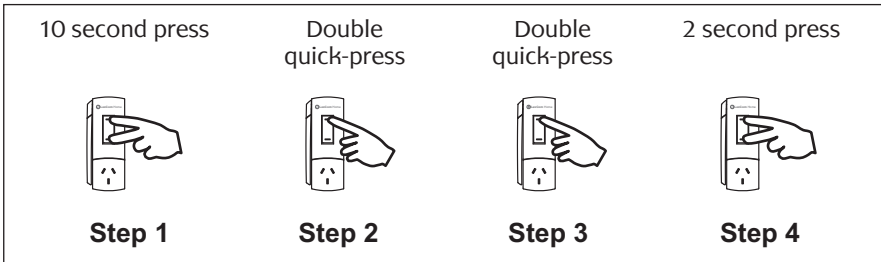

14.8 Creating a Scene Button

To create a scene button:

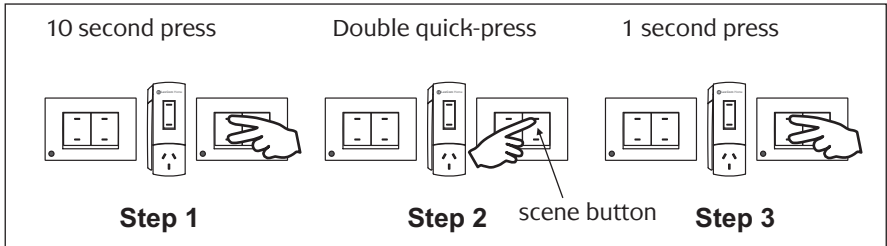

14.9 Learning a Scene

To learn a scene (after creating a scene button):

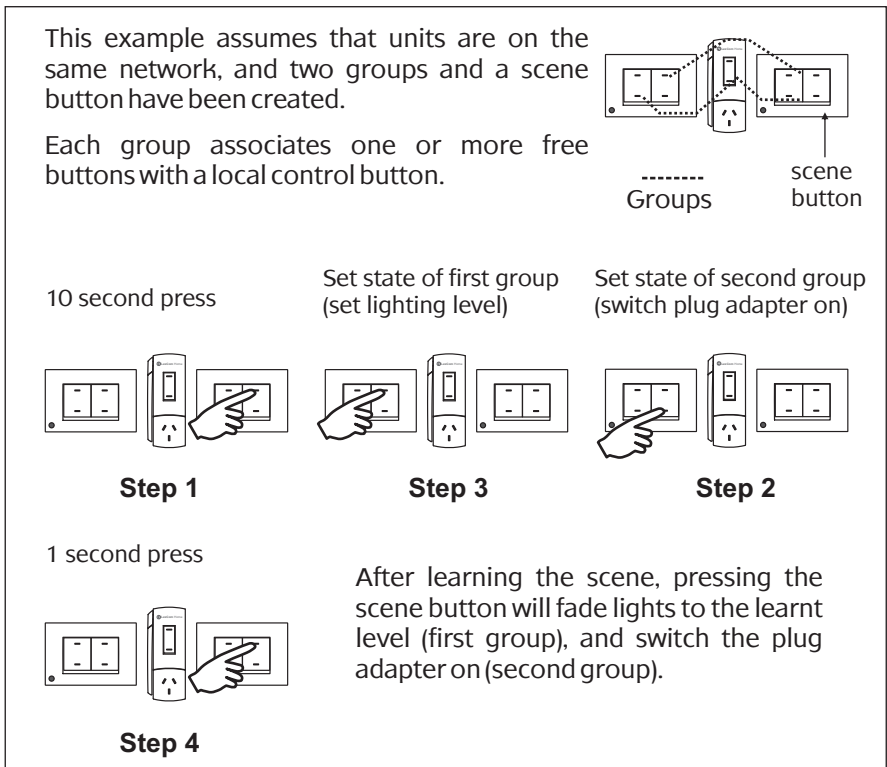

15.0 Troubleshooting

Wall switches won't work

A globe may have blown. Wall switches need a functioning light or other appliance connected to the first output channel for them to work. (The first output channel is connected to the first button pair).

Wall switch relay unit makes a clicking sound every 3 seconds or so

A globe may have blown (as in above problem).

Unit won't enter learn mode. When the top two buttons are held down, one of the lights starts flashing

The flashing button indicates it has been set as a scene button. Ensure you press the non-scene button first, when entering learn mode.

Button won't select in learn mode

You can't select both a local control button and free button on the same wall switch. If a free button is already selected, quick-pressing a local control button will have no affect. If a local control button is already selected, quick-pressing a free button will have no affect.

Buttons on different units won't group together

Units must belong to the same network before you can group their buttons together. You can confirm that units are networked together by entering learn mode on one unit (press and hold the top two buttons for 10 seconds). All units in the same network enter learn mode simultaneously, and begin flashing. (To exit learn mode, press and hold the top two buttons again for 1 second). Refer to section 6.1, Creating a Network.

A switched load switches off again after 5 seconds

You may have accidentally set a button as a 5 second timer. This is a special mode used for testing purposes. It is activated while in learn mode by holding a button down for just under 1 second. To fix this, enter learn mode from a local control button pair that the 5 second timer is grouped to. Deselect and then reselect the 5 second timer button, and then exit learn mode. Refer to section 7.0, Grouping Buttons Together.

All indicators on a unit flash unusually for one minute (a quick flash about once per second)

This is a special flash pattern indicating that there has been a transmission failure. You can press a button on the unit to stop it flashing immediately.

All indicators on a unit continue to flash every 4 seconds

This is a special flash pattern indicating that the unit is offline. The unit is most likely only barely in range of other units, and has shut itself down to prevent it from causing network radio frequency (RF) traffic congestion. The unit will place itself back online after an hour.

Sometimes a light or other appliance cannot be controlled from a grouped button on a another unit

LexCom Home Control uses an encryption system for added security. As a consequence of this, if a unit misses transmissions from other units (due to RF interference or being out of range), the unit may lose its ability to control other units.

The solution is to operate a grouped button on any unit nearby. This will re-synchronise the unit that is not transmitting. Sometimes simply operating the local control buttons a few times on the unit which is not transmitting will be sufficient. Note that the local control buttons will always operate the local load, even if the encryption system has lost synchronisation.

16.0 Electrical Specifications

All Units

Parameter	Description
Supply voltage	220 to 240 V AC @ 50 Hz
Radio frequency	433.92 MHz
Transmitting power	Remote Control: 10 mW; Other units: 1 mW
Typical range (Range depends on building construction and the proximity to dense or metallic objects)	15 to 20 m (in buildings with timber frame/brick veneer construction) 10 to 15 m (in buildings with brick, stone or steel frame construction) 5 to 10 m (in buildings with steel reinforced concrete construction)
Maximum range	50 m (open air)
Control functions	Load switching, dimming (LE/TE only), timer, relay
Status indicator colour	Orange
Warm-up time	5 seconds
Operating temperature range	0 to 40 °C
Operating humidity range	10 to 95% RH

Wall Switch Relay

Parameter	Description	
Min. load per channel	25 W, 0.1 A	
Max. total load*	2000 W, 8 A	
Compatible loads/rating[†] Incandescent/halogen Fluorescent [†] Iron core trans. LV lighting [§] Electronic LV Lighting Fan motors [#]	IEC 8A 4AX 8A 8A 2A	Australia/NZ 8A 4AX 8A 8A 3M
Off state power consumption	0.25 W	
Off state leakage current	10 mA (channel 1) 0 mA (channel 2)	

Wall Switch Leading Edge Dimmer

Parameter	Description	
Min. load per channel	25 W lamp or 0.25 A fan motor [#]	
Max. load per channel	500 W, 2 A (one channel unit) 250 W, 1 A (two channel unit)	
Compatible loads/rating[‡] Incandescent/halogen Iron core trans. LV lighting [§] Fan motors [#]	IEC 2 A 2 A 2 A	Australia/NZ 2 A 2 A 3 M
Off state power consumption	0.5 W	
Off state leakage current	12 mA (channel 1) 5 mA (channel 2)	

Wall Switch Trailing Edge Dimmer

Parameter	Description	
Min. load per channel	25 W lamp	
Max. load per channel	500 W, 2 A (one channel unit) 250 W, 1 A (two channel unit)	
Compatible loads/rating[‡] Electronic LV lighting	IEC 2 A	Australia/NZ 2 A
Off state power consumption	0.5 W	
Off state leakage current	15 mA (channel 1) 10 mA (channel 2)	

Plug Adapter Relay

Parameter	Description	
Max. total load	2400W, 10 A	
Compatible loads/rating[‡] Incandescent/halogen Fluorescent [†] Iron core trans. LV lighting [§] Electronic LV Lighting Fan motors [#]	IEC 10 A 4 AX 10 A 10 A 2 A	Australia/NZ 10 A 4 AX 10 A 10 A 3 M

Plug Adapter Leading Edge Dimmer

Parameter	Description	
Max. total load	750W, 3 A	
Compatible loads/rating[†] Incandescent/halogen Iron core trans. LV lighting [§]	IEC 3 A 3 A	Australia/NZ 3 A 3 A

Plug Adapter Trailing Edge Dimmer

Parameter	Description	
Max. total load	500W, 2 A	
Compatible loads/rating[†] Electronic LV Lighting	IEC 2 A	Australia/NZ 2 A

* Total loading connected to 2 channel model is the sum of load 1 and load 2. Refer to Compatible loads / ratings for individual channel switch ratings for each load type.

[†] Fluorescent luminare must include a Power Factor Correction (PFC) capacitor in order for a switch unit to function correctly.

[‡] See Important Notes (page 5).

[§] Only iron core transformers compatible with electronic switches may be used to ensure compliance to IEC 60669-2-1.

[#] Exhaust and ceiling fans with shaded pole or permanent-split-capacitor motors.

17.0 Mechanical Specifications

Refer to the LexCom Home Control Wall Switch Series Installation Instructions for wall switch mechanical specifications.

LexCom Home Control Plug Adapter

Parameter	Description
Dimensions (W×H×D)	49 × 127 × 64 mm
Weight	TBA

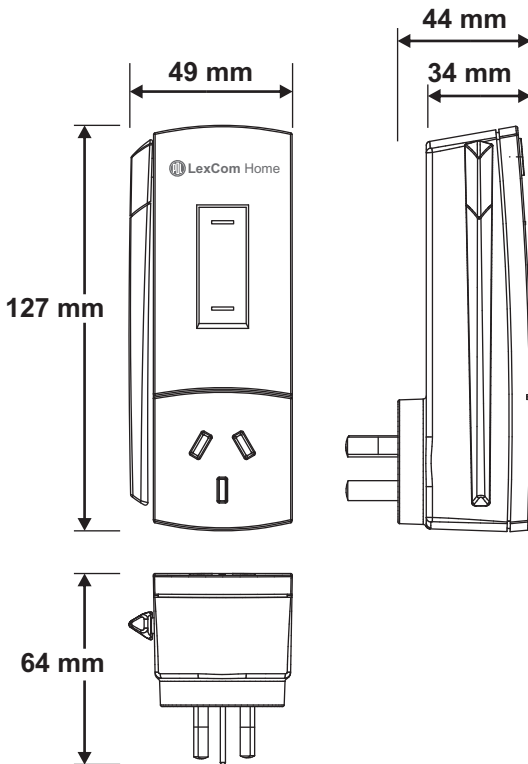

LexCom Home Control Remote Control

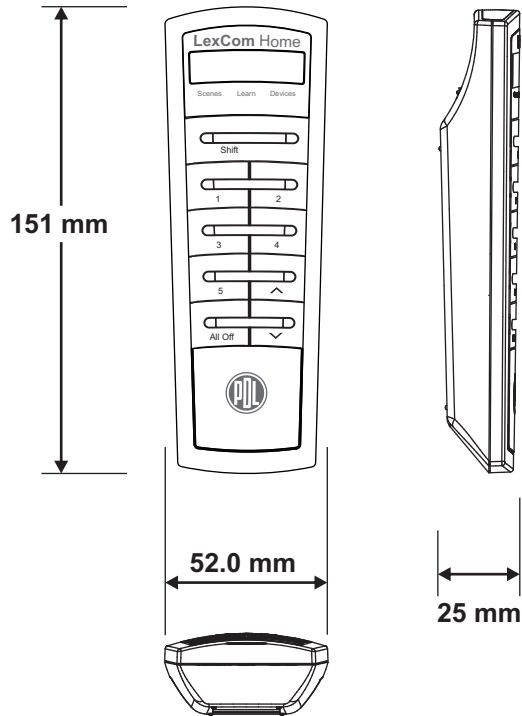

18.0 Warranty

LexCom Home Control wall switch, plug adapter and remote control products carry a two year warranty against manufacturing defects.



P D L

Technical Support and Troubleshooting

For further assistance in using this product, consult your nearest PDL Sales Representative or Technical Support Officer.

Sales and Customer Service Contact Number	
Australia	1300 PDL COM (1300 735 266)

Technical Support Email: help@pdl.com.au

Additional product information and technical resources are provided at <http://www.pdl.com.au>

PDL Industries Australia Pty Ltd

Locked Bag 5500, Baulkham Hills Business Centre
NSW 2153 Australia

Telephone: +61 (0)2 9851 2666

Facsimile: +61 (0)2 9851 2695

Email: help@pdl.com.au