

orazio.premium 1043



Model Code F5510

revision 00 of 05-01-16
(the present replaces any previous versions)

Designer: centro studi interno

Structure: pinewood, multilayer and plywood covered with polyurethane foam.

Spring system: elastic webbing.

Seat Padding: ecological polyurethane foam covered with 100% polyester layer.

Back Padding: fiber (synthetic fiberfill).

Arm Interior: ecological polyurethane foam covered with 100% polyester layer.

Removability: not available.

Sewing: leather coverings feasible with contrast stitching in the colors available; cuts and sewing vary on microfiber (or fabric) coverings. The model on leather versions is also available with 1.2 mm thick thread.

Mechanisms: versions 489, 452, 453, 456 are equipped with manually sliding seats. The depth of the seat with sliding system positioned outwards is 87 cm, the total depth of the model is 127 cm.

Standard feet: PL978 on sofa versions and PL982 on small chair version (190) and ottoman (540), PL987 on armless sides, end corners (071/072) and terminal ottoman (B05), all in coal black colored beechwood, h 10 cm, also available in rosewood, black, cherry, dark walnut, light walnut, silver and natural. Some versions may be equipped with hidden feet with a supporting structural function.

Optional feet: PM973, on sofa versions and PM977 on small chair version (190) and ottoman (540), PM986 on armless sides, end corners (071/072) and terminal ottoman (B05), all in shiny metal, h. 10 cm.

Density of seat and back

Markets	Seat	Back
I	35 Medium	fiocco
D - NL - CH		
USA - California		
GB	35 fire retardant	fiocco fire retardant
Others	35 Medium	fiocco

Note: when no values/contents are specified in the chart, please refer to 'Others' field/area.

Coverings

	suggested	not suggested	not possible
thick leathers	✓		
thin elastic leathers	✓		
natural leathers	✓		
fabric*	✓		
microfibre*	✓		
leather + split	✓		
DeLuxe			✓
multicovering			
multicolour			

Please note: for not removable models, only one colour fabric covers are available.

* fabrics and microfibers are not available for the U.K. market

Multicovering / Components / Optional vers.



Feet



PL978

PL987

PM973

Ottoman



With the reservation of carrying for production purposes and without advanced notices modifications on the materials, coverings and dimensions of the product as indicated in the relevant specification. The given dimensions and volume are of indicative value being subject to the production process tolerances.



↑ fold following the dotted line ↑

orazio.premium 1043



L Length - H Height - D Depth - SH Seat Height - SD Seat Depth
Dimensions refer to maximum sizes.

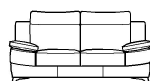
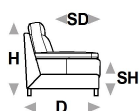

dimensions	L 109 H93 D97 SH44 SD57	L 178 H93 D97 SH44 SD57	L 198 H93 D97 SH44 SD57	L 218 H93 D97 SH44 SD57	L 70 H44 D70 SH- SD-
version code	190	200	240	300	540
Description	small chair	2 seater	2 1/2 seater	3 seater	ottoman

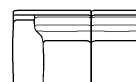
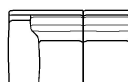
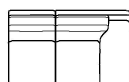

L 85 H44 D65 SH- SD- B 05	L 154 H93 D97 SH44 SD57	L 154 H93 D97 SH44 SD57	L 164 H93 D97 SH44 SD57	L 164 H93 D97 SH44 SD57	L 184 H93 D97 SH44 SD57
B 05	210	220	251	252	310
terminal ottoman	1right arm facing 2 str	1left arm facing 2 str	1 right arm fac.2 1/2 str	1 left arm fac. 2 1/2 str	1right arm facing 3 str

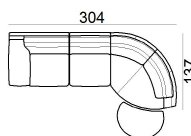
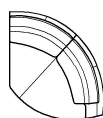
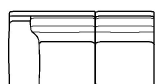

L 184 H93 D97 SH44 SD57	L 120 H93 D137 SH44 SD57	L 120 H93 D137 SH44 SD57	L - H- D- SH- SD- X59
320	071	072	X59
1left arm facing 3 str	rhf end corner	lhf end corner	320 + 071 + b05

↓ fold following the dotted line ↓

