



CORVETTE

product code	C842PR03
product description	CORVETTE Table 200x90 acacia wh wash poly-cement grey Table with solid acacia structure. Finishing with Nano oil PNZ long UV protection and durability. Top in poly-cement Superstone. For indoor and outdoor under cover use.

product sizes

height x width x depth (cm)	76	x	200	x	90
product weight (Kg)	54				

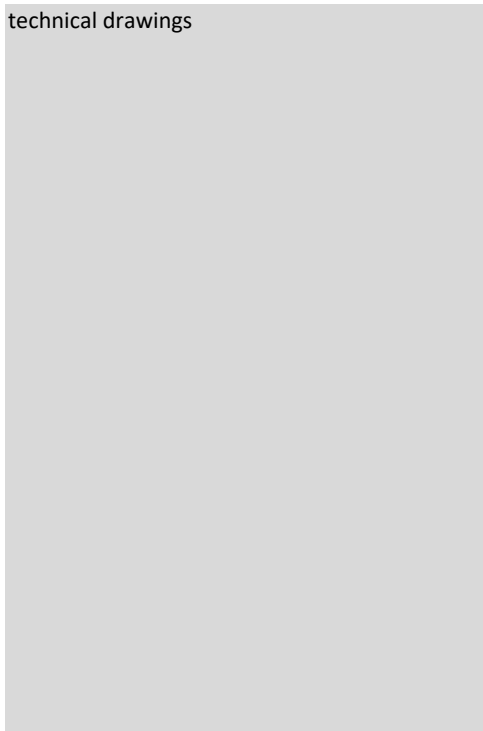

product features

use (domestic/office)	Domestic
applicance (inner/outer)	Outer under cover
extendible (yes/no)	No
adjustable height (yes/no)	No
foldable (yes/no)	No
up to seats	8
max. load (Kg)	70
top material	MDF
top finishing	Superstone finishing (composed by cement, stone powder and refined ores)
top thickness	8 mm
leaf material	
leaf finishing	
number of leaves	
stored inside (yes/no)	No

legs material	Eucalyptus wood (<i>Eucalyptus grandis</i>). Wood origin country: Uruguay
legs finishing	Brushed with white washed. PU lacquered finishing (4 layers to make it UV resistant)
feet protection (yes/no)	Yes
adjustable feet (yes/no)	Yes

RAL Specifications	
size and shape variation (yes/no)	No
color variation (yes/no)	No
other details	

general warnings
Do not use abrasive products like acetones, bleaches, solvents, etc. To extend the durability of wooden outdoor furniture please follow the instructions below:

specific use and care instructions
Clean with a mild soapy solution and dry immediately. We strongly recommend varnishing/re-staining the wood regularly (once a year) to prevent dryness, cracks and moisture absorption.

specific use and care instructions for outdoor furniture
Store the furniture in a dry indoor place. If you want to leave it outdoors, protect it with a waterproof cover in autumn winter and rainy season.

years of guarantee made according to
2
Manufactured according to EN-581:2015 for outdoor furniture.

good to know
Superstone is weather resistant, fire resistant, shatter resistant and environmental friendly.

assembly

assembly required (yes/no)	Yes
difficulty of assembly (hard/medium/easy)	Easy
assembly time (min)	20
people required	2
assembly suggestions	Put the top upside down and screw the legs

assembly instructions

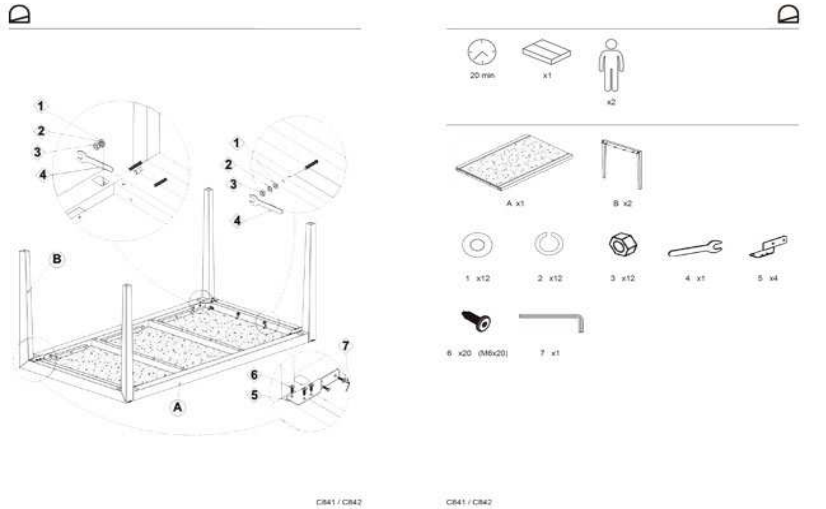

CB41 / CB42

CB41 / CB42

packaging

units per lot	1
cbm (m3) / gross weight (Kg)	0,343 / 59,4
nº of boxes	1

box 1	1
description	FULL ITEM
description box	CORVETTE Table 200x90 acacia wh wash poly-cement grey
height x width x depth (cm)	17 x 206 x 98
cbm (m3) / gross weight (Kg) / net weight (Kg)	0,343 / 59,4 / 54

box 2	
description	
description box	
height x width x depth (cm)	x x
cbm (m3) / gross weight (Kg) / net weight (Kg)	/ /

box 3	
description	
description box	
height x width x depth (cm)	x x
cbm (m3) / gross weight (Kg) / net weight (Kg)	/ /