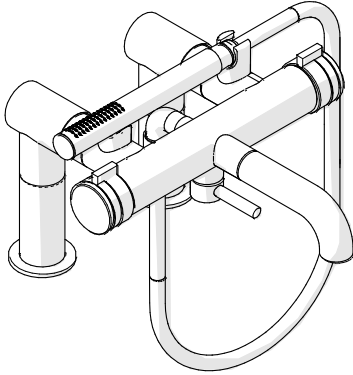

Style No. DBXT40

Exposed Deck Mounted Tub Filler with Handshower

**SPECIFICATIONS:**

Handle Spread: 10-7/16" (NOT ADJUSTABLE)
 Inlet Connection Size: 3/4"
 Inlet Connection Type: Male NPT
 Inlet Connection Spread: 5-7/8" (NOT ADJUSTABLE)
 Maximum Water Pressure: 80psi
 Minimum Water Pressure: 20psi
 Fittings Hole Diameter: 1-1/4"
 Recommended Water Pressure: 45psi
 Restricted Maximum Flow Rate: 2.0gpm [7.6L/min][†]
 Spout Reach: 11-5/8" (center of inlet to center of outlet)

[†] Only the HANDSHOWER has a restricted flow rate.

IMPORTANT:

- To ensure this product is installed properly, you must read and follow these guidelines.
- The owner/user of this product must keep this information for future reference.
- Be sure your installation conforms to federal state, and local codes. Anti-scald protection is the responsibility of the installer and according to applicable codes.
- In the State of Massachusetts, all installation must comply with the rules and regulations set forth within 248 CMR.
- This product must be installed by a professional licensed contractor.
- Product should be on-site prior to rough-in. This allows the installer to visualize the installation and verify the inlet connection spread.
- Refer to the specification and assembly drawings attached. Product is sold partially assembled but shown fully disassembled for illustrative and service purposes only.
- Check tub measurements to assure the spout projects far enough into the tub.

- Inspect this product to ensure you have all parts required for proper installation.
- Use only a strap wrench or protected/smooth-jaw wrench on any finished surface.
- Run 3/4" supply lines for maximum flow.
- Install accessible hot and cold service stop valve to facilitate servicing.

ROUGH-IN:

1. Run well supported 3/4" hot and cold supply lines for maximum water flow. The inlet supply spread is 5-7/8" on-center and is NOT ADJUSTABLE. 1-1/4" drilling for the mounting holes is recommended.

TUB FILLER INSTALLATION:

- Verify the 5-7/8" inlet supply spread prior to installation.
- See figure 01 for Steps 2 - 7.

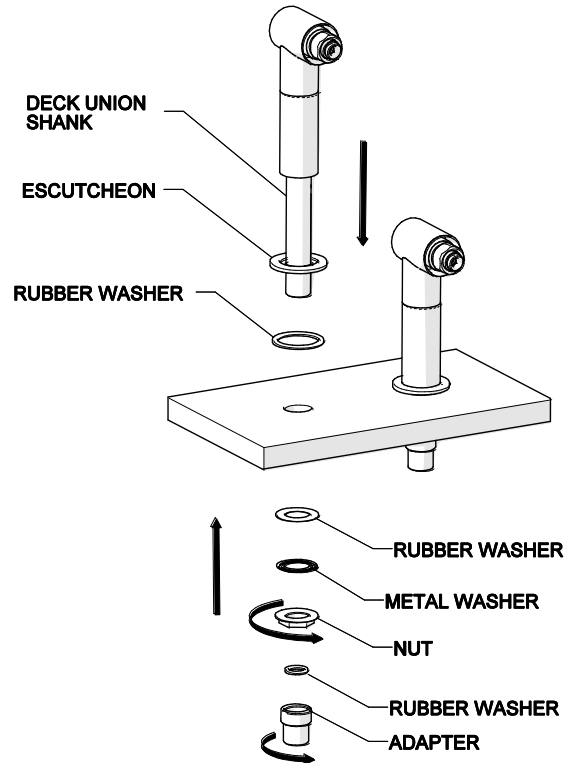

FIGURE - 01

2. Unthread 3/4" NPT ADAPTER; remove WASHER. Unthread NUT; remove METAL WASHER and RUBBER WASHER from the DECK UNION SHANK.
3. Slide the ESCUTCHEON and RUBBER WASHER over the DECK UNION SHANK then insert the union into the deck, making sure that the deck union tube sits properly in the escutcheon.

These guidelines have been prepared for the professional contractor to aid in the installation of:
 DECIBEL WALL MOUNTED EXPOSED TUB FILLER WITH METAL KNOB HANDLE AND HANDSHOWER (STYLE No.
 DBXT20)
 All dimensions are based on original specification and are subject to change and variation.
 Please consult your Design Associate for current specifications.

WATERWORKS
 STUDIO

4. Re-install the mounting hardware onto the SHANK.
5. Tighten the NUT up against the underside of the deck to secure the union.
6. Insert the WASHER into the ADAPTER, and then thread the ADAPTER onto the union.
7. Repeat steps 2 - 6 to install the second deck union.
8. Unthread the COLLARS from the VALVE BODY to expose the UNION NUTS. See Figure - 02 & 02A.

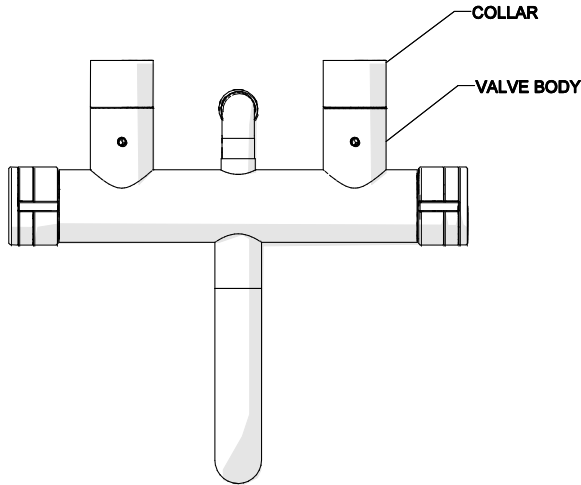

FIGURE - 02

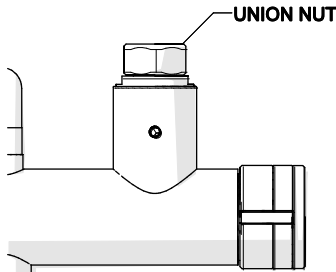

FIGURE - 02A

9. Insert the COLLARS into the deck union elbows. Make sure the threaded ends of the COLLARS are facing out. See Figure - 03.

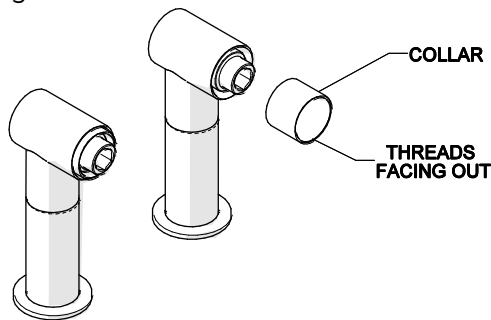

FIGURE - 03

10. Hold the VALVE BODY up to the DECK UNION ELBOWS and thread the UNION NUTS onto the exposed nipples. Make sure that a WASHER is inside each nut. See Figure - 04.

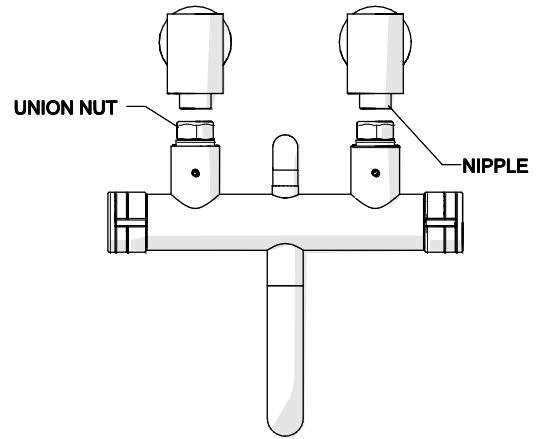

FIGURE - 04

11. Securely tighten the UNION NUTS then thread the COLLARS back onto the VALVE BODY to conceal the UNION NUTS. See Figure - 04A.

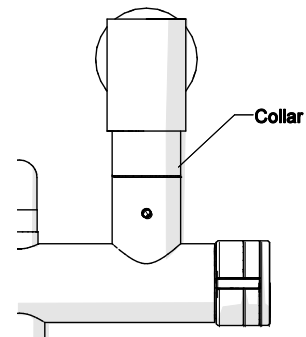

FIGURE - 04A

HANDSHOWER INSTALLATION:

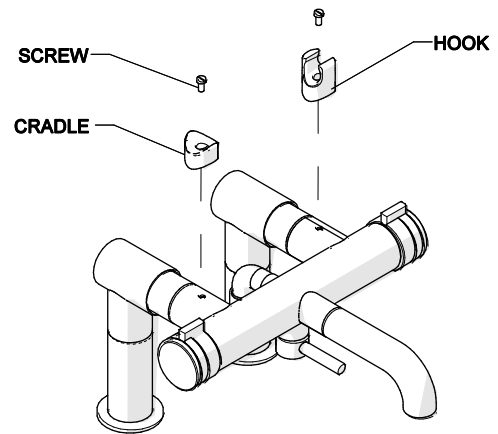

FIGURE - 05

These guidelines have been prepared for the professional contractor to aid in the installation of: DECIBEL WALL MOUNTED EXPOSED TUB FILLER WITH METAL KNOB HANDLE AND HANDSHOWER (STYLE No. DBXT20)
 All dimensions are based on original specification and are subject to change and variation.
 Please consult your Design Associate for current specifications.

WATERWORKS
 STUDIO

12. Install the HANDSHOWER HOOK and CRADLE as shown in Figure - 05 onto the VALVE BODY using the SCREWS provided. Ensure the hook is installed with the wider opening facing towards the inside.
 13. Install the check valve housing onto the handshower elbow. Make sure the check valve is inside the housing and to include the washer between the housing and elbow.
- **NOTE:** A CHECK VALVE is located in the handshower elbow on the back side of the tub filler body.

INSPECT THE INSTALLATION:

14. Remove the flow straightener from the spout using the aerator tool provided.
15. Turn on the supplies then open the hot and cold valves to flush out the debris in the supply lines before diverting to the handshower. To divert to the handshower turn the lever on the bottom of the valve.
16. Carefully inspect all the connections for leaks and check for proper operation.
17. Re-install the flow straightener.

SERVICING:

- Service stops (not provided) should be turned off prior to servicing.
- See Figure - 06 for Steps 18 & 19.
18. To access the hot and cold CARTRIDGES, unthread the HANDLE ASSEMBLY.
 19. Remove the CARTRIDGES using a 17mm wrench.

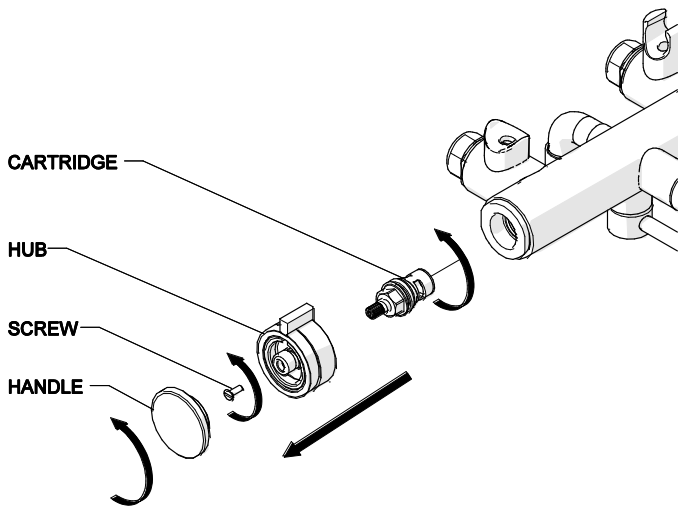

FIGURE - 06

- See Figure - 07 for Steps 20 - 23.

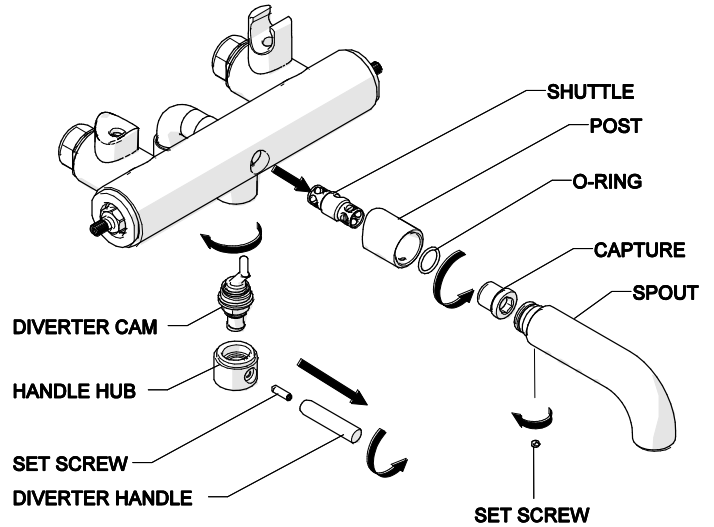

FIGURE - 07

20. Unthread DIVERTER HANDLE, and remove DIVERTER HUB.
 21. Remove DIVERTER CAM ASSEMBLY.
 22. Loosen SET SCREW on SPOUT, and then remove the SPOUT. Unthread DIVERTER CAPTURE and remove O-RING and POST.
 23. Remove SHUTTLE.
- If further assistance is required, please contact Product Support at 1-800-927-2120 (8am-6pm EST).
- See service part document for parts ordering, available on WATERWORKS.COM.

These guidelines have been prepared for the professional contractor to aid in the installation of:
DECIBEL WALL MOUNTED EXPOSED TUB FILLER WITH METAL KNOB HANDLE AND HANDSHOWER (STYLE No. DBXT20)
All dimensions are based on original specification and are subject to change and variation.
Please consult your Design Associate for current specifications.

WATERWORKS
STUDIO