

Features

- Single-speed whirlpool offers performance and value, with 6 fully adjustable jets.
- Hydromassage flow and direction can be controlled at each jet.
- Oval-shaped basin creates a graceful and spacious bathing experience.
- Molded lumbar support and armrests offer extra comfort while bathing.
- Multiple pump location options give you more choices for installation and access. (See specification sheet for pump locations.)

Material

- Acrylic.

Hydrotherapy

- Whirlpool.

Installation

- Reversible drain.
- Drop-in.

Recommended Products/Accessories

K-1491 Bath/Whirlpool Pillow
K-1601 Bath/Whirlpool Footstop
K-24916 Wireless Music Kit
K-7213 27" Cable Bath Drain
K-7214 27" Cable Bath Drain
K-23726 Drain treatment
K-23732 Tub & shower cleaner
K-7161-AF 1-1/2" adjustable pop-up drain above- or through-floor
K-37383 Rough-in cable bath drain, PVC, 30" cable with tubing
K-7265 Brass toe tap bath drain
K-37386 rough-in cable drain, PVC, 30" cable
K-7259 Brass toe tap bath drain
K-7166-AF Bath Drain



Codes/Standards



ASME A112.19.7/CSA B45.10
CSA B45.5/IAPMO Z124
UL 1795

**KOHLER® Plastic Baths and Receptors
Lifetime Limited Warranty
KOHLER® Hydrotherapy Components
Five-Year Limited Warranty**

See website for detailed warranty information.

Available Colors/Finishes

Color tiles intended for reference only.

| Color | Code | Description |
|--------------------------------------------------------------------------------------|------|-------------|
|  | 0 | White |
|  | 96 | Biscuit |
|  | 47 | Almond |

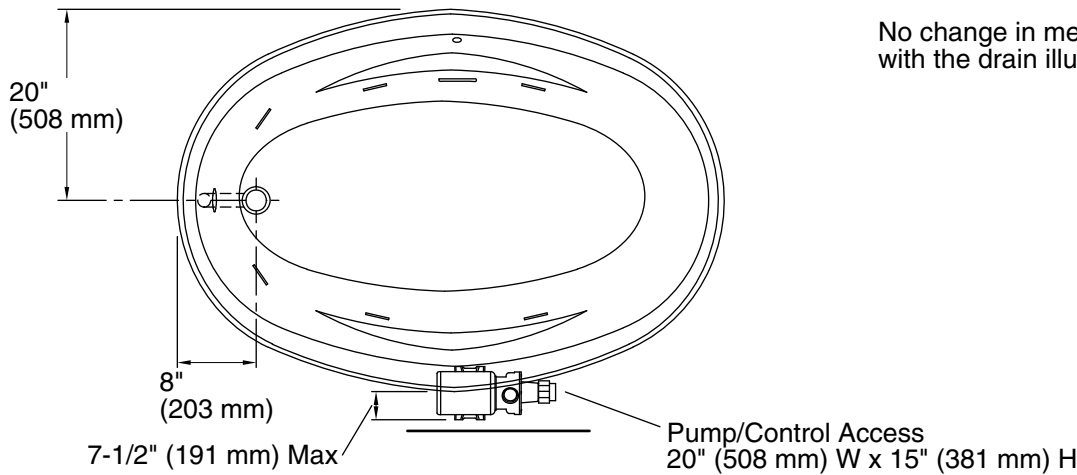

No change in measurements if connected with the drain illustrated. (K-11677)

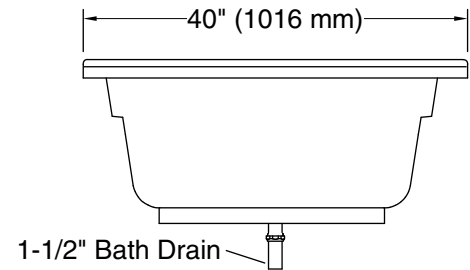
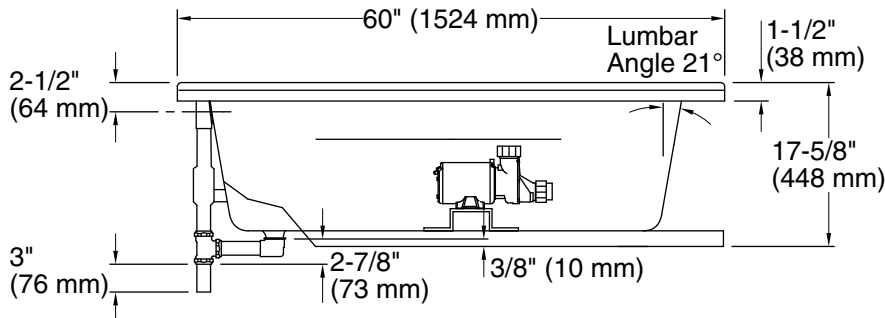
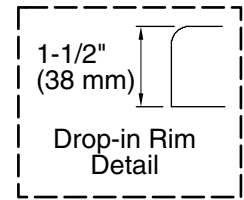

Required Electrical Service

One dedicated circuit required, protected with Class A Ground-Fault Circuit-Interrupter (GFCI). Outside North America, this device may be known as a Residual Current Device (RCD).

Pump: 120 V, 15 A, 60 Hz

Technical Information

All product dimensions are nominal.

| | |
|------------------------------|---------------------------------------------------|
| Installation: | Drop-in |
| Drain location: | End |
| Basin area, bottom: | 46" x 19" (1168 mm x 483 mm) |
| Basin area, top: | 55" x 29" (1397 mm x 737 mm) |
| Weight: | 56 lbs (25.4 kg) |
| Minimum floor load: | 32 lbs/ft ² (156.2 kg/m ²) |
| Water depth: | 14" (356 mm) |
| Water capacity: | 54 gal (204.4 L) |
| Template: | Drop-in, 114859-7, required, included |
| Electrical component rating: | Pump: 120 V, 7.5 A, 60 Hz |
| Pump speed: | Single |

Notes

Measure your actual product for rough-in details. Install this product according to the installation instructions.

The hot water supply should be 70% of the capacity of the bath or greater. Installations will vary.