

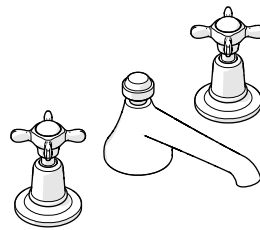

ESTB. 1978

# WATERWORKS

## SERVICE PARTS



### **STYLE EALS01**

Easton Classic Low Profile Three Hole Deck Mounted Lavatory Faucet  
with Metal Cross Handles

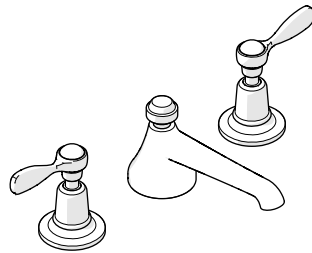

### **STYLE EALS02**

Easton Classic Low Profile Three Hole  
Deck Mounted Lavatory Faucet  
with Metal Lever Handles

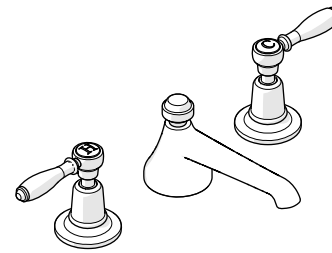

### **STYLE EALS03**

Easton Classic Low Profile Three Hole  
Deck Mounted Lavatory Faucet  
with White Porcelain Lever Handles

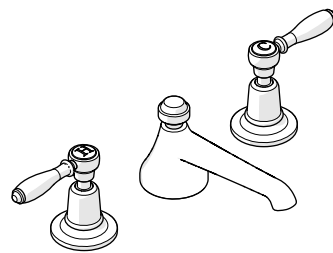

### **STYLE EALS04**

Easton Classic Low Profile Three Hole  
Deck Mounted Lavatory Faucet  
with Black Porcelain Lever Handles

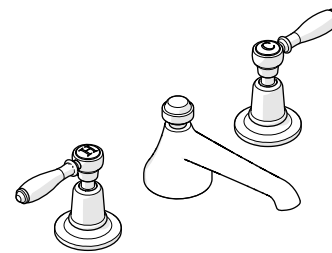

### **STYLE EALS05**

Easton Classic Low Profile Three Hole  
Deck Mounted Lavatory Faucet  
with Oak Lever Handles

---

WELCOME TO

# WATERWORKS

For over three decades, Waterworks has transformed the bath through an absolute commitment to design authenticity, innovation and quality. A blend of scholarly appreciation and applied experience guarantees mechanical integrity, meticulous craftsmanship, and timeless designs.

---

**TO ORDER PARTS CALL  
1 (800) 927-2120 (EXT 2)**

Order by part number and specify color, finish, or other options if required.

**PRODUCT SUPPORT**

Our Product Support team provides troubleshooting and technical problem resolution, including replacement parts and installation recommendations throughout the life of your product.

Product Support is available Monday through Friday, 8AM-6PM EST.

**LIMITED LIFETIME  
WARRANTY**

Our warranty covers repair and replacement of Waterworks products if within the applicable coverage period and deemed defective by Waterworks. Waterworks will, at its option, repair or replace such products; this does not include installation costs, labor charges, or other incidental or consequential costs.

To obtain your complete warranty or inquire about warranty service, please visit us at [www.waterworks.com](http://www.waterworks.com) or contact our Product Support Team.



ESTB. 1978

WATERWORKS

## MAIN KITS

STYLES: EALS01, EALS02, EALS03,  
EALS04, EALS05

**103553**  
HOT PORCELAIN INDICE

**103534\***  
METAL LEVER HANDLE

**103554\***  
HOT METAL INDICE

**103537\***  
WHITE PORCELAIN  
LEVER HANDLE

**103538\***  
BLACK PORCELAIN  
LEVER HANDLE

**103539\***  
OAK LEVER  
HANDLE

**103570\***  
ESCUTCHEON

**103474**  
COUNTERCLOCKWISE ON  
SIDEBOY

**103475**  
HOSE

**103561\***  
SPOUT

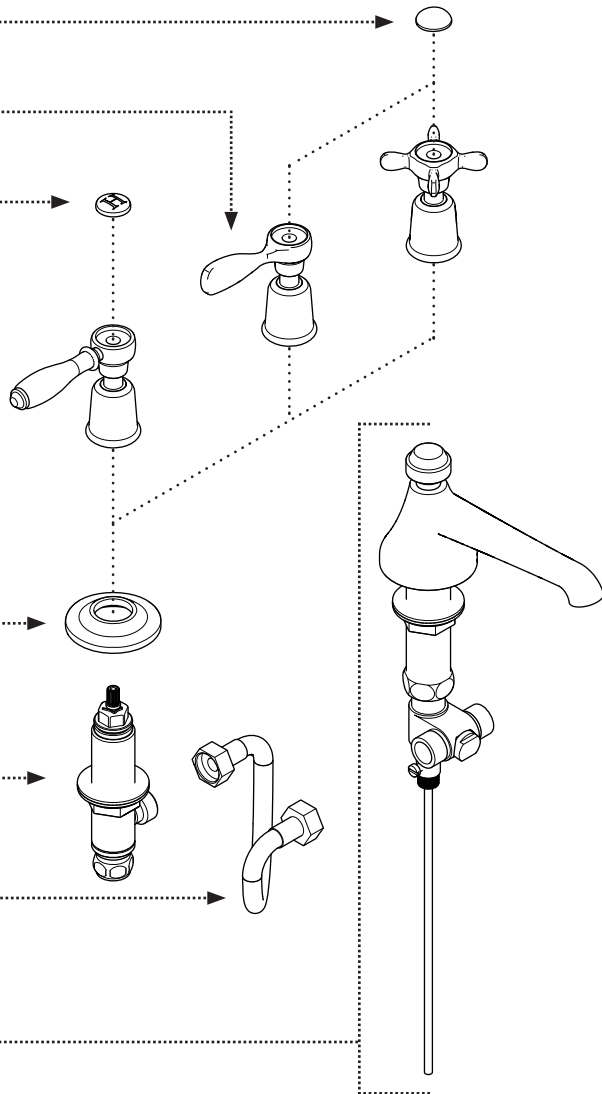

\*FINISH/COLOR MUST BE SPECIFIED WHEN ORDERING  
++SUPPLIED AS A PAIR

**103552\***  
COLD METAL INDICE

**103551**  
COLD PORCELAIN INDICE

**103607\***  
CROSS HANDLE

**103474**  
COUNTERCLOCKWISE ON  
SIDEBOY  
**103504**  
CLOCKWISE ON SIDEBOY  
[LEVER HANDLE ONLY]

**103476\***  
DRAIN

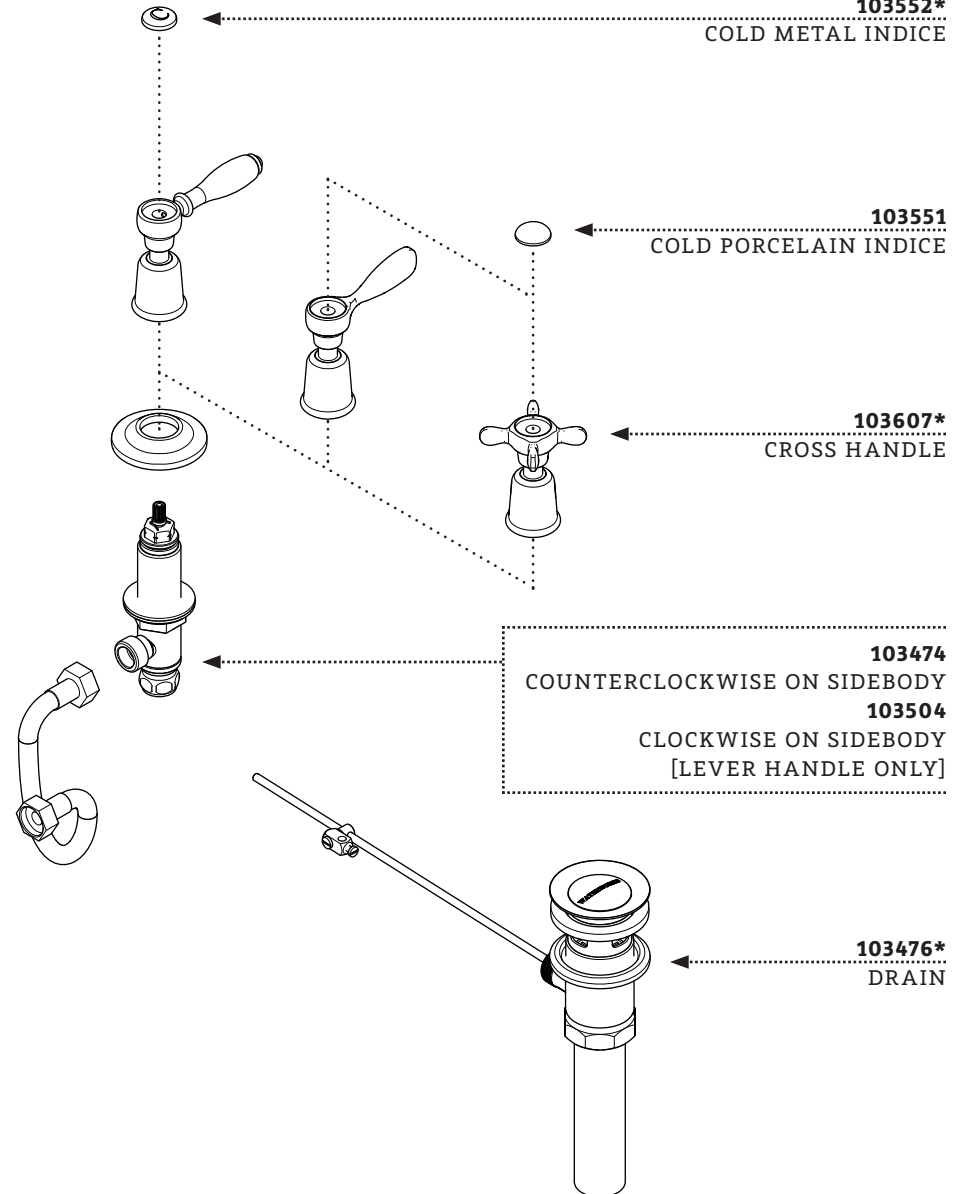



ESTB. 1978

WATERWORKS

### KIT COMPONENTS

**STYLES: EALS01, EALS02, EALS03,  
EALS04, EALS05**

**103555\***  
LIFT ROD

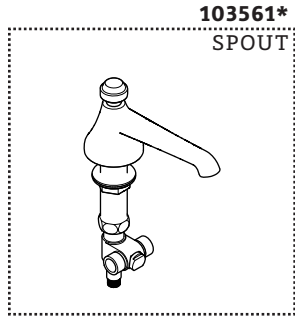
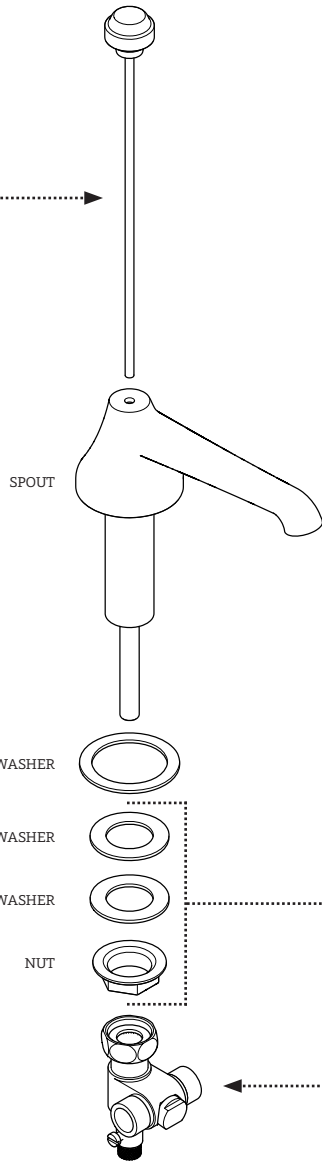

**103471**  
MOUNTING HARDWARE

**103567**  
TEE

\*FINISH/COLOR MUST BE SPECIFIED WHEN ORDERING  
++SUPPLIED AS A PAIR

### KIT COMPONENTS

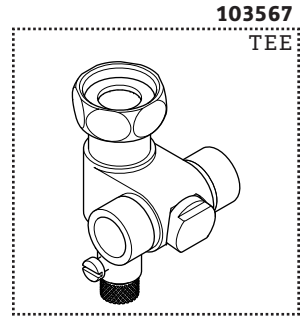
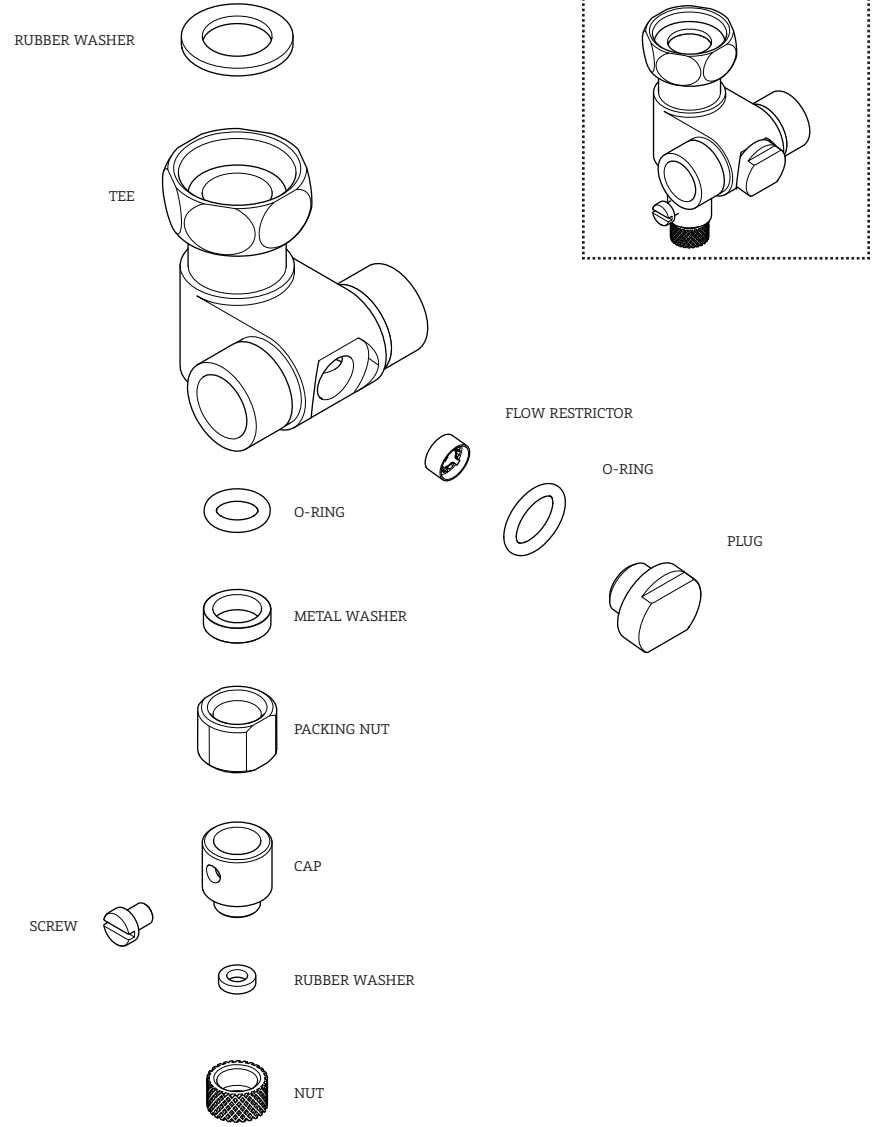



ESTB. 1978

WATERWORKS

**KIT COMPONENTS**

**STYLES: EALS01, EALS02, EALS03,  
EALS04, EALS05**



POP-UP KNOB



RUBBER WASHER

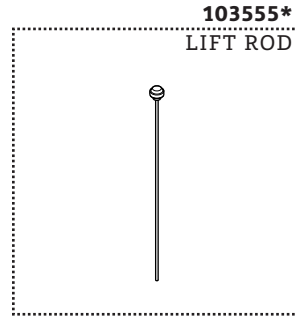

103555\*

LIFT ROD

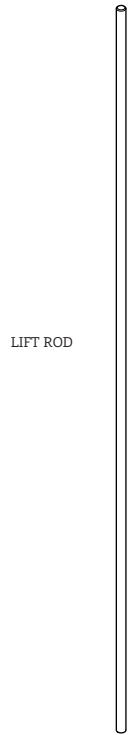

LIFT ROD

\*FINISH/COLOR MUST BE SPECIFIED WHEN ORDERING  
++SUPPLIED AS A PAIR

**KIT COMPONENTS**

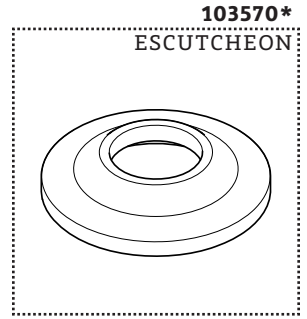

103570\*

ESCUTCHEON

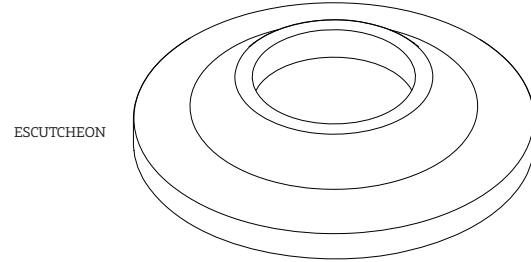

ESCUTCHEON

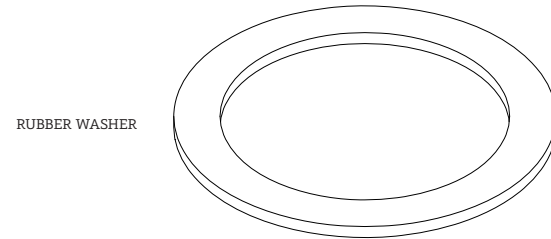

RUBBER WASHER



ESTB. 1978

WATERWORKS

**KIT COMPONENTS**

**STYLES: EALS01, EALS02, EALS03,  
EALS04, EALS05**

**\*FINISH/COLOR MUST BE SPECIFIED WHEN ORDERING  
++SUPPLIED AS A PAIR**

**KIT COMPONENTS**

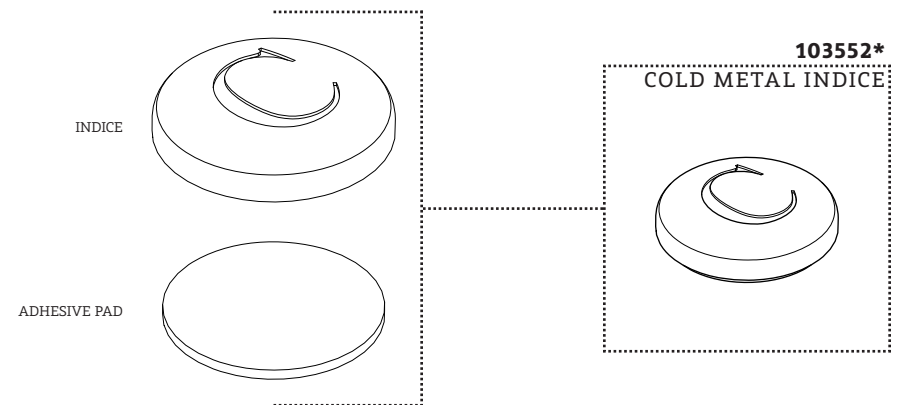
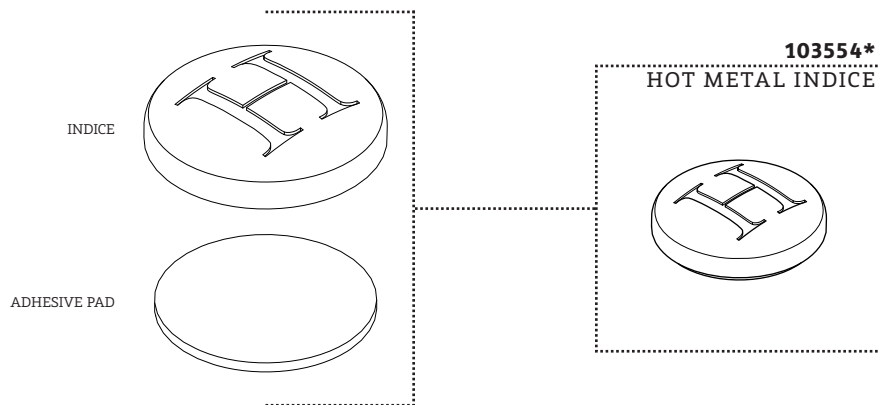
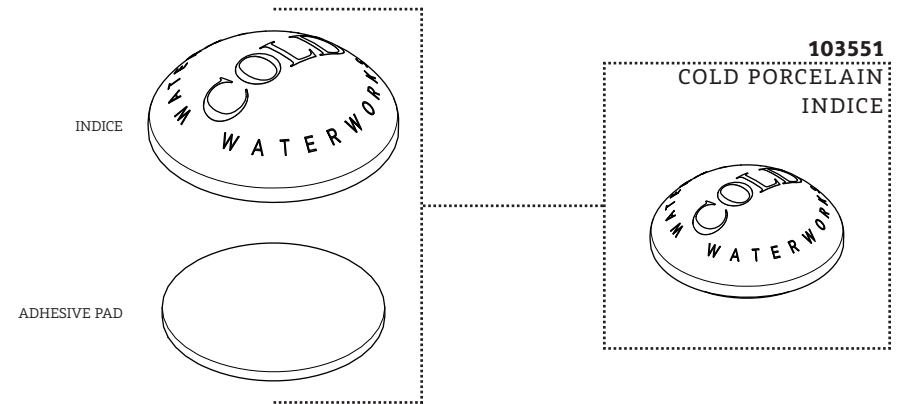
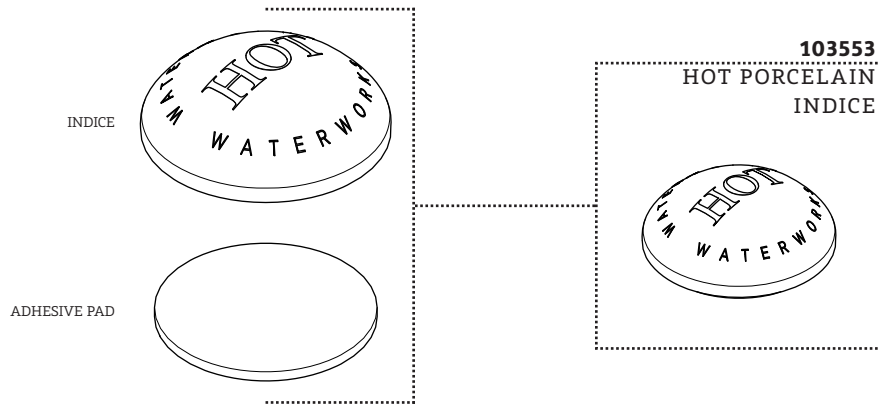



ESTB. 1978

WATERWORKS

### KIT COMPONENTS

**STYLES: EALS01, EALS02, EALS03,  
EALS04, EALS05**

**103471**  
MOUNTING HARDWARE

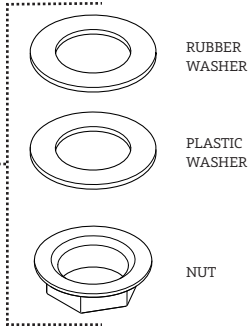

**337847**  
COUNTERCLOCKWISE ON  
CARTRIDGE

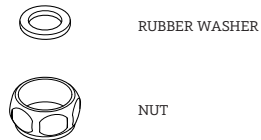
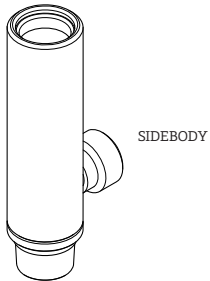

**103474**  
COUNTERCLOCKWISE  
ON SIDEBODY

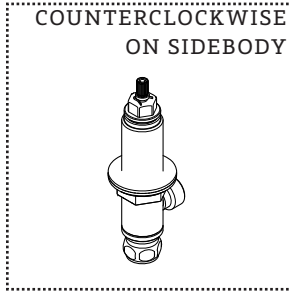

\*FINISH/COLOR MUST BE SPECIFIED WHEN ORDERING  
++SUPPLIED AS A PAIR

### KIT COMPONENTS

**103471**  
MOUNTING HARDWARE

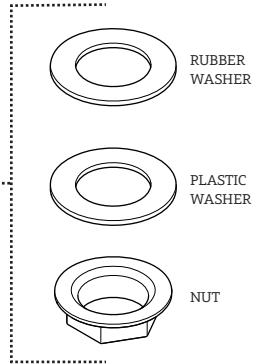

**258790**  
CLOCKWISE ON  
CARTRIDGE

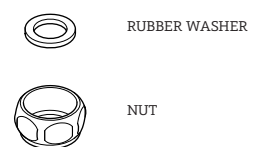
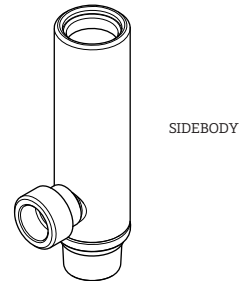

**103504**  
CLOCKWISE ON  
SIDEBODY

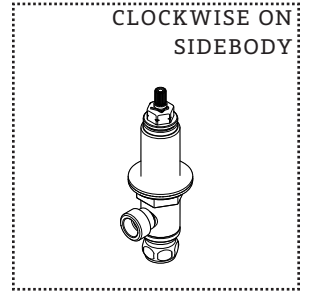



ESTB. 1978

WATERWORKS

### KIT COMPONENTS

STYLES: EALS01, EALS02, EALS03,  
EALS04, EALS05

064346\*  
DRAIN STOPPER

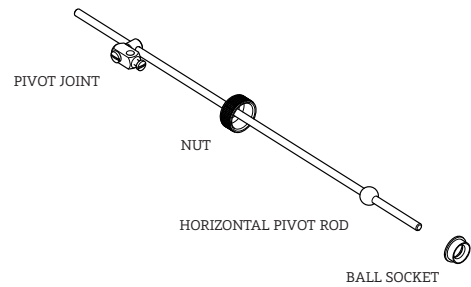

PIVOT JOINT

NUT

HORIZONTAL PIVOT ROD

BALL SOCKET

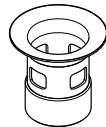
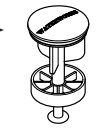

DRAIN FLANGE

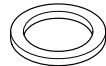

FOAM WASHER



LOWER DRAIN GASKET



LOWER DRAIN BODY



RUBBER WASHER



TAILPIECE



TAILPIECE NUT

103476\*  
DRAIN

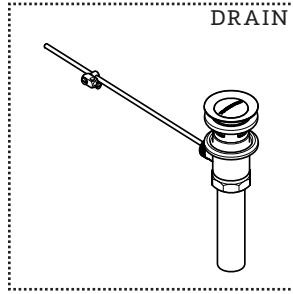

\*FINISH/COLOR MUST BE SPECIFIED WHEN ORDERING  
++SUPPLIED AS A PAIR

### KIT COMPONENTS

064346\*

DRAIN STOPPER

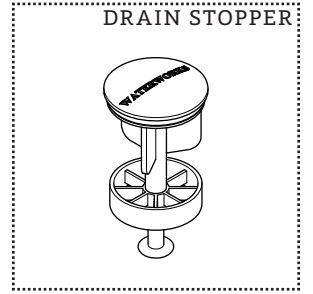

O-RING

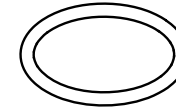

DRAIN STOPPER



DRAIN STRAINER

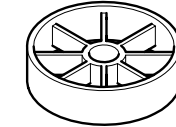

NUT



SCREW

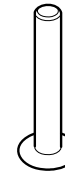





ESTB. 1978

WATERWORKS

**STYLES: EALS01, EALS02, EALS03,  
EALS04, EALS05**

**SERVICE PARTS INDEX**

<u>STYLE</u>	<u>DESCRIPTION</u>	<u>PG</u>
103538*	BLACK PORCELAIN LEVER HANDLE	2
258790	CLOCKWISE ON CARTRIDGE	11
103504	CLOCKWISE ON SIDEBODY	11
103552*	COLD METAL INDICE	9
103551	COLD PORCELAIN INDICE	9
337847	COUNTERCLOCKWISE ON CARTRIDGE	10
103474	COUNTERCLOCKWISE ON SIDEBODY	10
103607*	CROSS HANDLE	3
103476*	DRAIN	12
064346*	DRAIN STOPPER	13
103570*	ESCUTCHEON	7
103475	HOSE	2
103554*	HOT METAL INDICE	8
103553	HOT PORCELAIN INDICE	8
103555*	LIFT ROD	6
103534*	METAL LEVER HANDLE	2
103471	MOUNTING HARDWARE	11
103539*	OAK LEVER HANDLE	2
103561*	SPOUT	4
103567	TEE	5

DOCUMENT: SPEA01\_REV01

\*FINISH/COLOR MUST BE SPECIFIED WHEN ORDERING  
++SUPPLIED AS A PAIR

**SERVICE PARTS INDEX**

<u>STYLE</u>	<u>DESCRIPTION</u>	<u>PG</u>
103537*	WHITE PORCELAIN LEVER HANDLE	2

DOCUMENT: SPEA01\_REV01



ESTB. 1978

WATERWORKS

**NOTES**

**STYLES: EALS01, EALS02, EALS03,  
EALS04, EALS05**

\*FINISH/COLOR MUST BE SPECIFIED WHEN ORDERING  
++SUPPLIED AS A PAIR

**NOTES**



ESTB. 1978

WATERWORKS

**PRODUCT SUPPORT**

60 BACKUS AVENUE  
DANBURY, CT 06810

1 (800) 927-2120 (EXT 2)

[WWW.WATERWORKS.COM](http://WWW.WATERWORKS.COM)