



ESTB. 1978

WATERWORKS

SERVICE PARTS

EASTON

Classic Pressure Balance



STYLE EAPB82
Control Valve Trim
with Metal Lever Handles

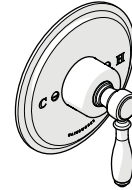

STYLE EAPB83
Control Valve Trim
with White Porcelain Lever Handles



STYLE EAPB84
Control Valve Trim
with Black Porcelain Lever Handles

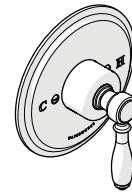

STYLE EAPB85
Control Valve Trim
with Oak Lever Handles

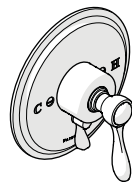

STYLE EAPB92
with Diverter Trim
with Metal Lever Handles

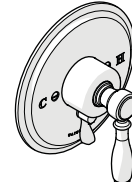

STYLE EAPB93
with Diverter Trim
with White Porcelain Lever Handles



STYLE EAPB94
with Diverter Trim
with Black Porcelain Lever Handles

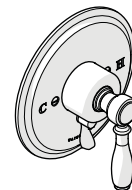

STYLE EAPB95
with Diverter Trim
with Oak Lever Handles

WELCOME TO

WATERWORKS

For over three decades, Waterworks has transformed the bath through an absolute commitment to design authenticity, innovation and quality. A blend of scholarly appreciation and applied experience guarantees mechanical integrity, meticulous craftsmanship, and timeless designs.

**TO ORDER PARTS CALL
1 (800) 927-2120 (EXT 2)**

Order by part number and specify color, finish, or other options if required.

PRODUCT SUPPORT

Our Product Support team provides troubleshooting and technical problem resolution, including replacement parts and installation recommendations throughout the life of your product.

Product Support is available Monday through Friday, 8AM-6PM EST.

**LIMITED LIFETIME
WARRANTY**

Our warranty covers repair and replacement of Waterworks products if within the applicable coverage period and deemed defective by Waterworks. Waterworks will, at its option, repair or replace such products; this does not include installation costs, labor charges, or other incidental or consequential costs.

To obtain your complete warranty or inquire about warranty service, please visit us at www.waterworks.com or contact our Product Support Team.



ESTB. 1978

WATERWORKS

MAIN KITS

**STYLES: EAPB82, EAPB83, EAPB84, EAPB85,
EAPB92, EAPB93, EAPB94, EAPB95**

*FINISH/COLOR MUST BE SPECIFIED WHEN ORDERING
++SUPPLIED AS A PAIR

103573*
FACEPLATE TRIM

103574*
FACEPLATE TRIM

103568*
TRIM SCREW

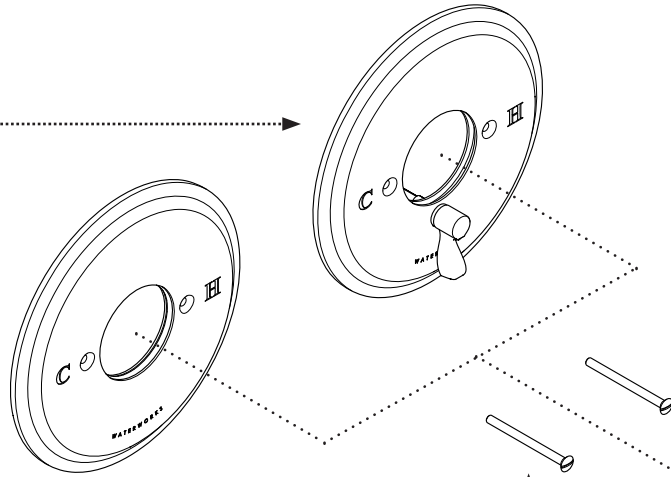

103532*
GLAND COVER

103558*
NOSE CONE

103540*
METAL LEVER
HANDLE

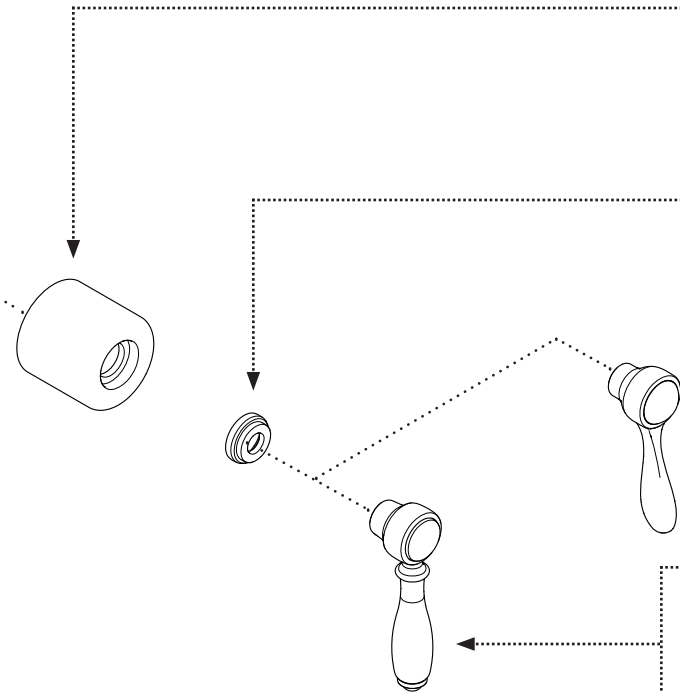

103542*
WHITE PORCELAIN
LEVER HANDLE
103541*
BLACK PORCELAIN
LEVER HANDLE
103608*
OAK LEVER HANDLE



ESTB. 1978

WATERWORKS

KIT COMPONENTS

**STYLES: EAPB82, EAPB83, EAPB84, EAPB85,
EAPB92, EAPB93, EAPB94, EAPB95**

103574*

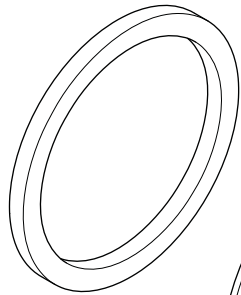
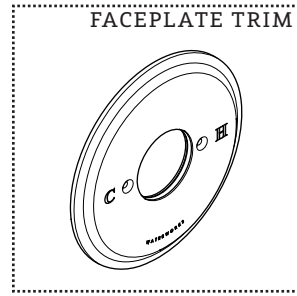

GASKET

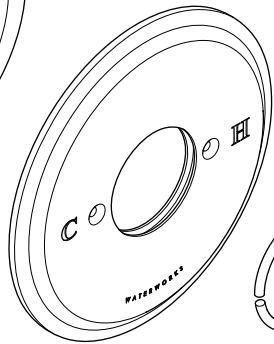

TRIM PLATE

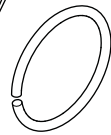

O-RING CORD

*FINISH/COLOR MUST BE SPECIFIED WHEN ORDERING
++SUPPLIED AS A PAIR

KIT COMPONENTS

103573*

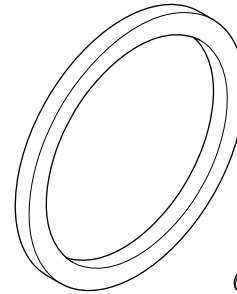
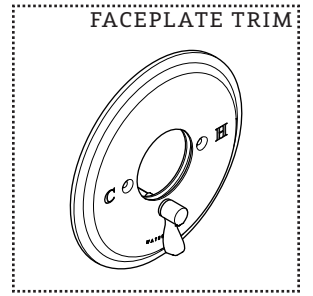

GASKET



CLIP



PLASTIC
WASHER

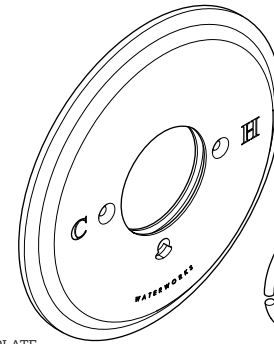

TRIM PLATE



O-RING CORD

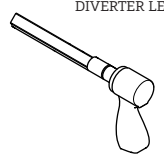

DIVERTER LEVER



ESTB. 1978

WATERWORKS

**STYLES: EAPB82, EAPB83, EAPB84, EAPB85,
EAPB92, EAPB93, EAPB94, EAPB95**

KIT COMPONENTS

103540*

METAL LEVER HANDLE

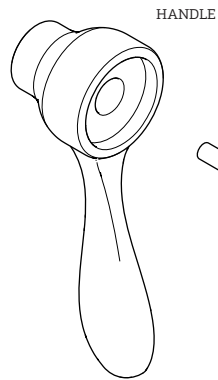
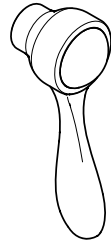

103543

HANDLE SCREW

POST



ADHESIVE PAD



103549

**BLANK PORCELAIN
INDICE**

INDICE

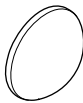

*FINISH/COLOR MUST BE SPECIFIED WHEN ORDERING
++SUPPLIED AS A PAIR

KIT COMPONENTS

103542*

WHITE PORCELAIN LEVER HANDLE

103541*

BLACK PORCELAIN LEVER HANDLE

103608*

OAK LEVER HANDLE

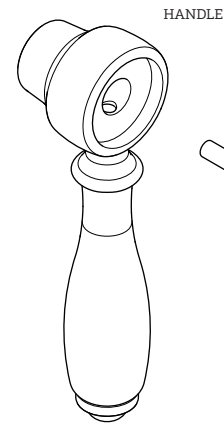
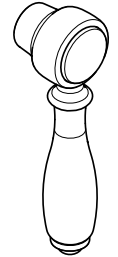

103543

HANDLE SCREW

POST



ADHESIVE PAD



103550*

BLANK METAL INDICE

INDICE





ESTB. 1978

W A T E R W O R K S

**STYLES: EAPB82, EAPB83, EAPB84, EAPB85,
EAPB92, EAPB93, EAPB94, EAPB95**

SERVICE PARTS INDEX

<u>STYLE</u>	<u>DESCRIPTION</u>	<u>PG</u>
103541*	BLACK PORCELAIN LEVER HANDLE	7
103550*	BLANK METAL INDICE	7
103549	BLANK PORCELAIN INDICE	6
103574*	FACEPLATE TRIM	4
103573*	FACEPLATE TRIM	5
103532*	GLAND COVER	3
103543	HANDLE SCREW	7
103540*	METAL LEVER HANDLE	6
103558*	NOSE CONE	3
103608*	OAK LEVER HANDLE	7
103568*	TRIM SCREW	2
103542*	WHITE PORCELAIN LEVER HANDLE	7

*FINISH/COLOR MUST BE SPECIFIED WHEN ORDERING
++SUPPLIED AS A PAIR

NOTES

DOCUMENT: SPEA09_REV01



ESTB. 1978

WATERWORKS

PRODUCT SUPPORT

60 BACKUS AVENUE
DANBURY, CT 06810

1 (800) 927-2120 (EXT 2)

WWW.WATERWORKS.COM