

COVERED

- EATU01** (CROSS HANDLE)
- EATU02-K** (METAL LEVER HANDLE)
- EATU03-K** (WHITE PORCELAIN LEVER HANDLE)
- EATU04-K** (BLACK PORCELAIN LEVER HANDLE)
- EATU05-K** (OAK LEVER HANDLE)

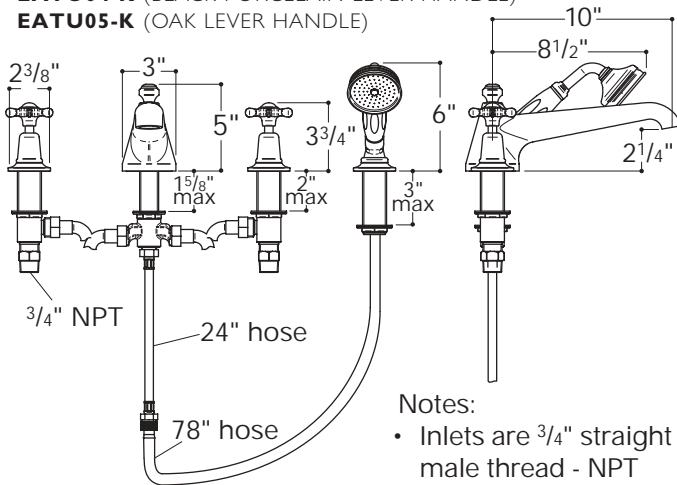

Notes:

- Inlets are 3/4" straight male thread - NPT adaptors provided
- Drilling hole size: 1 1/2"
- Must have access panel for servicing.
- Consult your local building codes for anti-scald requirements.

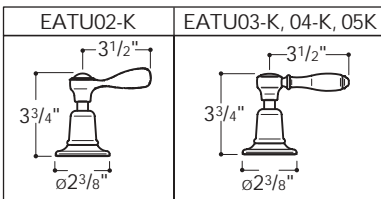

INSTALLATION GUIDELINES:

IMPORTANT:

- To ensure this product is installed properly, you must read and follow these guidelines.
- The owner/user of the faucet must keep this information for future reference.
- Be sure your installation conforms to local codes. It is the responsibility of the plumber to provide anti-scald protection.
- Accessible shut-off valves, which will facilitate servicing, are recommended for the hot and cold feed lines.
- An access panel is necessary for future servicing.
- Inspect this product to assure you have all parts required for proper installation.
- Use only a strap wrench or protected/smooth-jaw wrench on any finished surface.
- Run 3/4" supply lines for maximum water flow.
- Do NOT use putty during this installation.
- Refer to the specification and assembly drawings attached. Faucet is sold partially assembled but shown fully disassembled for illustrative and service purposes only.

SIDE VALVE INSTALLATION:

1. With the lock nut (15) and lower sealing gasket (14) installed on the side valve (13), insert the side valve into the hole in the mounting surface so at least 1" of threads are exposed above the deck surface.
2. Place the upper sealing gasket (11) onto the side valve then thread the base escutcheon (10) onto the side valve.
3. Thread the handle assembly (1-9) onto the side valve until it stops. Hand tight is adequate; if this assembly is too tight, the handle will bind.
4. Unthread the base escutcheon until it contacts the gland nut (6), which will assure proper side valve height.
5. Tighten the lock nut up against the underside of the mounting surface to secure the side valve.
6. Repeat these steps to install the second side valve.

SPOUT INSTALLATION:

7. Unthread the diverter tee (32), locking nut (30) and lower washer (29) from the spout (19).
8. Insert the spout assembly (17-28) through the hole in the mounting surface with the upper washer (20) positioned under the spout.
9. Reinstall the lower washer and tighten the locking nut to secure the spout to the mounting surface.
10. Reattach the tee to the spout and fully tighten to prevent leaks.

HAND SHOWER INSTALLATION:

11. Unscrew the locking nut (37) from the all-thread (42) and remove the lower washer (38).
12. Unscrew the cover ring (44) from the all-thread and pull out the plastic guide (43).
13. Insert the all-thread through the mounting surface, leaving the escutcheon (41) and upper washer (40) in place.
14. Re-attach the lower washer and locking nut to the all-thread. Fully tighten the locking nut to secure the assembly.
15. Slide the cover ring (44) over the conical end of the hose (36) and insert the hose into the plastic guide (43). Now pass the knurled end of the hose (36) through the all thread (42) until the plastic guide is fully seated inside of the all-thread. Finally, re-attach the cover ring to the all-thread.
16. Connect the conical end of the hose to the hand shower. Note: The combination flow restrictor/non-return valve (45) is located in the end of the hand shower. Final Connections and Inspection

12/24 These guidelines have been prepared for the professional contractor to aid in the installation of: **EASTON® CONCEALED TUB FILLER WITH HAND SHOWER (COVERED) (EATU01, 02-K, 03-K, 04-K, 05-K)**
 All dimensions are based on original specifications and are subject to change and variation. Please consult your Design Associate for current specifications.

FINAL CONNECTIONS AND INSPECTION:

- 17. Connect each of the supply hoses (33) to the adjacent side valve making sure the hoses are not kinked.
 - 18. Connect the female end of the flexible hose (35) to the tee junction (32) using the washer (34).
 - 19. Connect the knurled end of the hand shower hose (36) to the male end of the flex hose (35).
 - 20. Connect the side valves (13) to the water supplies (not provided).
 - 21. Carefully open the hot and cold valves to flush out any debris in the supply lines before transferring the flow of water to the hand shower.
 - 22. Carefully inspect all connections for leaks and check for proper operation prior to enclosing the unit.
 - 23. For servicing the valve stem (12), unscrew the cover (6) and pull off the handle assembly (1-9).
- If further assistance is required, please contact Product Support at 1-800-927-2120 (8am-7pm EST).

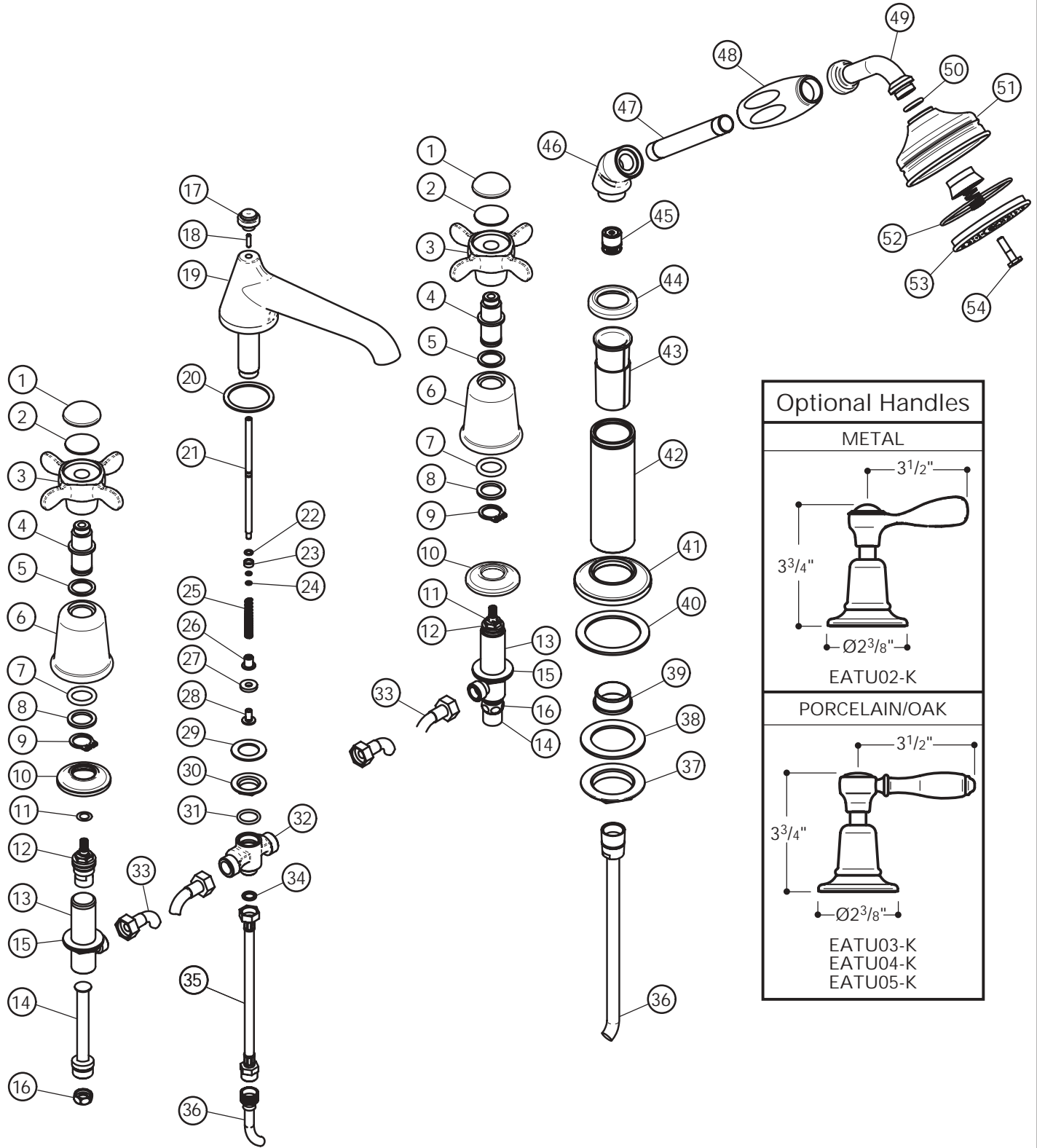

Optional Handles	
METAL	
EATU02-K	
PORCELAIN/OAK	
EATU03-K EATU04-K EATU05-K	

12/24 These guidelines have been prepared for the professional contractor to aid in the installation of: **EASTON® CONCEALED TUB FILLER WITH HAND SHOWER (COVERED)** (EATU01, 02-K, 03-K, 04-K, 05-K)
 All dimensions are based on original specifications and are subject to change and variation. Please consult your Design Associate for current specifications.