



IB RUBINETTI

Collection

REFLEX

Article

RX200

Description

Monohole washbasin hydroprogressive mixer

Box Dimensions

340 x 180 x 70 mm

Weight

1.6 kg

Finishes

- **CC**
CHROME
- **CF**
BLACK CHROME
- **OO**
GOLD
- **BB**
ANTIQUÉ BRONZE
- **SS**
BRUSHED NICKEL
- **CS**
BRUSHED BLACK CHROME
- **BO**
MATT WHITE
- **NP**
MATT BLACK
- **IS**
BRUSHED PALE GOLD
- **OS**
BRUSHED GOLD
- **II**
PALE GOLD
- **RR**
ANTIQUÉ COPPER
- **RS**
ROSE GOLD
- **ON**
NATURAL BRASS
- **SR**
BRUSHED ROSE GOLD
- **PL**
PLATINUM



Dimensions

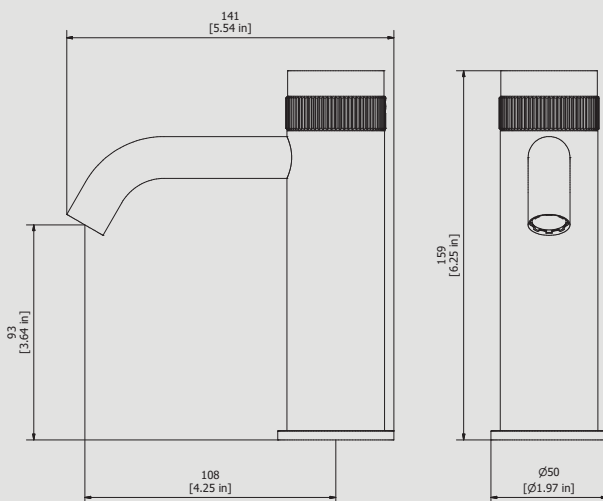

Cartridge

Ø25 ceramic cartridge

Hoses

Inox hoses G3\8" female 400 mms long

Aerator

M16.5x1

Flow Rate (+/-10%)

1 BAR	2 BAR	3 BAR
3.2 l/min	3.8 l/min	3.9 l/min

Production

Main body is a machined from a solid pieces

Material

BRASS
According to CuZn42 (CW510L)
Max Lead content: 0.2%





IB RUBINETTI

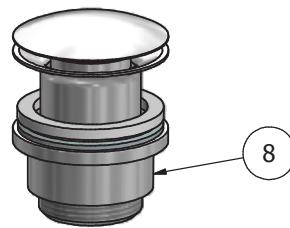
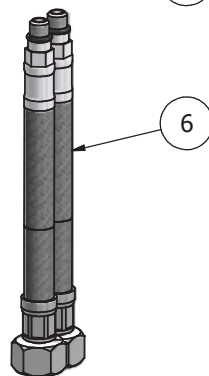
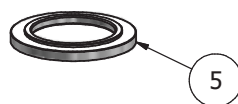
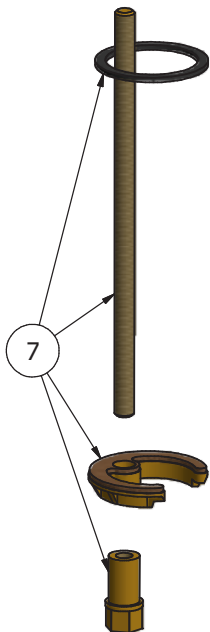
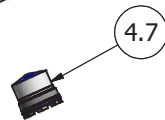
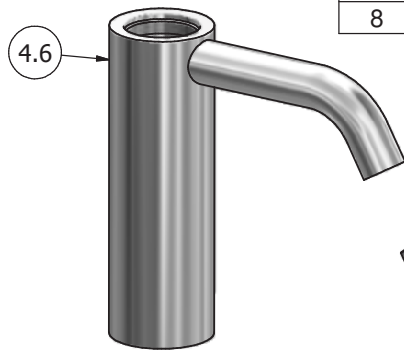
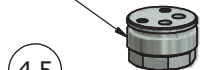
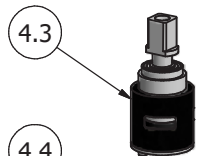
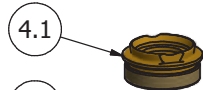
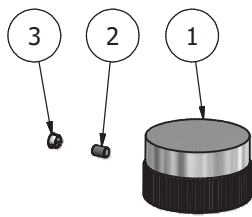

Parts list			
ELEM	CODICE	NUMERO DI MAGAZZINO	QT
1	AC0016780	Handle Ø43 H25.5 knurled 9x9	1
2	AQ0001081	Grubscrew M4x6 flat point	1
3	AQ0012203	Plug	1
4	CPKRX200 CCX01	Preassembled basin mixer	1
4.1	AS0011353	Cartridge fixing nut M30x1 H14.35	1
4.2	AQ0010564	OR 26.7x1.78 NBR 70 SH	1
4.3	AQ0016781	Progressive cartridge Ø25 open 9x9 (ST232A001321039)	1
4.4	AC0010810	Connection piece Ø27X18	1
4.5	AQ0010972	OR 23x2 NBR 70 SH	1
4.6	AQ0014246	Mixer body Ø42 H129	1
4.7	AQ0014147	Perlator PCA cachè laminar 1 GPM (44.3358.010)	1
5	AC0010787	Base Ø5 H5	1
6	AQ0011013	Inox hose G3/8" M8x1 L400	2
7	AQ0015676	Fixing set	1
8	AQ0009837	Simple rapid waste 1"1/4	1

WARRANTY

All IB Rubinetterie SpA products are warranted for 10 years from the date of purchase, for the following cases:

- Defects of casting, porosity and chrome plating.
- Operating defects caused by incorrect fabrication.

The warranty provides for repair or replacement of products with fabrication defects recognized by our technical office. There is no other type of compensation anche the merchandise must be returned FOB our warehouse. The warranty only cover surface defects (scatches, dings, etc.) on fitting that have not been installed and used, returned in its original packaging with all components. O-ring, gasket seals and components subject to wear proportional to use are warranted for 2 years.

The warranty is void in the following cases:

Error installing and putting the product into service.

Deterioration of finished surfaces due to use of cleaning products containing acids or abrasive substances. Deterioration of surface with finishes other than chrome plating. Their durability is, in fact, dependent on the user's care and gentleness of use.

Deterioration of the fitting due incorrect installation.

Improper repairs and maintenance performed without the company's prior authorization.

The warranty from IB Rubinetterie SpA is not renewable.

Cleaning

We recommended cleaning the finish surfaces with water and soap, using a soft cloth.

Do not use detergents that contain hydrochloric acid or abrasive substances.

