

Art. 2512  
 Art. 2612  
 Art. 1612

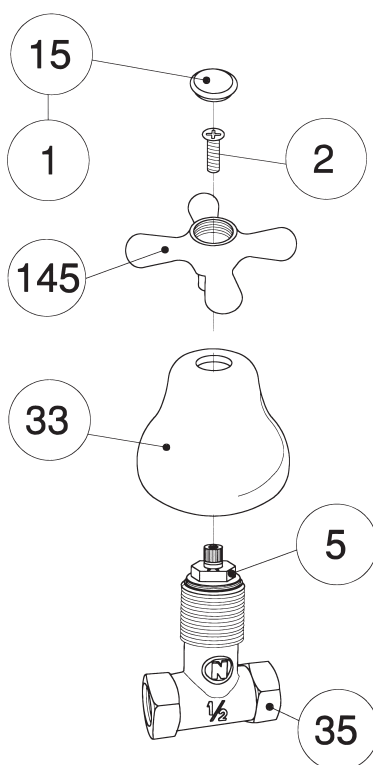
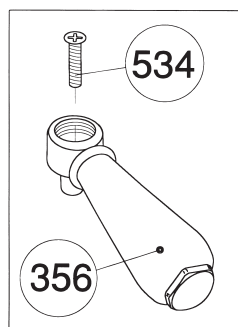
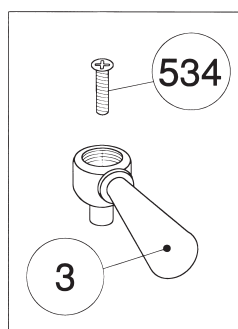

Pos.	Descrizione	Description	Cod.
1	Placchetta per maniglia con lettera F	Plate for handle with indication "C" (cold)	C 7698
2	Vite M4x10 mm	Screw M4x10 mm	C 7550
3	Maniglia Mac Kinley	Mac Kinley handle	C 7660
5	Vitone ceramic disc	Ceramic disc valve	C 7075
15	Placchetta per maniglia con lettera C	Plate for diverter with indication "H" (hot)	C 7698
33	Cappuccio	Cap	C 7213
35	Corpo rubinetto d'arresto G 1/2"	Body of stop cock G 1/2" or NPT 1/2"	C 5039/1
145	Maniglia Nuova Brenta	Nuova Brenta handle	C 7601
356	Maniglia Mont Blanc	Mont Blanc handle	C 7662
534	Vite inox M4x23	Stainless steel screw M4x23	C 7551