

E10872



Collection: SINGULIER

Finish*:



CP - Chrome

Main features:



Features

- **WEIGHT:** 3.6 kg
- **INSTALLATION TYPE:** 2 holes
- **FLOW RATE:** 19 l/min under 3 bar
- **MECHANISM:** Expandable wax thermostatic cartridge with temperature and flow control
- **WATER/ENERGY-SAVING:** WATER-SAVING
- **WARM BODY:** Yes
- Non-return valves on supplies
- **MATERIAL:** Metal
- **TYPE:** Single-lever
- **CONNECTION:** With connectors and wall escutcheons
- **HOLE CONFIGURATION:** 150 ± 15
- **SAFETY STOP:** 40°C
- **MECHANISM GUARANTEE:** 5 years

Consumer benefits

- **SAFETY:** Maximum temperature set at 50°
- Water saver

Technical drawing

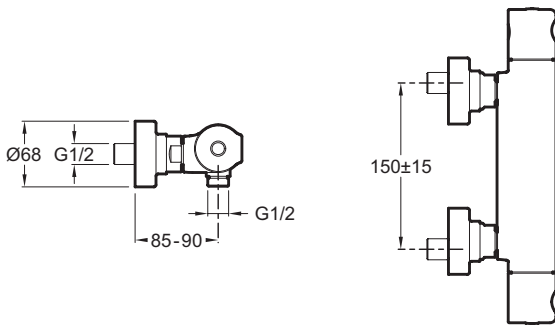

Product Specification: Thermostatic single-lever wall-mount shower mixer. E10872. Collection: SINGULIER. WEIGHT: 3.6 kg. MATERIAL: Metal. INSTALLATION TYPE: 2 holes. TYPE: Single-lever. FLOW RATE: 19 l/min under 3 bar. CONNECTION: With connectors and wall escutcheons. MECHANISM: Expandable wax thermostatic cartridge with temperature and flow control. HOLE CONFIGURATION: 150 ± 15. WATER/ENERGY-SAVING: WATER-SAVING. SAFETY STOP: 40°C. WARM BODY: Yes. MECHANISM GUARANTEE: 5 years. Non-return valves on supplies.

**Due to possible variations in computer and printer calibrations, technical factors and certain finish characteristics, the colors you see may not accurately portray the actual colors and are provided as a guide only.*