

# RICAMBI / SPARE PARTS

# ISTRUZIONI life

**Art. 0512/P - 0512/2/P -  
0512/3/P - 0512/4/P**

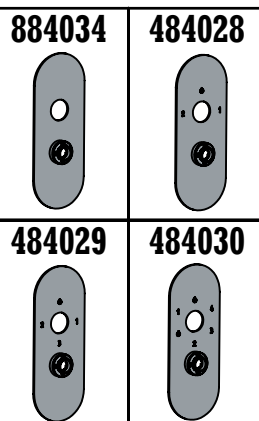
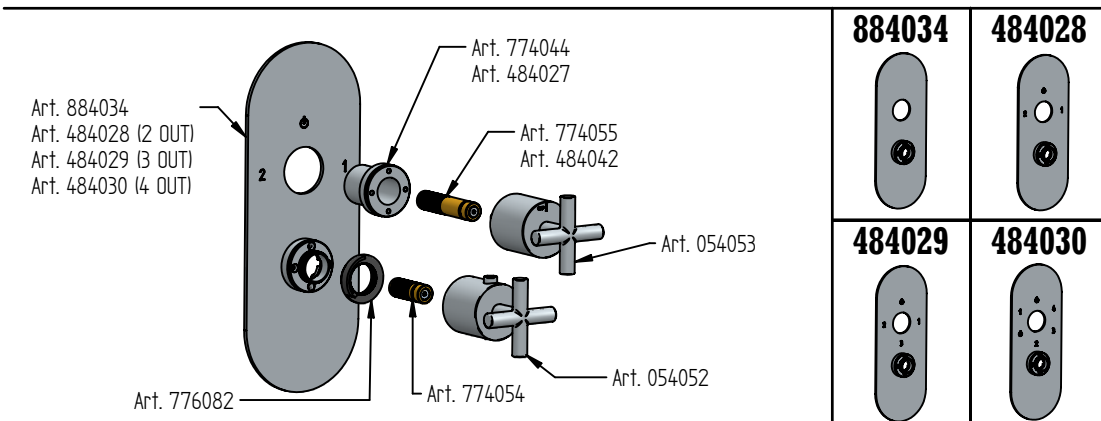

<b>Cod. 774044</b> 	<b>Cod. 776082</b> 	<b>Cod. 054052</b> 	<b>Cod. 484027</b> 
<b>Cod. 774054</b> 	<b>Cod. 774055</b> 	<b>Cod. 484042</b> 	<b>Cod. 054053</b> 

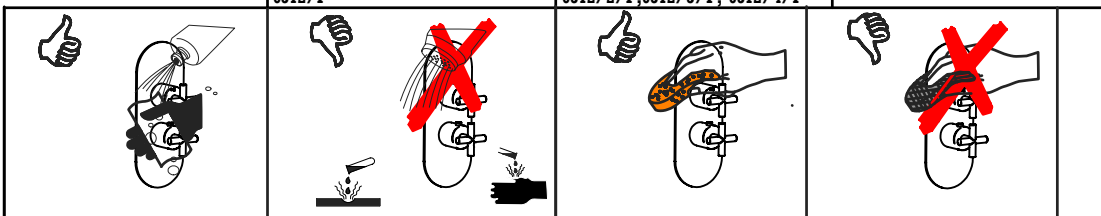

**MANUTENZIONE E PULIZIA**  
Per una corretta manutenzione e pulizia di questo prodotto, raccomandiamo alcuni semplici accorgimenti:

- Utilizzare detersivi neutri, spruzzando il prodotto direttamente su un panno morbido onde evitare infiltrazioni
- Evitare sempre il contatto con prodotti acidi o abrasivi
- Risciacquare bene con abbondante acqua per eliminare eventuali residui ed asciugare sempre con un panno morbido
- Effettuare una pulizia periodica al fine di prevenire le formazioni calcaree

La BELLOSTA CARLO & C. non è RESPONSABILE di danni derivati dall'utilizzo di prodotti impropri per la pulizia.

**MAINTENANCE AND CLEANING**  
For a proper maintenance and cleaning, we recommend the following:

- Use **neutral detergents**, avoiding to spray directly on taps to avoid residual infiltration
- **Avoid** contact with acid or abrasive products
- **Rinse** with water and **always dry** with a clean cloth to avoid residue of detergent
- Perform a **periodic cleaning** to prevent limestone deposits

BELLOSTA CARLO & C. cannot be held responsible for damages due to an improper use of detergents

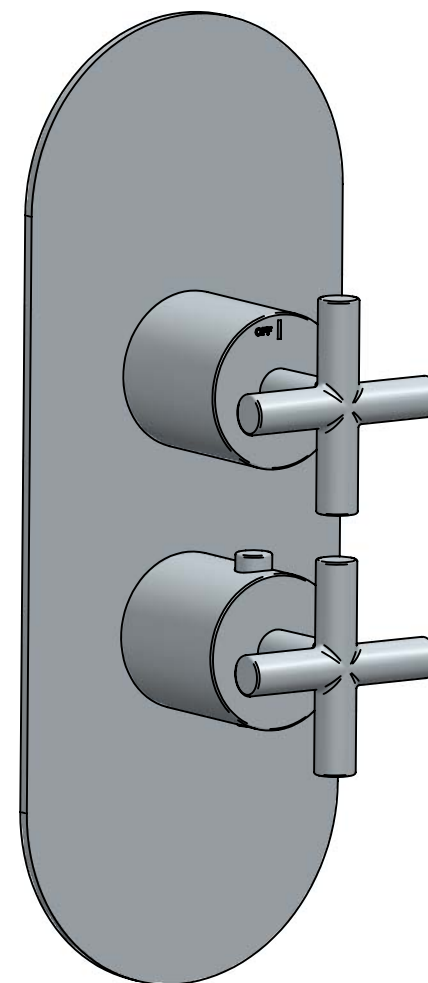

**MADE IN ITALY**

Questo prodotto è stato realizzato interamente in Italia con l'utilizzo di materie prime di altissima qualità

**DESIGN**  
**EOB**

**MADE IN ITALY**

This product has been entirely manufactured in Italy, by top quality raw materials.







## RICAMBI / SPARE PARTS

COD. 035346

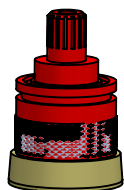

RIF. 484021

COD. 035345



RIF. 484022

COD. 035344



RIF. 484023

COD. 055134



COD. 774045



COD. 775007

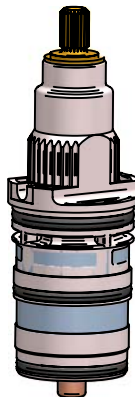

Art.484020 n°1pz  
Art.774035 n°1pz

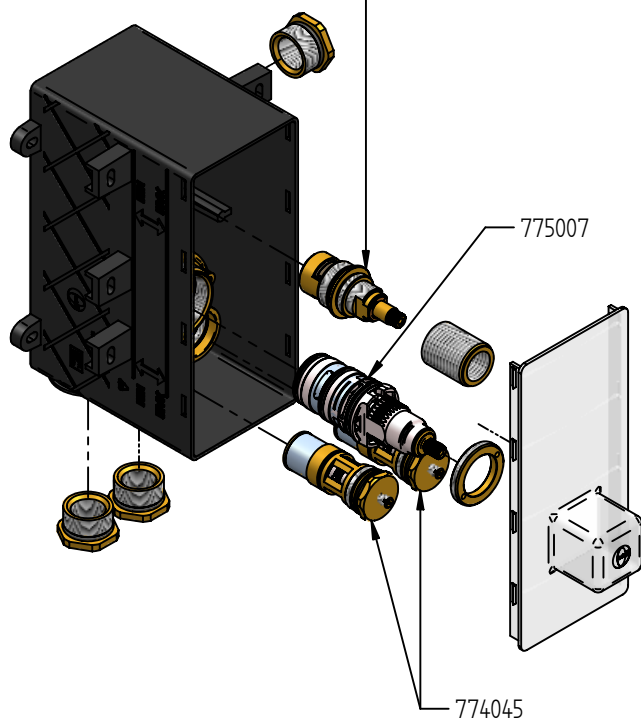

La BELLOSTA CARLO & C. non è RESPONSABILE di danni derivati dall'utilizzo di prodotti impropri per la pulizia. BELLOSTA CARLO & C. cannot be held responsible for damages due to an improper use of detergents

**MADE IN ITALY**

**DESIGN**  
EQB

**MADE IN ITALY**

This product has been entirely manufactured in Italy, by top quality raw materials.



D

# ISTRUZIONI *revivre*

**Art. 484020**  
**Art. 774035**

**Art. 484021**

**Art. 484022**

**Art. 484023**

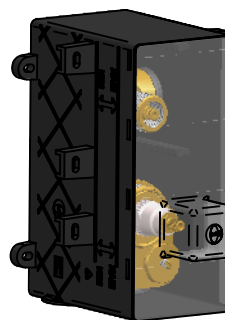

**1 OUT 1/2"**  
**1 OUT 3/4"**

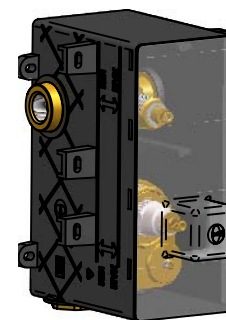

**2 OUT 1/2"**

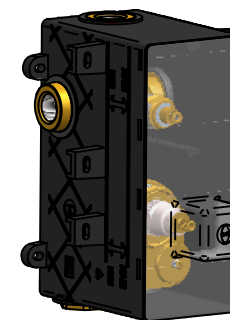

**3 OUT 1/2"**

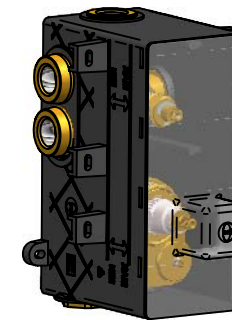

**4 OUT 1/2"**

**1**



**SPURGARE IMPIANTO**



**2**

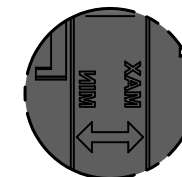

SCOSTAMENTO CONSIDERATO A MURO FINITO COMPRESO DI RIVESTIMENTO

LIMIT MEASURE AT ENDED WALL INCLUSIVE OF COVERING

56 - 80

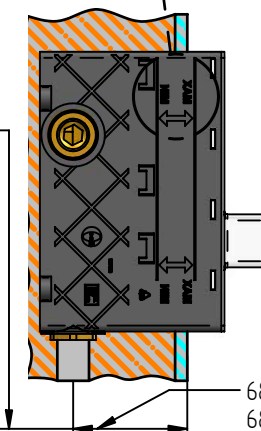

68 MISURA IDEALE  
68 IDEAL MEASURE

**MADE IN ITALY**

This product is entirely manufactured in Italy with the use of the highest quality raw materials.

**DESIGN**  
EQB

**MADE IN ITALY**

This product has been entirely manufactured in Italy, by top quality raw materials.



Rubinetti d'autore dedicati a te

> ufficio tecnico BELLOSTA - B.I. 06/06 ISO 9001-2000 SCQ

3 art. 484020 (1/2")  
art. 774035 (3/4")

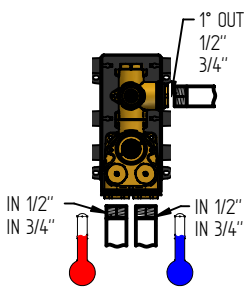

art. 484021

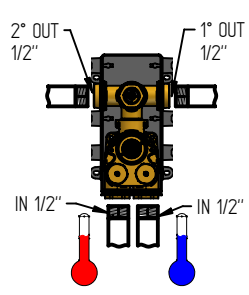

art. 484022

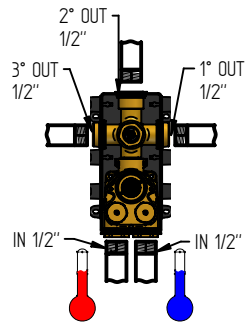

art. 484023

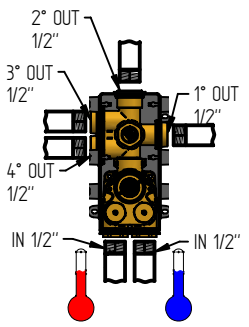

4

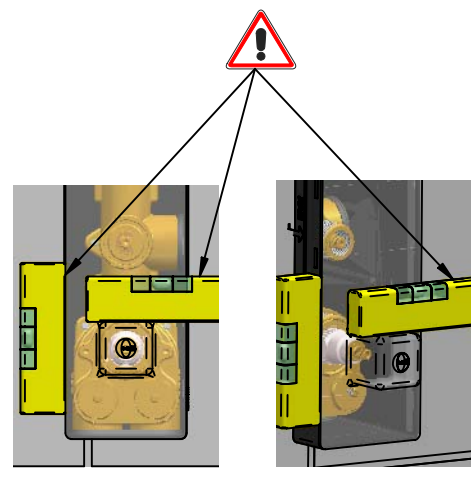

SOSTITUZIONE VITONE ART. 055034  
RIGHT CERAMIC VALVE REPLACEMENT ART. 055034

1

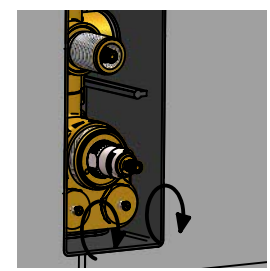
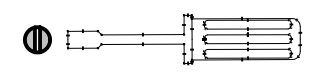

1 2  
CLOSE

2

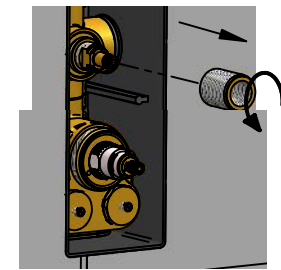

3

CH 14 mm

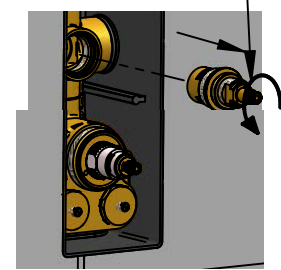

5

VERIFICA IMPIANTO

OPEN / CLOSE

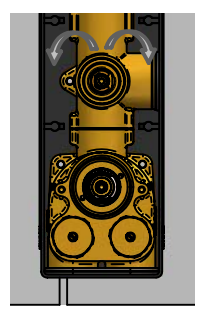
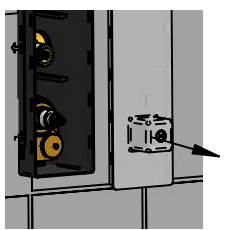

PLANT CHECK

6

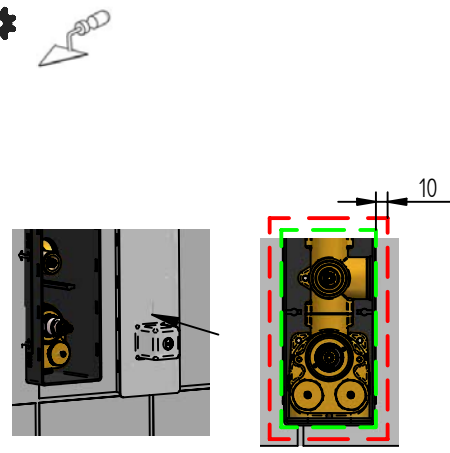

Dimensioni piastra  
Wall plate dimensions

100x210

SOSTITUZIONE CARTUCCIA ART. 775007  
THERMOSTATIC VALVE REPLACEMENT ART. 775007

1

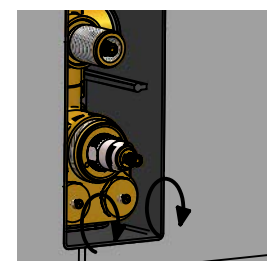
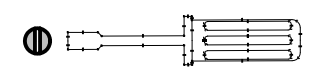

1 2  
CLOSE

2

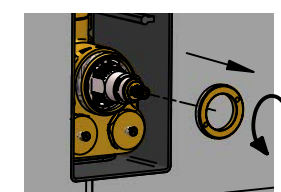
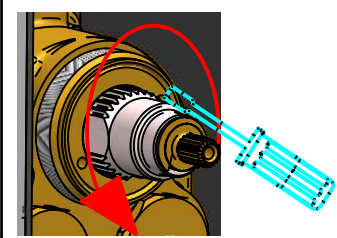

3

