

Waste bin, Large w/o lid - 17L

Knud Holscher Collection

d line

PRODUCT DATA SHEET

ITEM NUMBER	SURFACE
14.7085.02.201	Satin Stainless Steel
16.7085.01.200	Polished stainless steel

PRODUCT

Waste bin, large w/o lid - 17L, wall mounted, satin finish

PICTURE



TENDER TEXT

Waste bin, large. Outstanding classic danish design by Knud Holscher. Material: stainless steel AISI 316 satin finish, wall mounted, w/o lid, 17L. W:390 mm x H:300 mm x D:203 mm.

PRODUCT SPECIFICATION

Dimensions: W:390 mm x H:300 mm x D:203 mm.

Volume: 17L

Material: stainless steel AISI 316

Surface finish: satin grain 320, crafted by hand

Warranty for stainless steel (non movable) parts - 20 years

DRAWING

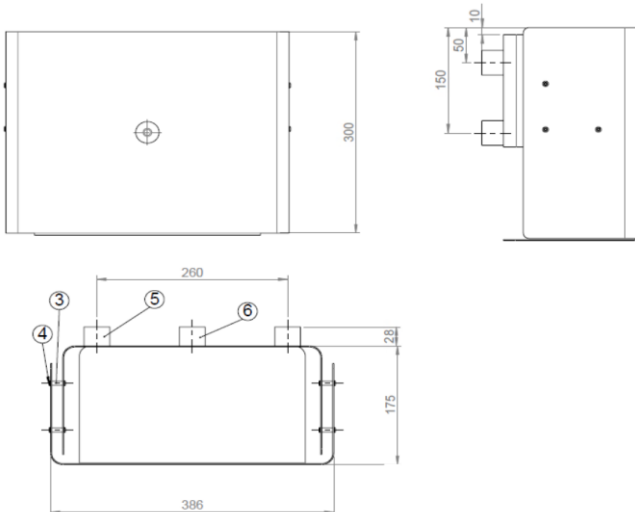

SPARE PARTS / ACCESSORIES:

14.7097.00.001 - Plastic bags, 30L

P0.0000.00.453 - Ø4.5x70/plug 8x40 set 3 pcs.

14.9834.00.338 - Drill template: 14.7084/85

MOUNTING:

See instruction supplied with product.

PACKING:

1 pair per box

ISO-DRAWING

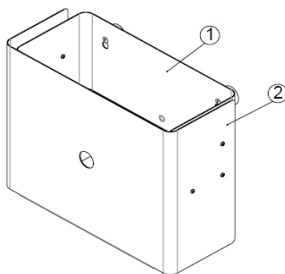

PRODUCT CARE

d line products are produced in the highest quality stainless steel, marine grade, AISI 316. To sustain the unique d line finish appearance please follow the below instructions:

- Wash down the surfaces using soapy water or mild detergent
- Always thoroughly rinse off with clean water
- To complete the cleaning procedure dry/polish the surfaces with a soft dry cloth

Please do not use scouring powder, steel wool, chloride based detergents or other aggressive cleaning products as these may damage the surface.

If spots or corrosion appear on the surface it is not due to the stainless steel quality, but to impurities in the environment, aggressive conditions or improper or insufficient cleaning.