

Key escutcheon Ø50 w/key hole

Arne Jacobsen Collection

d line

PRODUCT DATA SHEET

ITEM NUMBER 12.2830.02.232
SURFACE Satin finish stainless steel

PRODUCT
Key escutcheon Ø50 w/key hole

PICTURE

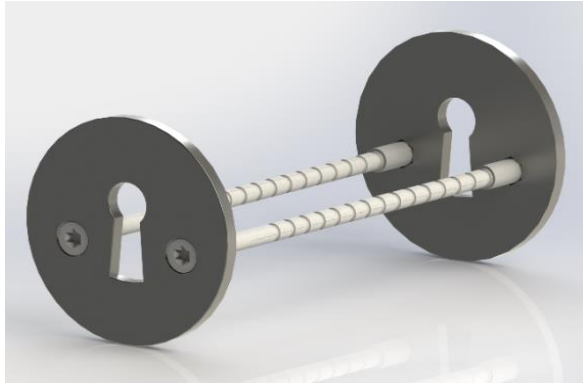

TENDER TEXT

Key escutcheon by Arne Jacobsen. Iconic, timeless and classically elegant Ø50 w/key hole. Material: stainless steel AISI 304 satin finish. W:50 mm x H:50 mm x D:3 mm.

PRODUCT SPECIFICATION

Dimensions: W:50 mm x H:50 mm x D:3 mm.

Material: stainless steel AISI 304

Surface finish: satin finish, crafted by hand

Warranty for stainless steel (non movable) parts - 15 years

DRAWING

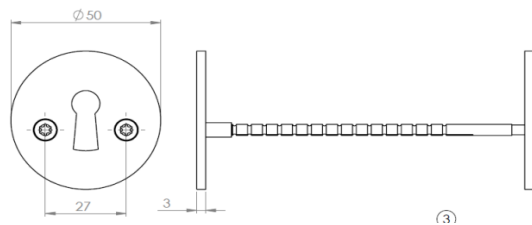

SPARE PARTS / ACCESSORIES:

P0000000080-Sectioned bolt M4 x 110 mm with bush set

MOUNTING:

Used on the door

PACKING:

1 set in a bag

ISO-DRAWING

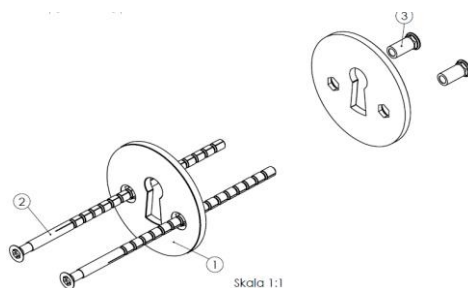

PRODUCT CARE

d line products are produced in the highest quality stainless steel. To sustain the unique d line finish appearance please follow the below instructions:

- Wash down the surfaces using soapy water or mild detergent
- Always thoroughly rinse off with clean water
- To complete the cleaning procedure dry/polish the surfaces with a soft dry cloth

Please do not use scouring powder, steel wool, chloride based detergents or other aggressive cleaning products as these may damage the surface.

If spots or corrosion appear on the surface it is not due to the stainless steel quality, but to impurities in the environment, aggressive conditions or improper or insufficient cleaning.