

UNIVERSAL

GULV27

Universal Lavatory Wall Mounted Rough Valve (Used with Cross or Wheel Handle Lavatory Faucets)



SHOWN IN UNIVERSAL LAVATORY WALL MOUNTED ROUGH VALVE (USED WITH CROSS OR WHEEL HANDLE LAVATORY

TECHNICAL DETAILS

ADA Compliance: No
 Fittings Hole Diameter: 1 1/8"
 Handle Spread Maximum: 8"
 Handle Spread Minimum: 8"
 Handle Turn Angle: Quarter Turn
 Depth / Width: 6"
 Height: 2 3/4"
 Inlet Connection Size: 1/2"
 Inlet Connection Type: Female NPT
 Installation Type: Wall Mounted
 Length: 10"
 Outlet Connection Size: 1/2"
 Outlet Connection Type: Female NPT
 Primary Material: Brass
 Suggested Application: Bath
 Valve Material: Ceramic
 Water Pressure Maximum: 85.0 psi
 Water Pressure Minimum: 20.0 psi
 Water Pressure Recommended: 45.0 psi

INSPIRATION

Our Universal collection features timeless designs complementing any of our Waterworks. With a wide range of product, from fittings to accessories, Universal adds exquisite proportion and balance to any environment.

CODES & STANDARDS

Code # GUSV27: Complies with ASME A112.18.1/CSA B125.1, NSF 61, NSF 372, CEC and 0.25% Weighted Average Lead Content. Certified with IAPMO, cUPC, NSF, CEC, UL, State of MA and WRAS.

PRODUCT FEATURES

This hot and cold cartridge rough is for use with Waterworks wall mounted faucets
 1/2" NPT male inlet and 1/2" NPT female outlet, with quarter turn functionality
 6 gpm unrestricted maximum flow at 45 psi
 Available option that complies with 0.25% Weighted Average Lead Content (WALC).



UNIVERSAL

GULV27

Universal Lavatory Wall Mounted Rough Valve (Used with Cross or Wheel Handle Lavatory Faucets)

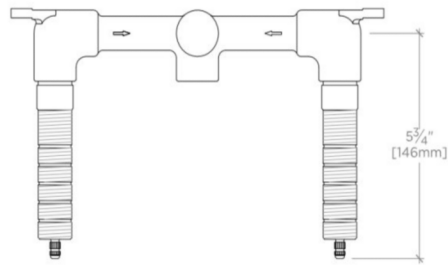

TOP VIEW

SCALE: 3"=1'-0"

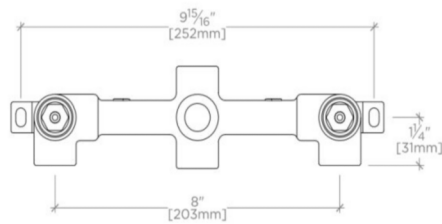
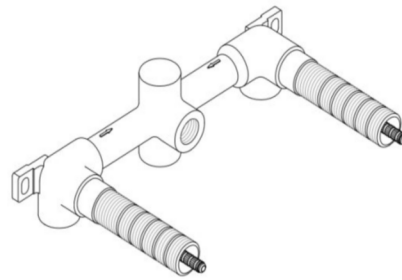

FRONT VIEW

SCALE: 3"=1'-0"

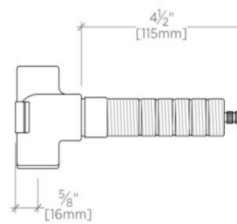

SIDE VIEW

SCALE: 3"=1'-0"