

A³form

Technical data sheet



Washstands

WT.RX450QS

Article number: 4804000000

Design partner: busalt design

Features

Description	WT.RX450QS
Article number	4804000000
Standard colour	White
Special surfaces	White easy-clean (XXXX XXX 400) White antibacterial (XXXX XXX 401)
Construction	without faucet hole, without overflow
Special versions	special- or matt colour
Dimensions	17 7/8 x 17 7/8 x 35 3/8"
Material	Glazed steel
Net weight	68.56 lbs
Installation	for wall connection
Accessoires	Mirror SP.450, Mirror SP.450.1, Mirror SP.450.4
Faucet information	Optimum point of impact approx. 6 5/8 – 8 7/8" from rear edge of basin.

Faucets with a vertical outlet and an aerator provide the optimum flow of water onto the surface below (angle of impact: 90°).

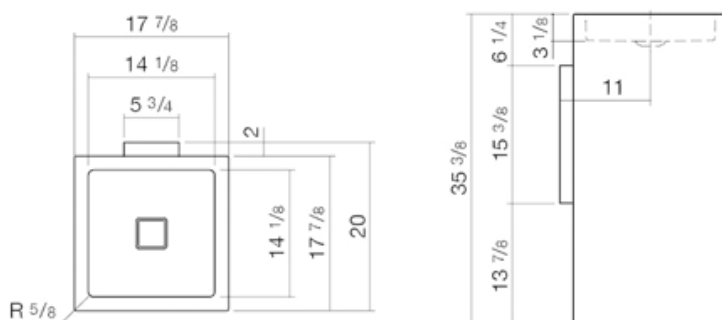

Text for invitation to tender

Washstand, square, 17 7/8 x 17 7/8", glazed inside and outside, height 35 3/8", without faucet hole and overflow, including siphon, drain valve with white glazed cap, white wall bracket and fixing set

Brand: Alape

Model: WT.RX450QS