

E10863



Collection: SINGULIER

Finish\*:



CP - Chrome

Main features:



## Features

- WEIGHT: 3.6 kg
- INSTALLATION TYPE: Wall-mount
- FLOW RATE: 14 l/min
- INSTALLATION TYPE: 2 holes
- Sensitive flow control
- MATERIAL: Metal
- TYPE: Single-lever
- MECHANISM: Ceramic disc cartridge with flow control
- MECHANISM GUARANTEE: 5 years

## Technical drawing

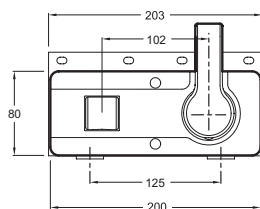
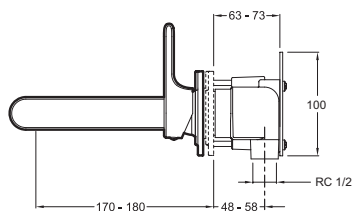

Product Specification: Single-lever wall-mount washbasin mixer. E10863. Collection: SINGULIER. WEIGHT: 3.6 kg. MATERIAL: Metal. INSTALLATION TYPE: Wall-mount. TYPE: Single-lever. FLOW RATE: 14 l/min. MECHANISM: Ceramic disc cartridge with flow control. INSTALLATION TYPE: 2 holes. MECHANISM GUARANTEE: 5 years. Sensitive flow control.