

E72282



Collection: ALEO

Finish*:



CP - Chrome

Main features:



Features

- **WEIGHT:** 2.3 kg
- **INSTALLATION TYPE:** 2 holes
- **TYPE:** Single-lever
- **MECHANISM:** Ceramic disc cartridge
- **NON-RETURN VALVE:** Yes
- **MECHANISM GUARANTEE:** 5 years
- Discreetly-positioned. anti-scale aerator: Easy replacement with no special tool (you can use a coin) and easier cleaning
- **MATERIAL:** Metal
- **NORMS AND REGULATION:** Standards: ACS (Certificate of Sanitary Compliance):10 ACC LY 113
- **CONNECTION:** With connectors and wall escutcheons
- **HOLE CONFIGURATION:** 150 ± 15
- **DIVERTER:** Automatic pushbutton diverter
- Pushbutton automatic diverter

Technical drawing

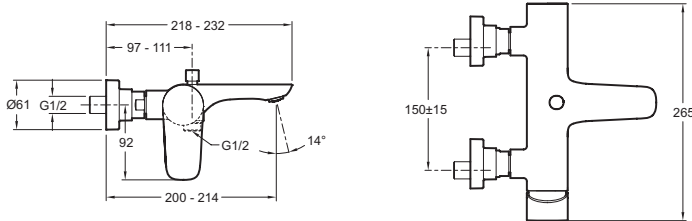

Product Specification: Wall-mount bath-shower mixer. E72282. Collection: ALEO. WEIGHT: 2.3 kg. MATERIAL: Metal. INSTALLATION TYPE: 2 holes. NORMS AND REGULATION: Standards: ACS (Certificate of Sanitary Compliance):10 ACC LY 113. TYPE: Single-lever. CONNECTION: With connectors and wall escutcheons. MECHANISM: Ceramic disc cartridge. HOLE CONFIGURATION: 150 ± 15. NON-RETURN VALVE: Yes. DIVERTER: Automatic pushbutton diverter. MECHANISM GUARANTEE: 5 years. Pushbutton automatic diverter. Discreetly-positioned. anti-scale aerator: Easy replacement with no special tool (you can use a coin) and easier cleaning.

*Due to possible variations in computer and printer calibrations, technical factors and certain finish characteristics, the colors you see may not accurately portray the actual colors and are provided as a guide only.