

E78130



Collection: LÉONIE

Finish*:



CP - Chrome

Main features:



Features

- WEIGHT: 1.4 kg
- INSTALLATION TYPE: 1 hole
- FLOW RATE: 6 l/mn
- INSTALLATION TYPE: 1 hole
- MATERIAL: 54
- TYPE: Single-lever
- CONNECTION: With supply hoses
- MECHANISM GUARANTEE: 5 years

Technical drawing

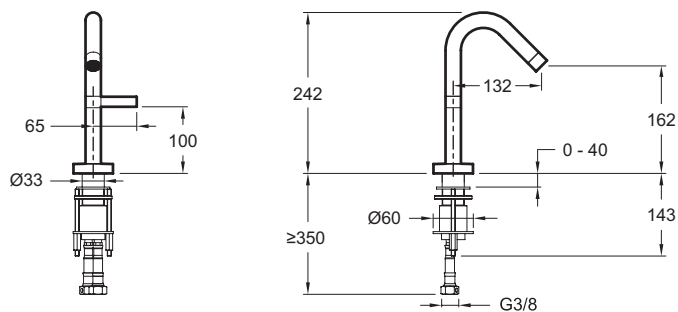

Product Specification: Single-lever basin mixer. E78130. Collection: LÉONIE. WEIGHT: 1.4 kg. MATERIAL: 54. INSTALLATION TYPE: 1 hole. TYPE: Single-lever. FLOW RATE: 6 l/mn. CONNECTION: With supply hoses. INSTALLATION TYPE: 1 hole. MECHANISM GUARANTEE: 5 years.

*Due to possible variations in computer and printer calibrations, technical factors and certain finish characteristics, the colors you see may not accurately portray the actual colors and are provided as a guide only.