

Access PL

2PL

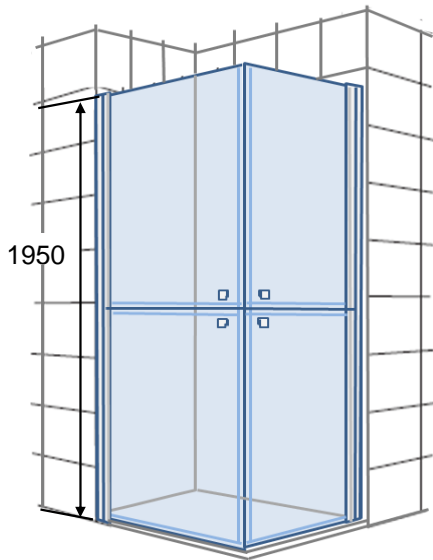

PL + PLF

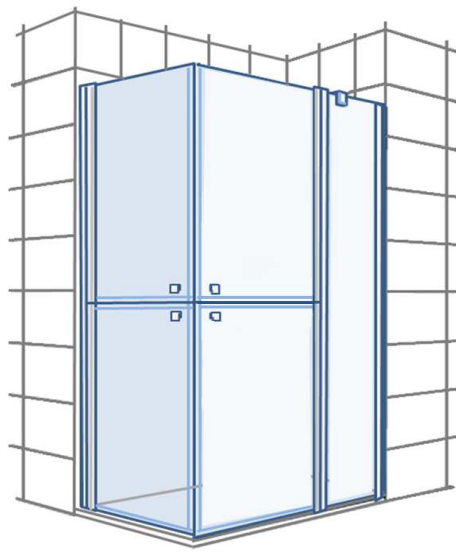

PL + LF*

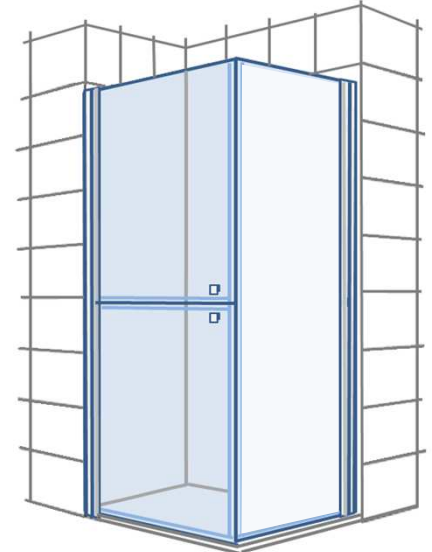

(*) Easy LF

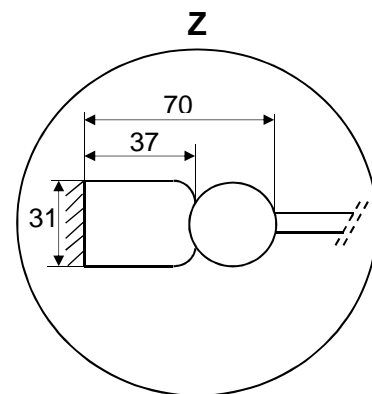
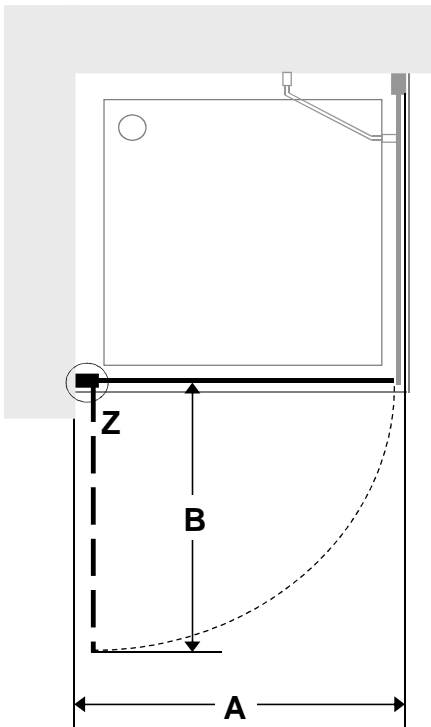

PL		A	B
A= 600,601...1000	Mín.	A - 7	A - 75
	Máx.	A + 8	

Ejemplo / Example:

A= 900

A Mín= 900 - 7 = 893

B= 900 - 75 = 825

A Máx= 900 + 8 = 908