



**DANIEL**

SCHEDA TECNICA TECHNICAL FEATURES

ART. COD.

**KC231**

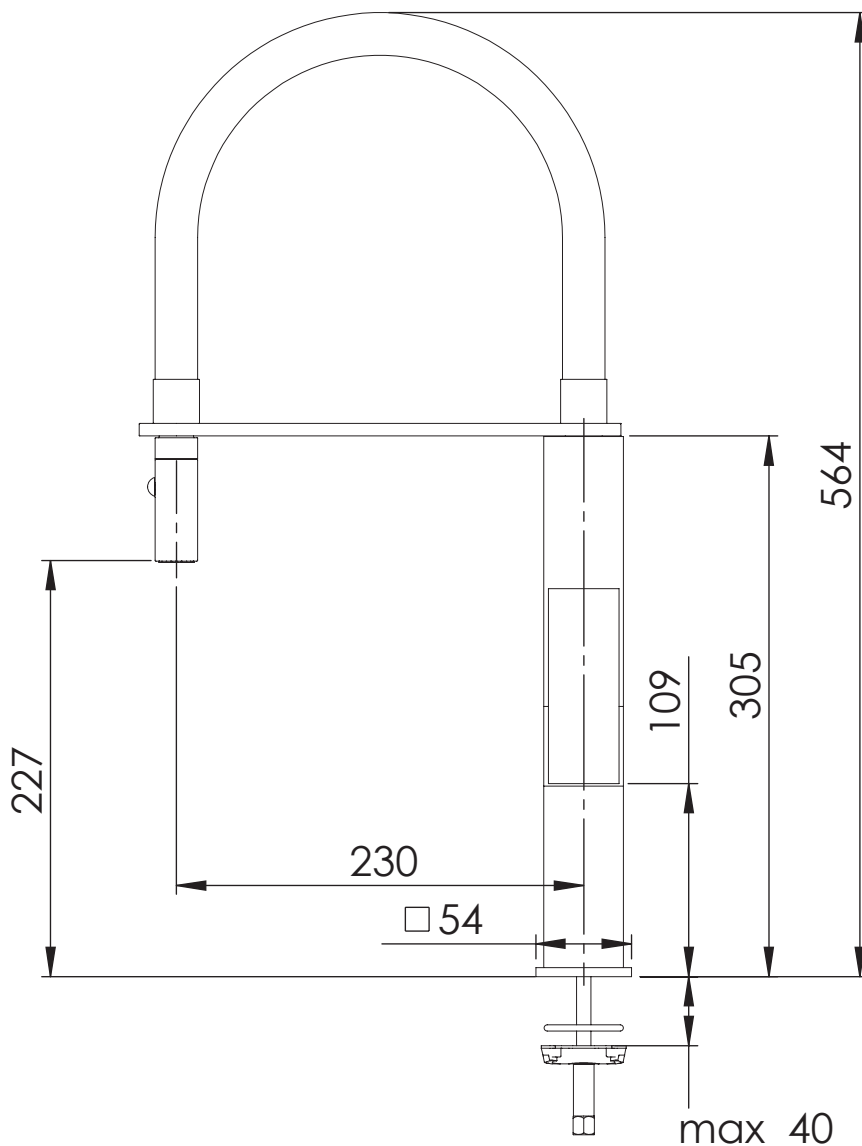

### **MATERIALI / MATERIALS**

**OTTONE CROMATO / CHROME PLATED BRASS**

flessibile rivestito in tubo gomma soft-touch / flexible hose coated in soft-touch rubber pipe

### **CROMATURA / CHROME PLATING**

UNI EN 248

Via Leonardo da Vinci 53 20062 Cassano d'Adda (MI) Italy Tel. +39-0363 62651  
info@daniel.it www.daniel.it