

▲ Specify Finish
Especifique el Acabado
Précisez le Fini

Model/Modelo/Modèle
35891LF▲
Series/Series/Seria
Becker™

RP101134▲
Handle Assemblies
Conjunto de manija
Montage de la manette

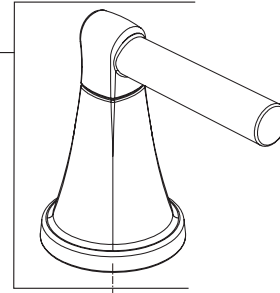

RP101066▲
Lift Rod
Barra de Alzar
Tige de Manoeuvre

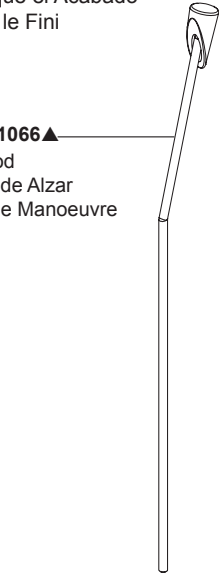

RP101069
Stem Unit Assembly, Seat & Spring,
Bonnet Nut
Ensamble de la Unidad del Vástago,
Asiento, Resorte y Bonete
Obtuteur, siège et ressort et écrou à
chapeau

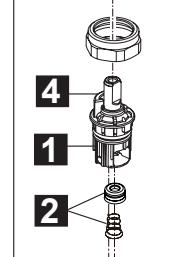

RP101073
Gasket
Empaque
Joint



RP101071
Gasket
Empaque
Joint

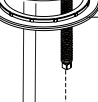

3 RP100866
1.2 PGM (4.5 L/min)
Aerator
Aireador
Aérateur



RP47029
Bracket
Soporte
Support

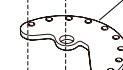

RP47030
Nut & Wrench
Tuerca y Llave
Écrou et clé



RP47423
Washers (2), Nuts (2)
& Screws (4)
Arandelas (2), Tuercas (2)
y Tornillos (4)
Rondelles (2), Écrous(2)
et Vis (4)

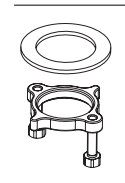

RP93980
Hose Assembly
Ensamble de la manguera
Tuyau souple

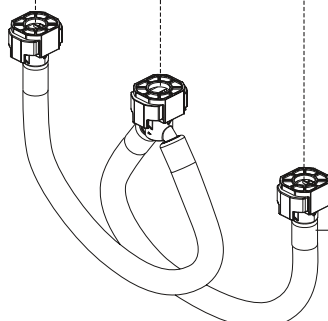

RP62472▲
Plastic Pop-Up Less Lift Rod
Desagüe Automático de Plástico
Menos la Barra de Alzar
Renvoi Mécanique en Plastique
Sans la Tige de Manoeuvre
(For SpotShield™ Brushed Nickel (SP)
Order SS Designation)

