

FIBRA

REXA

DESIGN



Floor layng instructions

Preparing the surface

Before starting to lay Fibra, make sure the surface is:

- clean and even, without noticeable stains or marks;
- smooth;
- preferably light grey colour;
- not crumbly;

If the surface does not meet these requirements, it is necessary to smooth the floor using suitable material we advise using MAPEI TRIBLOCK P.



What you need

Ensure that your pack contains the ordered materials, including the EQ•dekor sheets (check the number and length of the sheets), EQ•dekor adhesive glue, the finishing product and laying instructions, which you will need to understand the order in which the rolls must be laid. You will also need a short nap roller and a plastic scraper.



Positioning the sheets

With the laying diagram in front of you, calculate the positions of all the sheets. To mark the sheet positions, you can trace some markings using a pencil or a pen onto gummed paper tape applied to the wall, which you will then remove once the sheets have been glued down. Allow for excess material along all four edges of the floor.

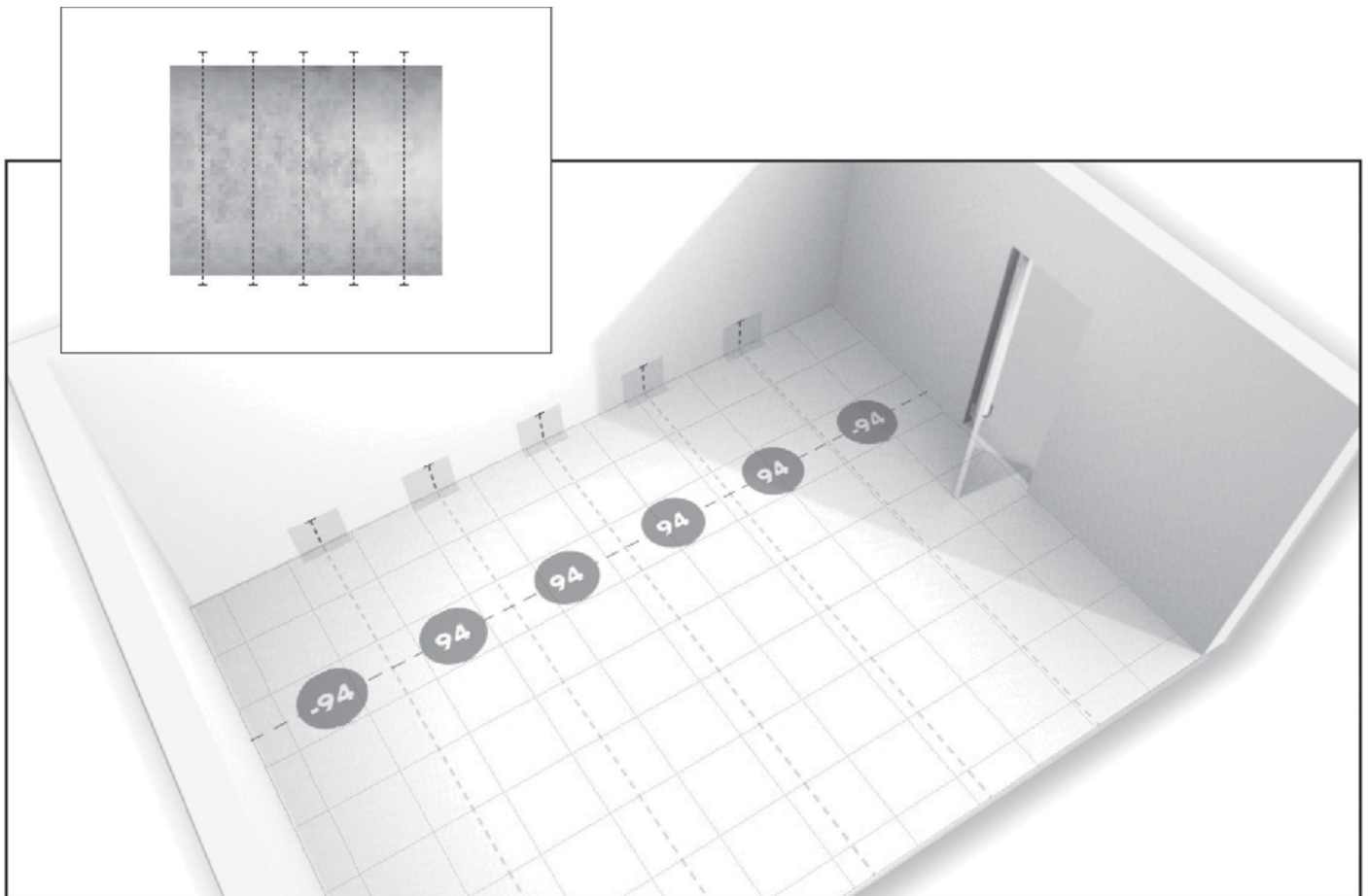

Do not trace any kind of markings, such as the positions of the sheet, directly on to the floor.

Apply the first coat of adhesive

Put protective covers on over your shoes.

Using a roller, apply a even coat of adhesive (without lumps) to the whole floor.

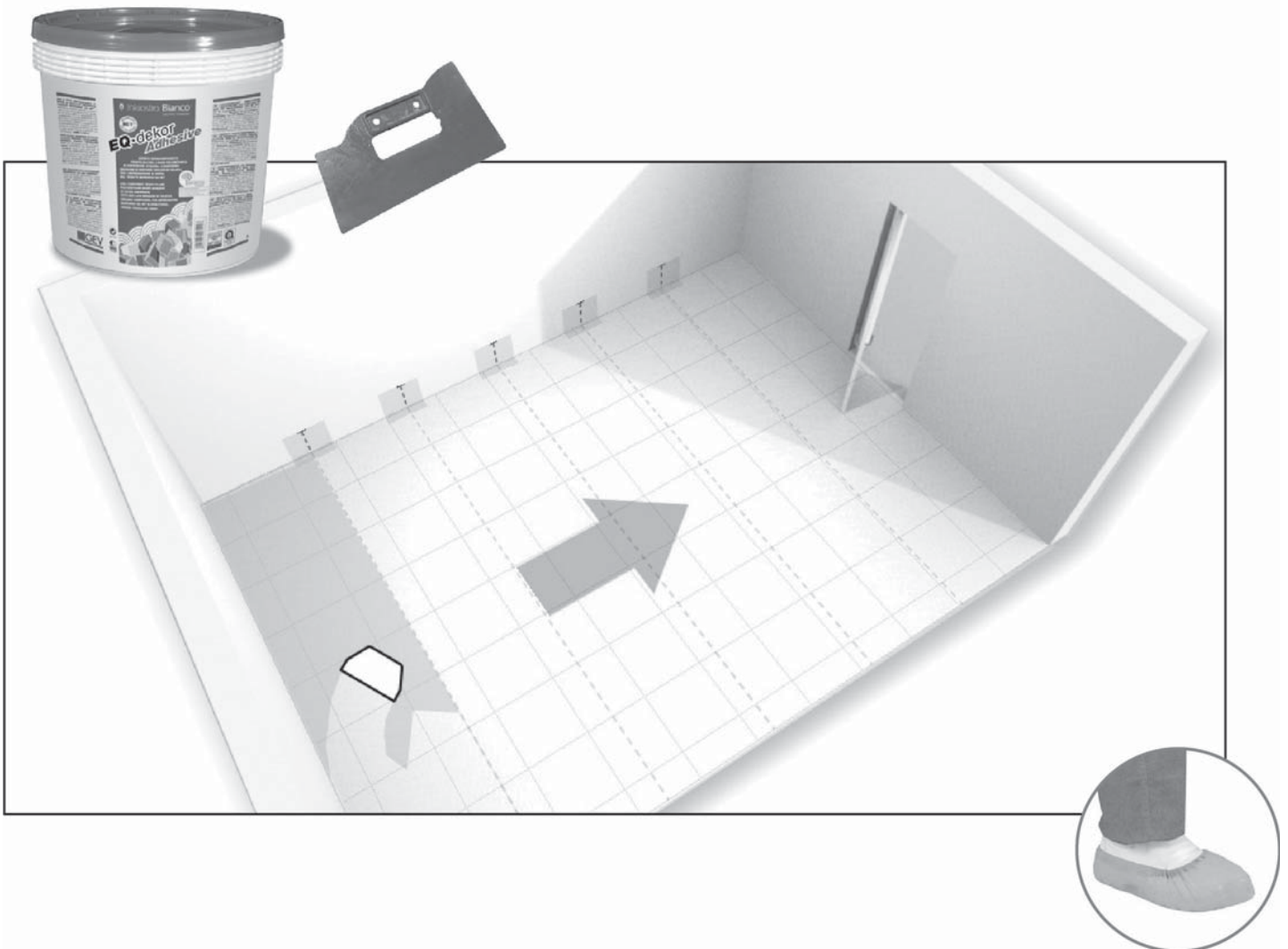

Checking the adhesive

Wait the adhesive is completely dried at least 1-2 hours before to proceed laying the sheets as described in the following point.

Also if the adhesive, once dried, is sticky you can proceed laying sheets.



Laying the first sheet

Lay the first sheet, making sure that you leave some excess material along the edges of the floor, as shown in the image and highlighted in red.

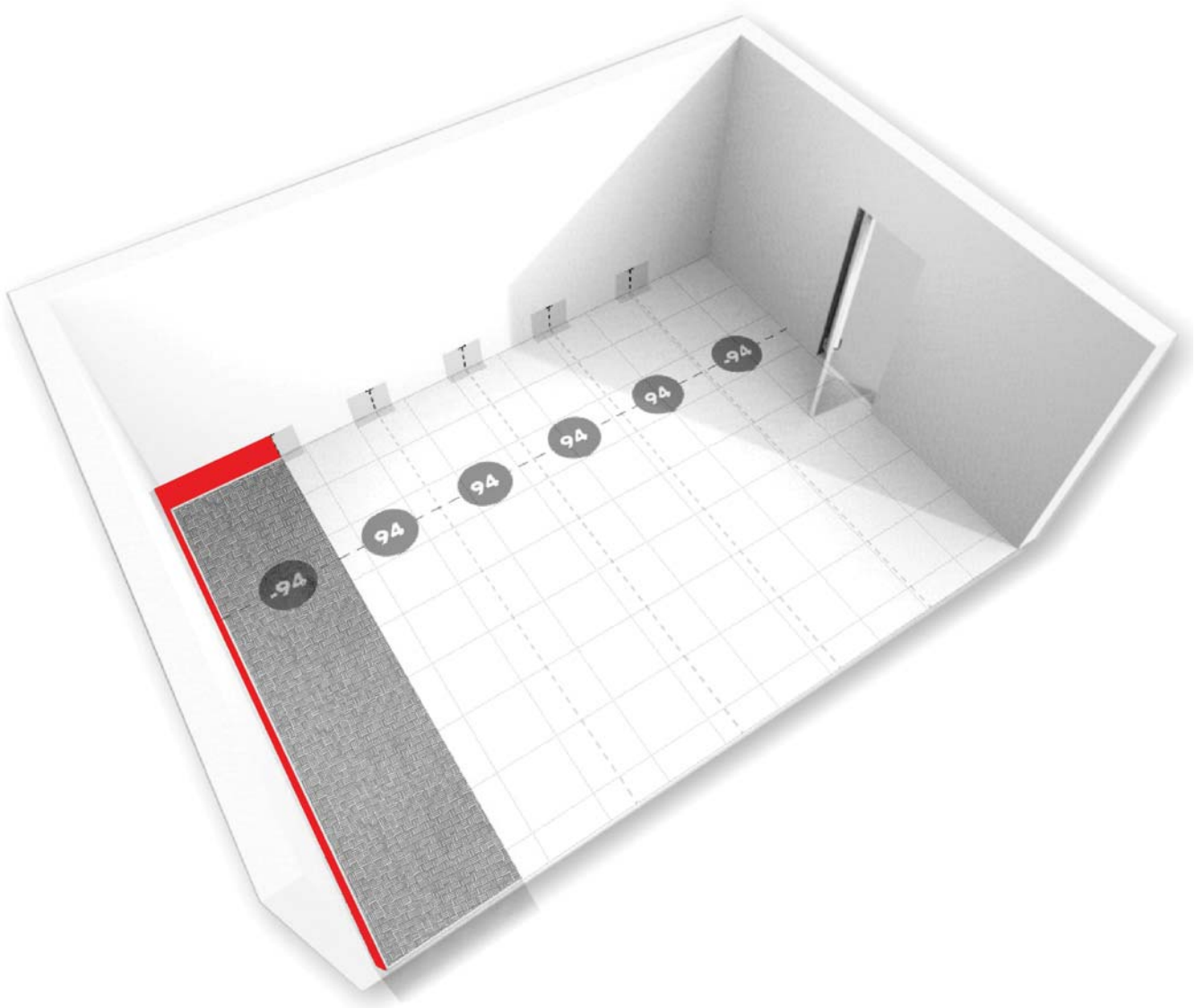

Laying the sheets

Progressively lay the remaining sheets, making sure you align them perfectly, in order to recreate the graphic pattern.

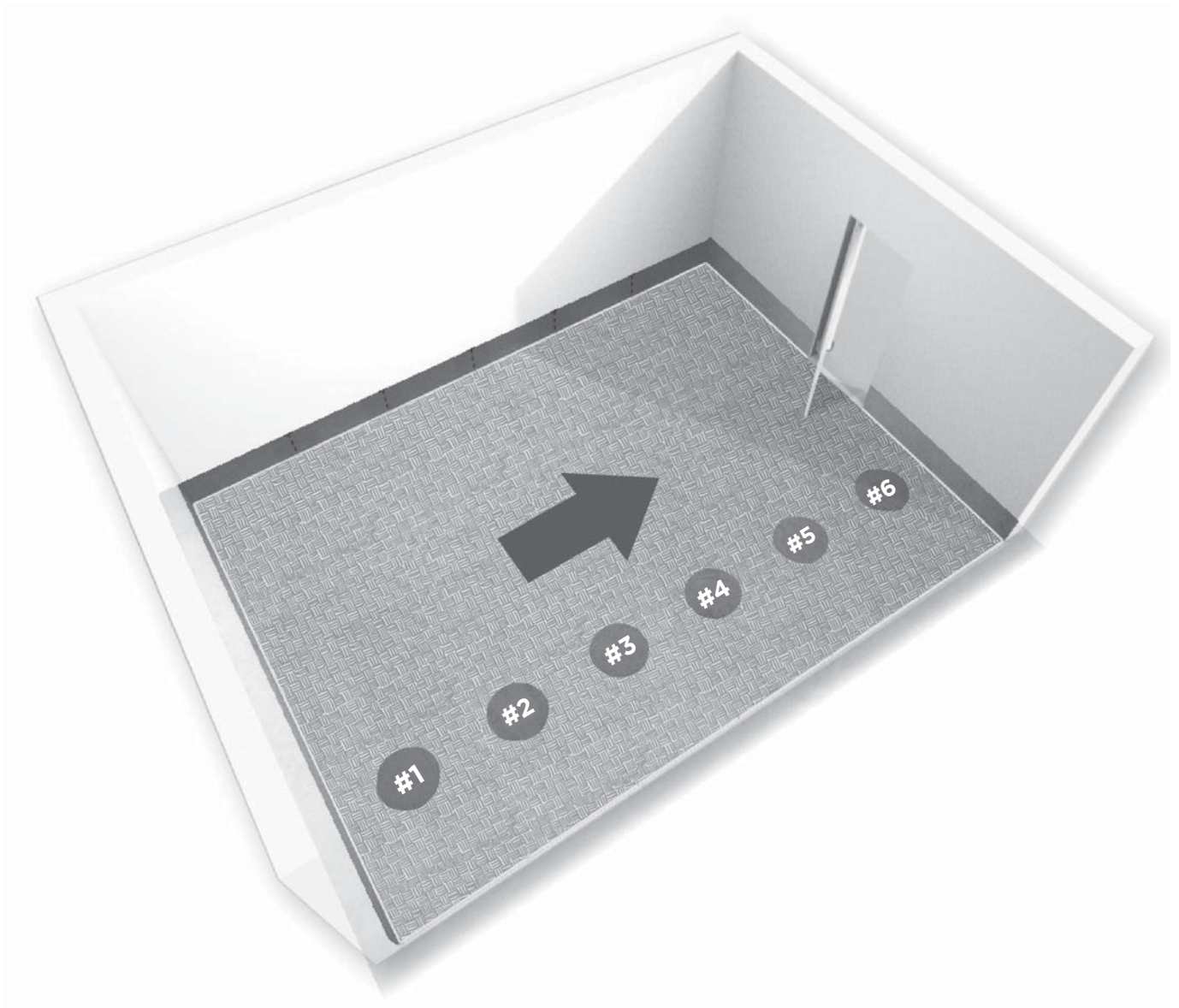

Removing the off-cuts

Remove the excess material by running a cutter along the edge of the wall (in the image the cutting line is shown in yellow)

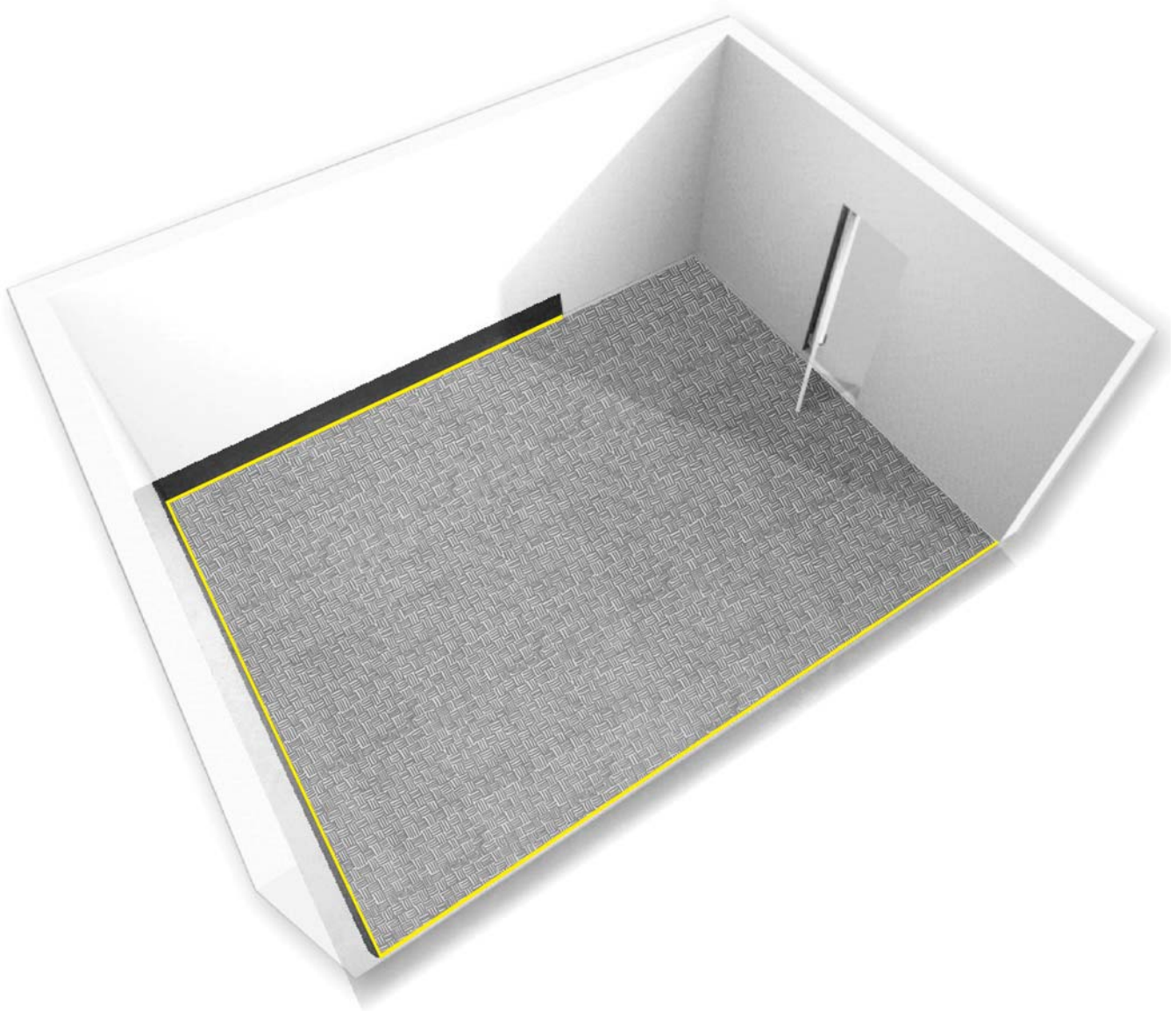

Second coat of adhesive

Starting from the first sheet, apply a second coat of adhesive using a plastic scraper, making sure to not allow any adhesive excess.

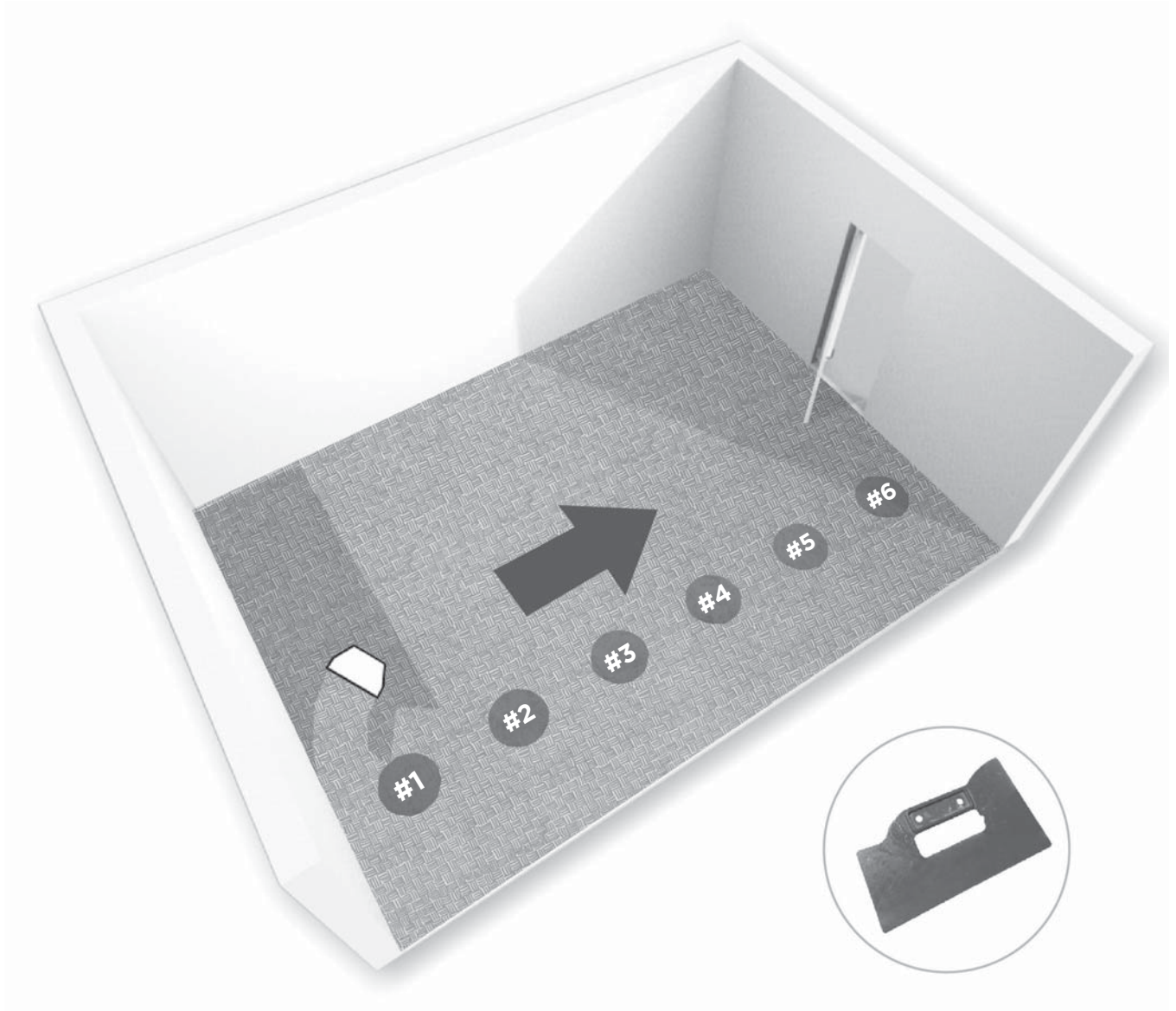

Adhesive drying

Wait for the adhesive to dry completely (1-2 hours)

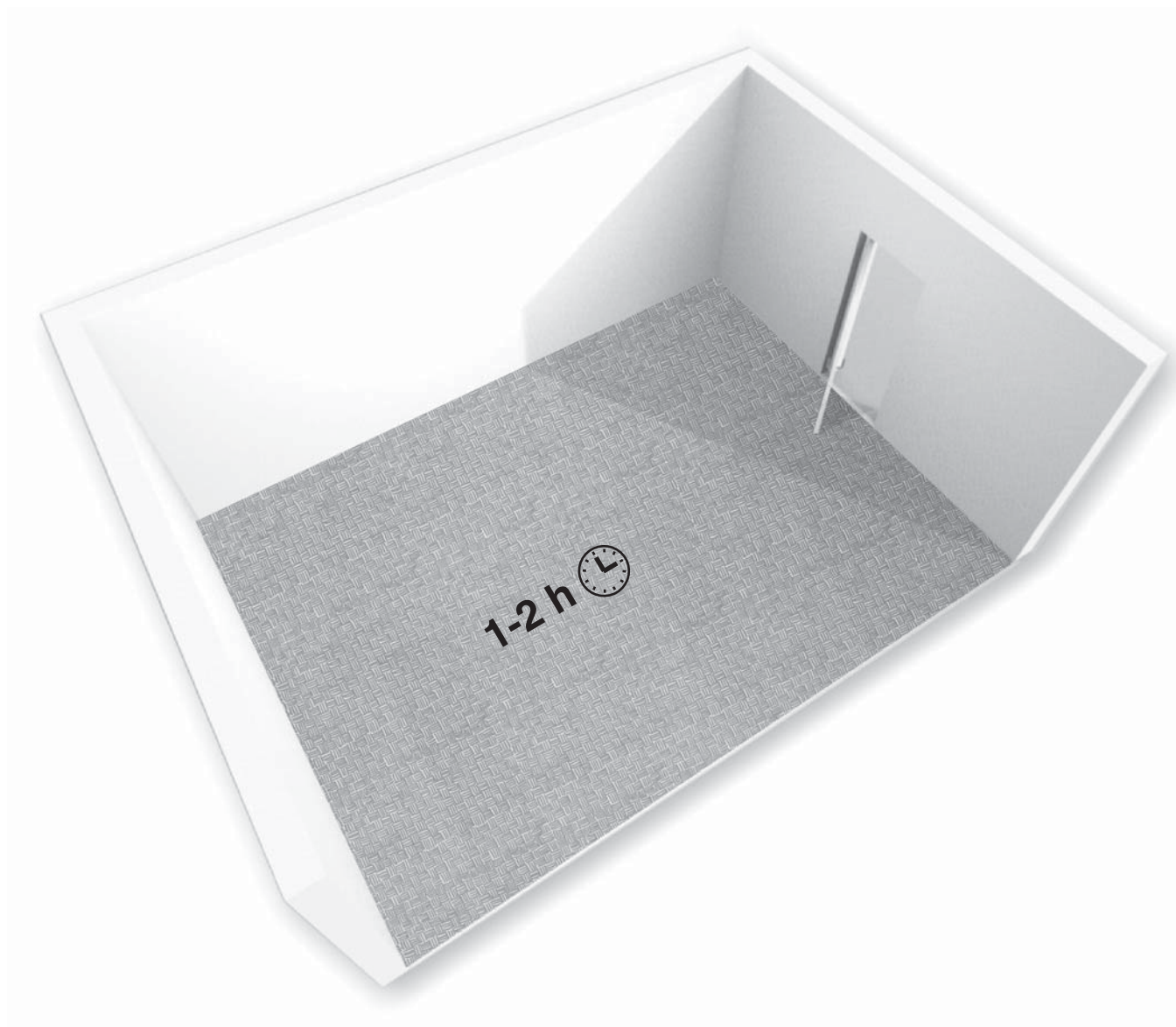

Preparing of finish product EQ•dekor FINISH

Preparing of finish product EQ•dekor FINISH for the first coat mix half bottle of component 'A' with third bottle of component 'B' and blend the compound using electric mixer with low revs.



EQ•dekor FINISH W/B

EQ•dekor FINISH W/A

Apply the first coat of finish

Apply a first coat of the bicomponent protective, evenly to the whole floor and allow to dry for at least 1-2 hours.

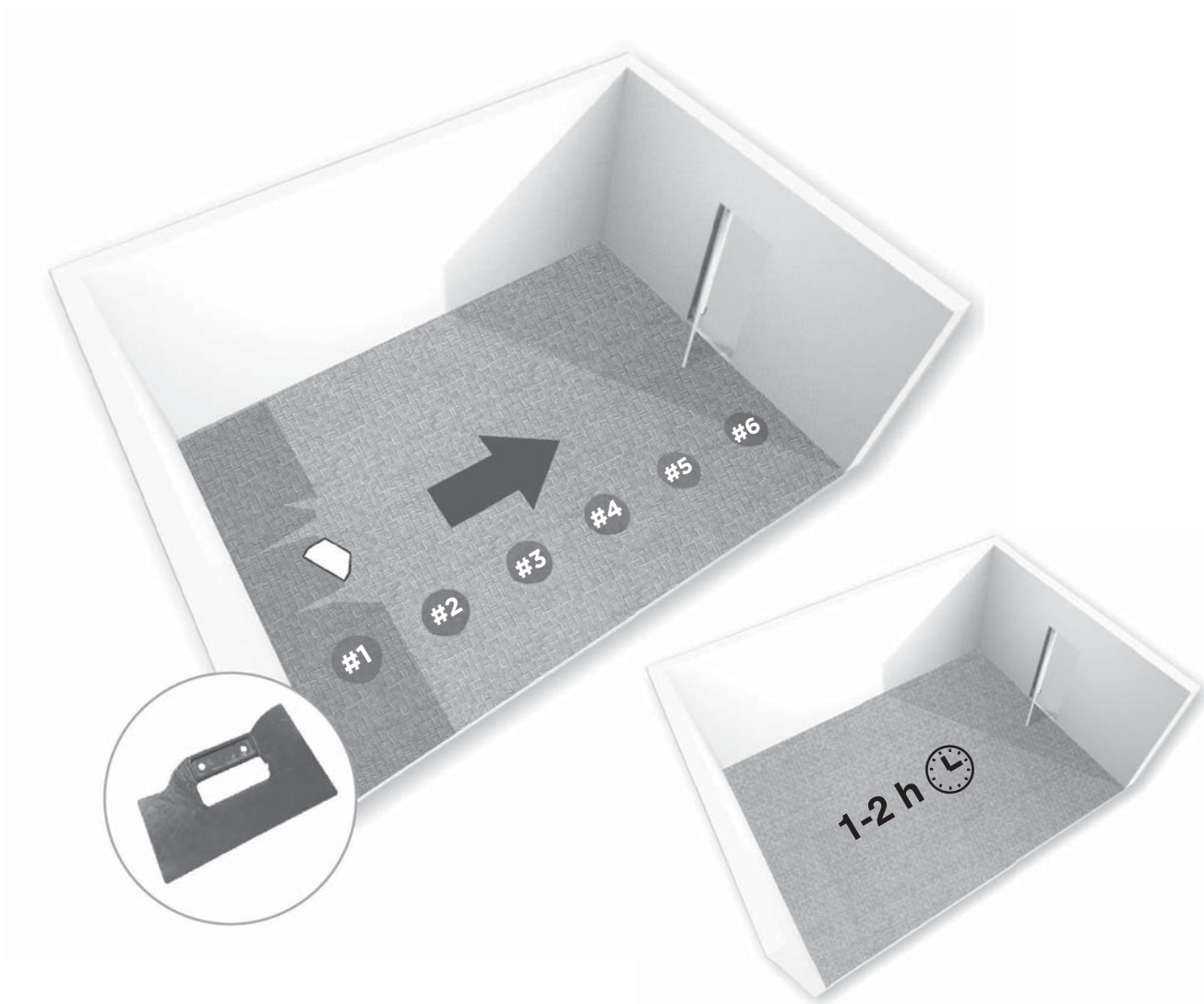

The room may be used again after 24 hours. Furniture or other heavy objects may be returned to the room, lifting and placing them in the desired positions, without dragging them.
EQ•decor FINISH 58 catalyses completely in 7 days, after which the surface will also withstand dragging or greater strain.

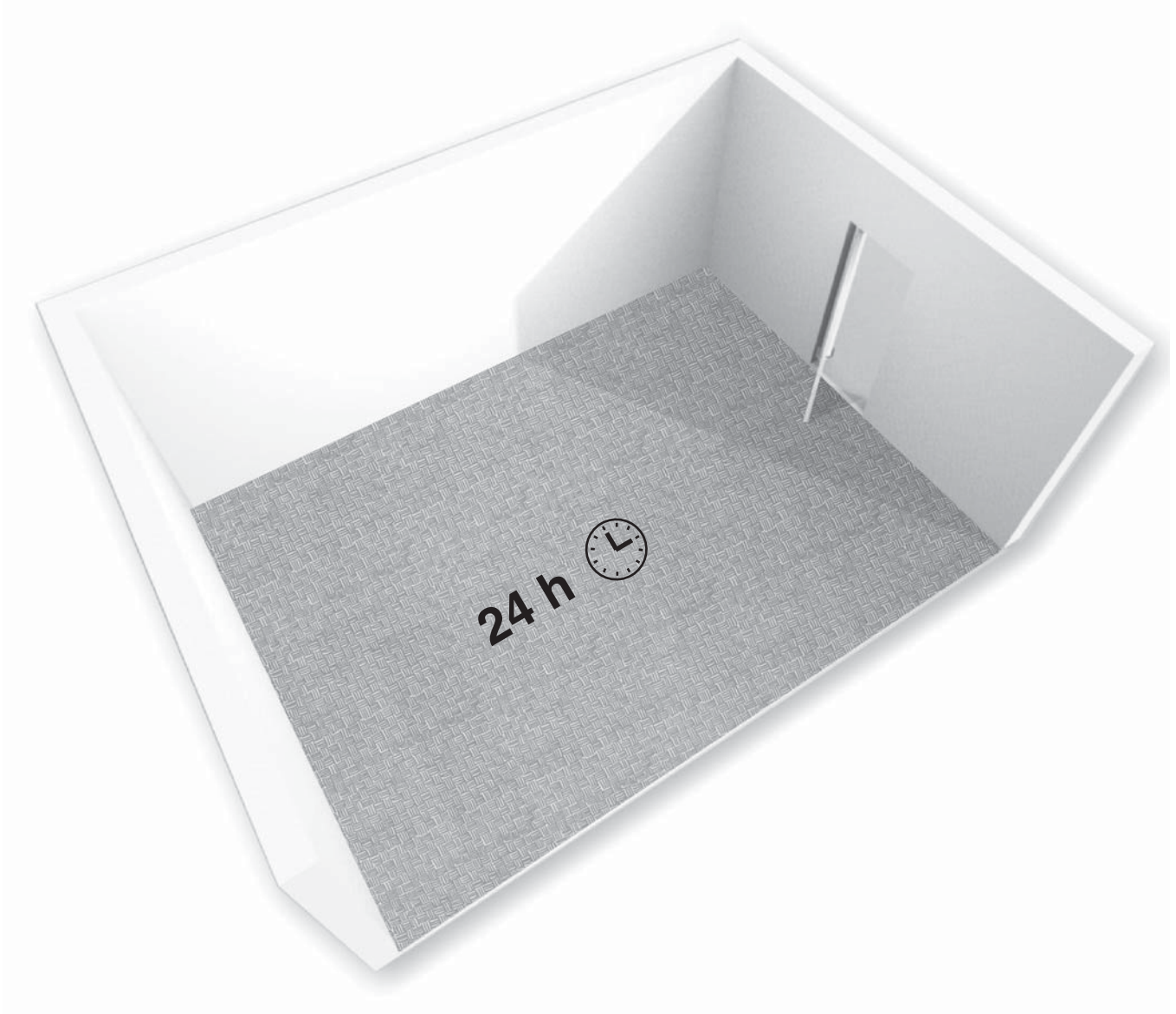

REXA

DESIGN

REXA DESIGN srl
via Maniago, 57/A
33080 San Quirino (PN) - Italy
Tel. 0434 593 182
Fax 0434 921579
info@rexadesign.it
www.rexadesign.it