

MEM Deck valve anti-clockwise closing hot - Platinum

MEM

20 005 783



- With linear texture
- hole diameter 32 mm
- rosette 60 x 60 mm
- with hot marking
- WRAS 2103001

	Platinum	20 005 783-08
	Chrome	20 005 783-00
	Brushed Platinum	20 005 783-06
	Dark Chrome	20 005 783-19
	Brushed Durabronze (23kt Gold)	20 005 783-28
	Brushed Champagne (22kt Gold)	20 005 783-46
	Champagne (22kt Gold)	20 005 783-47
	Brushed Dark Platinum	20 005 783-99

20 005 783

mm [inches]

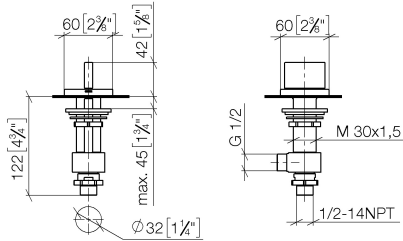

Flow rate chart

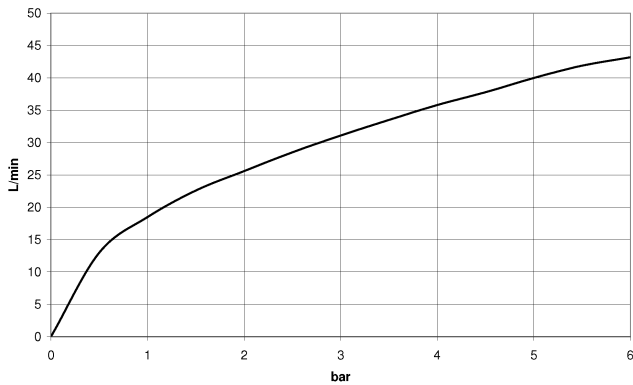

Codes & Standards

DIN 4109

ISO 3822

Scottish Water
Byelaws

UK Water Supply
Regulations

Ü-Zeichen



MEM Deck valve anti-clockwise closing hot - Platinum

MEM

20 005 783

Certificates

LGA_28

WRAS_2103

20 005 783

Product version from 9/1/2022

Parts for other
finishes can be found
here: [Chrome](#)

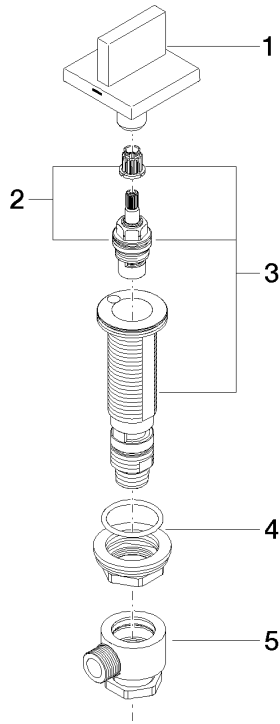



MEM Deck valve anti-clockwise closing hot - Platinum

MEM

20 005 783

Spare parts list

Product version from 9/1/2022

No.	Item Number	Name	Quantity used	Delivery time
	90 20 78 011 01-08	handle (hot)	5	40