

# Signaling units

## Ø 40 - 60 - 100

Harmony<sup>®</sup> XVC monolithic tower lights

Catalog

September **2013**



# How to find the “Automation and Control” products

## > Catalogs

Complete product ranges



## > Essential guides

Selection of the top selling products

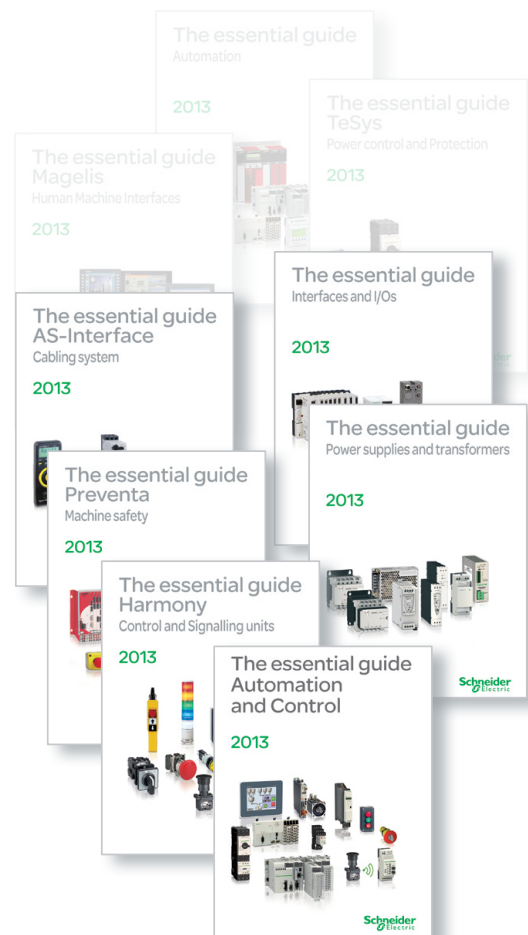

# General contents

## Harmony® XVC monolithic tower lights

*Selection guide* ..... *page 2*

### ■ Presentation

□ Pre-assembled and pre-cabled tower lights, Ø 40 to 100 mm, Harmony type XVC ..... *page 6*

### ■ References

□ Tower lights Ø 40 mm, type XVC4 ..... *page 7*

□ Tower lights Ø 60 mm, type XVC6 ..... *page 8*

□ Tower lights Ø 100 mm, type XVC1 ..... *page 9*

### ■ How to find the “Automation and Control” products

□ Search, visualize, and download ..... *page 10*

□ Access product references with adapted tools ..... *page 12*

□ Compare, select, and compile ..... *page 14*

□ Check the product status, design your equipment ..... *page 15*

■ **Product reference index** ..... *page 16*

Harmony® type XV **Monolithic tower lights**



<b>Type of products</b>	Complete pre-cabled pilot lights, height 55 mm/2.17 in.	Complete miniature beacons	Pre-assembled/pre-cabled tower lights Variable composition tower lights for customer assembly of up to 4 units
<b>Diameter</b>	Ø 25 mm/0.98 in.	Ø 45 mm/1.75 in.	Ø 60 mm/2.36 in.
<b>Degree of protection conforming to IEC 60529</b>	IP 40	IP 40	IP 53 and IP 42 (base mounting) IP 23 (direct aluminium tube mounting, aluminium tube mounting and "L" bracket) IP 53 and IP 42 (aluminium tube mounting and fixing plate) IP 40 (aluminium tube mounting and foldable bracket)
<b>Type of signalling</b>	Steady Flashing "Flash" Sound	Yes – Yes –	Yes – – With buzzer
<b>Light sources</b>	Incandescent bulb LED bulb Integral LED "Flash" discharge tube Halogen bulb	Yes – – Yes –	– – Yes – –
<b>Colors of illuminated units</b>	<input type="checkbox"/> Green <input type="checkbox"/> Red <input type="checkbox"/> Clear <input type="checkbox"/> Yellow	<input type="checkbox"/> Green <input type="checkbox"/> Red <input type="checkbox"/> Orange <input type="checkbox"/> Blue <input type="checkbox"/> Clear <input type="checkbox"/> Yellow	<input type="checkbox"/> Red <input type="checkbox"/> Green <input type="checkbox"/> Amber <input type="checkbox"/> Blue
<b>Connection</b>	Flying leads, length 360 mm/14.17 in.	Screw clamp terminals	Flying leads, length 500 to 560 mm/19.68 to 22.05 in. for tube mounting according to model. Length 900 mm/35.43 in. for base mounting.
<b>Support panel drilling or cut-out</b>	Ø 22 mm/0.87 in. or Ø 30 mm/1.18 in.	3 x Ø 3.3 mm/0.13 in. or M3	Base mounting: 3 x Ø 5 mm/0.20 in. Direct aluminium tube mounting: Ø 20/0.79 in. Aluminium tube mounting and "L" bracket: 2 x Ø 9/0.35 in. Aluminium tube mounting and fixing plate: 4 x Ø 6/0.24 in. Aluminium tube mounting and foldable bracket: 4 x Ø 6/0.24 in.
<b>Type references</b>	XV1CA	XVDLS	XVG



<b>Type of products</b>	Pre-assembled and pre-cabled tower lights	Pre-assembled and pre-cabled tower lights	Pre-assembled and pre-cabled tower lights	Pre-assembled and pre-cabled USB tower lights
<b>Diameter</b>	Ø 40 mm/1.57 in.	Ø 60 mm/2.36 in.	Ø 100 mm/3.94 in.	Ø 60 mm/2.36 in.
<b>Degree of protection conforming to IEC 60529</b>	IP 54 (flat surface installation) IP 23 (vertical surface installation)	IP 54 (flat surface installation) IP 23 (vertical surface installation)	IP 54 (flat surface installation)	IP 42
<b>Type of signalling</b>	Yes Yes – With buzzer – – Yes – –	Yes Yes – With buzzer – – Yes – –	Yes Yes – With siren or buzzer – – Yes – –	Yes Yes – With buzzer (volume control and alarm type can be set with HMI) – – Yes – –
<b>Light sources</b>	– – – – – –	– – – – – –	– – – – – –	– – – – – –
<b>Colors of illuminated units</b>	<input type="checkbox"/> Red <input type="checkbox"/> Orange <input type="checkbox"/> Green <input type="checkbox"/> Blue <input type="checkbox"/> Clear	<input type="checkbox"/> Red <input type="checkbox"/> Orange <input type="checkbox"/> Green <input type="checkbox"/> Blue <input type="checkbox"/> Clear	<input type="checkbox"/> Red <input type="checkbox"/> Orange <input type="checkbox"/> Green <input type="checkbox"/> Blue <input type="checkbox"/> Clear	Multi-color LEDs (many possible combinations can be set with HMI) <input type="checkbox"/> Red <input type="checkbox"/> Orange <input type="checkbox"/> Green <input type="checkbox"/> Blue
<b>Connection</b>	Flying leads, length 450 mm/17.71 in. to 900 mm/35.43 in. according to model	Flying leads, length 450 mm/17.71 in. to 850 mm/33.46 in. according to model	Flying leads, length 500 mm/19.68 in.	USB power cable: - 300 mm/11.81 in. for tube mounting - 400 mm/15.75 in. for direct mounting
<b>Support panel drilling or cut-out</b>	Mounting on support tube with bracket: 2 x Ø 9 mm/0.35 in. Direct mounting on horizontal support: 3 x Ø 5 mm/0.20 in. Other mounting possibilities with accessories	Mounting on support tube with bracket: 2 x Ø 11 mm/0.43 in. Direct mounting on horizontal support: 3 x Ø 5 mm/0.20 in. Other mounting possibilities with accessories	Direct mounting on horizontal support: - 3 x Ø 6 mm/0.24 in. (without siren) - 3 x Ø 7 mm/0.28 in. (with siren) Other mounting possibilities with accessories	Mounting on support tube with fixing plate: 4 x Ø 6 mm/0.24 in. Direct mounting on horizontal support: 3 x Ø 5 mm/0.20 in.
<b>Type references</b>	XVC4	XVC6	XVC1	XVGU

Harmony® type XV		Modular tower lights	
			
<b>Type of products</b>	Pre-assembled/pre-cabled tower lights Variable composition tower lights for customer assembly of up to 5 units	Tower lights for customer assembly of up to 5 units.	
<b>Diameter</b>	Ø 45 mm/1.77 in.	Ø 60 mm/2.36 in.	
<b>Degree of protection conforming to IEC 60529</b>	IP 54 in vertical position (XVM with plastic fixing plate) IP 42 in horizontal position (XVM with metal bracket) IP 40 in other positions (all types of XVM tower lights)	IP 65 for illuminated units IP 54 for audible units IP 55 for flexible mounting option	
<b>Type of signalling</b>	Steady Flashing "Flash" Sound	Yes Yes Yes Yes	Yes Yes Yes Yes
<b>Light sources</b>	Incandescent bulb LED bulb Integral LED "Flash" discharge tube Halogen bulb	Yes Yes - Yes -	- - Yes - -
<b>Colors of illuminated units</b>	<input type="checkbox"/> Red <input type="checkbox"/> Green <input type="checkbox"/> Orange <input type="checkbox"/> Blue <input type="checkbox"/> Clear	<input type="checkbox"/> Green <input type="checkbox"/> Red <input type="checkbox"/> Orange <input type="checkbox"/> Blue <input type="checkbox"/> White <input type="checkbox"/> Yellow (only for multi-color unit with above colors)	
<b>Connection</b>	Flying leads, length 300 mm/11.81 in. or screw terminals	Spring cage connection terminals	
<b>Support panel drilling or cut-out</b>	Mounting on bracket: 2 x Ø 9 mm /0.35 in. Mounting on support tube: 4 x Ø 5.5 mm/0.22 in. or M5	Mounting on support tube and adjustable support tube: 4 x Ø 6 mm/0.24 in.  Direct mounting and Flexible wall mounting: 3 x Ø 5 mm/0.196 in.	
<b>Type references</b>	XVM	XVU	

		Rotating beacons	Sound solutions
			
<b>Type of products</b>	Illuminated beacons Variable composition tower lights for customer assembly of up to 5 units	Pre-cabled rotating beacons	Sirens and electronic alarms
<b>Diameter</b>	Ø 70 mm/2.76 in.	Ø 84 mm/3.31 in. to Ø 130 mm/5.12 in.	-
<b>Degree of protection conforming to IEC 60529</b>	IP 65 (mounted on fixing base XVBZ0●) IP 66 (mounted on base unit)	Ø 84 mm/3.31 in. and Ø 106 mm/4.17 in.: IP 23 (IP 65 with accessory) Ø 120 mm/4.72 in.: IP 23 Ø 130 mm/5.12 in.: IP 66 and IP 67 (depending on voltage)	IP 53 (sirens) IP 54 (electronic alarms)
<b>Type of signalling</b>	Yes Yes Yes Yes Yes	Yes - - Yes -	- - - Yes -
<b>Light sources</b>	Yes "PROTECTED LED" "PROTECTED LED" Yes -	- "Super Bright" - - Yes	- - - - -
<b>Colors of illuminated units</b>	<input type="checkbox"/> Green <input type="checkbox"/> Red <input type="checkbox"/> Orange <input type="checkbox"/> Blue <input type="checkbox"/> Clear <input type="checkbox"/> Yellow	<input type="checkbox"/> Red <input type="checkbox"/> Orange <input type="checkbox"/> Green <input type="checkbox"/> Blue	-
<b>Connection</b>	Screw clamp terminals	Flying leads, length 400 mm/15.75 in.(except XVR08: 500 mm/19.68 in.)	Screw clamp terminals (except XVS14: flying leads, length 500 mm/19.68 in.)
<b>Support panel drilling or cut-out</b>	Mounting on support tube: 4 x Ø 5.5 mm/0.22 in. or M5 Vertical mounting: 3 x Ø 5 mm/0.20 in. or M5 Direct mounting: 2 x Ø 4.5 mm/0.18 in. or M4	Depending on model: - XVR08 (Ø 84 mm/3.31 in.): 3 x Ø 5 mm/0.20 in. - XVR10 (Ø 106 mm/5.12 in.): 3 x Ø 5 mm/0.20 in. - XVR12 (Ø 120 mm/4.72 in.): 3 x Ø 6 mm/0.24 in. - XVR13 (Ø 130 mm/5.12 in.): 3 x Ø 9 mm/0.35 in. - XVR13●●L (Ø 130 mm/5.12 in.): 3 x Ø 7 mm/0.28 in.	3 x Ø 6.5 mm/0.25 in.
<b>Type references</b>	XVBL, XVBC	XVR	XVS

# Signaling Units

## Monolithic tower lights

### Harmony® type XVC Ø 40, Ø 60 and Ø 100

#### Pre-assembled/pre-cabled tower lights



#### Presentation

The monolithic tower lights in the Harmony® XVC range are designed for long distance indication of the operating states or sequences of a machine or installation, either visually by means of illuminated signaling units visible through 360°, or audibly by means of an adjustable buzzer or siren.

- The range includes both small diameter (40 and 60 mm) and large diameter products (100 mm). It is therefore virtually suitable for use in all activity sectors:
  - XVC4 (40 mm) tower lights are used mainly in the food-processing and medical sectors,
  - XVC6 (60 mm) tower lights are used in semi-conductor factories, on conveyor belts and on small food or drink dispensing machines in the commercial sector,
  - XVC1 (100 mm) tower lights are more particularly designed for industrial applications and machine-tools.

- The entire range provides an IP 54 degree of protection to allow both outdoor and indoor use.

- XVC tower lights are supplied:
  - with 1, 2, 3, 4, or 5 illuminated signaling units (up to 3 for XVC1●●HK),
  - with or without a buzzer or siren,
  - pre-assembled and pre-cabled,
  - fitted with a support tube and bracket for mounting on a vertical support or 3 screws for direct mounting on a horizontal surface (depending on the model).

- XVC tower lights are supplied:

- with 1, 2, 3, 4, or 5 illuminated signaling units (up to 3 for XVC1●●HK),
- with or without a buzzer or siren,
- pre-assembled and pre-cabled,
- fitted with a support tube and bracket for mounting on a vertical support or 3 screws for direct mounting on a horizontal surface (depending on the model).

#### Illuminated signaling

Several lens unit colors are available in the catalog:

- 5 colors for XVC1●●K and XVC1●●SK (Red, Orange, Green, Blue or Clear),
- 3 colors for XVC1●●HK (Red, Orange, Green).

The colors are always placed in the above mentioned order, from top to bottom. The light source consists of Super Bright LEDs which provide optimum luminosity.

#### Audible signaling

The XVC tower lights are supplied with or without an audible signaling unit (buzzer or siren) depending on the required configuration. This audible unit is located in the base of the tower light.

For products equipped with a buzzer, the type of signal (continuous or intermittent) can be reversed by modifying the cable connections (only for 60 and 100 mm units). For products equipped with a siren, it is possible to choose between 16 melodies, either by a switch or by 4 external digital outputs.

A potentiometer is also present in the base for adjusting the audible signaling volume, up to a value of:

- 85 dB for XVC1●●K and XVC1●●SK (equipped with a buzzer),
- 102 dB for XVC1●●HK (equipped with a siren).

#### Environment

- The degree of protection of XVC tower lights depends on the installation mode:
  - IP 54 (both outdoor and indoor use) for all models, when mounted on a horizontal surface,
  - IP 23 for tower lights of Ø 40 and Ø 60 mm, when mounted on a vertical surface.

- XVC tower lights conform with the EN/IEC standards, depending on voltage :
  - EN/IEC 61000 for 24 V A.C./D.C. (40 and 60 mm) and 24 V D.C. (100 mm),
  - EN/IEC 60947 for 100-240 V A.C. (40, 60 and 100 mm).

- The whole range of tower lights is CE, UL and CSA certified.

#### Cabling

XVC tower lights supplied pre-assembled are equipped with wires marked with a label indicating the correct way to connect. Each level is marked by a different colored wire.

XVC tower lights that have been pre-assembled and pre-cabled at the factory cannot be modified because the wires are permanently connected (soldered).

# Signaling Units

## Monolithic tower lights

### Harmony® type XVC Ø 40

#### Pre-assembled/pre-cabled tower lights

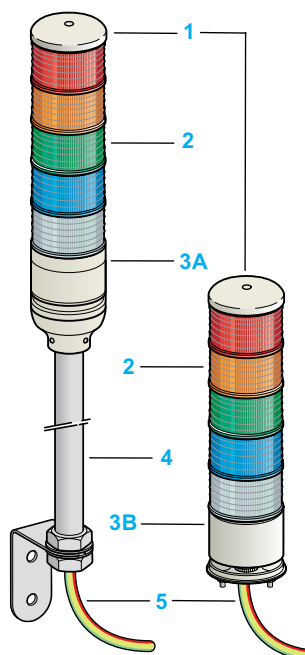

### Description

XVC Ø 40, Ø 60 and Ø 100 mm tower lights comprise an assembly of:

- 1 cover.
- 2 One, two, three, four or five colored illuminated signaling units (Red, Orange, Green, Blue or Clear). Each illuminated unit is equipped with a LED (Super Bright LED).
- 3 A base mounted on the support tube **3A** or a base fitted with 3 screws **3B** for direct mounting on a horizontal surface.
- 4 A chromium plated-steel support tube mounted on a bracket (support tube depending on the model) for mounting on a vertical support (support tube on this page is for XVC Ø 40 mm and XVC Ø 60 mm).
- 5 Marked wires, with projecting length of 500 to 900 mm (depending on the model).

### Pre-assembled and pre-cabled tower lights Ø 40 mm

Description	Light source (included)	Voltage V	Signaling colors (1)		Reference	Weight kg
			Steady	Flashing (2)		
<b>For support tube mounting, 17 mm, on horizontal (IP 54) or vertical (IP 23) surface</b>						
<b>Without buzzer</b>	LED for steady light only	≈ 24	R	–	<b>XVC4B1</b>	0.500
			R, O	–	<b>XVC4B2</b>	0.520
			R, O, G	–	<b>XVC4B3</b>	0.540
			R, O, G, B	–	<b>XVC4B4</b>	0.560
			R, O, G, B, C	–	<b>XVC4B5</b>	0.580
~ 100-240			R	–	<b>XVC4M1</b>	0.720
			R, O	–	<b>XVC4M2</b>	0.750
			R, O, G	–	<b>XVC4M3</b>	0.780
			R, O, G, B	–	<b>XVC4M4</b>	0.810
			R, O, G, B, C	–	<b>XVC4M5</b>	0.840
<b>With buzzer</b> Sound level at 1 m: 70 to 85 dB, continuous or intermittent tone + flashing light	LED for steady or flashing light	≈ 24	R	R	<b>XVC4B15S</b>	0.600
			R, O	R, O	<b>XVC4B25S</b>	0.620
			R, O, G	R, O, G	<b>XVC4B35S</b>	0.640
			R, O, G, B	R, O, G, B	<b>XVC4B45S</b>	0.660
			R, O, G, B, C	R, O, G, B, C	<b>XVC4B55S</b>	0.680
~ 100-240			R	R	<b>XVC4M15S</b>	0.740
			R, O	R, O	<b>XVC4M25S</b>	0.770
			R, O, G	R, O, G	<b>XVC4M35S</b>	0.800
			R, O, G, B	R, O, G, B	<b>XVC4M45S</b>	0.830
			R, O, G, B, C	R, O, G, B, C	<b>XVC4M55S</b>	0.860

### For direct base mounting on horizontal surface (IP 54)

<b>Without buzzer</b>	LED for steady light only	≈ 24	R	–	<b>XVC4B1K</b>	0.100
			R, O	–	<b>XVC4B2K</b>	0.120
			R, O, G	–	<b>XVC4B3K</b>	0.140
			R, O, G, B	–	<b>XVC4B4K</b>	0.160
			R, O, G, B, C	–	<b>XVC4B5K</b>	0.180

### Accessories for support tube mounting (for tower lights XVC4●● and XVC4●●5S)

Description	Diameter mm	Minimum height to be added mm	Reference	Weight kg
<b>Metal fixing plate IP 54</b>	90	32	<b>XVCZ11</b>	0.100
<b>Plastic fixing plate IP 54</b>	84	24.5	<b>XVCZ01</b>	0.060
<b>Wall mounting bracket IP 54</b>	–	82	<b>XVCZ31</b>	0.130

(1) Signaling colors: R: Red, O: Orange, G: Green, B: Blue, C: Clear. The colors are listed in the same order as the mounting order of the illuminated units (from top to bottom).

(2) Flashing function can be simply selected/programmed by wiring.

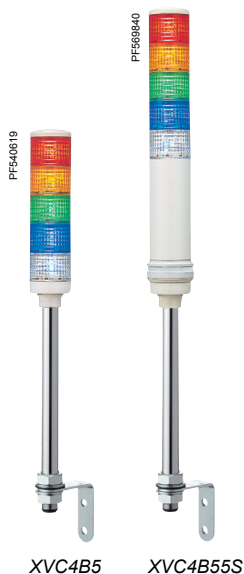

XVC4B5

XVC4B55S



XVCZ11



XVCZ01



XVCZ31

# Signaling Units

## Monolithic tower lights

### Harmony® type XVC Ø 60

Pre-assembled/pre-cabled tower lights

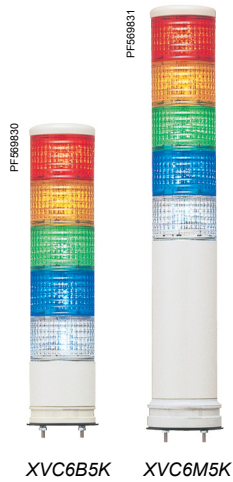

XVC6B5K

XVC6M5K



XVCZ02



XVCZ12



XVCZ12



XVCZ32

### Pre-assembled and pre-cabled tower lights Ø 60 mm

Description	Light source (included)	Voltage V	Signaling colors (1)		Reference	Weight kg
			Steady	Flashing (2)		
<b>For support tube mounting, 22 mm, on horizontal (IP 54) or vertical (IP 23) surface</b>						
Without buzzer	LED for steady light only	≈ 24	R	–	XVC6B1	0.700
			R, O	–	XVC6B2	0.740
			R, O, G	–	XVC6B3	0.780
			R, O, G, B	–	XVC6B4	0.820
			R, O, G, B, C	–	XVC6B5	0.860
		~ 100-240	R	–	XVC6M1	0.960
			R, O	–	XVC6M2	1.020
			R, O, G	–	XVC6M3	1.070
			R, O, G, B	–	XVC6M4	1.120
			R, O, G, B, C	–	XVC6M5	1.180
With buzzer Sound level at 1 m: 70 to 85 dB, continuous or intermittent tone + flashing light	LED for steady or flashing light	≈ 24	R	R	XVC6B15S	0.900
			R, O	R, O	XVC6B25S	0.940
			R, O, G	R, O, G	XVC6B35S	0.980
			R, O, G, B	R, O, G, B	XVC6B45S	1.020
			R, O, G, B, C	R, O, G, B, C	XVC6B55S	1.060
		~ 100-240	R	R	XVC6M15S	1.010
			R, O	R, O	XVC6M25S	1.070
			R, O, G	R, O, G	XVC6M35S	1.120
			R, O, G, B	R, O, G, B	XVC6M45S	1.170
			R, O, G, B, C	R, O, G, B, C	XVC6M55S	1.230

### For base mounting on horizontal surface (IP 54)

Without buzzer	LED for steady light only	≈ 24	R	–	XVC6B1K	0.200
			R, O	–	XVC6B2K	0.250
			R, O, G	–	XVC6B3K	0.300
			R, O, G, B	–	XVC6B4K	0.350
			R, O, G, B, C	–	XVC6B5K	0.400
		~ 100-240	R	–	XVC6M1K	0.440
			R, O	–	XVC6M2K	0.500
			R, O, G	–	XVC6M3K	0.550
			R, O, G, B	–	XVC6M4K	0.600
			R, O, G, B, C	–	XVC6M5K	0.660
With buzzer Sound level at 1 m: 70 to 85 dB, continuous or intermittent tone + flashing light	LED for steady or flashing light	≈ 24	R	R	XVC6B15SK	0.200
			R, O	R, O	XVC6B25SK	0.250
			R, O, G	R, O, G	XVC6B35SK	0.300
			R, O, G, B	R, O, G, B	XVC6B45SK	0.350
			R, O, G, B, C	R, O, G, B, C	XVC6B55SK	0.400
		~ 100-240	R	R	XVC6M15SK	0.490
			R, O	R, O	XVC6M25SK	0.550
			R, O, G	R, O, G	XVC6M35SK	0.600
			R, O, G, B	R, O, G, B	XVC6M45SK	0.650
			R, O, G, B, C	R, O, G, B, C	XVC6M55SK	0.710

### Accessories for support tube mounting or base mounting

Description	Utilization for	Diameter mm	Minimum height to be added (mm)	Reference	Weight kg
<b>Metal fixing plate IP 54</b>	<b>Support-tube mounting with XVC6●● and XVC6●●5S</b>	100	30	XVCZ02	0.080
<b>Metal fixing plate IP 54</b>	<b>Direct base mounting with XVC6●●K and XVC6●●5SK</b>	84	21.6	XVCZ12	0.100
<b>Wall mounting bracket IP 54</b>	<b>Support-tube mounting with XVC6●● and XVC6●●5S</b>	–	82	XVCZ32	0.130

(1) Signaling colors: R: Red, O: Orange, G: Green, B: Blue, C: Clear. The colors are listed in the same order as the mounting order of the illuminated units (from top to bottom).

(2) Flashing function can be simply selected/programmed by wiring.



# Signaling Units

## Monolithic tower lights

### Harmony® type XVC Ø 100

Pre-assembled/pre-cabled tower lights



Pre-assembled and pre-cabled tower lights Ø 100 mm							
Description	Light source (included)	Voltage V	Signaling colors (1)		Reference	Weight kg	
			Steady	Flashing (2)			
<b>For direct base mounting on horizontal surface (IP 54)</b>							
<b>Without buzzer</b> <b>With flashing light</b>	LED for steady or flashing light	~ 24	R	R	<b>XVC1B1K</b>	0.700	
			R, O	R, O	<b>XVC1B2K</b>	0.900	
			R, O, G	R, O, G	<b>XVC1B3K</b>	1.100	
			R, O, G, B	R, O, G, B	<b>XVC1B4K</b>	1.300	
			R, O, G, B, C	R, O, G, B, C	<b>XVC1B5K</b>	1.500	
			~ 100-240	R	R	<b>XVC1M1K</b>	1.000
			R, O	R, O	<b>XVC1M2K</b>	1.200	
			R, O, G	R, O, G	<b>XVC1M3K</b>	1.400	
			R, O, G, B	R, O, G, B	<b>XVC1M4K</b>	1.600	
			R, O, G, B, C	R, O, G, B, C	<b>XVC1M5K</b>	1.800	
<b>With buzzer</b> <b>Sound level at 1 m: 60 dB to 85 dB, continuous or intermittent tone + flashing light</b>	LED for steady or flashing light	~ 24	R	R	<b>XVC1B1SK</b>	0.700	
			R, O	R, O	<b>XVC1B2SK</b>	0.900	
			R, O, G	R, O, G	<b>XVC1B3SK</b>	1.100	
			R, O, G, B	R, O, G, B	<b>XVC1B4SK</b>	1.300	
			R, O, G, B, C	R, O, G, B, C	<b>XVC1B5SK</b>	1.500	
			~ 100-240	R	R	<b>XVC1M1SK</b>	1.050
			R, O	R, O	<b>XVC1M2SK</b>	1.250	
			R, O, G	R, O, G	<b>XVC1M3SK</b>	1.450	
			R, O, G, B	R, O, G, B	<b>XVC1M4SK</b>	1.650	
			R, O, G, B, C	R, O, G, B, C	<b>XVC1M5SK</b>	1.850	
<b>With siren</b> <b>Sound level at 1 m: 0 to 102 dB, 16 melodies + flashing light</b>	LED for steady or flashing light	~ 24	R	R	<b>XVC1B1HK</b>	1.580	
			R, O	R, O	<b>XVC1B2HK</b>	1.780	
			R, O, G	R, O, G	<b>XVC1B3HK</b>	1.980	
			~ 100-240	R	R	<b>XVC1M1HK</b>	1.680
			R, O	R, O	<b>XVC1M2HK</b>	1.880	
			R, O, G	R, O, G	<b>XVC1M3HK</b>	2.080	



Accessories for mounting on vertical support (IP 23)						
Description	For use with	Diameter mm	Height mm	Reference	Weight kg	
Chromium plated-steel extension tube with metal fixing plate	XVC1●●K and XVC1●●SK	140	300	<b>XVCZ13</b>	0.700	
	XVC1●●HK (with siren)	140	306	<b>XVCZ14</b>	0.700	
Metal fixing bracket	XVC1●●K and XVC1●●SK	-	-	<b>XVCZ23</b>	0.380	
	XVC1●●HK (with siren)	-	-	<b>XVCZ24</b>	0.380	

(1) Signaling colors: R: Red, O: Orange, G: Green, B: Blue, C: Clear. The colors are listed in the same order as the mounting order of the illuminated units (from top to bottom).  
 (2) Flashing function can be simply selected/programmed by wiring.

# Search, visualize, and download

Use your tablet or your PC to quickly access detailed and comprehensive information on our products



## Tablets

Application name: "Automation Library by Schneider Electric"

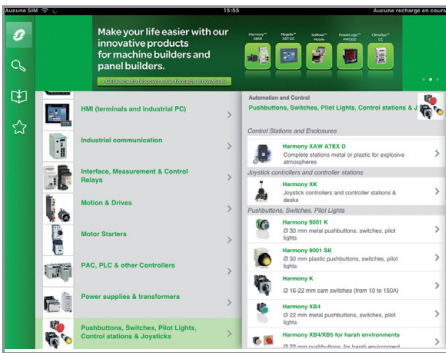

Product ranges displayed by function

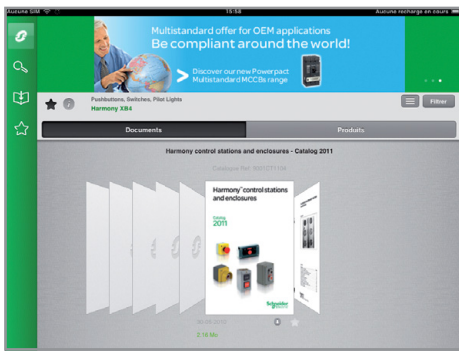

Control and signaling units Ø 22  
Harmony<sup>®</sup> XEP mendicite  
Catalog  
January 2013

Dynamic catalogs (hyperlinks, video, ...)

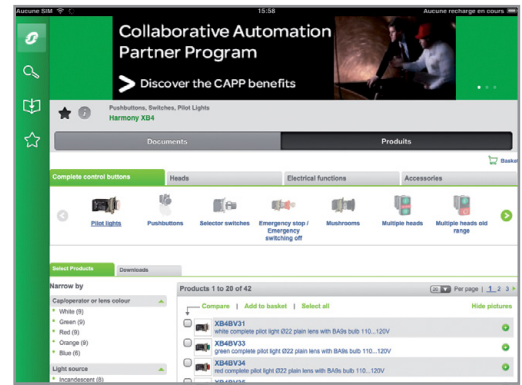

Product selector: dynamic filters to get easily your part number



# Personal computer

Path: [www.schneider-electric.com](http://www.schneider-electric.com) > **Products and Services** > Automation and control > Product offer

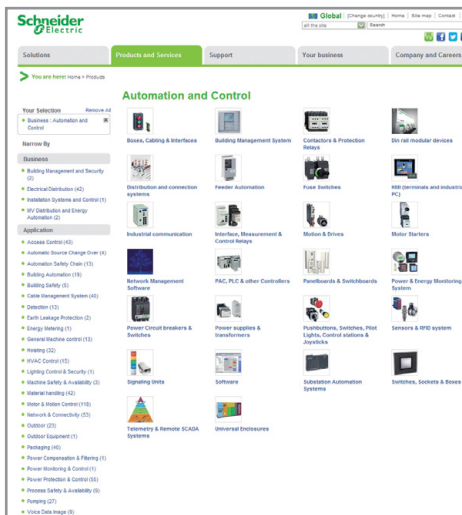

**Product ranges displayed by function**

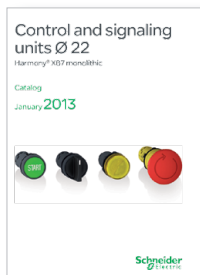
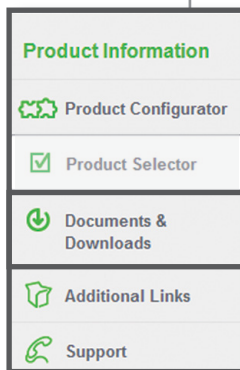
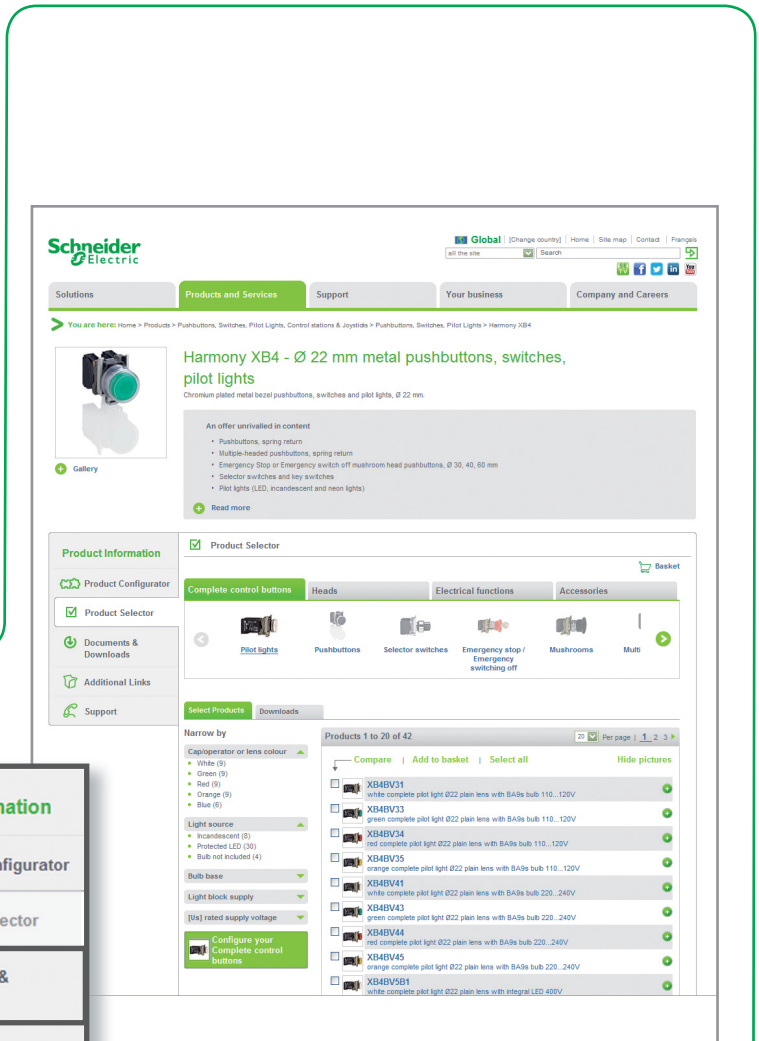

**Dynamic catalogs** (hyperlinks, video, ...)

**Product selector: dynamic filters** to get easily your part number

# Access product references with adapted tools



Path: [www.schneider-electric.com](http://www.schneider-electric.com) > **Products and Services** > Automation and control > ... > Product offer

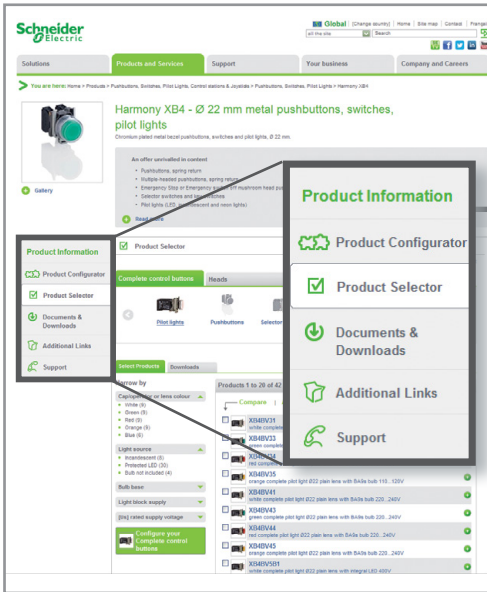

**Graphic product configurator**  
Select the right product with just a few clicks

**Dynamic product selector**  
Visualize product characteristics and dimensions

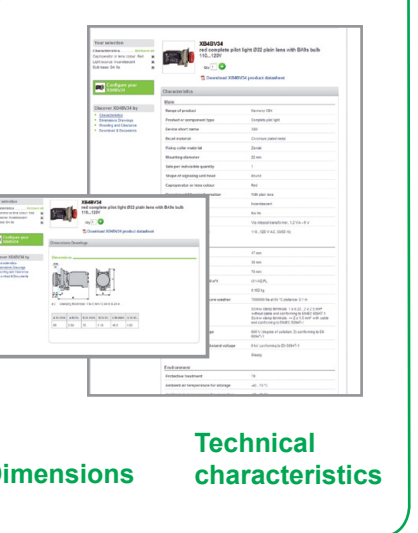
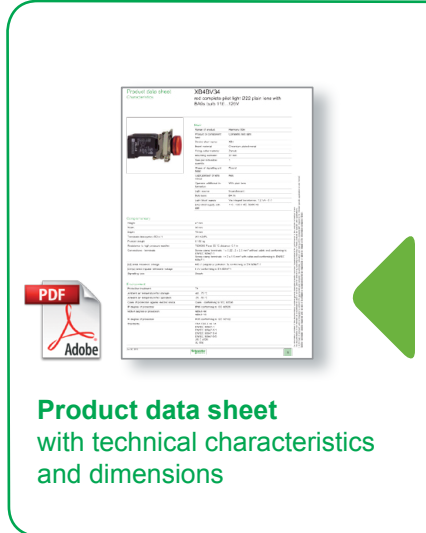
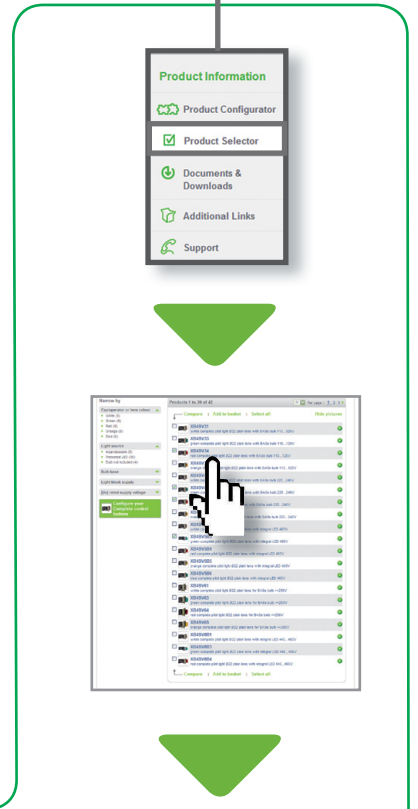
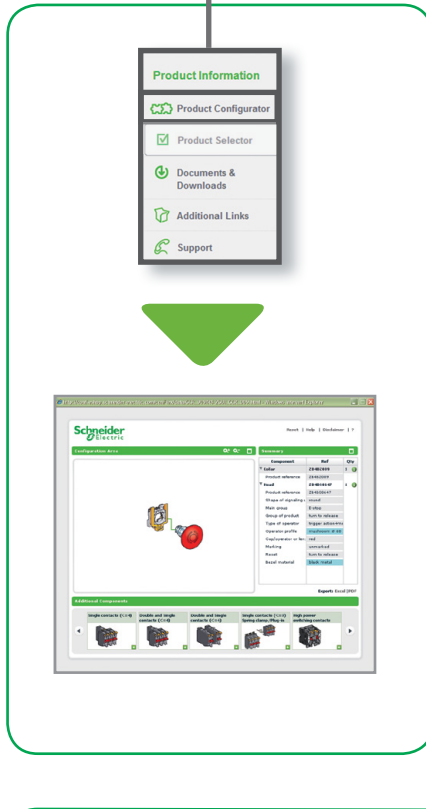

**Product data sheet**  
with technical characteristics  
and dimensions

**Dimensions**

**Technical characteristics**

Documents and downloads  
Visualize and download catalogs,  
technical publications, certificates, etc.

**Product Information**

- Product Configurator
- Product Selector

**Documents & Downloads**

- Additional Links
- Support

Schneider electric

**Products and Services**

Harmony XB4 - Ø 22 mm metal pushbuttons, switches, pilot lights

**Documents & Downloads**

Title	Date	Size
Response for Safety Voltage switch Phase 202201210121012	Jan 26, 2012	63.0 KB
Harmony XB4 Pushbutton, switches and pilot lights - 202201210121012	Jan 19, 2012	1.17 MB
The essential guide of ControlPanel	Jan 16, 2012	58.0 KB
The essential guide of PowerSupply	Jan 16, 2012	1.04 MB
Harmony XB4 switch on control 202201210121012	Jan 16, 2012	1.04 MB
The essential guide of Control & Control Panel	Jan 16, 2012	1.04 MB
Harmony XB4 switch on control 202201210121012	Jan 16, 2012	1.04 MB
Harmony XB4 switch on control 202201210121012	Jan 16, 2012	1.04 MB
Harmony XB4 switch on control 202201210121012	Jan 16, 2012	1.04 MB
Harmony XB4 switch on control 202201210121012	Jan 16, 2012	1.04 MB
Harmony XB4 switch on control 202201210121012	Jan 16, 2012	1.04 MB
Harmony XB4 switch on control 202201210121012	Jan 16, 2012	1.04 MB
Harmony XB4 switch on control 202201210121012	Jan 16, 2012	1.04 MB
Harmony XB4 switch on control 202201210121012	Jan 16, 2012	1.04 MB
Harmony XB4 switch on control 202201210121012	Jan 16, 2012	1.04 MB
Harmony XB4 switch on control 202201210121012	Jan 16, 2012	1.04 MB
Harmony XB4 switch on control 202201210121012	Jan 16, 2012	1.04 MB
Harmony XB4 switch on control 202201210121012	Jan 16, 2012	1.04 MB
Harmony XB4 switch on control 202201210121012	Jan 16, 2012	1.04 MB
Harmony XB4 switch on control 202201210121012	Jan 16, 2012	1.04 MB
Harmony XB4 switch on control 202201210121012	Jan 16, 2012	1.04 MB
Harmony XB4 switch on control 202201210121012	Jan 16, 2012	1.04 MB
Harmony XB4 switch on control 202201210121012	Jan 16, 2012	1.04 MB
Harmony XB4 switch on control 202201210121012	Jan 16, 2012	1.04 MB
Harmony XB4 switch on control 202201210121012	Jan 16, 2012	1.04 MB
Harmony XB4 switch on control 202201210121012	Jan 16, 2012	1.04 MB
Harmony XB4 switch on control 202201210121012	Jan 16, 2012	1.04 MB
Harmony XB4 switch on control 202201210121012	Jan 16, 2012	1.04 MB
Harmony XB4 switch on control 202201210121012	Jan 16, 2012	1.04 MB
Harmony XB4 switch on control 202201210121012	Jan 16, 2012	1.04 MB
Harmony XB4 switch on control 202201210121012	Jan 16, 2012	1.04 MB
Harmony XB4 switch on control 202201210121012	Jan 16, 2012	1.04 MB
Harmony XB4 switch on control 202201210121012	Jan 16, 2012	1.04 MB
Harmony XB4 switch on control 202201210121012	Jan 16, 2012	1.04 MB

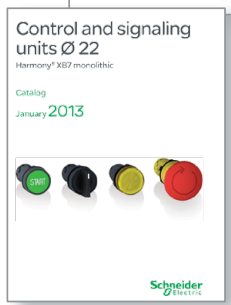

**Essential guides**

**TYPE APPROVAL CERTIFICATE**

Schneider Electric Industrie SAS

**ROHS BUTTONS (LOW VOLTAGE)**  
CONTROL AND SIGNALING UNITS Ø22 - Ø24 - Ø26 - Ø28 - Ø30

**Certificates**

**ZB4BC / ZB5AC**

**Installation / Mise en œuvre / Utilizzazione**

**HAZARD OF ELECTRIC SHOCK / DANGER OF ELECTRIC SHOCK / PELIGRO DE ELECTROCUCIÓN / PELIGRO DE ELECTRICIDAD**

**Technical publications**

**Dynamic catalogs**

# Compare, select, and compile



Path: [www.schneider-electric.com](http://www.schneider-electric.com) > **Products and Services** > Automation and control > ... > Harmony XB4\*

**Compare**  
technical  
characteristics

**Select**  
and store  
your products  
into  
the basket

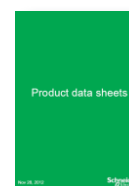

**Compile**  
data sheets  
in a unique  
document

\* Example of research on a product

# Check the product status, design your equipment



Path: [www.schneider-electric.com](http://www.schneider-electric.com) > **Support** > Product Substitution Tool  
 Path: [www.schneider-electric.com](http://www.schneider-electric.com) > **Support** > CAD files

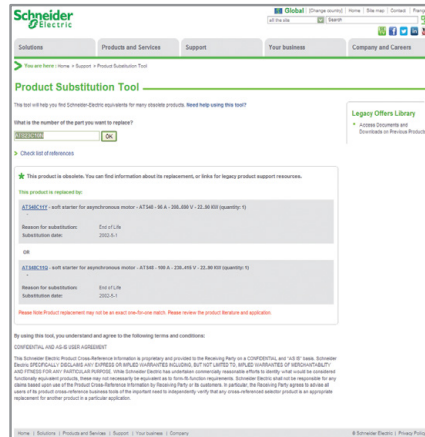
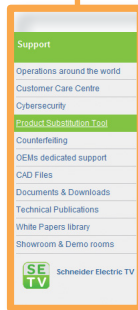
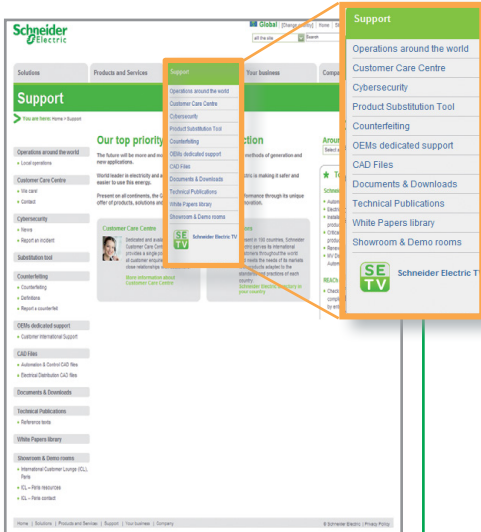

**Product status:**  
 indicate whether the product is still commercialized. Otherwise, the tool suggests a product substitution.

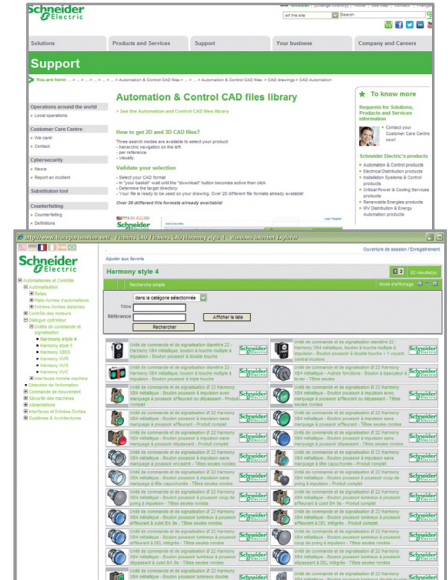

**CAD files:**  
 available in various formats they will be easily integrated into your installation design software.

Please note that references to products and services are just examples.

<b>X</b>		
XVC1B1HK	9	XVC6B15SK 8
XVC1B1K	9	XVC6B25S 8
XVC1B1SK	9	XVC6B25SK 8
XVC1B2HK	9	XVC6B35S 8
XVC1B2K	9	XVC6B35SK 8
XVC1B2SK	9	XVC6B45S 8
XVC1B3HK	9	XVC6B45SK 8
XVC1B3K	9	XVC6B55S 8
XVC1B3SK	9	XVC6B55SK 8
XVC1B4K	9	XVC6M1 8
XVC1B4SK	9	XVC6M1K 8
XVC1B5K	9	XVC6M2 8
XVC1B5SK	9	XVC6M2K 8
XVC1M1HK	9	XVC6M3 8
XVC1M1K	9	XVC6M3K 8
XVC1M1SK	9	XVC6M4 8
XVC1M2HK	9	XVC6M4K 8
XVC1M2K	9	XVC6M5 8
XVC1M2SK	9	XVC6M5K 8
XVC1M3HK	9	XVC6M15S 8
XVC1M3K	9	XVC6M15SK 8
XVC1M3SK	9	XVC6M25S 8
XVC1M4K	9	XVC6M25SK 8
XVC1M4SK	9	XVC6M35S 8
XVC1M5K	9	XVC6M35SK 8
XVC1M5SK	9	XVC6M45S 8
XVC4B1	7	XVC6M45SK 8
XVC4B1K	7	XVC6M55S 8
XVC4B2	7	XVC6M55SK 8
XVC4B2K	7	XVCZ01 7
XVC4B3	7	XVCZ02 8
XVC4B3K	7	XVCZ11 7
XVC4B4	7	XVCZ12 8
XVC4B4K	7	XVCZ31 7
XVC4B5	7	XVCZ32 8
XVC4B5K	7	
XVC4B15S	7	
XVC4B25S	7	
XVC4B35S	7	
XVC4B45S	7	
XVC4B55S	7	
XVC4M1	7	
XVC4M2	7	
XVC4M3	7	
XVC4M4	7	
XVC4M5	7	
XVC4M15S	7	
XVC4M25S	7	
XVC4M35S	7	
XVC4M45S	7	
XVC4M55S	7	
XVC6B1	8	
XVC6B1K	8	
XVC6B2	8	
XVC6B2K	8	
XVC6B3	8	
XVC6B3K	8	
XVC6B4	8	
XVC6B4K	8	
XVC6B5	8	
XVC6B5K	8	
XVC6B15S	8	





**Schneider Electric Industries SAS**

Head Office  
35, rue Joseph Monier  
F-92500 Rueil-Malmaison  
France

[www.schneider-electric.com](http://www.schneider-electric.com)

The information provided in this documentation contains general descriptions and/or technical characteristics of the performance of the products contained herein. This documentation is not intended as a substitute for and is not to be used for determining suitability or reliability of these products for specific user applications. It is the duty of any such user or integrator to perform the appropriate and complete risk analysis, evaluation and testing of the products with respect to the relevant specific application or use thereof. Neither Schneider Electric nor any of its affiliates or subsidiaries shall be responsible or liable for misuse of the information contained herein.

Design: Schneider Electric  
Photos: Schneider Electric  
Printed by:

DIA5ED2130805EN

September 2013