

ABOUTWATER AF/21

Gruppo bordo vasca senza bocca Art. A267 / Deck-mounted without spout Art. A267 / Dur gorge sans bec Art. A267

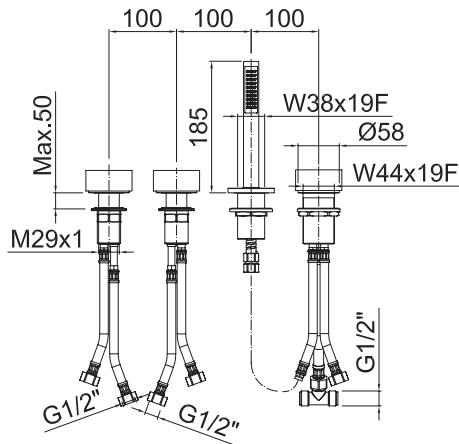

| N° | Codice / Code | Descrizione / Description / Désignation |
|----|---------------|---|
| 1 | 90 00 8507 | Maniglia completa lavabo per Art. A204WF-A206WF-A207WF Complete handle washbasin for Art. A204WF-A206WF-A207WF Manette complete lavabo pour Art. A204WF-A206WF-A207WF |
| 1A | 90 00 9146 | Confezione di fissaggio per maniglia Nostromo Nostromo Fixing kit for Nostromo handle Conféction de fixation pour manette Nostromo |
| 2 | 90 00 8520 | Rosone maniglia Art. A204WF-A206WF-A207WF Handle plate for Art. A204WF-A206WF-A207WF Manette rosace pour Art. A204WF-A206WF-A207WF |
| 3 | 90 00 9659 | Adattatore + vite M4x8 per rub. arresto per Art. 4712 Milano Adaptor + screw M4x8 for stop tap of Art. 4712 Milano Adaptateur + ressort M4x8 pour robinet d'arrêt de l'Art. 4712 Milano7 |
| 4 | 90 00 8519 | Piantana completa per Art. A204WF-A206WF-A207WF Complete stop-tap for Art. A204WF-A206WF-A207WF Robinet lateral complet pour Art. A204WF-A206WF-A207WF |
| 4A | 90 00 0892 | Vitone ceramico Ceramic valve stem Tete de robinet ceramique |
| 5 | 90 00 9476 | Kit guarnizioni piantane per Art. 4204 Riviera Kit of gaskets of stop valves for Art. 4204 Riviera Confection de joints de robineta lateraux pour Art. 4204 Riviera |
| 6 | 90 02 9918 | Flessibile entrata acqua per Art.5965 Venezia Pair of flexible pipes for water inlet for Art. 5965 Venezia Paire de flexibles pour arrive d'eau pour Art. 5965 Venezia |
| 7 | 90 02 9109 | Flessibili collegamento bocca (coppia) Pair of flexible pipes for spout connection Paire de flexibles pour connection du bec |
| 8 | 90 00 8592 | Ghiera per deviatore Art. A265-A267 Diverter ring nut Meccanismo pour bague |
| 9 | 90 00 9702 | Ghiera di bloccaggio cartuccia per Art.5484 Ring nut to arrest cartridge for Art.5484 Bague d'arrêt cartouche pour Art.5484 |
| 10 | 90 00 B270 | Deviatore D.35 due vie per Art. B217A-B219A-B121A D.35 diverter with two ways for Art. B217A-B219A-B121A Inverseur D.35 avec deux voies pour Art. B217A-B219A-B121A |
| 11 | 90 00 8581 | Guarnizioni e flangia per Art. B265 Gaskets and flange for Art. B265 Joints et bride pour Art. B265 |
| 12 | 90 02 9063 | Flessibili di collegamento miscel. 1265S (coppia) Pair of flexible connections 1265S Couple de flexibles d'alimentation 1265S |
| 13 | 90 02 8578 | Flessibili inox M12x1 M3/8 da cm. 60 Stainless steel M12x1 M3/8 60 cm flex. Flexibles en inox M12x1 M3/8 60 cm |
| 14 | 90 00 9914 | Doccetta serie Aboutwater Hand shower series aboutwater Aboutwater séries Douchette |
| 15 | 90 02 1982 | Flessibile per bordo vasca Flexible for horizontal bath-tub mixer Flexible pour bain-douche sur gorge |

AF/21

Gruppo bordo vasca senza bocca Art. A267 / Deck-mounted without spout Art. A267 / Dur gorge sans bec Art. A267

| N° | Codice / Code | Descrizione / Description / Désignation |
|----|---------------|---|
| 16 | 90 00 8591 | Supporto doccetta per bordo vasca Art. A265 Support slim for Art. A265 Support douche pour Art. A265 |
| 17 | 90 00 9919 | Gruppo per valvola non ritorno per Art.5965-5967 Venezia Group for non-return valve for Art. 5965-5967 Venezia Groupe clapet anti-retour pour Art. 5965-5967 Venezia |

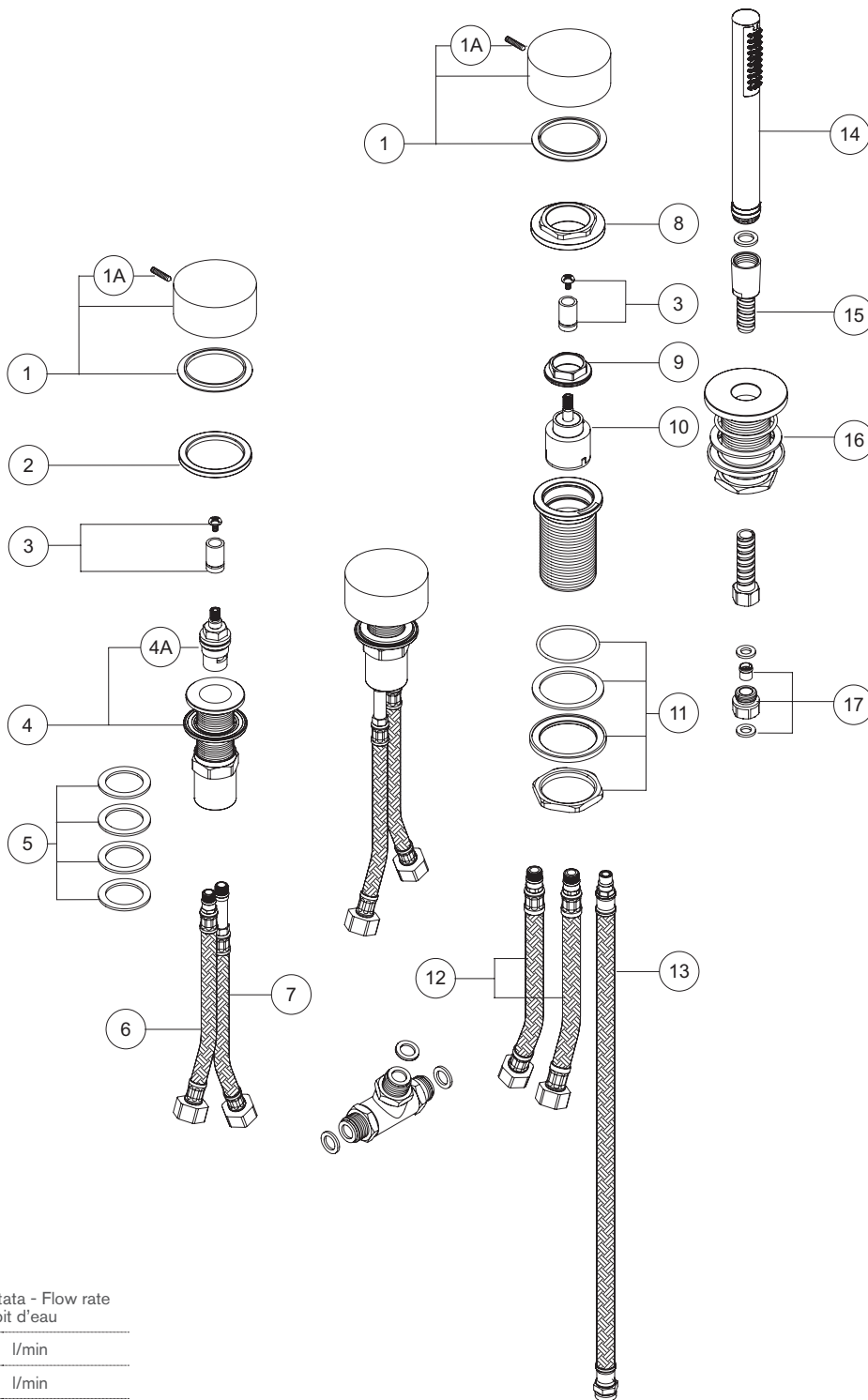

| Pressione - Pressure Pression | Portata - Flow rate Debit d'eau |
|----------------------------------|------------------------------------|
| 0,5 bar | 3 l/min |
| 1 bar | 5 l/min |
| 2 bar | 8 l/min |
| 3 bar | 9 l/min |
| 4 bar | 9 l/min |
| 5 bar | 9 l/min |

Uscita doccetta