

Marchio / Brand ZUCCHETTI

Classe / Class WW

JINGLE

ZIN659

Termostatico incasso doccia con rubinetto d'arresto. / Built-in thermostatic shower mixer, 1 stop valve.



Termostatico incasso doccia da 1/2", con rubinetto d'arresto.





1/2" built-in thermostatic shower mixer with stop valve.

R97820

Parte incasso. / Built-in part.

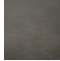

Finiture / Finishes

| | | | | | | |
|--|---|---|---|---|---|---|
|  |  |  |  |  |  |  |
| Cromo / Chrome | Nickel Spazzolato / Brushed Nickel | Nickel Lucido / Polished Nickel | Oro / Gold | Oro spazzolato / Brushed Gold | Metal Black / Metal Black | Metal Black spazzolato / Brushed Metal Black |
|  |  | | | | | |
| Bianco Opaco Goffrato / Embossed Matt White | Nero Opaco Goffrato / Embossed Matt Black | | | | | |

JINGLE

ZIN659

Disegno Complessivo / Overall Drawing

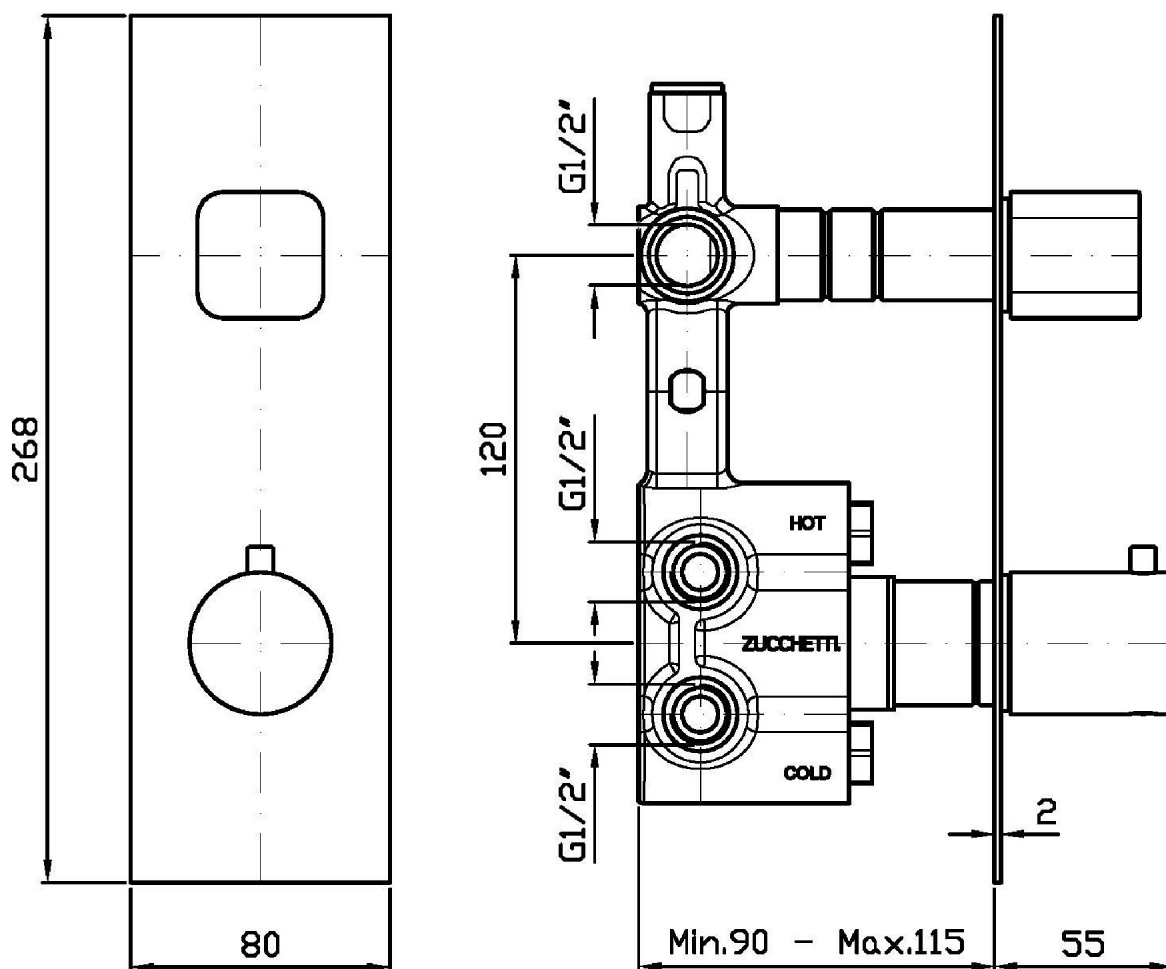

JINGLE

ZIN659

Esplosi / Exploded

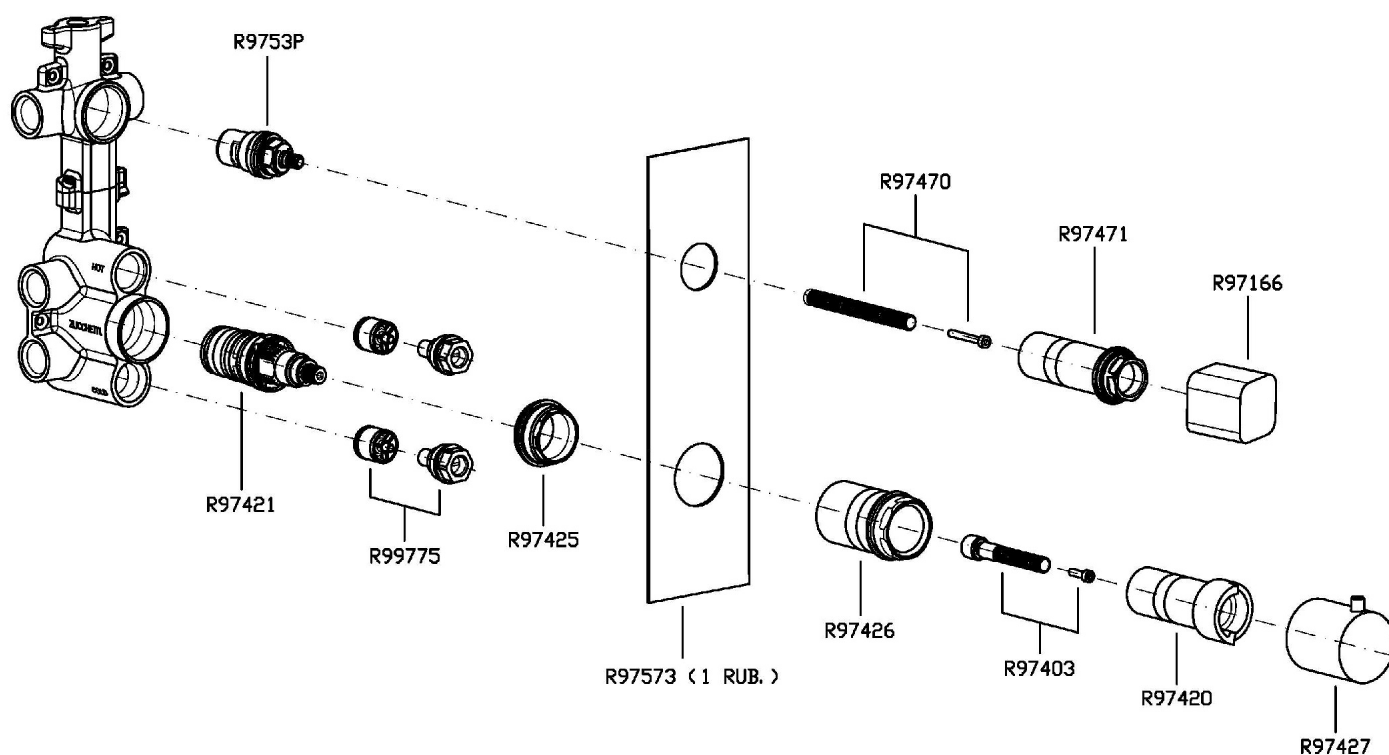

JINGLE

ZIN659

Portate / Flowrates (lt/min)

| PRESSIONE PRESSURE | 1 BAR | 2 BAR | 3 BAR | 4 BAR | 5 BAR |
|---------------------------------|-------|-------|-------|-------|-------|
| 1 RUBINETTO APERTO <i>P1</i> | 13,2 | 18,4 | 22,7 | 26,2 | 29,2 |
| <i>P2</i> | | | | | |
| <i>P3</i> | | | | | |
| <i>P4</i> | | | | | |
| <i>P5</i> | | | | | |

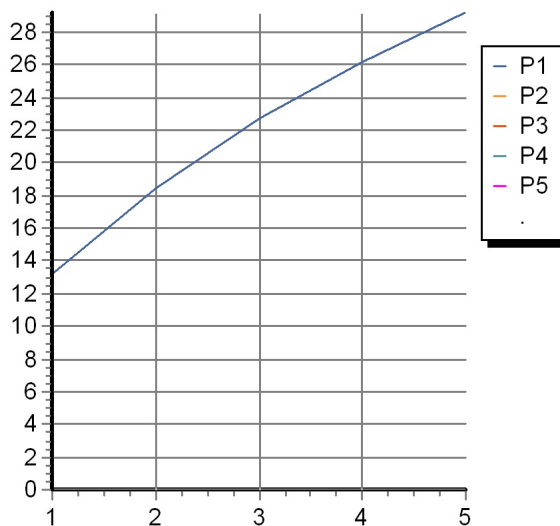

JINGLE

ZIN659

Pesi e Misure / Weights and Sizes

| | | |
|-------------------------------|---------------|----------------|
| Peso (Kg) Weight (lb) | 1,30 (Kg) | 2,87 (lb) |
| Volume test (dc3) - (in3) | 11,01 (dc3) | 671,87 (in3) |
| h (mm) - (in) | 90,00 (mm) | 3,54 (in) |
| L1 (mm) - (in) | 335,00 (mm) | 13,19 (in) |
| L2 (mm) - (in) | 365,00 (mm) | 14,37 (in) |

