

Marchio / Brand ZUCCHETTI

Classe / Class ACC

PAN

ZAC651







Appendiabiti doppio. / Double hook.



Appendiabiti doppio.

Double hook.

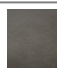
Finiture / Finishes

	 C3	 C8	 C40	 C41	 C50	 C51
Cromo / Chrome	Nickel Spazzolato / Brushed Nickel	Nickel Lucido / Polished Nickel	Oro / Gold	Oro spazzolato / Brushed Gold	Metal Black / Metal Black	Metal Black spazzolato / Brushed Metal Black
 W1	 N1	 N7				
Bianco Opaco Goffrato / Embossed Matt White	Nero Opaco Goffrato / Embossed Matt Black	Nero Soft Touch / Soft Touch Black				

PAN

ZAC651

Disegno Complessivo / Overall Drawing

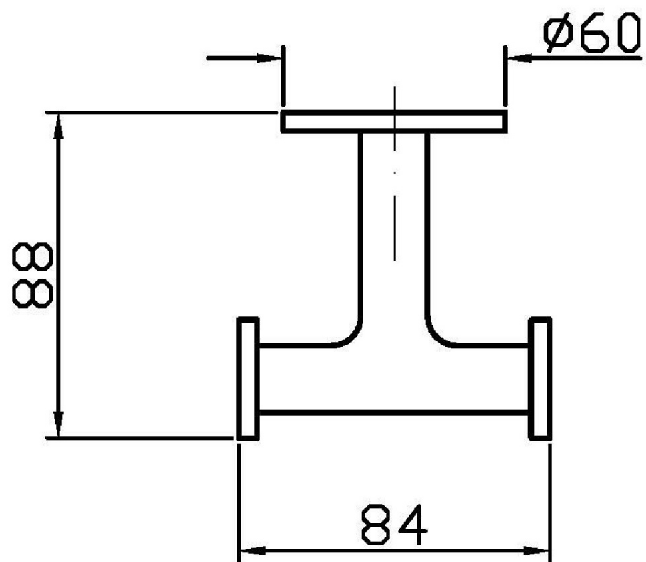

PAN

ZAC651**Pesi e Misure / Weights and Sizes**

Peso (Kg) Weight (lb)	0,57 (Kg)	1,26 (lb)
Volume test (dc3) - (in3)	1,21 (dc3)	73,84 (in3)
h (mm) - (in)	73,00 (mm)	2,87 (in)
L1 (mm) - (in)	127,00 (mm)	5,00 (in)
L2 (mm) - (in)	130,00 (mm)	5,12 (in)

